

# 2021 Certified Tax Roll



**Grid Page  
A-260-A1**



Fort Bend Central Appraisal District (FBCAD) is not authorized to determine legal title to property or establish the legal boundaries of property. FBCAD establishes appraisal records based on information from various sources, including but not limited to deeds, plats and surveys provided to but not created by the district. FBCAD is not responsible for errors or omissions in information submitted to and reviewed by the district. If any errors or omission are detected, contact the GIS Department of the FBCAD.

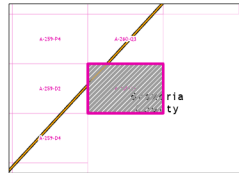

Grid Location Reference

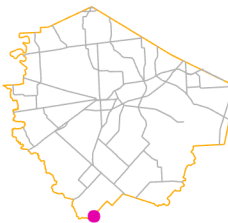

County Location Reference

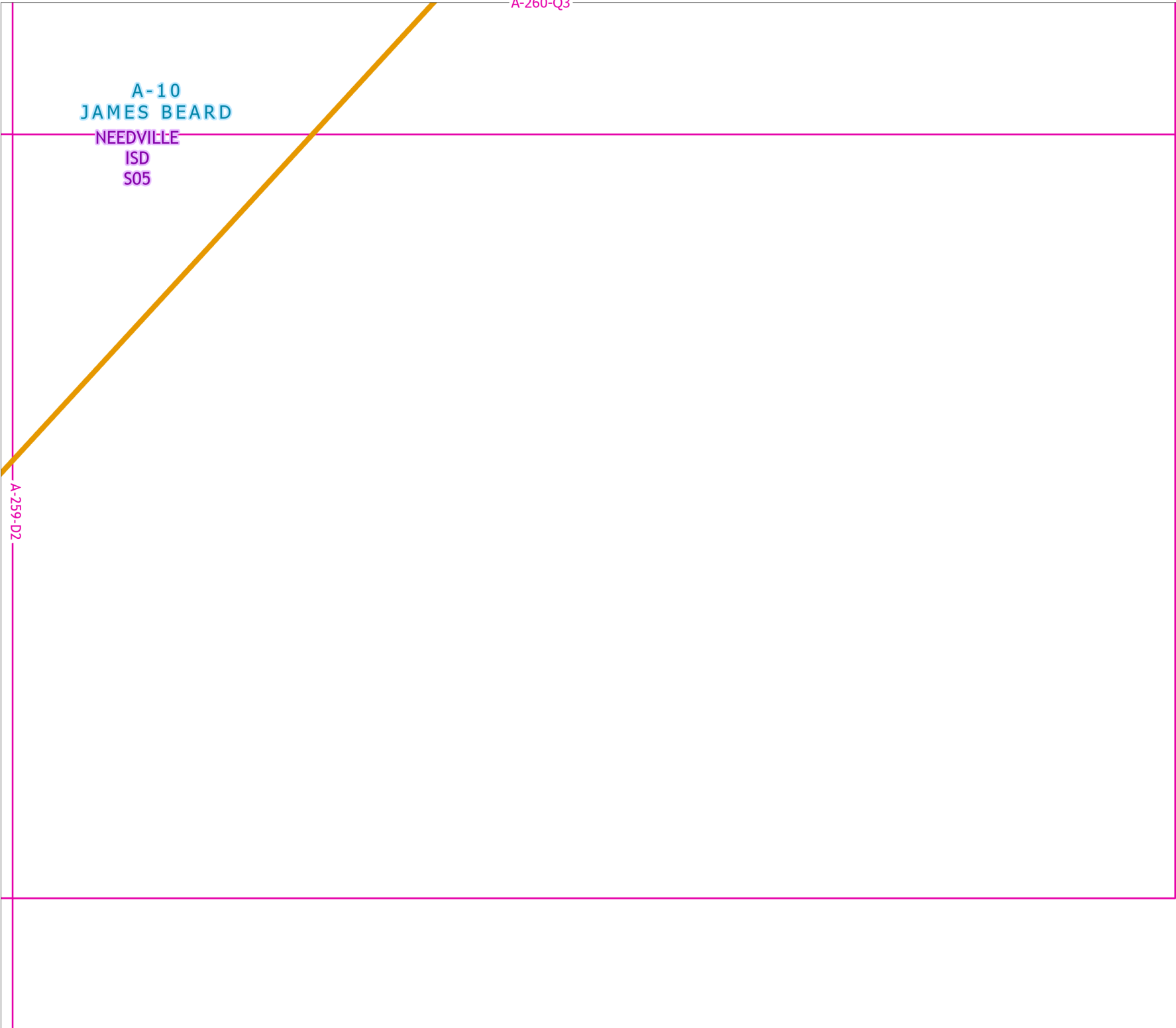

# 2021 Certified Tax Roll



**Grid Page  
A-260-L1**

**A-10  
JAMES BEARD**

**NEEDVILLE  
ISD  
S05**

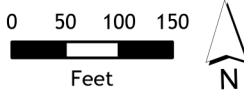

Fort Bend Central Appraisal District (FBCAD) is not authorized to determine legal title to property or establish the legal boundaries of property. FBCAD establishes appraisal records based on information from various sources, including but not limited to deeds, plats and surveys provided to but not created by the district. FBCAD is not responsible for errors or omissions in information submitted to and reviewed by the district. If any errors or omission are detected, contact the GIS Department of the FBCAD.

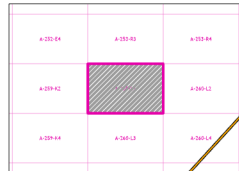

Grid Location Reference

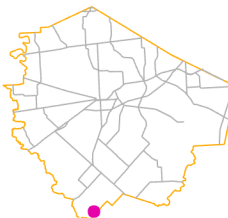

County Location Reference

# 2021 Certified Tax Roll



**Grid Page  
A-260-L2**

**A-10  
JAMES BEARD**

**NEEDVILLE  
ISD  
S05**

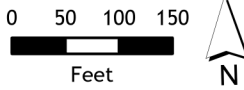

Fort Bend Central Appraisal District (FBCAD) is not authorized to determine legal title to property or establish the legal boundaries of property. FBCAD establishes appraisal records based on information from various sources, including but not limited to deeds, plats and surveys provided to but not created by the district. FBCAD is not responsible for errors or omissions in information submitted to and reviewed by the district. If any errors or omission are detected, contact the GIS Department of the FBCAD.

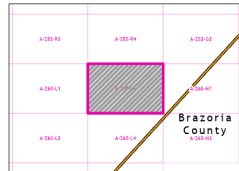

Grid Location Reference

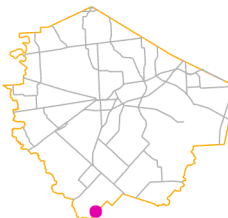

County Location Reference

# 2021 Certified Tax Roll



**Grid Page  
A-260-L3**

**A-10  
JAMES BEARD  
NEEDVILLE  
ISD  
S05**

A-259-K4

A-260-L4

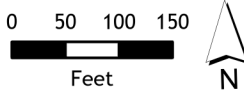

Fort Bend Central Appraisal District (FBCAD) is not authorized to determine legal title to property or establish the legal boundaries of property. FBCAD establishes appraisal records based on information from various sources, including but not limited to deeds, plats and surveys provided to but not created by the district. FBCAD is not responsible for errors or omissions in information submitted to and reviewed by the district. If any errors or omissions are detected, contact the GIS Department of the FBCAD.

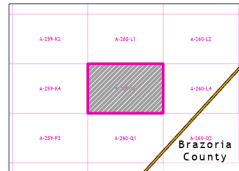

Grid Location Reference

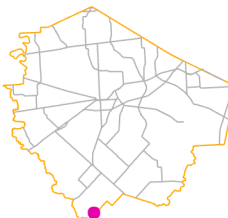

County Location Reference

A-260-L2

# 2021 Certified Tax Roll



Grid Page  
A-260-L4

A-10  
JAMES BEARD  
NEEDVILLE  
ISD  
S05

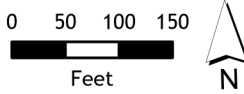

Fort Bend Central Appraisal District (FBCAD) is not authorized to determine legal title to property or establish the legal boundaries of property. FBCAD establishes appraisal records based on information from various sources, including but not limited to deeds, plats and surveys provided to but not created by the district. FBCAD is not responsible for errors or omissions in information submitted to and reviewed by the district. If any errors or omission are detected, contact the GIS Department of the FBCAD.

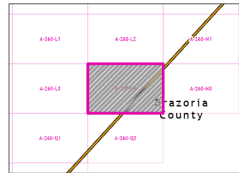

Grid Location Reference

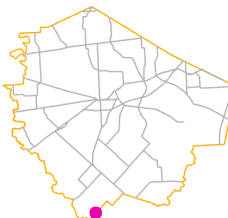

County Location Reference

A-260-L3

A-260-M3

A-260-Q2

ARMSTRONG RD

# 2021 Certified Tax Roll



Grid Page  
A-260-M1



Fort Bend Central Appraisal District (FBCAD) is not authorized to determine legal title to property or establish the legal boundaries of property. FBCAD establishes appraisal records based on information from various sources, including but not limited to deeds, plats and surveys provided to but not created by the district. FBCAD is not responsible for errors or omissions in information submitted to and reviewed by the district. If any errors or omission are detected, contact the GIS Department of the FBCAD.

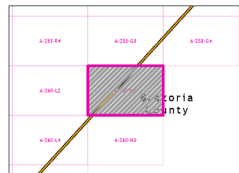

Grid Location Reference

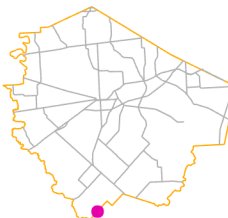

County Location Reference

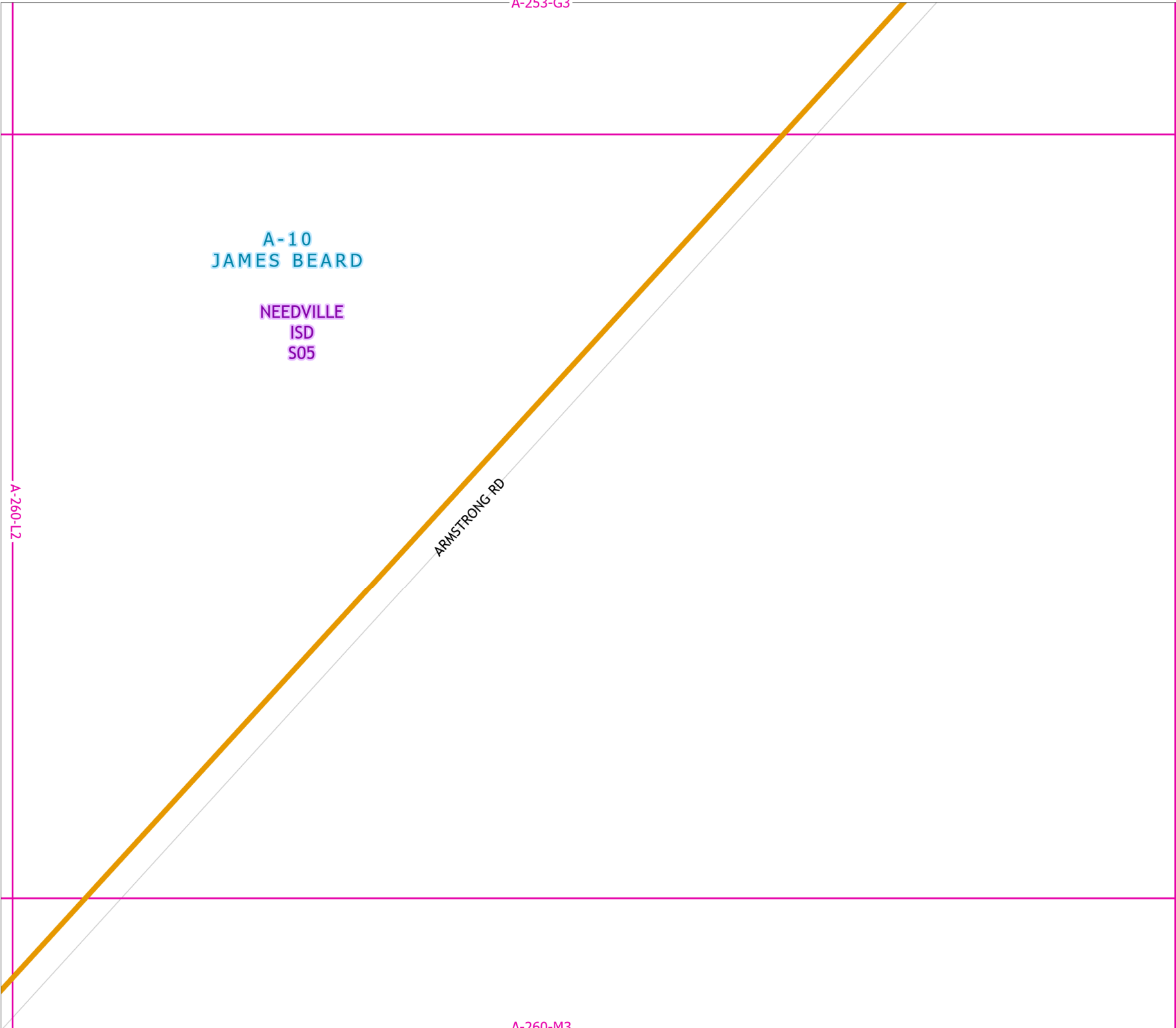

A-10  
JAMES BEARD  
NEEDVILLE  
ISD  
S05

A-260-M1

ARMSTRONG RD

A-260-L4

# 2021 Certified Tax Roll



Grid Page  
A-260-M3

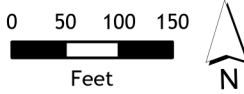

Fort Bend Central Appraisal District (FBCAD) is not authorized to determine legal title to property or establish the legal boundaries of property. FBCAD establishes appraisal records based on information from various sources, including but not limited to deeds, plats and surveys provided to but not created by the district. FBCAD is not responsible for errors or omissions in information submitted to and reviewed by the district. If any errors or omission are detected, contact the GIS Department of the FBCAD.

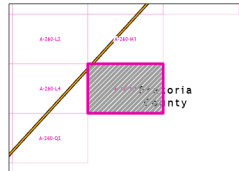

Grid Location Reference

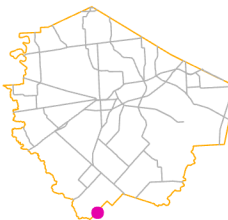

County Location Reference

A-260-L3

# 2021 Certified Tax Roll



Grid Page  
A-260-Q1

A-10  
JAMES BEARD  
NEEDVILLE  
ISD  
S05

A-259-P2

A-260-Q2

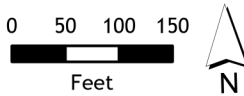

Fort Bend Central Appraisal District (FBCAD) is not authorized to determine legal title to property or establish the legal boundaries of property. FBCAD establishes appraisal records based on information from various sources, including but not limited to deeds, plats and surveys provided to but not created by the district. FBCAD is not responsible for errors or omissions in information submitted to and reviewed by the district. If any errors or omission are detected, contact the GIS Department of the FBCAD.

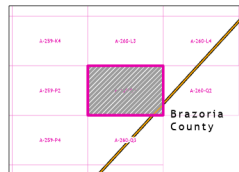

Grid Location Reference

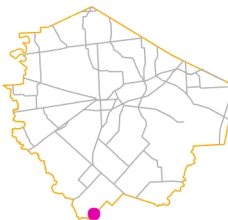

County Location Reference

A-260-Q3

ARMSTRONG RD



# 2021 Certified Tax Roll



**Grid Page  
A-260-Q2**



Fort Bend Central Appraisal District (FBCAD) is not authorized to determine legal title to property or establish the legal boundaries of property. FBCAD establishes appraisal records based on information from various sources, including but not limited to deeds, plats and surveys provided to but not created by the district. FBCAD is not responsible for errors or omissions in information submitted to and reviewed by the district. If any errors or omission are detected, contact the GIS Department of the FBCAD.

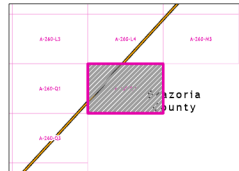

Grid Location Reference

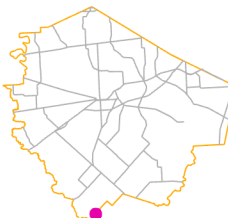

County Location Reference

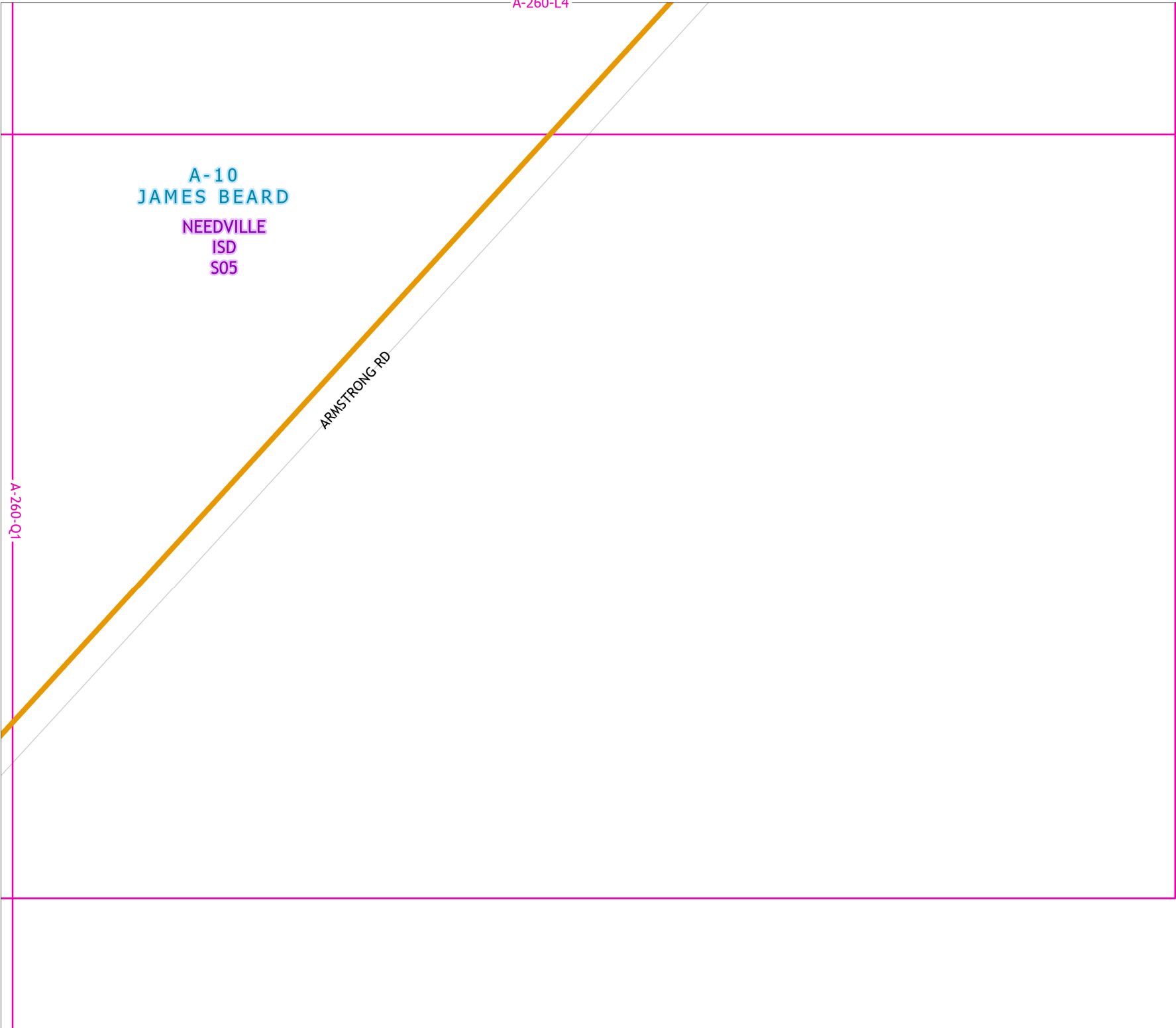

A-260-Q1

# 2021 Certified Tax Roll



Grid Page  
A-260-Q3

A-10  
JAMES BEARD  
NEEDVILLE  
ISD  
S05

ARMSTRONG RD

A-259-P4

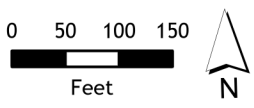

Fort Bend Central Appraisal District (FBCAD) is not authorized to determine legal title to property or establish the legal boundaries of property. FBCAD establishes appraisal records based on information from various sources, including but not limited to deeds, plats and surveys provided to but not created by the district. FBCAD is not responsible for errors or omissions in information submitted to and reviewed by the district. If any errors or omission are detected, contact the GIS Department of the FBCAD.

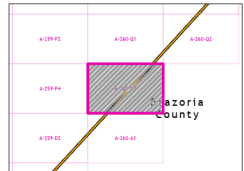

Grid Location Reference

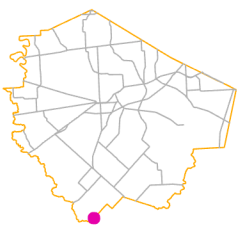

County Location Reference

A-260-A1