

A-248-Q4

G DUTY

NEEDVILLE  
ISD  
S05

A-150  
H N CLEVELAND

# 2021 Certified Tax Roll



Grid Page  
A-255-E2

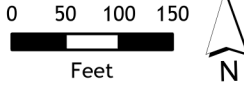

Fort Bend Central Appraisal District (FBCAD) is not authorized to determine legal title to property or establish the legal boundaries of property. FBCAD establishes appraisal records based on information from various sources, including but not limited to deeds, plats and surveys provided to but not created by the district. FBCAD is not responsible for errors or omissions in information submitted to and reviewed by the district. If any errors or omission are detected, contact the GIS Department of the FBCAD.

A-255-F1

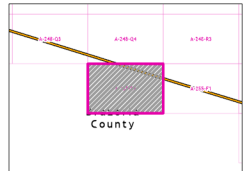

Grid Location Reference

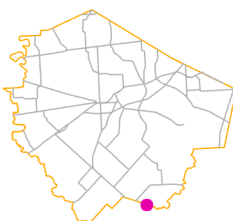

County Location Reference

# 2021 Certified Tax Roll



**Grid Page  
A-255-F1**

7200  
11.3149 AC

NEEDVILLE  
ISD  
S05

A-150  
H N CLEVELAND

A-255-E2

A-255-F2

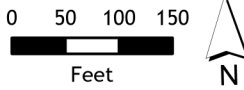

Fort Bend Central Appraisal District (FBCAD) is not authorized to determine legal title to property or establish the legal boundaries of property. FBCAD establishes appraisal records based on information from various sources, including but not limited to deeds, plats and surveys provided to but not created by the district. FBCAD is not responsible for errors or omissions in information submitted to and reviewed by the district. If any errors or omission are detected, contact the GIS Department of the FBCAD.

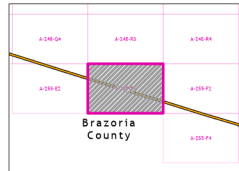

Grid Location Reference

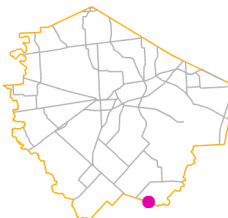

County Location Reference



## Grid Page A-255-F2

6900  
151.361 AC

A-150  
H N CLEVELAND  
NEEDVILLE  
ISD  
S05

7901  
10.785 AC

A-255-F1

A-256-G1

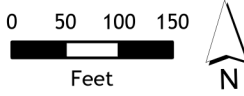

Fort Bend Central Appraisal District (FBCAD) is not authorized to determine legal title to property or establish the legal boundaries of property. FBCAD establishes appraisal records based on information from various sources, including but not limited to deeds, plats and surveys provided to but not created by the district. FBCAD is not responsible for errors or omissions in information submitted to and reviewed by the district. If any errors or omission are detected, contact the GIS Department of the FBCAD.

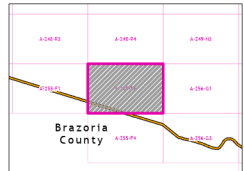

Grid Location Reference

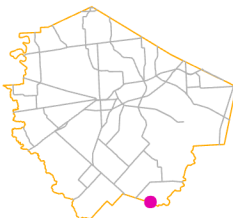

County Location Reference

A-255-F2

7901  
10.785 AC

NEEDVILLE  
ISD  
505 H N CLEVELAND  
A-150

# 2021 Certified Tax Roll



Grid Page  
A-255-F4

A-256-G3

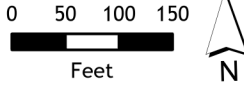

Fort Bend Central Appraisal District (FBCAD) is not authorized to determine legal title to property or establish the legal boundaries of property. FBCAD establishes appraisal records based on information from various sources, including but not limited to deeds, plats and surveys provided to but not created by the district. FBCAD is not responsible for errors or omissions in information submitted to and reviewed by the district. If any errors or omission are detected, contact the GIS Department of the FBCAD.

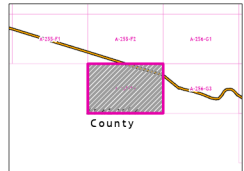

Grid Location Reference

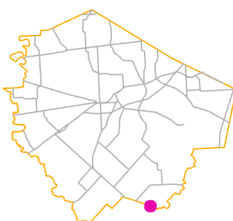

County Location Reference