

2021 Certified Tax Roll



Grid Page
A-248-A1



Fort Bend Central Appraisal District (FBCAD) is not authorized to determine legal title to property or establish the legal boundaries of property. FBCAD establishes appraisal records based on information from various sources, including but not limited to deeds, plats and surveys provided to but not created by the district. FBCAD is not responsible for errors or omissions in information submitted to and reviewed by the district. If any errors or omission are detected, contact the GIS Department of the FBCAD.

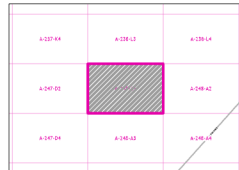

Grid Location Reference



County Location Reference

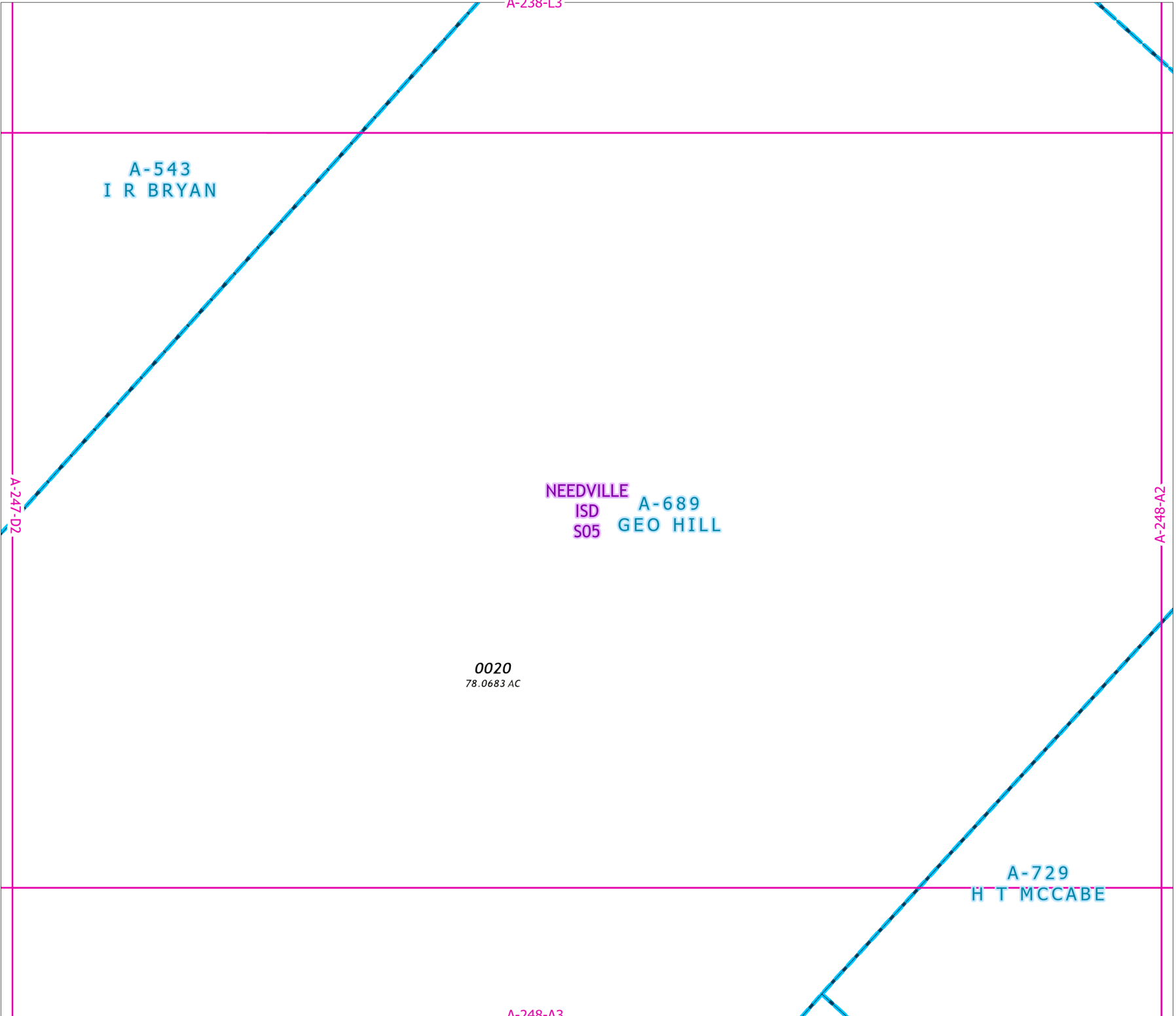

2021 Certified Tax Roll



Grid Page
A-248-A2



Fort Bend Central Appraisal District (FBCAD) is not authorized to determine legal title to property or establish the legal boundaries of property. FBCAD establishes appraisal records based on information from various sources, including but not limited to deeds, plats and surveys provided to but not created by the district. FBCAD is not responsible for errors or omissions in information submitted to and reviewed by the district. If any errors or omission are detected, contact the GIS Department of the FBCAD.

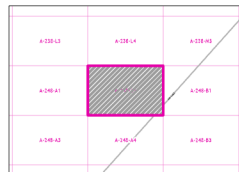

Grid Location Reference

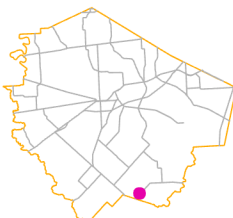

County Location Reference

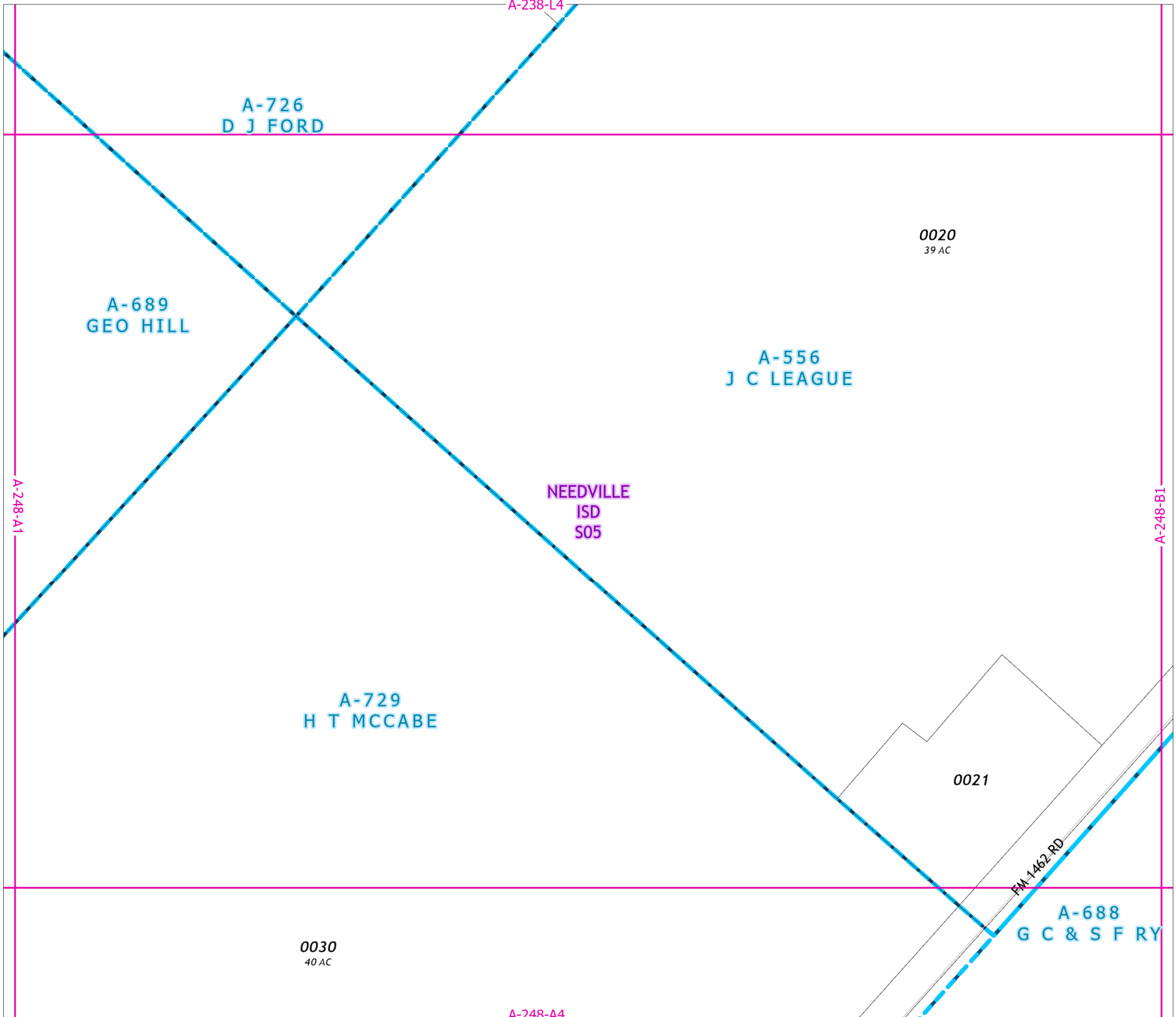

A-248-A1

2021 Certified Tax Roll



Grid Page
A-248-A3

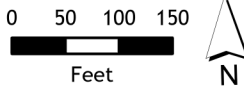

Fort Bend Central Appraisal District (FBCAD) is not authorized to determine legal title to property or establish the legal boundaries of property. FBCAD establishes appraisal records based on information from various sources, including but not limited to deeds, plats and surveys provided to but not created by the district. FBCAD is not responsible for errors or omissions in information submitted to and reviewed by the district. If any errors or omission are detected, contact the GIS Department of the FBCAD.

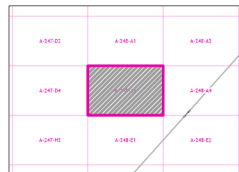

Grid Location Reference



County Location Reference

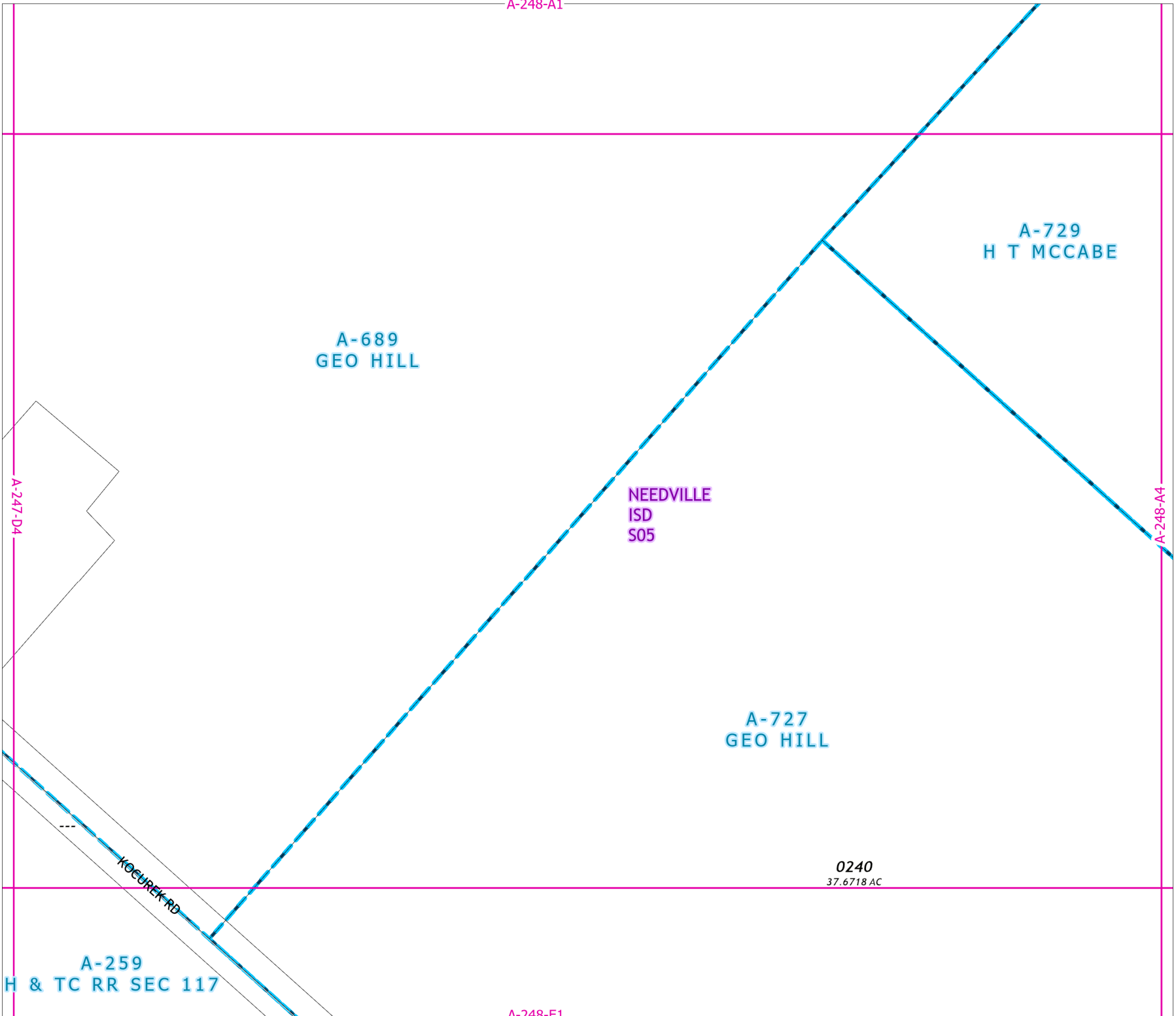

A-247-D4

A-259
H & TC RR SEC 117

A-689
GEO HILL

NEEDVILLE
ISD
S05

A-727
GEO HILL

A-729
H T MCCABE

0240
37.6718 AC

A-248-E1

A-248-A4

A-248-A2

0021
A-556
J C LEAGUE

0030
40 AC

A-729
H T MCCABE

A-688
G C & S F R Y

NEEDVILLE
ISD
S05

FM 1462 RD

A-449
DAY LAND & CATTLE

A-727
GEO HILL

A-248-E2

2021 Certified Tax Roll



Grid Page
A-248-A4

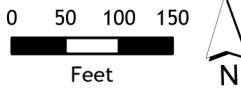

Fort Bend Central Appraisal District (FBCAD) is not authorized to determine legal title to property or establish the legal boundaries of property. FBCAD establishes appraisal records based on information from various sources, including but not limited to deeds, plats and surveys provided to but not created by the district. FBCAD is not responsible for errors or omissions in information submitted to and reviewed by the district. If any errors or omission are detected, contact the GIS Department of the FBCAD.

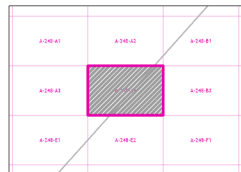

Grid Location Reference



County Location Reference

A-248-A3

A-248-B3

2021 Certified Tax Roll



Grid Page
A-248-B1

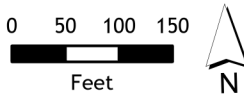

Fort Bend Central Appraisal District (FBCAD) is not authorized to determine legal title to property or establish the legal boundaries of property. FBCAD establishes appraisal records based on information from various sources, including but not limited to deeds, plats and surveys provided to but not created by the district. FBCAD is not responsible for errors or omissions in information submitted to and reviewed by the district. If any errors or omission are detected, contact the GIS Department of the FBCAD.

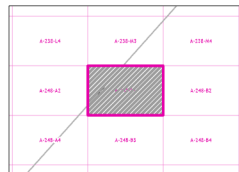

Grid Location Reference



County Location Reference

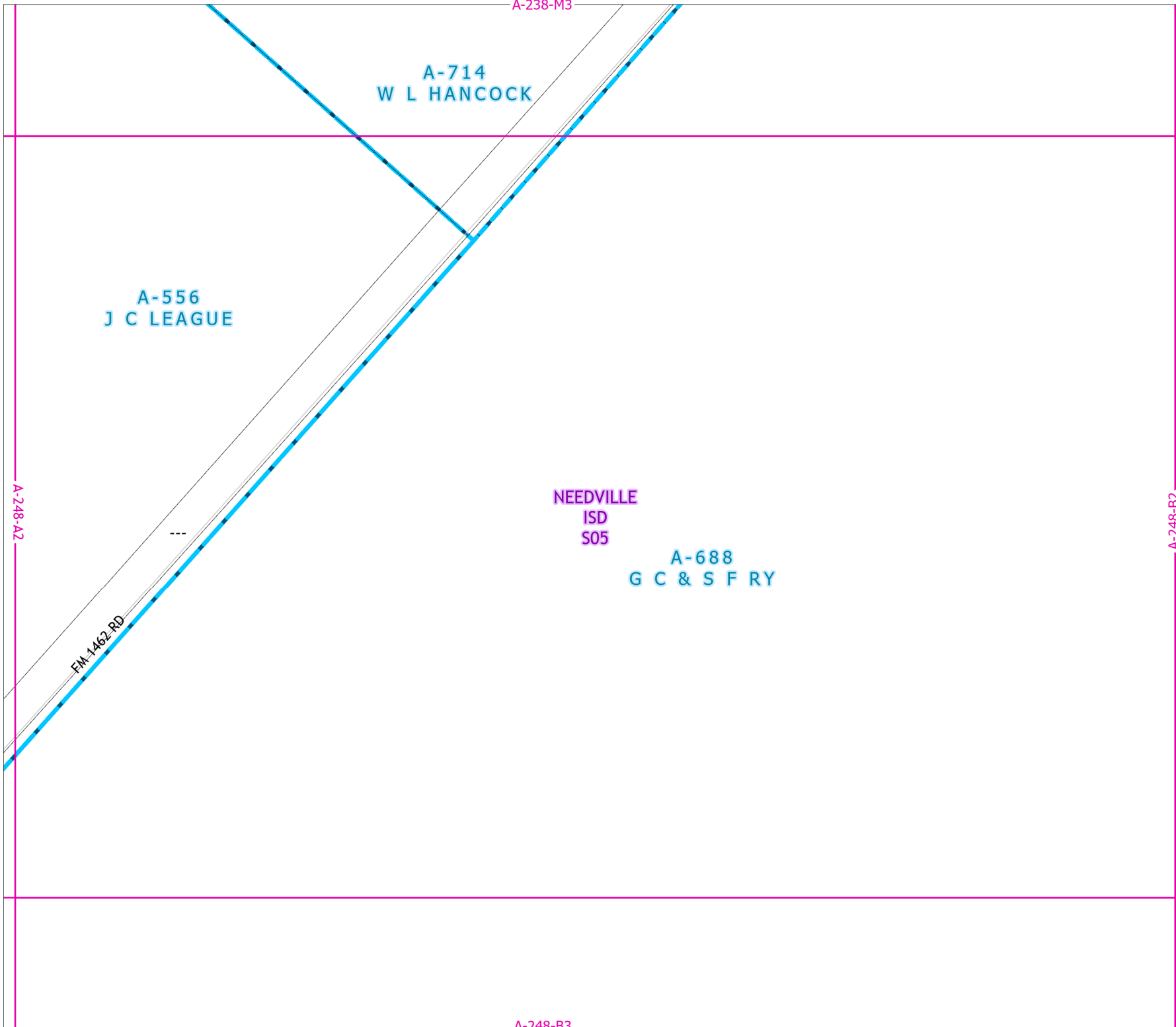

2021 Certified Tax Roll



**Grid Page
A-248-B2**

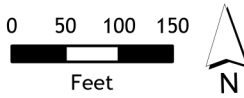

Fort Bend Central Appraisal District (FBCAD) is not authorized to determine legal title to property or establish the legal boundaries of property. FBCAD establishes appraisal records based on information from various sources, including but not limited to deeds, plats and surveys provided to but not created by the district. FBCAD is not responsible for errors or omissions in information submitted to and reviewed by the district. If any errors or omission are detected, contact the GIS Department of the FBCAD.

NEEDVILLE 0730
267.165 AC
ISD A-688
S05 G C & S F RY

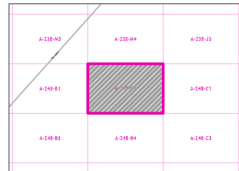

Grid Location Reference

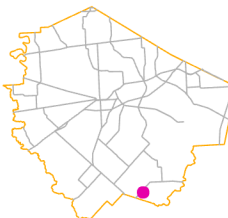

County Location Reference



A-688
G C & S F R Y

NEEDVILLE
ISD
S05

A-662
JOHN STEWARDSON

A-449
DAY LAND & CATTLE

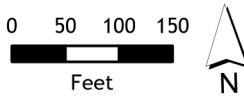

Fort Bend Central Appraisal District (FBCAD) is not authorized to determine legal title to property or establish the legal boundaries of property. FBCAD establishes appraisal records based on information from various sources, including but not limited to deeds, plats and surveys provided to but not created by the district. FBCAD is not responsible for errors or omissions in information submitted to and reviewed by the district. If any errors or omission are detected, contact the GIS Department of the FBCAD.

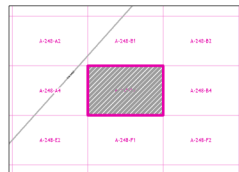

Grid Location Reference

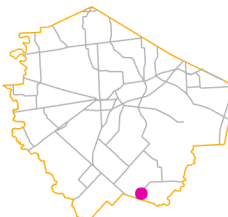

County Location Reference

A-248-A4

A-248-B4



A-688
G C & S F R Y

NEEDVILLE
ISD
S05

A-662
JOHN STEWARDSON

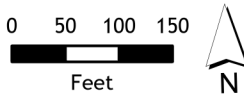

Fort Bend Central Appraisal District (FBCAD) is not authorized to determine legal title to property or establish the legal boundaries of property. FBCAD establishes appraisal records based on information from various sources, including but not limited to deeds, plats and surveys provided to but not created by the district. FBCAD is not responsible for errors or omissions in information submitted to and reviewed by the district. If any errors or omission are detected, contact the GIS Department of the FBCAD.

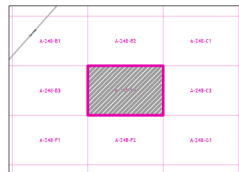

Grid Location Reference

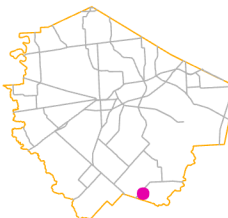

County Location Reference

2021 Certified Tax Roll



**Grid Page
A-248-C1**

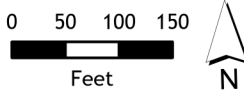

Fort Bend Central Appraisal District (FBCAD) is not authorized to determine legal title to property or establish the legal boundaries of property. FBCAD establishes appraisal records based on information from various sources, including but not limited to deeds, plats and surveys provided to but not created by the district. FBCAD is not responsible for errors or omissions in information submitted to and reviewed by the district. If any errors or omission are detected, contact the GIS Department of the FBCAD.

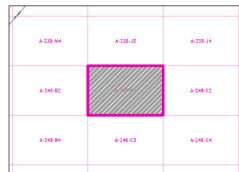

Grid Location Reference



County Location Reference

NEEDVILLE
ISD
S05
A-688
G C & S F R Y

G DUTY

2021 Certified Tax Roll



**Grid Page
A-248-C2**

0020
100 AC

**A-150
H N CLEVELAND**

**NEEDVILLE
ISD
S05**

A-248-C1

A-248-D1

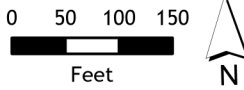

Fort Bend Central Appraisal District (FBCAD) is not authorized to determine legal title to property or establish the legal boundaries of property. FBCAD establishes appraisal records based on information from various sources, including but not limited to deeds, plats and surveys provided to but not created by the district. FBCAD is not responsible for errors or omissions in information submitted to and reviewed by the district. If any errors or omission are detected, contact the GIS Department of the FBCAD.

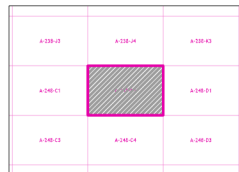

Grid Location Reference



County Location Reference

A-248-C1

2021 Certified Tax Roll



Grid Page
A-248-C3

A-688
G C & S F R Y

NEEDVILLE
ISD
S05

G DURY

A-662
JOHN STEWARDSON

A-248-B4

A-248-C4

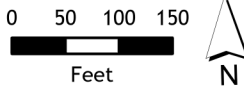

Fort Bend Central Appraisal District (FBCAD) is not authorized to determine legal title to property or establish the legal boundaries of property. FBCAD establishes appraisal records based on information from various sources, including but not limited to deeds, plats and surveys provided to but not created by the district. FBCAD is not responsible for errors or omissions in information submitted to and reviewed by the district. If any errors or omission are detected, contact the GIS Department of the FBCAD.

| | | |
|----------|----------|----------|
| A-248-B2 | A-248-C1 | A-248-C2 |
| A-248-B4 | A-248-C3 | A-248-C4 |
| A-248-B6 | A-248-D1 | A-248-D2 |

Grid Location Reference

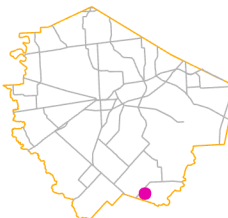

County Location Reference

A-248-G1

A-248-C2

2021 Certified Tax Roll



Grid Page
A-248-C4

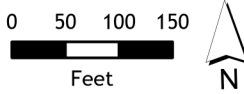

Fort Bend Central Appraisal District (FBCAD) is not authorized to determine legal title to property or establish the legal boundaries of property. FBCAD establishes appraisal records based on information from various sources, including but not limited to deeds, plats and surveys provided to but not created by the district. FBCAD is not responsible for errors or omissions in information submitted to and reviewed by the district. If any errors or omission are detected, contact the GIS Department of the FBCAD.

A-150 NEEDVILLE
H N CLEVELAND ISD S05

A-248-C3

A-248-D3

| | | |
|----------|----------|----------|
| A-248-C1 | A-248-C2 | A-248-C3 |
| A-248-C3 | A-248-C4 | A-248-C5 |
| A-248-C1 | A-248-C2 | A-248-C3 |

Grid Location Reference

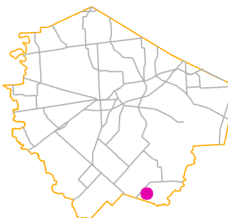

County Location Reference

A-248-G2

2021 Certified Tax Roll



**Grid Page
A-248-D1**

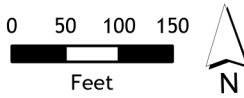

Fort Bend Central Appraisal District (FBCAD) is not authorized to determine legal title to property or establish the legal boundaries of property. FBCAD establishes appraisal records based on information from various sources, including but not limited to deeds, plats and surveys provided to but not created by the district. FBCAD is not responsible for errors or omissions in information submitted to and reviewed by the district. If any errors or omission are detected, contact the GIS Department of the FBCAD.

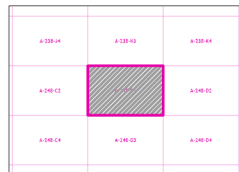

Grid Location Reference



County Location Reference



A-248-C2

A-248-D2

A-238-K4

NEEDVILLE
ISD
S05

2021 Certified Tax Roll



Grid Page
A-248-D2

1120
98.613 AC

0820
95.402 AC

A-150
H N CLEVELAND

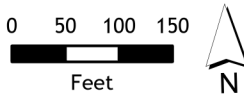

Fort Bend Central Appraisal District (FBCAD) is not authorized to determine legal title to property or establish the legal boundaries of property. FBCAD establishes appraisal records based on information from various sources, including but not limited to deeds, plats and surveys provided to but not created by the district. FBCAD is not responsible for errors or omissions in information submitted to and reviewed by the district. If any errors or omission are detected, contact the GIS Department of the FBCAD.

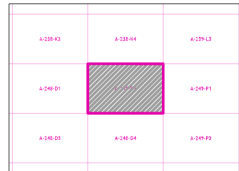

Grid Location Reference

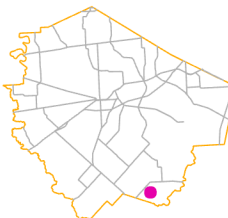

County Location Reference

A-248-D4

A-248-D1

A-249-P1

A-248-D1

2021 Certified Tax Roll



**Grid Page
A-248-D3**

**A-150 NEEDVILLE
H N CLEVELAND ISD S05**

A-248-C4

A-248-D4

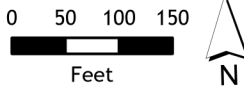

Fort Bend Central Appraisal District (FBCAD) is not authorized to determine legal title to property or establish the legal boundaries of property. FBCAD establishes appraisal records based on information from various sources, including but not limited to deeds, plats and surveys provided to but not created by the district. FBCAD is not responsible for errors or omissions in information submitted to and reviewed by the district. If any errors or omission are detected, contact the GIS Department of the FBCAD.

| | | |
|----------|----------|----------|
| A-248-C2 | A-248-D1 | A-248-E2 |
| A-248-C4 | A-248-D3 | A-248-D4 |
| A-248-C6 | A-248-E1 | A-248-E4 |

Grid Location Reference

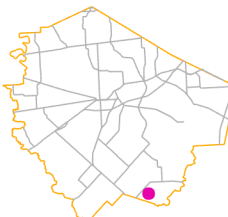

County Location Reference

A-248-H1

2021 Certified Tax Roll



Grid Page
A-248-D4



Fort Bend Central Appraisal District (FBCAD) is not authorized to determine legal title to property or establish the legal boundaries of property. FBCAD establishes appraisal records based on information from various sources, including but not limited to deeds, plats and surveys provided to but not created by the district. FBCAD is not responsible for errors or omissions in information submitted to and reviewed by the district. If any errors or omission are detected, contact the GIS Department of the FBCAD.

| | | |
|----------|----------|----------|
| A-248-D1 | A-248-D2 | A-248-D3 |
| A-248-D3 | A-248-D4 | A-248-D5 |
| A-248-D6 | A-248-D7 | A-248-D8 |

Grid Location Reference

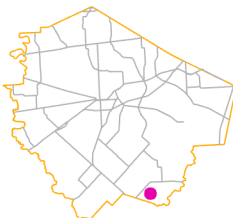

County Location Reference

A-248-D2

A-150
H N CLEVELAND

NEEDVILLE
ISD
S05

A-248-D3

A-249-P3

A-248-H2

2021 Certified Tax Roll



Grid Page
A-248-E1



Fort Bend Central Appraisal District (FBCAD) is not authorized to determine legal title to property or establish the legal boundaries of property. FBCAD establishes appraisal records based on information from various sources, including but not limited to deeds, plats and surveys provided to but not created by the district. FBCAD is not responsible for errors or omissions in information submitted to and reviewed by the district. If any errors or omission are detected, contact the GIS Department of the FBCAD.

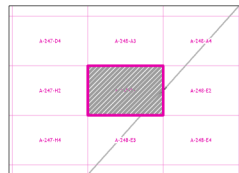

Grid Location Reference

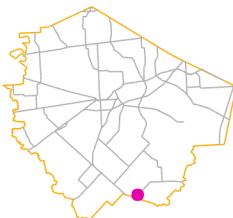

County Location Reference

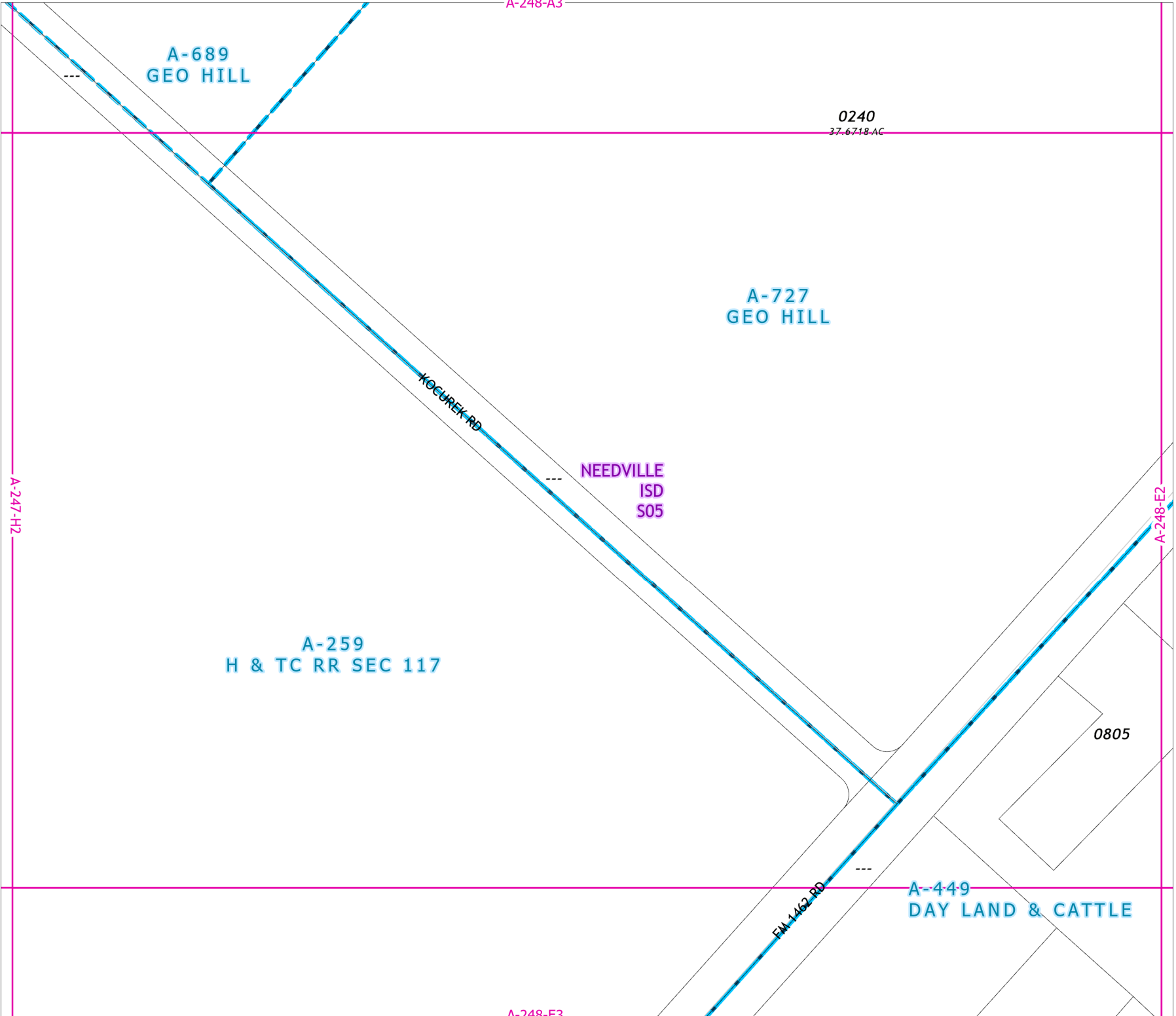

2021 Certified Tax Roll



Grid Page
A-248-E2



Fort Bend Central Appraisal District (FBCAD) is not authorized to determine legal title to property or establish the legal boundaries of property. FBCAD establishes appraisal records based on information from various sources, including but not limited to deeds, plats and surveys provided to but not created by the district. FBCAD is not responsible for errors or omissions in information submitted to and reviewed by the district. If any errors or omissions are detected, contact the GIS Department of the FBCAD.

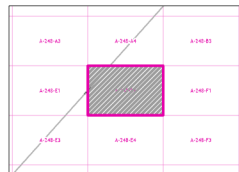

Grid Location Reference



County Location Reference

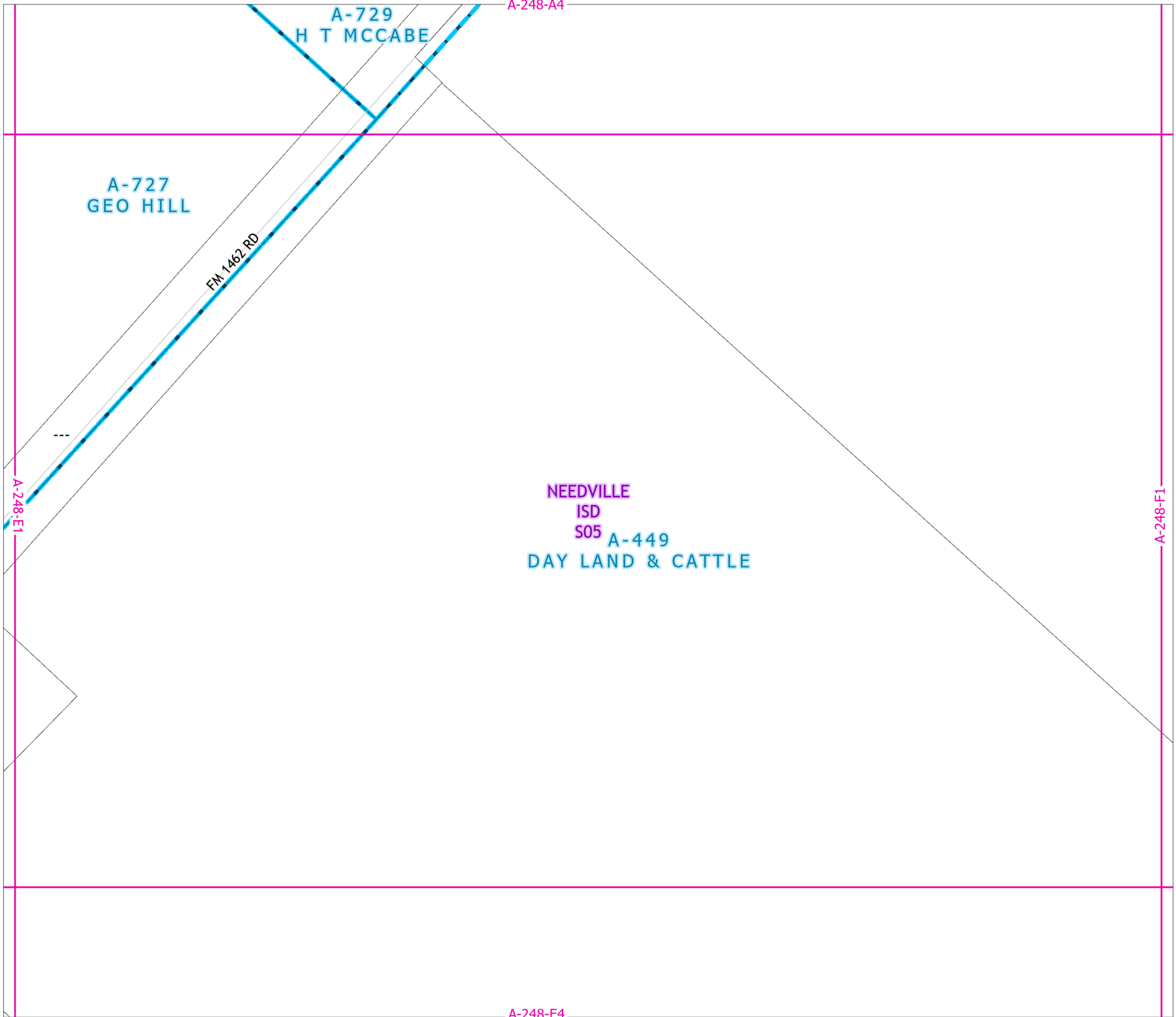

A-248-E1

2021 Certified Tax Roll



Grid Page
A-248-E3

A-259
H & TC RR SEC 117

0801

0800
9 AC

NEEDVILLE
ISD
S05

A-449
DAY LAND & CATTLE

FM 1462 RD

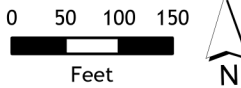

Fort Bend Central Appraisal District (FBCAD) is not authorized to determine legal title to property or establish the legal boundaries of property. FBCAD establishes appraisal records based on information from various sources, including but not limited to deeds, plats and surveys provided to but not created by the district. FBCAD is not responsible for errors or omissions in information submitted to and reviewed by the district. If any errors or omission are detected, contact the GIS Department of the FBCAD.

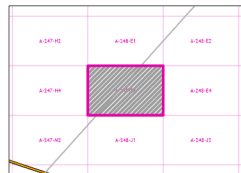

Grid Location Reference

0275

0270
7.452 AC

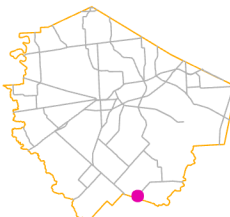

County Location Reference

A-248-J1

A-247-H4

A-248-E4

A-248-E2

2021 Certified Tax Roll



**Grid Page
A-248-E4**

0802
90.149 AC

A-449
DAY LAND & CATTLE
NEEDVILLE
ISD
S05

0804
15 AC

A-248-E3

A-248-E3

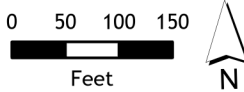

Fort Bend Central Appraisal District (FBCAD) is not authorized to determine legal title to property or establish the legal boundaries of property. FBCAD establishes appraisal records based on information from various sources, including but not limited to deeds, plats and surveys provided to but not created by the district. FBCAD is not responsible for errors or omissions in information submitted to and reviewed by the district. If any errors or omission are detected, contact the GIS Department of the FBCAD.

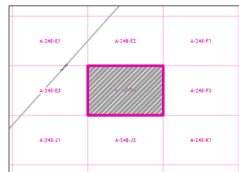

Grid Location Reference



County Location Reference

A-248-J2

2021 Certified Tax Roll



Grid Page
A-248-F1



Fort Bend Central Appraisal District (FBCAD) is not authorized to determine legal title to property or establish the legal boundaries of property. FBCAD establishes appraisal records based on information from various sources, including but not limited to deeds, plats and surveys provided to but not created by the district. FBCAD is not responsible for errors or omissions in information submitted to and reviewed by the district. If any errors or omission are detected, contact the GIS Department of the FBCAD.

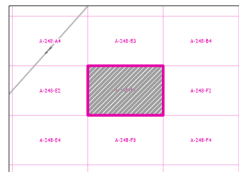

Grid Location Reference



County Location Reference

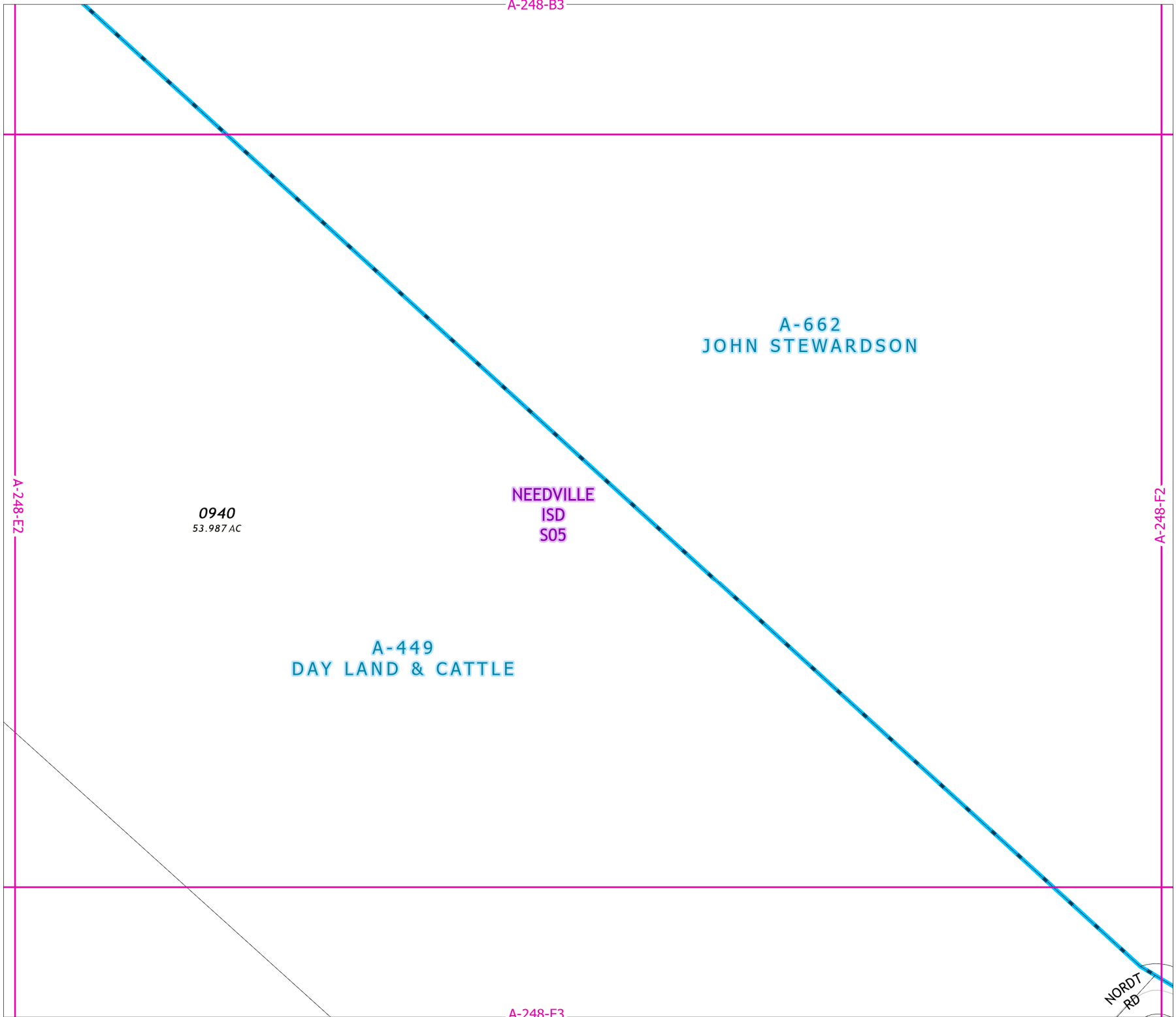



Grid Page A-248-F2

A-662
JOHN STEWARDSON
NEEDVILLE
ISD
S05

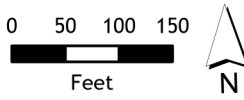

Fort Bend Central Appraisal District (FBCAD) is not authorized to determine legal title to property or establish the legal boundaries of property. FBCAD establishes appraisal records based on information from various sources, including but not limited to deeds, plats and surveys provided to but not created by the district. FBCAD is not responsible for errors or omissions in information submitted to and reviewed by the district. If any errors or omission are detected, contact the GIS Department of the FBCAD.

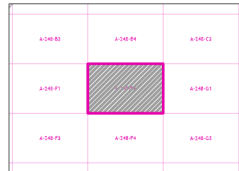

Grid Location Reference

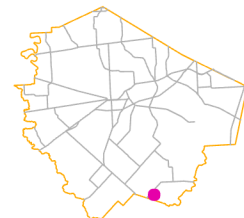

County Location Reference

0030
243.009 AC



2021 Certified Tax Roll



**Grid Page
A-248-F3**



Fort Bend Central Appraisal District (FBCAD) is not authorized to determine legal title to property or establish the legal boundaries of property. FBCAD establishes appraisal records based on information from various sources, including but not limited to deeds, plats and surveys provided to but not created by the district. FBCAD is not responsible for errors or omissions in information submitted to and reviewed by the district. If any errors or omission are detected, contact the GIS Department of the FBCAD.

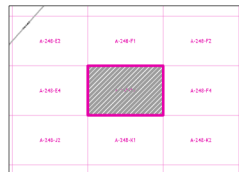

Grid Location Reference

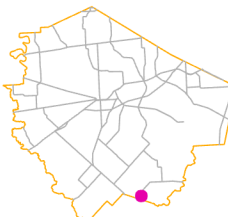

County Location Reference

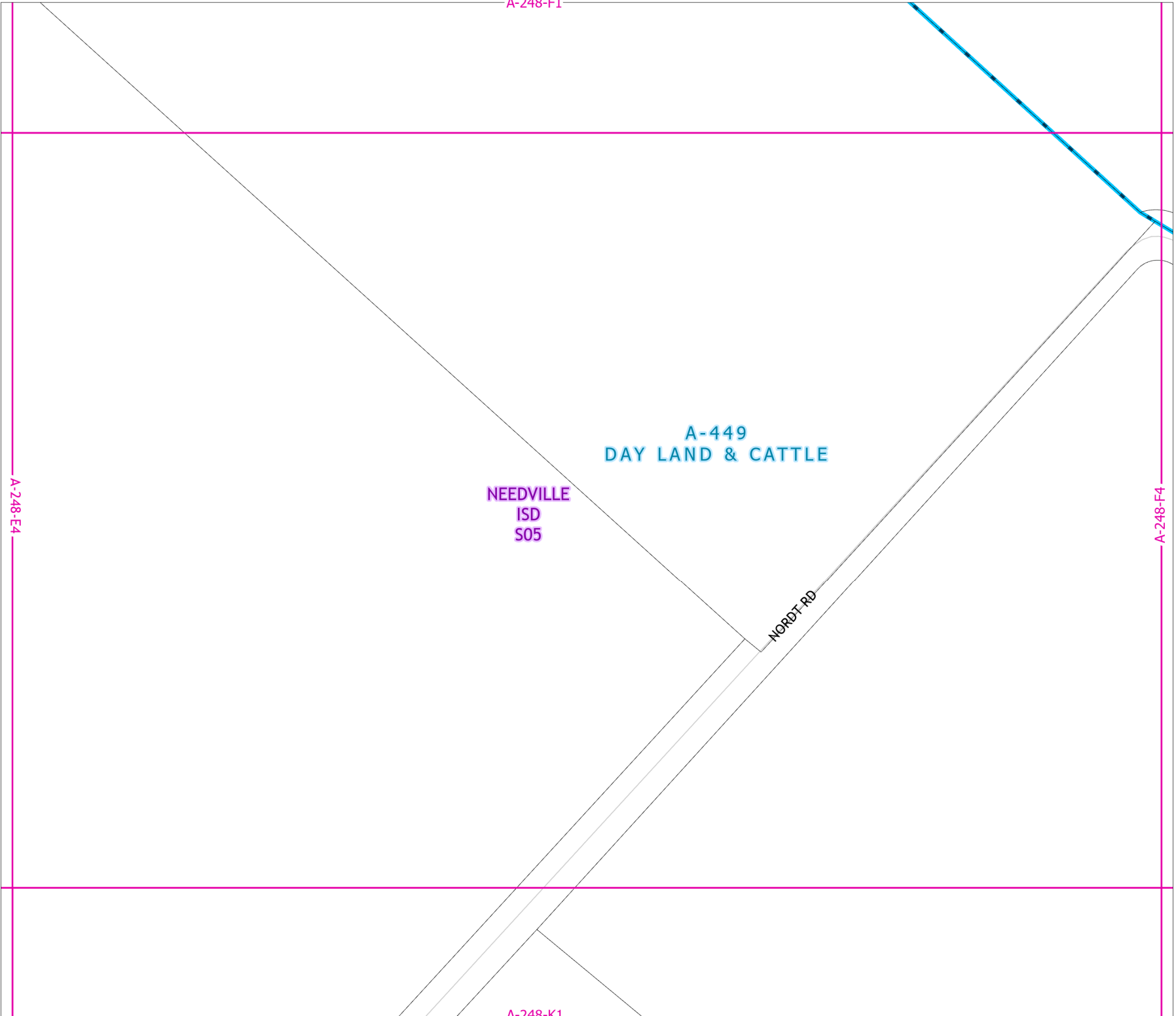

A-248-F2

0030
243.009 AC

2021 Certified Tax Roll



Grid Page
A-248-F4

A-662
JOHN STEWARDSON

NEEDVILLE
ISD
S05

NORDT RD

A-449
DAY LAND & CATTLE

A-248-F3

A-248-G3

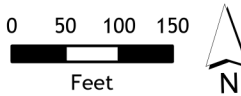

Fort Bend Central Appraisal District (FBCAD) is not authorized to determine legal title to property or establish the legal boundaries of property. FBCAD establishes appraisal records based on information from various sources, including but not limited to deeds, plats and surveys provided to but not created by the district. FBCAD is not responsible for errors or omissions in information submitted to and reviewed by the district. If any errors or omission are detected, contact the GIS Department of the FBCAD.

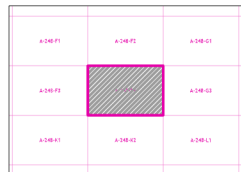

Grid Location Reference

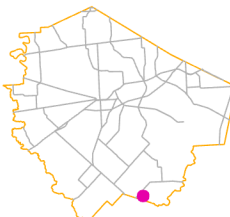

County Location Reference

A-248-K2

2021 Certified Tax Roll



Grid Page A-248-G1

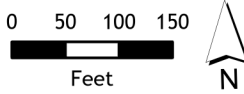

Fort Bend Central Appraisal District (FBCAD) is not authorized to determine legal title to property or establish the legal boundaries of property. FBCAD establishes appraisal records based on information from various sources, including but not limited to deeds, plats and surveys provided to but not created by the district. FBCAD is not responsible for errors or omissions in information submitted to and reviewed by the district. If any errors or omission are detected, contact the GIS Department of the FBCAD.

NEEDVILLE
ISD
S05
A-662
JOHN STEWARDSON

G DUTY

A-248-F2

A-248-G2

| | | |
|----------|----------|----------|
| A-248-F4 | A-248-G3 | A-248-G4 |
| A-248-F2 | A-248-G1 | A-248-G2 |
| A-248-F4 | A-248-G3 | A-248-G4 |

Grid Location Reference



County Location Reference

2021 Certified Tax Roll



**Grid Page
A-248-G2**

**A-150
H N CLEVELAND**

**NEEDVILLE
ISD
S05**

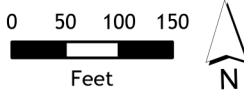

Fort Bend Central Appraisal District (FBCAD) is not authorized to determine legal title to property or establish the legal boundaries of property. FBCAD establishes appraisal records based on information from various sources, including but not limited to deeds, plats and surveys provided to but not created by the district. FBCAD is not responsible for errors or omissions in information submitted to and reviewed by the district. If any errors or omission are detected, contact the GIS Department of the FBCAD.

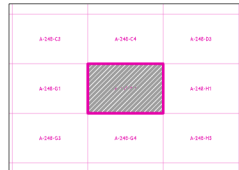

Grid Location Reference

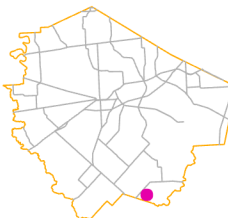

County Location Reference

2021 Certified Tax Roll



Grid Page
A-248-G3

A-662
JOHN STEWARDSON
NEEDVILLE
ISD
S05

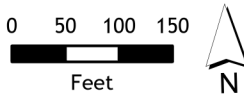

Fort Bend Central Appraisal District (FBCAD) is not authorized to determine legal title to property or establish the legal boundaries of property. FBCAD establishes appraisal records based on information from various sources, including but not limited to deeds, plats and surveys provided to but not created by the district. FBCAD is not responsible for errors or omissions in information submitted to and reviewed by the district. If any errors or omission are detected, contact the GIS Department of the FBCAD.

| | | |
|----------|----------|----------|
| A-248-F2 | A-248-G1 | A-248-G2 |
| A-248-F4 | A-248-G3 | A-248-G4 |
| A-248-G2 | A-248-L1 | A-248-L2 |

Grid Location Reference

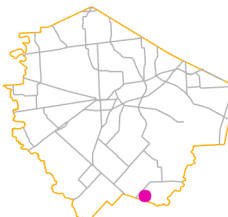

County Location Reference

2021 Certified Tax Roll



Grid Page
A-248-G4

A-150
H N CLEVELAND

NEEDVILLE
ISD
S05

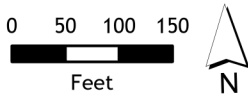

Fort Bend Central Appraisal District (FBCAD) is not authorized to determine legal title to property or establish the legal boundaries of property. FBCAD establishes appraisal records based on information from various sources, including but not limited to deeds, plats and surveys provided to but not created by the district. FBCAD is not responsible for errors or omissions in information submitted to and reviewed by the district. If any errors or omission are detected, contact the GIS Department of the FBCAD.

| | | |
|----------|----------|----------|
| A-248-G1 | A-248-G2 | A-248-G3 |
| A-248-G3 | A-248-G4 | A-248-G5 |
| A-248-G6 | A-248-G7 | A-248-G8 |

Grid Location Reference

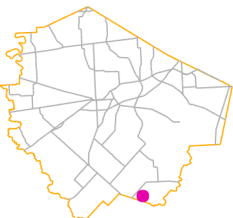

County Location Reference

BIG ISLAND RD

2021 Certified Tax Roll



**Grid Page
A-248-H1**

**A-150
H N CLEVELAND**

**NEEDVILLE
ISD
S05**

**2830
298.572 AC**

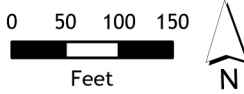

Fort Bend Central Appraisal District (FBCAD) is not authorized to determine legal title to property or establish the legal boundaries of property. FBCAD establishes appraisal records based on information from various sources, including but not limited to deeds, plats and surveys provided to but not created by the district. FBCAD is not responsible for errors or omissions in information submitted to and reviewed by the district. If any errors or omission are detected, contact the GIS Department of the FBCAD.

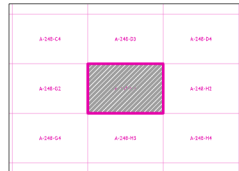

Grid Location Reference

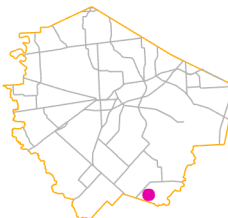

County Location Reference

2021 Certified Tax Roll



**Grid Page
A-248-H2**

**A-150
H N CLEVELAND**

**NEEDVILLE
ISD
S05**

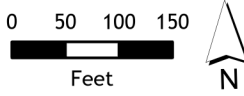

Fort Bend Central Appraisal District (FBCAD) is not authorized to determine legal title to property or establish the legal boundaries of property. FBCAD establishes appraisal records based on information from various sources, including but not limited to deeds, plats and surveys provided to but not created by the district. FBCAD is not responsible for errors or omissions in information submitted to and reviewed by the district. If any errors or omission are detected, contact the GIS Department of the FBCAD.

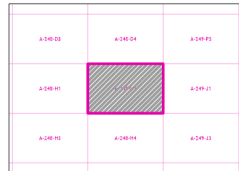

Grid Location Reference

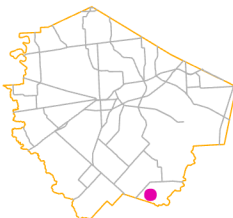

County Location Reference



**Grid Page
A-248-H3**

2833

**A-150 NEEDVILLE
H N CLEVELAND ISD
S05**

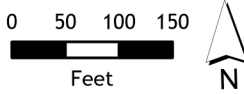

Fort Bend Central Appraisal District (FBCAD) is not authorized to determine legal title to property or establish the legal boundaries of property. FBCAD establishes appraisal records based on information from various sources, including but not limited to deeds, plats and surveys provided to but not created by the district. FBCAD is not responsible for errors or omissions in information submitted to and reviewed by the district. If any errors or omission are detected, contact the GIS Department of the FBCAD.

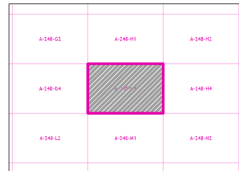

Grid Location Reference

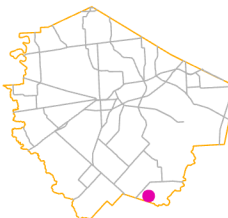

County Location Reference

BIG ISLAND RD



**Grid Page
A-248-H4**

**A-150
H N CLEVELAND**

**NEEDVILLE
ISD
S05**

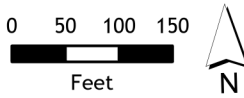

Fort Bend Central Appraisal District (FBCAD) is not authorized to determine legal title to property or establish the legal boundaries of property. FBCAD establishes appraisal records based on information from various sources, including but not limited to deeds, plats and surveys provided to but not created by the district. FBCAD is not responsible for errors or omissions in information submitted to and reviewed by the district. If any errors or omission are detected, contact the GIS Department of the FBCAD.

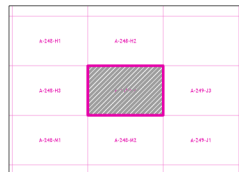

Grid Location Reference

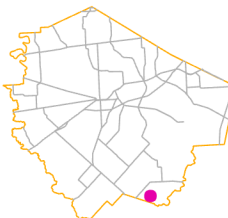

County Location Reference

BIG ISLAND RD

A-259
H & TC RR SEC 117

A-248-E3

0275

0270
7.452 AC

0271
8.45 AC

0034

0037

0350
8.452 AC

A-449
DAY LAND & CATTLE

0035

NEEDVILLE
ISD
S05

0036

0026
9.57 AC

0027
8.351 AC

A-248-J3

2021 Certified Tax Roll



Grid Page
A-248-J1

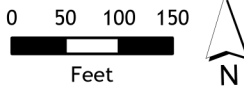

Fort Bend Central Appraisal District (FBCAD) is not authorized to determine legal title to property or establish the legal boundaries of property. FBCAD establishes appraisal records based on information from various sources, including but not limited to deeds, plats and surveys provided to but not created by the district. FBCAD is not responsible for errors or omissions in information submitted to and reviewed by the district. If any errors or omission are detected, contact the GIS Department of the FBCAD.

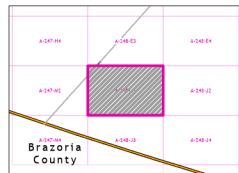

Grid Location Reference

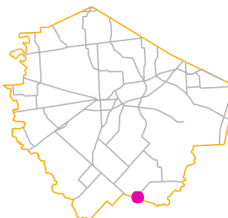

County Location Reference

A-247-M2

A-248-J2

FM 1462 RD

2021 Certified Tax Roll



Grid Page
A-248-J2



Fort Bend Central Appraisal District (FBCAD) is not authorized to determine legal title to property or establish the legal boundaries of property. FBCAD establishes appraisal records based on information from various sources, including but not limited to deeds, plats and surveys provided to but not created by the district. FBCAD is not responsible for errors or omissions in information submitted to and reviewed by the district. If any errors or omission are detected, contact the GIS Department of the FBCAD.

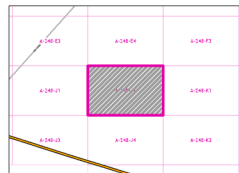

Grid Location Reference

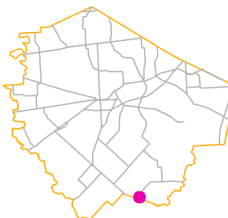

County Location Reference

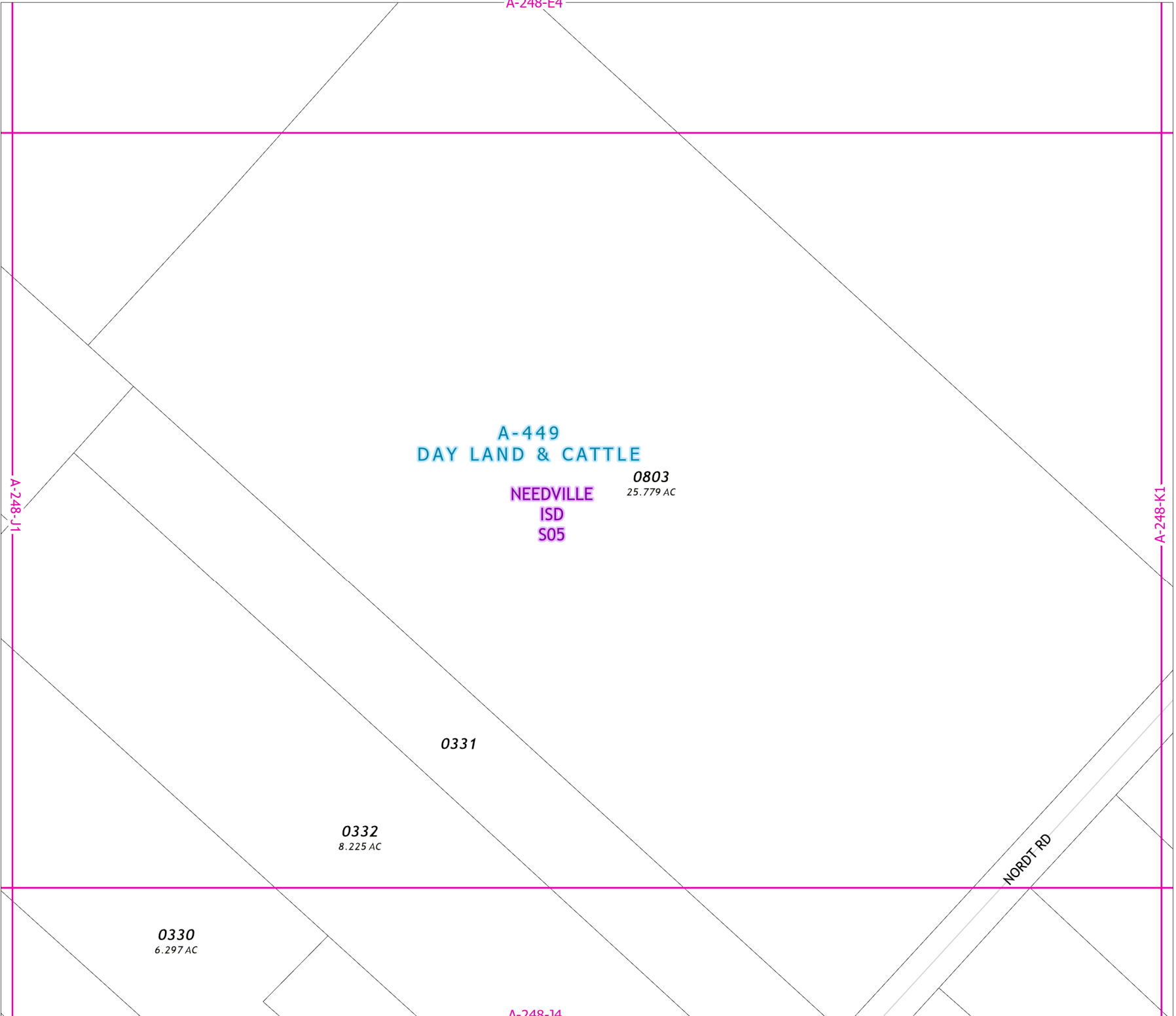

2021 Certified Tax Roll



Grid Page
A-248-J3



Fort Bend Central Appraisal District (FBCAD) is not authorized to determine legal title to property or establish the legal boundaries of property. FBCAD establishes appraisal records based on information from various sources, including but not limited to deeds, plats and surveys provided to but not created by the district. FBCAD is not responsible for errors or omissions in information submitted to and reviewed by the district. If any errors or omission are detected, contact the GIS Department of the FBCAD.

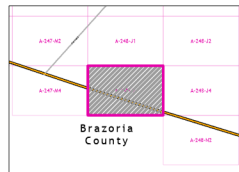

Grid Location Reference

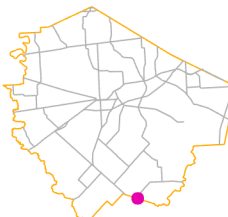

County Location Reference

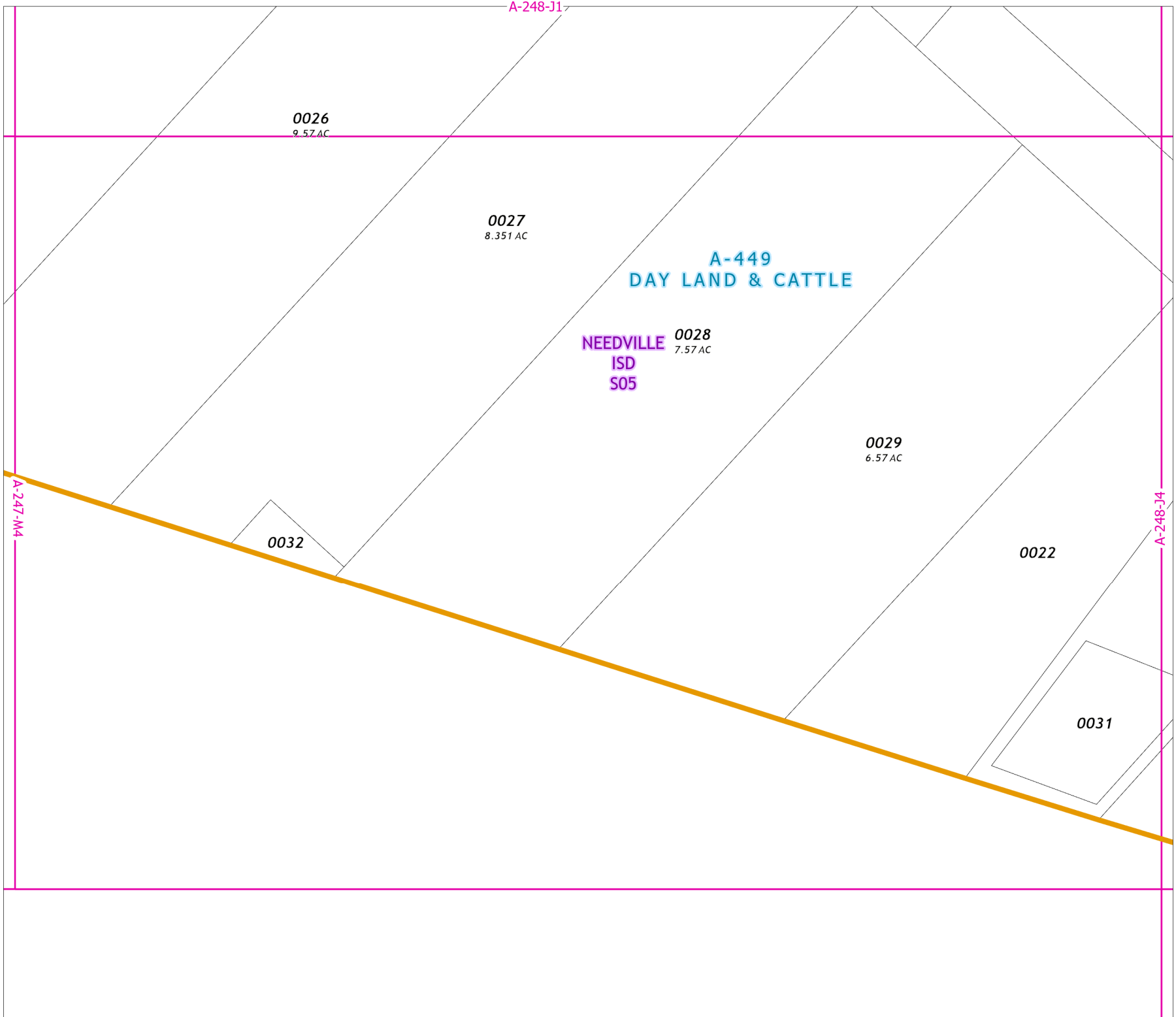

2021 Certified Tax Roll



Grid Page
A-248-J4



Fort Bend Central Appraisal District (FBCAD) is not authorized to determine legal title to property or establish the legal boundaries of property. FBCAD establishes appraisal records based on information from various sources, including but not limited to deeds, plats and surveys provided to but not created by the district. FBCAD is not responsible for errors or omissions in information submitted to and reviewed by the district. If any errors or omission are detected, contact the GIS Department of the FBCAD.

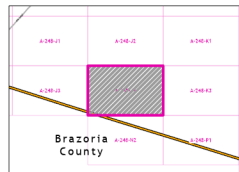

Grid Location Reference

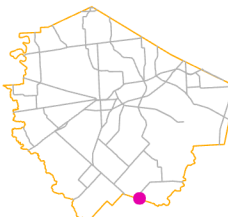

County Location Reference

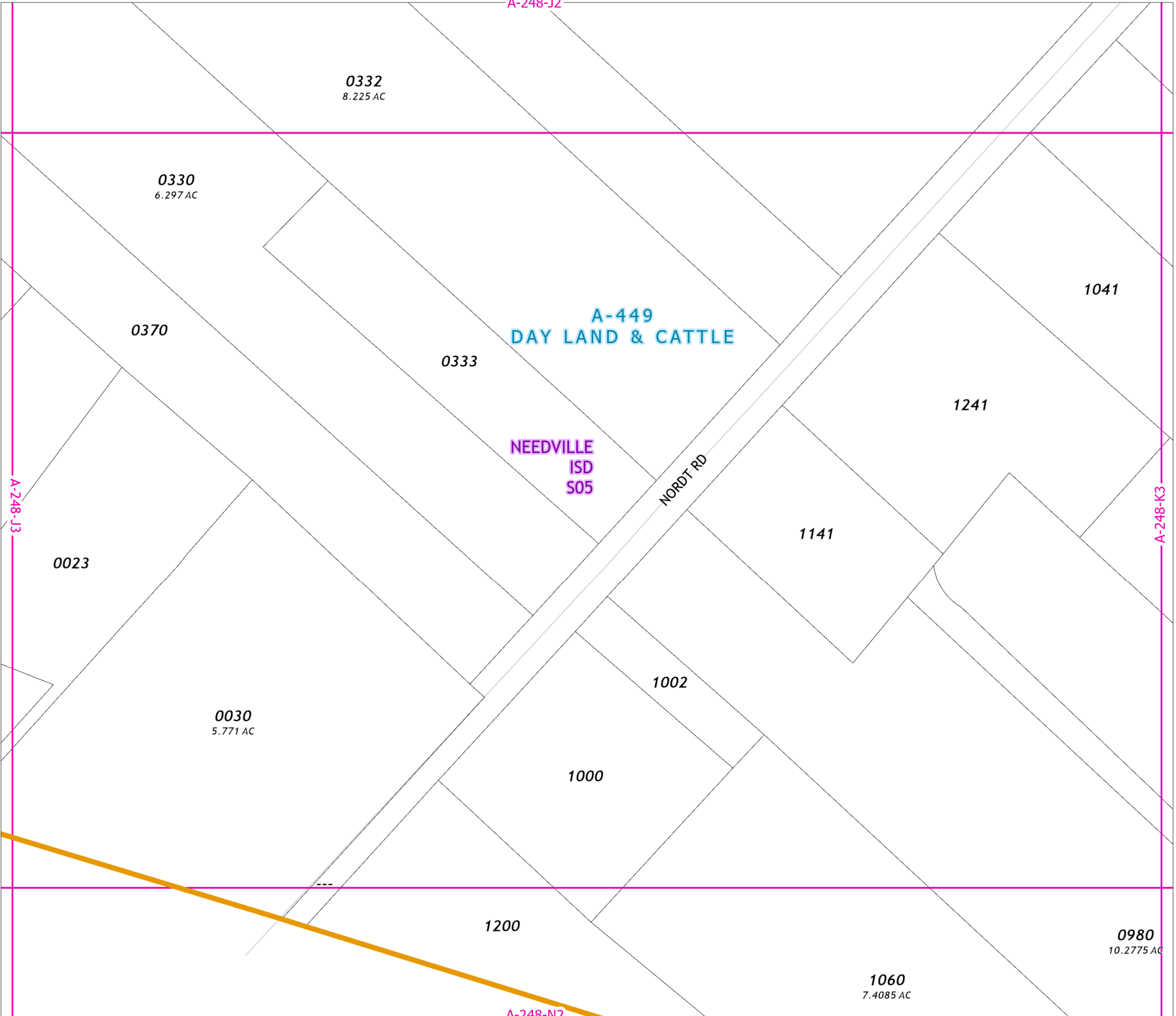

2021 Certified Tax Roll



**Grid Page
A-248-K1**

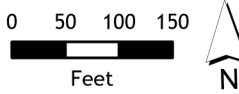

1490
95.74 AC

Fort Bend Central Appraisal District (FBCAD) is not authorized to determine legal title to property or establish the legal boundaries of property. FBCAD establishes appraisal records based on information from various sources, including but not limited to deeds, plats and surveys provided to but not created by the district. FBCAD is not responsible for errors or omissions in information submitted to and reviewed by the district. If any errors or omission are detected, contact the GIS Department of the FBCAD.

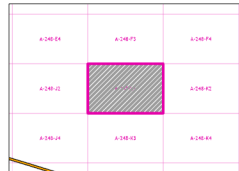

Grid Location Reference

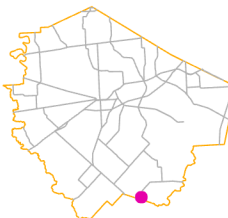

County Location Reference

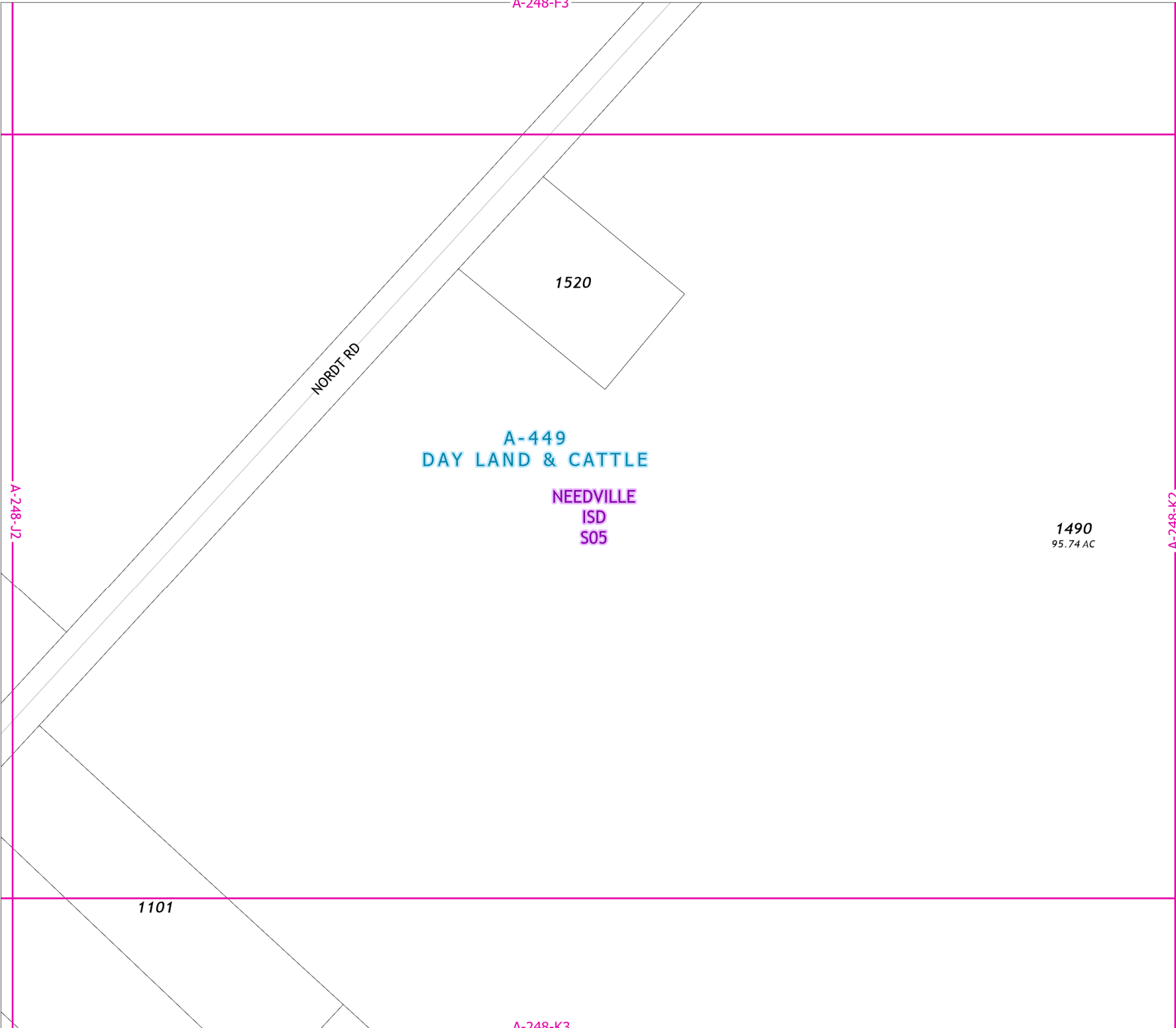

2021 Certified Tax Roll



Grid Page
A-248-K2

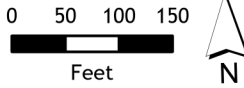

Fort Bend Central Appraisal District (FBCAD) is not authorized to determine legal title to property or establish the legal boundaries of property. FBCAD establishes appraisal records based on information from various sources, including but not limited to deeds, plats and surveys provided to but not created by the district. FBCAD is not responsible for errors or omissions in information submitted to and reviewed by the district. If any errors or omission are detected, contact the GIS Department of the FBCAD.

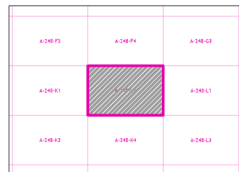

Grid Location Reference



County Location Reference

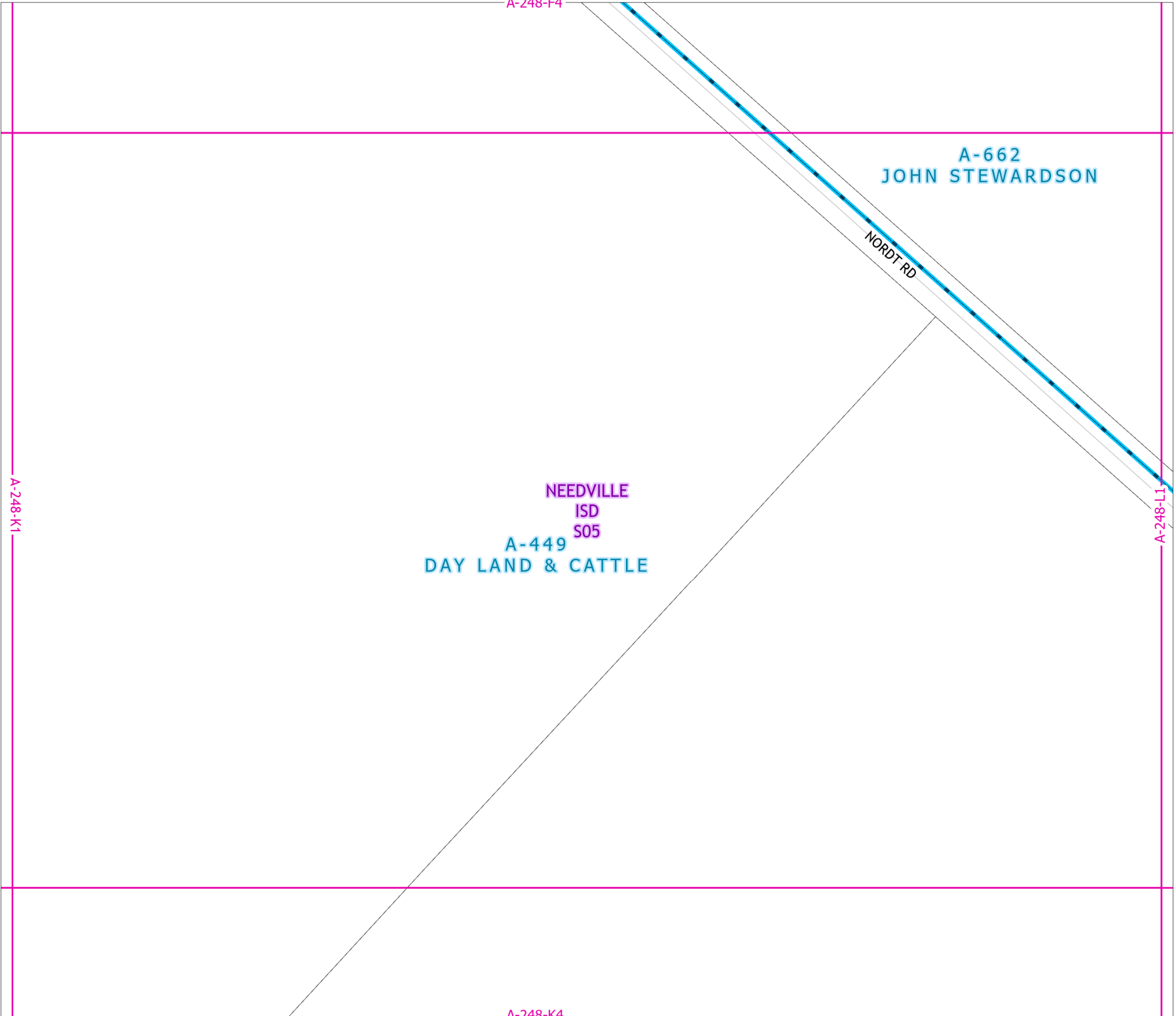



**A-449
DAY LAND & CATTLE**

**NEEDVILLE
ISD
S05**

1101

**1180
10.554 AC**

**1100
7.1 AC**

**1040
8.55 AC**

**1240
8.55 AC**

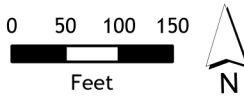

Fort Bend Central Appraisal District (FBCAD) is not authorized to determine legal title to property or establish the legal boundaries of property. FBCAD establishes appraisal records based on information from various sources, including but not limited to deeds, plats and surveys provided to but not created by the district. FBCAD is not responsible for errors or omissions in information submitted to and reviewed by the district. If any errors or omission are detected, contact the GIS Department of the FBCAD.

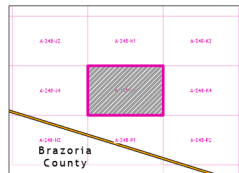

Grid Location Reference

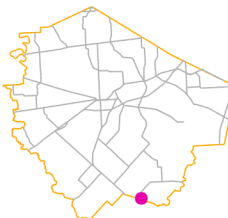

County Location Reference

2021 Certified Tax Roll



**Grid Page
A-248-K4**

**A-449
DAY LAND & CATTLE**

**NEEDVILLE
ISD
S05**

**1890
121.23 AC**

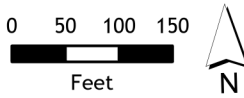

Fort Bend Central Appraisal District (FBCAD) is not authorized to determine legal title to property or establish the legal boundaries of property. FBCAD establishes appraisal records based on information from various sources, including but not limited to deeds, plats and surveys provided to but not created by the district. FBCAD is not responsible for errors or omissions in information submitted to and reviewed by the district. If any errors or omission are detected, contact the GIS Department of the FBCAD.

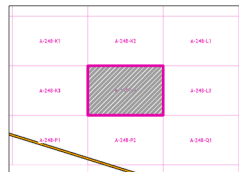

Grid Location Reference

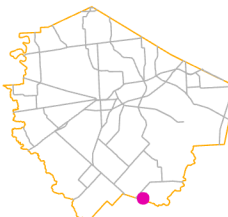

County Location Reference

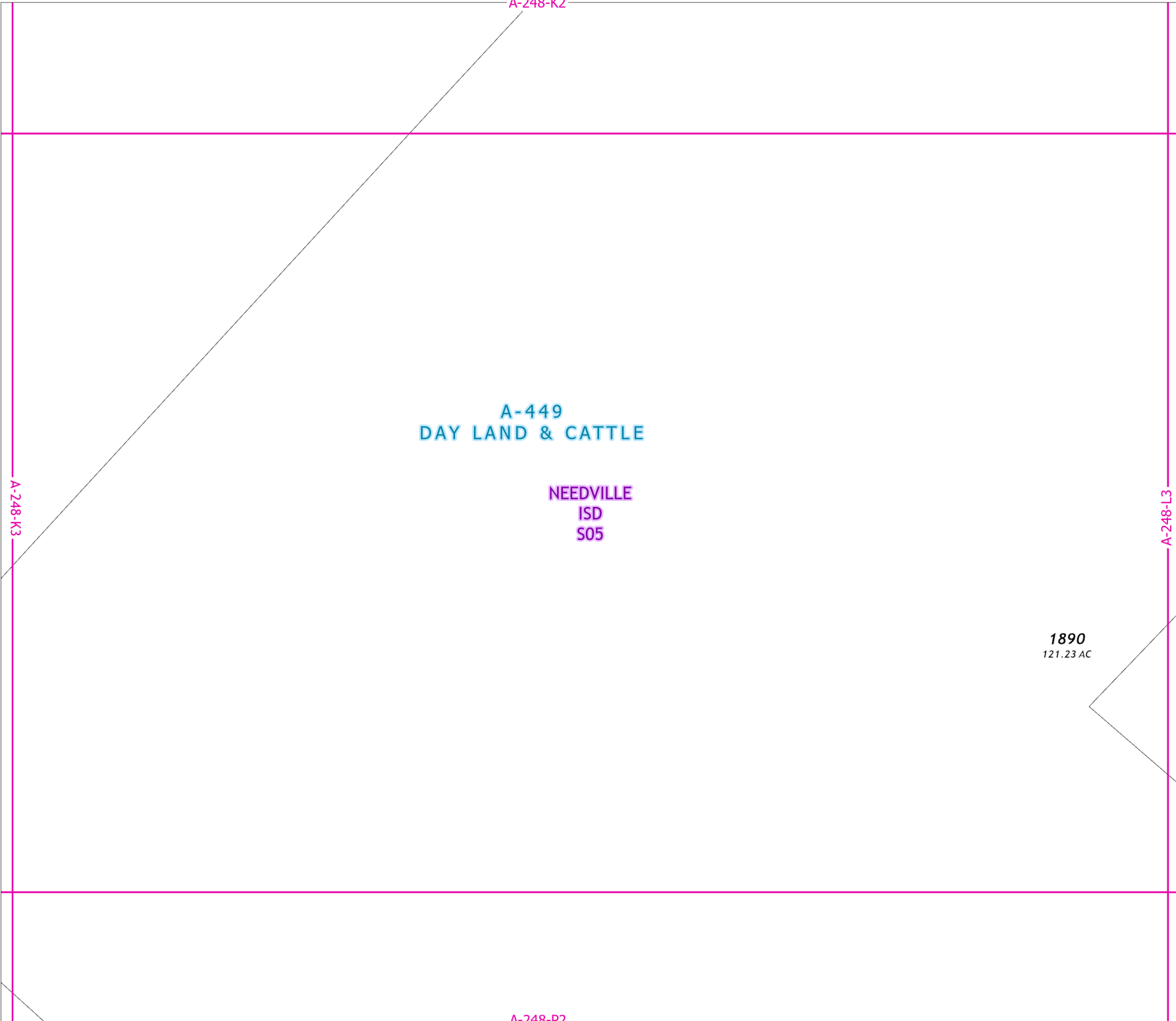

A-248-G3

2021 Certified Tax Roll



Grid Page
A-248-L1

A-662
JOHN STEWARDSON
NEEDVILLE
ISD
S05

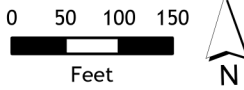

Fort Bend Central Appraisal District (FBCAD) is not authorized to determine legal title to property or establish the legal boundaries of property. FBCAD establishes appraisal records based on information from various sources, including but not limited to deeds, plats and surveys provided to but not created by the district. FBCAD is not responsible for errors or omissions in information submitted to and reviewed by the district. If any errors or omission are detected, contact the GIS Department of the FBCAD.

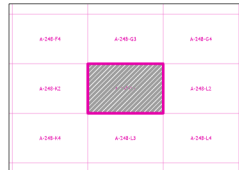

Grid Location Reference



County Location Reference

A-248-K2

A-248-L2

G DUTY

NORDT RD

A-449
DAY LAND & CATTLE

A-248-L3



**Grid Page
A-248-L2**

BIG ISLAND RD

**A-150 NEEDVILLE
H N CLEVELAND ISD
S05**

A-248-L1

A-248-M1

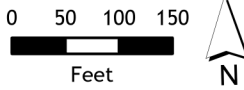

Fort Bend Central Appraisal District (FBCAD) is not authorized to determine legal title to property or establish the legal boundaries of property. FBCAD establishes appraisal records based on information from various sources, including but not limited to deeds, plats and surveys provided to but not created by the district. FBCAD is not responsible for errors or omissions in information submitted to and reviewed by the district. If any errors or omission are detected, contact the GIS Department of the FBCAD.

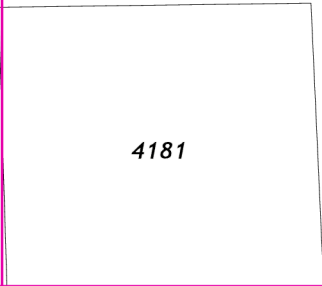

4181

| | | |
|----------|----------|----------|
| A-248-G3 | A-248-G4 | A-248-G5 |
| A-248-L3 | A-248-L2 | A-248-L1 |
| A-248-L3 | A-248-L4 | A-248-L5 |

Grid Location Reference

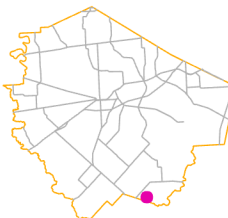

County Location Reference

2021 Certified Tax Roll



Grid Page
A-248-L3



Fort Bend Central Appraisal District (FBCAD) is not authorized to determine legal title to property or establish the legal boundaries of property. FBCAD establishes appraisal records based on information from various sources, including but not limited to deeds, plats and surveys provided to but not created by the district. FBCAD is not responsible for errors or omissions in information submitted to and reviewed by the district. If any errors or omissions are detected, contact the GIS Department of the FBCAD.

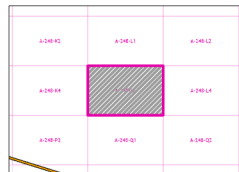

Grid Location Reference

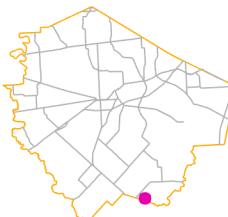

County Location Reference

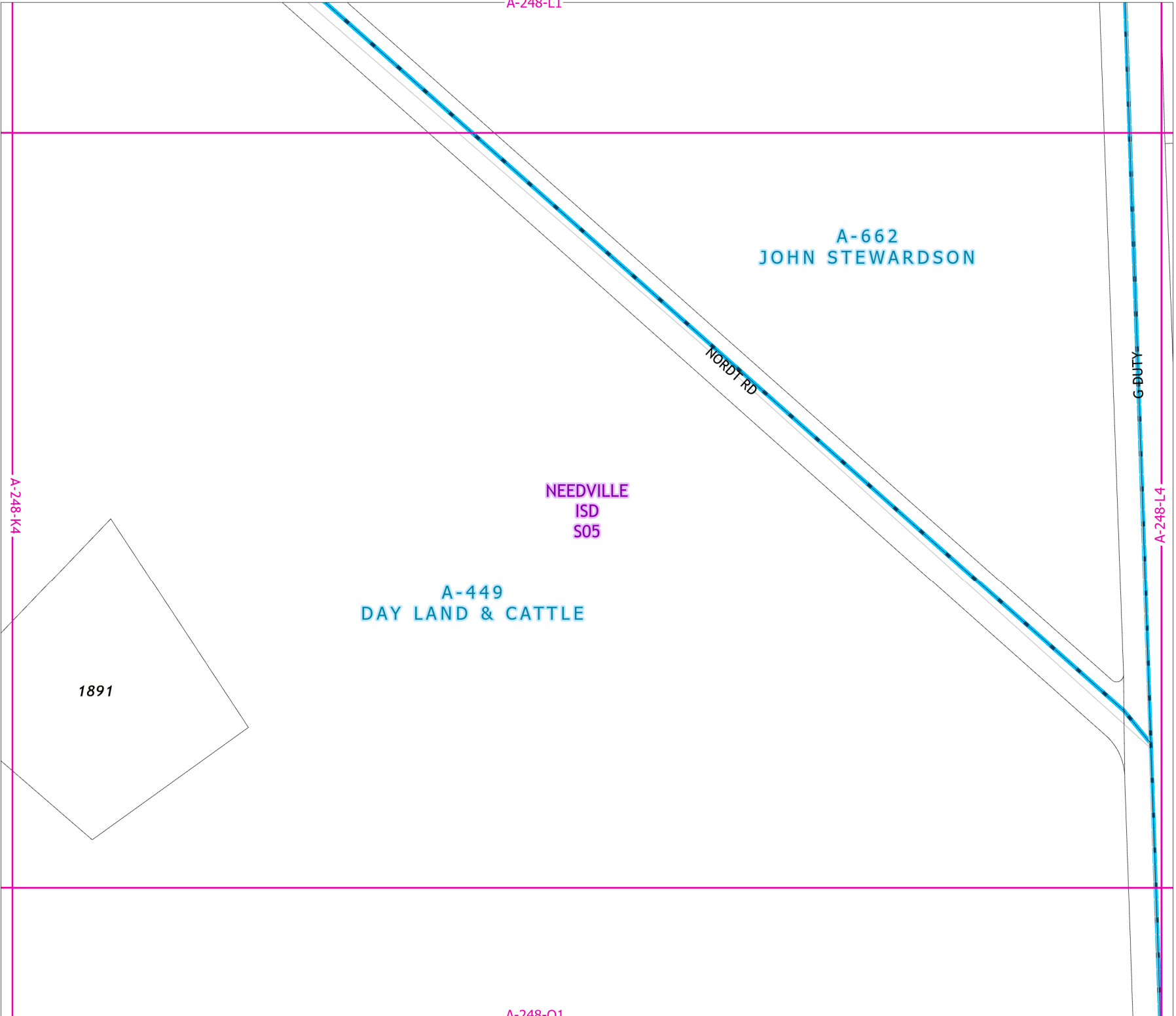

A-248-L2

4181

4180
123.5 AC

A-150
H N CLEVELAND

NEEDVILLE
ISD
S05

A-248-L3

A-248-M3

A-248-Q2

2021 Certified Tax Roll



Grid Page
A-248-L4

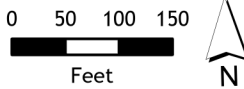

Fort Bend Central Appraisal District (FBCAD) is not authorized to determine legal title to property or establish the legal boundaries of property. FBCAD establishes appraisal records based on information from various sources, including but not limited to deeds, plats and surveys provided to but not created by the district. FBCAD is not responsible for errors or omissions in information submitted to and reviewed by the district. If any errors or omission are detected, contact the GIS Department of the FBCAD.

| | | |
|----------|----------|----------|
| A-248-L1 | A-248-L2 | A-248-L3 |
| A-248-L3 | A-248-L4 | A-248-L5 |
| A-248-Q1 | A-248-Q2 | A-248-Q3 |

Grid Location Reference



County Location Reference

A-248-H3

BIG ISLAND RD

A-150 NEEDVILLE
H N CLEVELAND ISD S05

A-248-L2

A-248-M2

A-248-M3

2021 Certified Tax Roll



Grid Page
A-248-M1

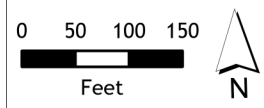

Fort Bend Central Appraisal District (FBCAD) is not authorized to determine legal title to property or establish the legal boundaries of property. FBCAD establishes appraisal records based on information from various sources, including but not limited to deeds, plats and surveys provided to but not created by the district. FBCAD is not responsible for errors or omissions in information submitted to and reviewed by the district. If any errors or omission are detected, contact the GIS Department of the FBCAD.

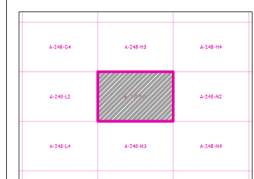

Grid Location Reference

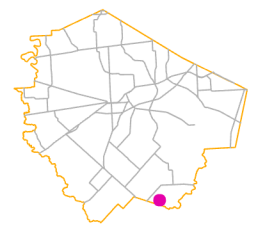

County Location Reference

2021 Certified Tax Roll



Grid Page
A-248-M2



Fort Bend Central Appraisal District (FBCAD) is not authorized to determine legal title to property or establish the legal boundaries of property. FBCAD establishes appraisal records based on information from various sources, including but not limited to deeds, plats and surveys provided to but not created by the district. FBCAD is not responsible for errors or omissions in information submitted to and reviewed by the district. If any errors or omission are detected, contact the GIS Department of the FBCAD.

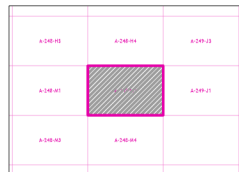

Grid Location Reference



County Location Reference

A-248-H4

BIG ISLAND RD

A-150
H N CLEVELAND

NEEDVILLE
ISD
S05

4780
195.65 AC

A-248-M4

A-248-M1

A-249-J1

2021 Certified Tax Roll



**Grid Page
A-248-M3**

**A-150
H N CLEVELAND**

**NEEDVILLE
ISD
S05**

A-248-L4

A-248-M4

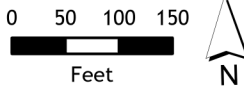

Fort Bend Central Appraisal District (FBCAD) is not authorized to determine legal title to property or establish the legal boundaries of property. FBCAD establishes appraisal records based on information from various sources, including but not limited to deeds, plats and surveys provided to but not created by the district. FBCAD is not responsible for errors or omissions in information submitted to and reviewed by the district. If any errors or omission are detected, contact the GIS Department of the FBCAD.

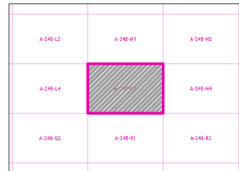

Grid Location Reference

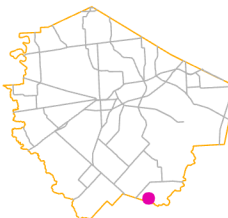

County Location Reference

2021 Certified Tax Roll



**Grid Page
A-248-M4**

4780
195.65 AC

**A-150
H N CLEVELAND**

**NEEDVILLE
ISD
S05**

A-248-M3

A-249-J3

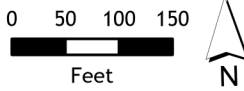

Fort Bend Central Appraisal District (FBCAD) is not authorized to determine legal title to property or establish the legal boundaries of property. FBCAD establishes appraisal records based on information from various sources, including but not limited to deeds, plats and surveys provided to but not created by the district. FBCAD is not responsible for errors or omissions in information submitted to and reviewed by the district. If any errors or omission are detected, contact the GIS Department of the FBCAD.

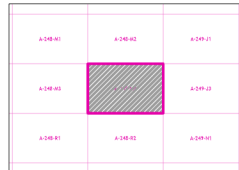

Grid Location Reference



County Location Reference

2021 Certified Tax Roll



Grid Page
A-248-N2



Fort Bend Central Appraisal District (FBCAD) is not authorized to determine legal title to property or establish the legal boundaries of property. FBCAD establishes appraisal records based on information from various sources, including but not limited to deeds, plats and surveys provided to but not created by the district. FBCAD is not responsible for errors or omissions in information submitted to and reviewed by the district. If any errors or omission are detected, contact the GIS Department of the FBCAD.

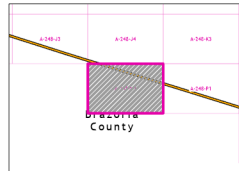

Grid Location Reference

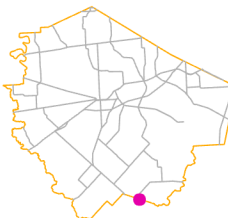

County Location Reference

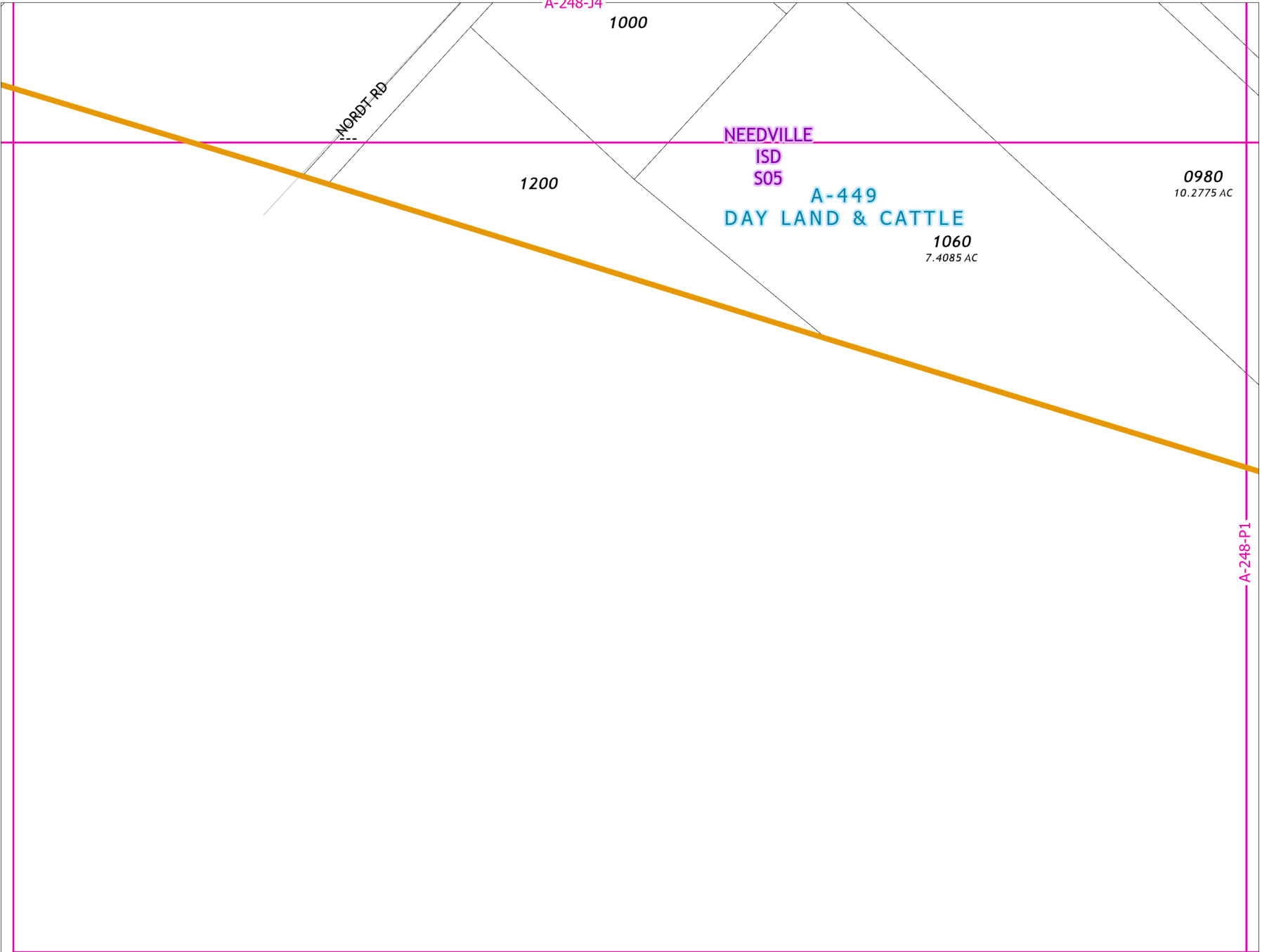

2021 Certified Tax Roll



Grid Page
A-248-P1



Fort Bend Central Appraisal District (FBCAD) is not authorized to determine legal title to property or establish the legal boundaries of property. FBCAD establishes appraisal records based on information from various sources, including but not limited to deeds, plats and surveys provided to but not created by the district. FBCAD is not responsible for errors or omissions in information submitted to and reviewed by the district. If any errors or omission are detected, contact the GIS Department of the FBCAD.

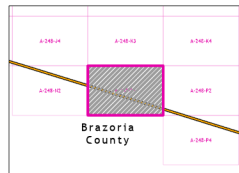

Grid Location Reference

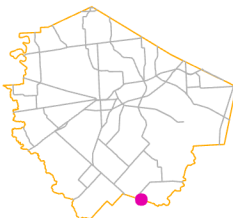

County Location Reference

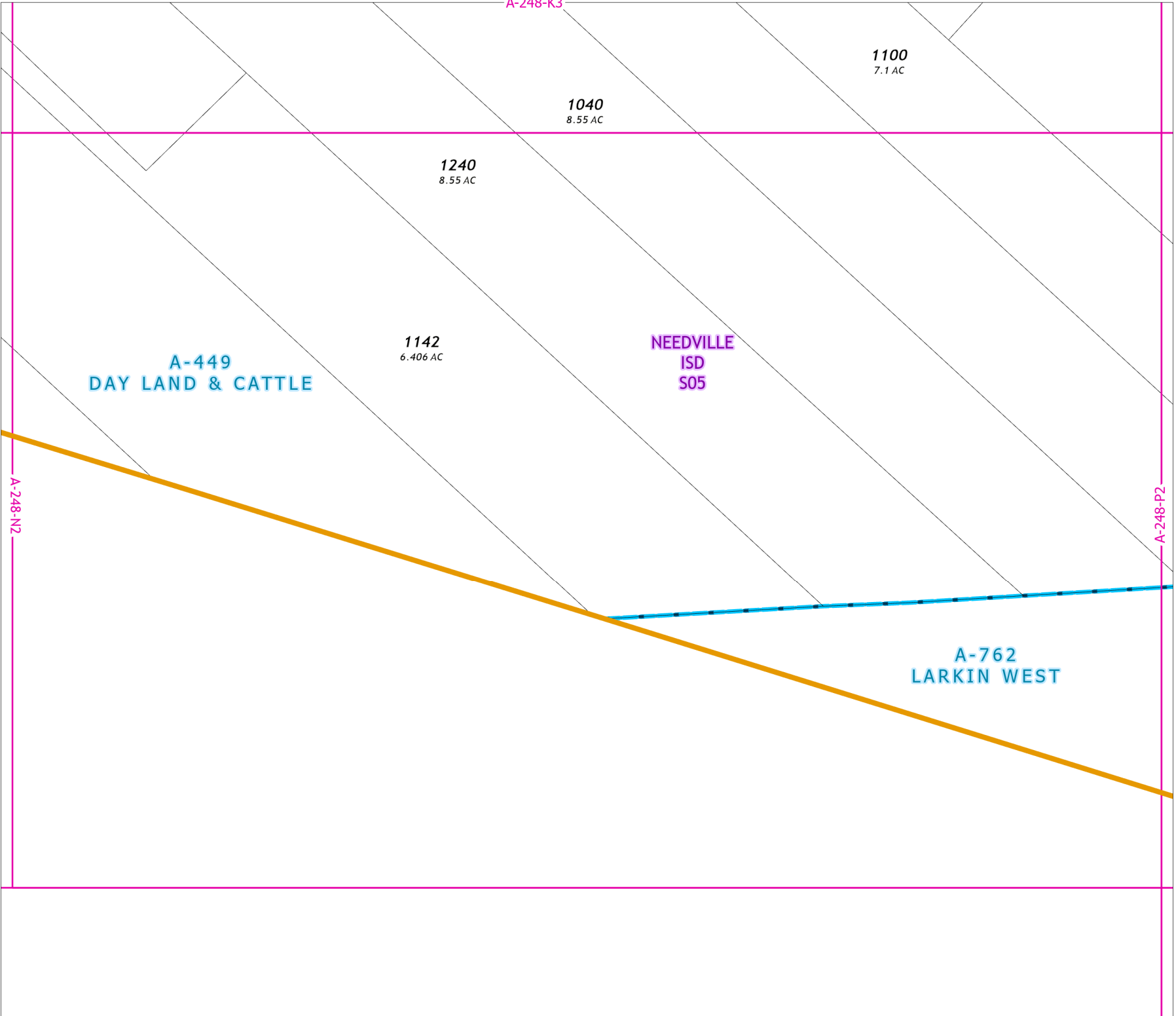

A-248-K4

2021 Certified Tax Roll



Grid Page
A-248-P2

A-449
DAY LAND & CATTLE

NEEDVILLE
ISD
S05

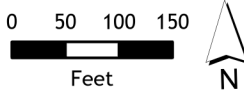

Fort Bend Central Appraisal District (FBCAD) is not authorized to determine legal title to property or establish the legal boundaries of property. FBCAD establishes appraisal records based on information from various sources, including but not limited to deeds, plats and surveys provided to but not created by the district. FBCAD is not responsible for errors or omissions in information submitted to and reviewed by the district. If any errors or omission are detected, contact the GIS Department of the FBCAD.

A-248-P1

A-248-Q1

0090
10.14 AC

A-762
LARKIN WEST

0130
10.4 AC

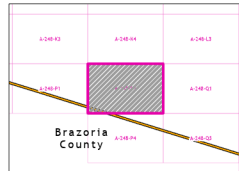

Grid Location Reference

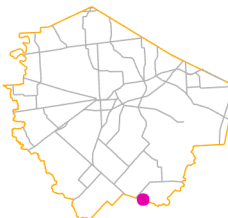

County Location Reference

A-248-P4

A-248-P2

0130
10.4 AC

NEEDVILLE
ISD
S05

A-762
LARKIN WEST

2021 Certified Tax Roll



Grid Page
A-248-P4

A-248-Q3

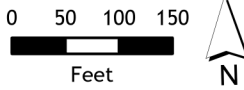

Fort Bend Central Appraisal District (FBCAD) is not authorized to determine legal title to property or establish the legal boundaries of property. FBCAD establishes appraisal records based on information from various sources, including but not limited to deeds, plats and surveys provided to but not created by the district. FBCAD is not responsible for errors or omissions in information submitted to and reviewed by the district. If any errors or omission are detected, contact the GIS Department of the FBCAD.

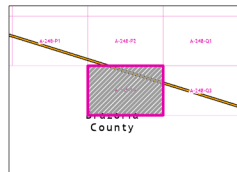

Grid Location Reference



County Location Reference

A-248-L3

2021 Certified Tax Roll



Grid Page
A-248-Q1

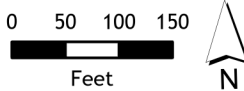

Fort Bend Central Appraisal District (FBCAD) is not authorized to determine legal title to property or establish the legal boundaries of property. FBCAD establishes appraisal records based on information from various sources, including but not limited to deeds, plats and surveys provided to but not created by the district. FBCAD is not responsible for errors or omissions in information submitted to and reviewed by the district. If any errors or omission are detected, contact the GIS Department of the FBCAD.

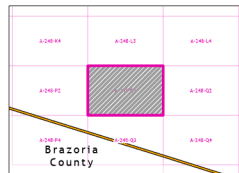

Grid Location Reference

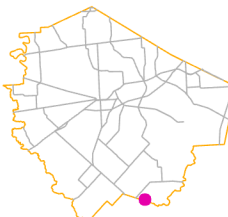

County Location Reference

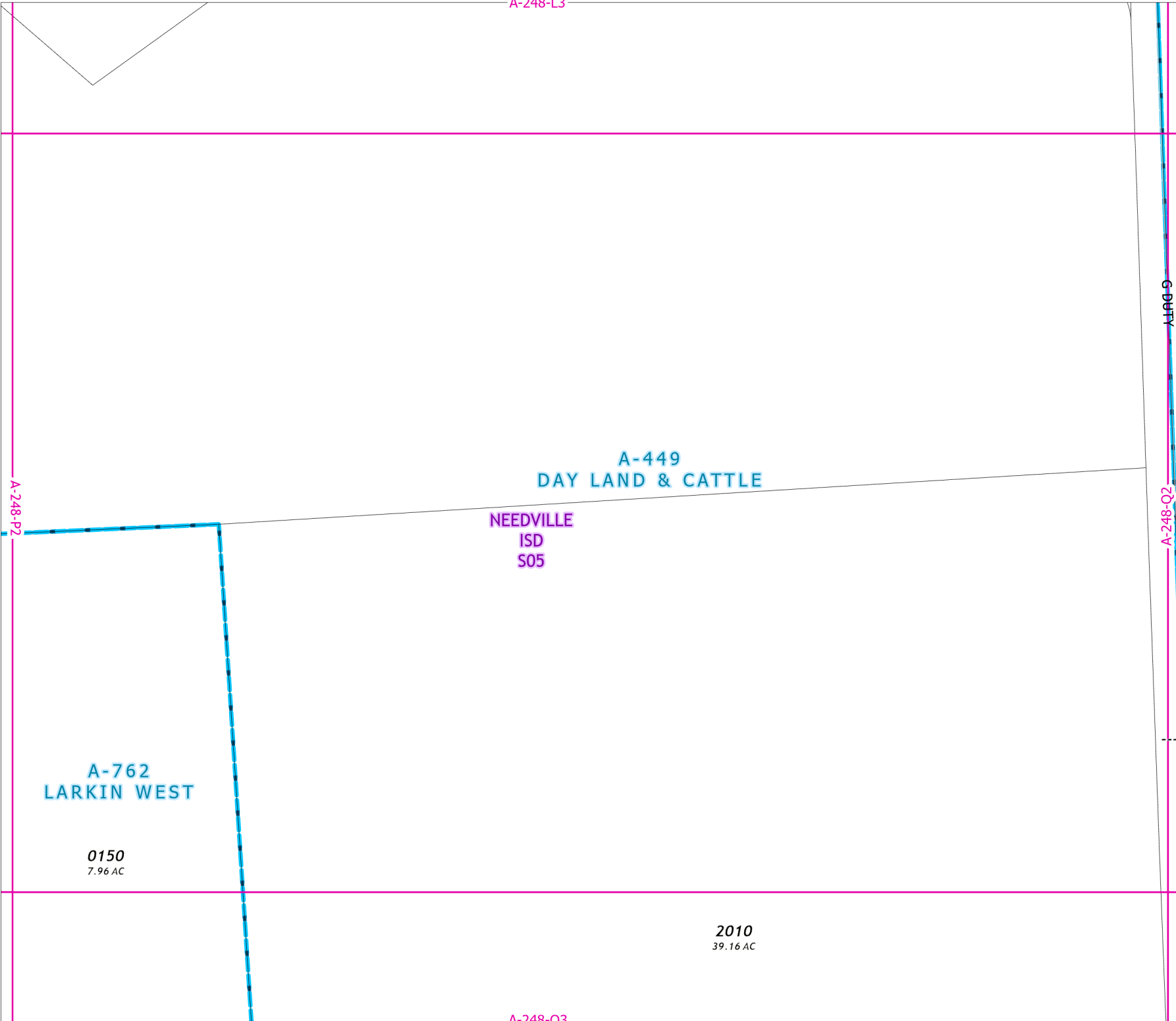

2021 Certified Tax Roll



**Grid Page
A-248-Q2**

5642

5641
9 AC

**A-150
H N CLEVELAND**

**NEEDVILLE
ISD
S05**

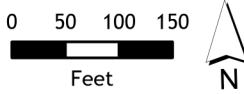

Fort Bend Central Appraisal District (FBCAD) is not authorized to determine legal title to property or establish the legal boundaries of property. FBCAD establishes appraisal records based on information from various sources, including but not limited to deeds, plats and surveys provided to but not created by the district. FBCAD is not responsible for errors or omissions in information submitted to and reviewed by the district. If any errors or omission are detected, contact the GIS Department of the FBCAD.

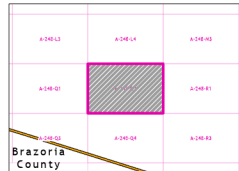

Grid Location Reference

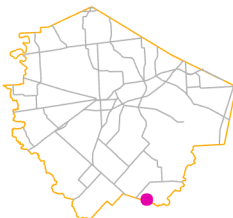

County Location Reference

2021 Certified Tax Roll



Grid Page
A-248-Q3



Fort Bend Central Appraisal District (FBCAD) is not authorized to determine legal title to property or establish the legal boundaries of property. FBCAD establishes appraisal records based on information from various sources, including but not limited to deeds, plats and surveys provided to but not created by the district. FBCAD is not responsible for errors or omissions in information submitted to and reviewed by the district. If any errors or omission are detected, contact the GIS Department of the FBCAD.

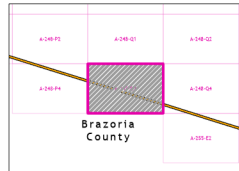

Grid Location Reference

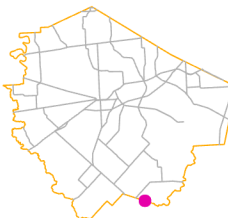

County Location Reference

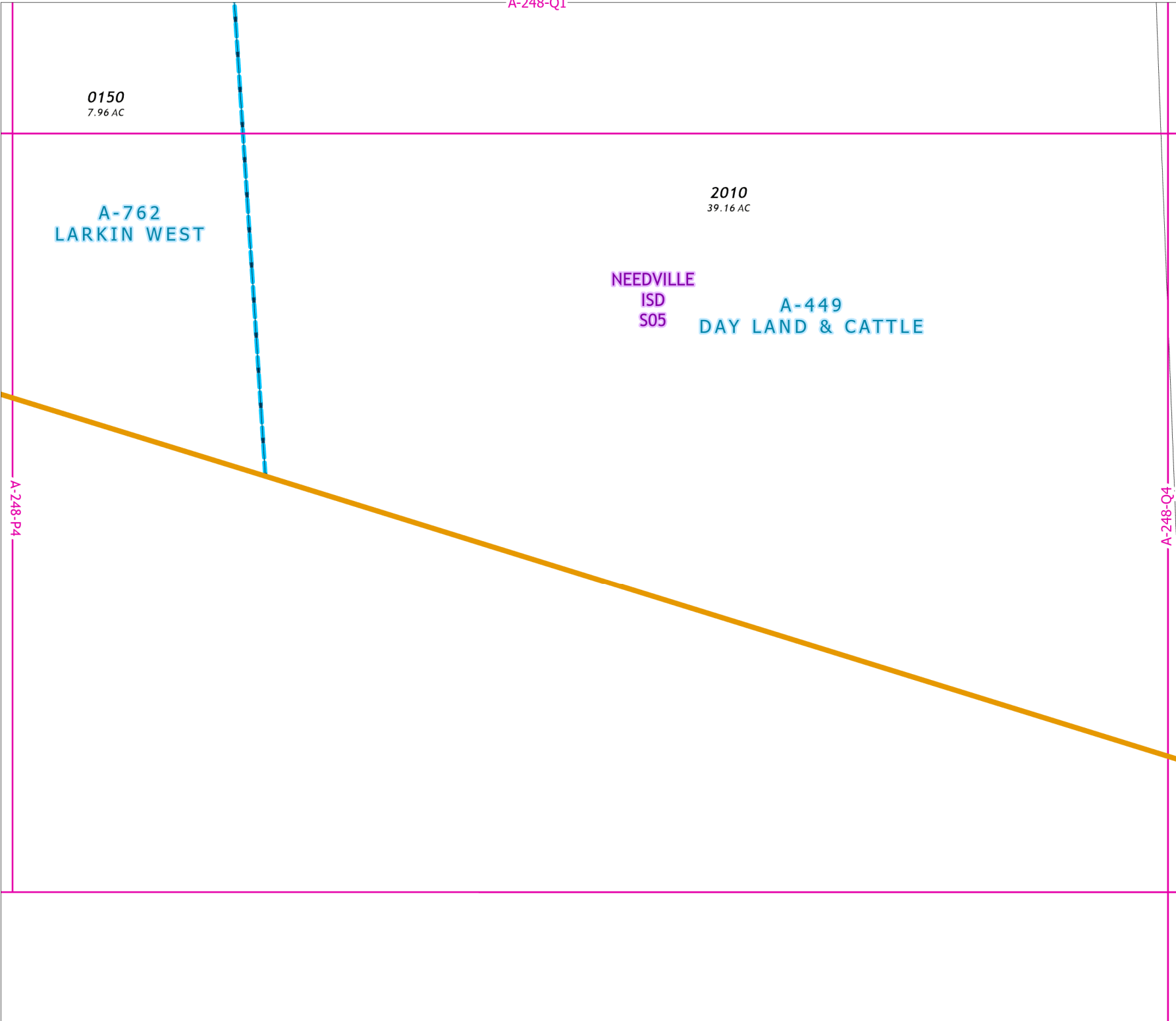



Grid Page
A-248-Q4

G DUTY

A-248-Q3

A-248-R3

6601

NEEDVILLE
6602 ISD
S05

6600
12.21 AC

A-150
H N CLEVELAND

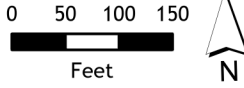

Fort Bend Central Appraisal District (FBCAD) is not authorized to determine legal title to property or establish the legal boundaries of property. FBCAD establishes appraisal records based on information from various sources, including but not limited to deeds, plats and surveys provided to but not created by the district. FBCAD is not responsible for errors or omissions in information submitted to and reviewed by the district. If any errors or omission are detected, contact the GIS Department of the FBCAD.

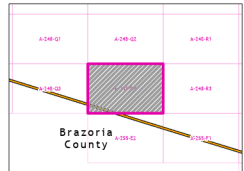

Grid Location Reference

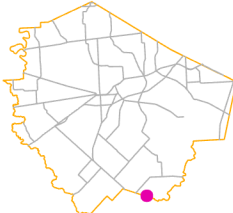

County Location Reference

A-248-M3

2021 Certified Tax Roll



Grid Page
A-248-R1

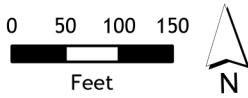

Fort Bend Central Appraisal District (FBCAD) is not authorized to determine legal title to property or establish the legal boundaries of property. FBCAD establishes appraisal records based on information from various sources, including but not limited to deeds, plats and surveys provided to but not created by the district. FBCAD is not responsible for errors or omissions in information submitted to and reviewed by the district. If any errors or omission are detected, contact the GIS Department of the FBCAD.

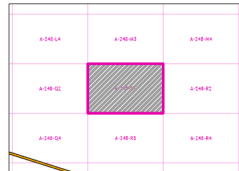

Grid Location Reference

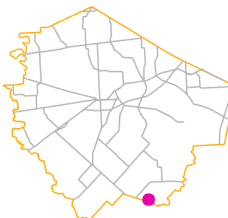

County Location Reference

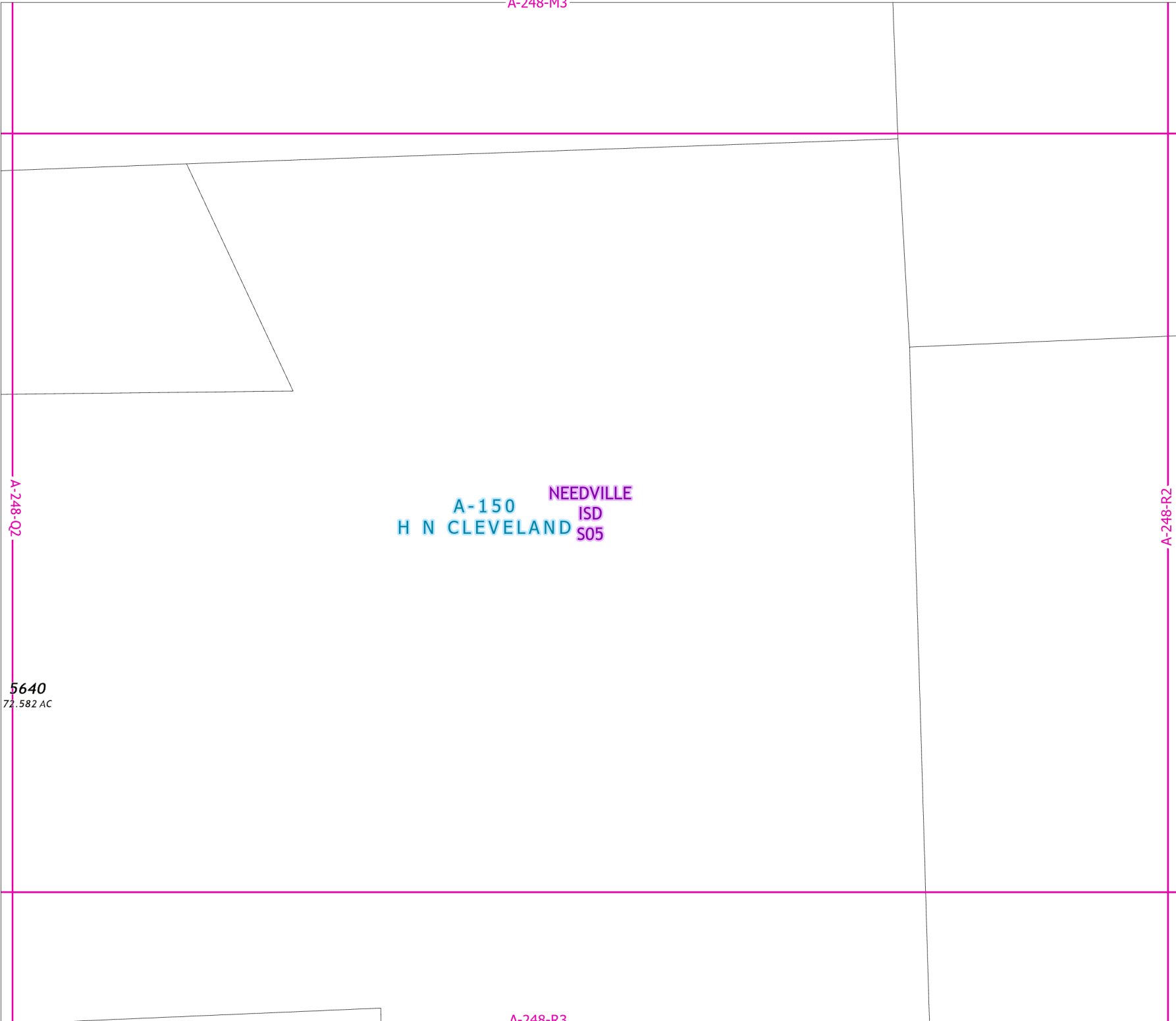

A-248-Q2

A-248-R2

A-150 NEEDVILLE
H N CLEVELAND ISD S05

5640
72.582 AC

A-248-R3

2021 Certified Tax Roll



**Grid Page
A-248-R2**

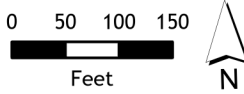

Fort Bend Central Appraisal District (FBCAD) is not authorized to determine legal title to property or establish the legal boundaries of property. FBCAD establishes appraisal records based on information from various sources, including but not limited to deeds, plats and surveys provided to but not created by the district. FBCAD is not responsible for errors or omissions in information submitted to and reviewed by the district. If any errors or omission are detected, contact the GIS Department of the FBCAD.

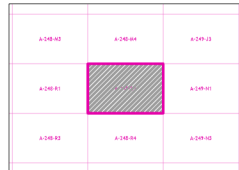

Grid Location Reference

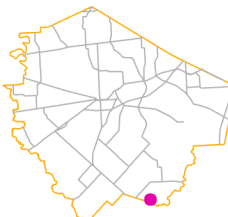

County Location Reference

**A-150
H N CLEVELAND**

**NEEDVILLE
ISD
S05**

**5810
50.42 AC**

A-248-R1

2021 Certified Tax Roll



Grid Page
A-248-R3

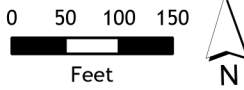

Fort Bend Central Appraisal District (FBCAD) is not authorized to determine legal title to property or establish the legal boundaries of property. FBCAD establishes appraisal records based on information from various sources, including but not limited to deeds, plats and surveys provided to but not created by the district. FBCAD is not responsible for errors or omissions in information submitted to and reviewed by the district. If any errors or omission are detected, contact the GIS Department of the FBCAD.

A-150 NEEDVILLE
H N CLEVELAND ISD
S05

A-248-Q4

A-248-R4

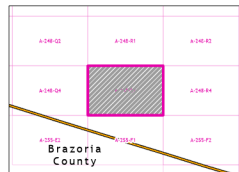

Grid Location Reference



County Location Reference

A-255-F1

A-248-R2

2021 Certified Tax Roll



Grid Page
A-248-R4

A-150
H N CLEVELAND
NEEDVILLE
ISD
S05

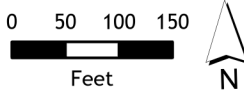

Fort Bend Central Appraisal District (FBCAD) is not authorized to determine legal title to property or establish the legal boundaries of property. FBCAD establishes appraisal records based on information from various sources, including but not limited to deeds, plats and surveys provided to but not created by the district. FBCAD is not responsible for errors or omissions in information submitted to and reviewed by the district. If any errors or omission are detected, contact the GIS Department of the FBCAD.

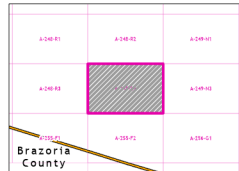

Grid Location Reference

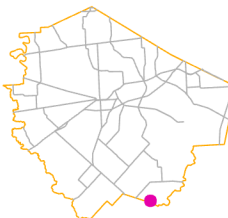

County Location Reference

6900
151.361 AC

A-255-F2

A-248-R3

A-249-N3