

# 2021 Certified Tax Roll

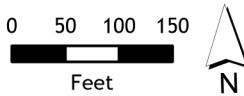

Grid Page  
A-222-A1



Fort Bend Central Appraisal District (FBCAD) is not authorized to determine legal title to property or establish the legal boundaries of property. FBCAD establishes appraisal records based on information from various sources, including but not limited to deeds, plats and surveys provided to but not created by the district. FBCAD is not responsible for errors or omissions in information submitted to and reviewed by the district. If any errors or omission are detected, contact the GIS Department of the FBCAD.

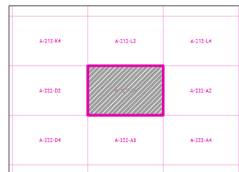

Grid Location Reference

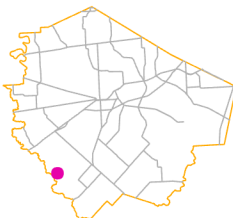

County Location Reference

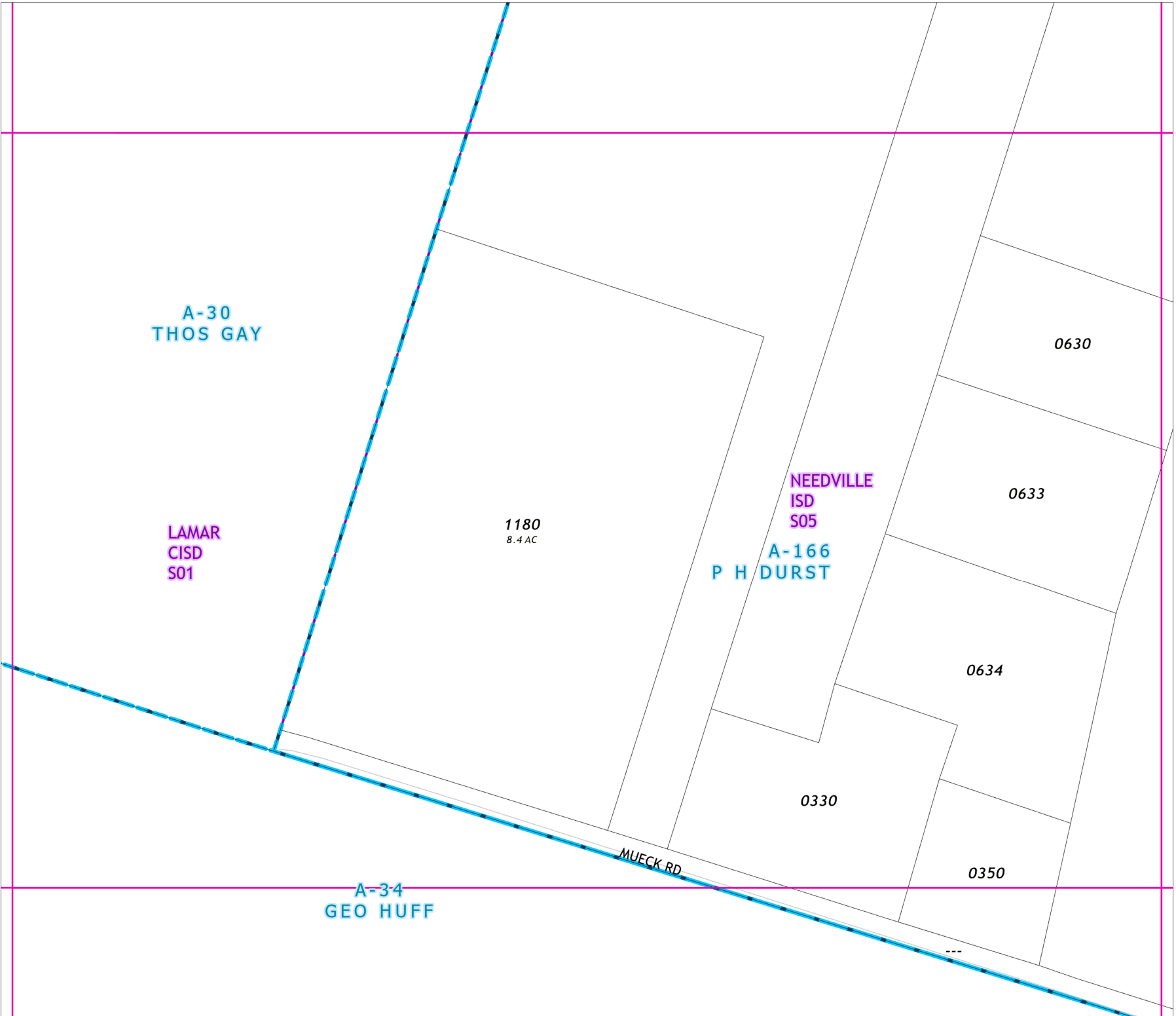

# 2021 Certified Tax Roll



**Grid Page  
A-222-A2**



Fort Bend Central Appraisal District (FBCAD) is not authorized to determine legal title to property or establish the legal boundaries of property. FBCAD establishes appraisal records based on information from various sources, including but not limited to deeds, plats and surveys provided to but not created by the district. FBCAD is not responsible for errors or omissions in information submitted to and reviewed by the district. If any errors or omission are detected, contact the GIS Department of the FBCAD.

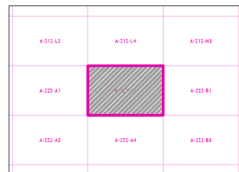

Grid Location Reference

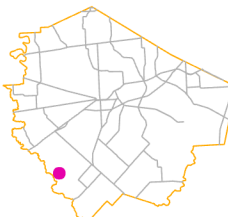

County Location Reference

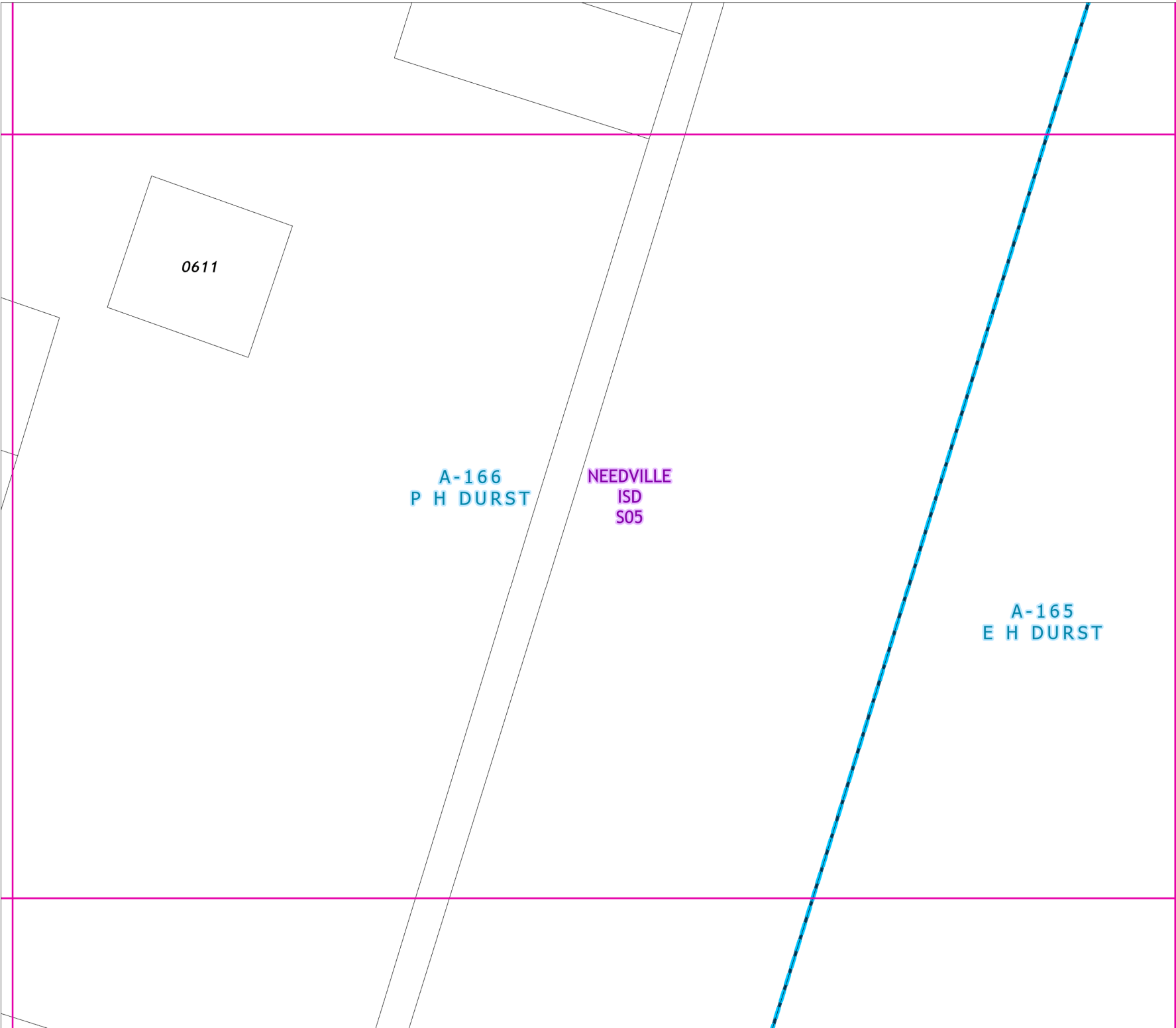

# 2021 Certified Tax Roll



**Grid Page  
A-222-A3**

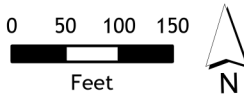

Fort Bend Central Appraisal District (FBCAD) is not authorized to determine legal title to property or establish the legal boundaries of property. FBCAD establishes appraisal records based on information from various sources, including but not limited to deeds, plats and surveys provided to but not created by the district. FBCAD is not responsible for errors or omissions in information submitted to and reviewed by the district. If any errors or omission are detected, contact the GIS Department of the FBCAD.

|          |          |          |
|----------|----------|----------|
| A-222-01 | A-222-01 | A-222-01 |
| A-222-04 |          | A-222-04 |
| A-222-05 | A-222-01 | A-222-01 |

Grid Location Reference

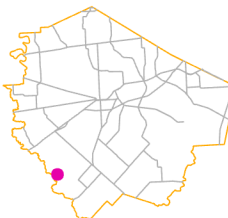

County Location Reference

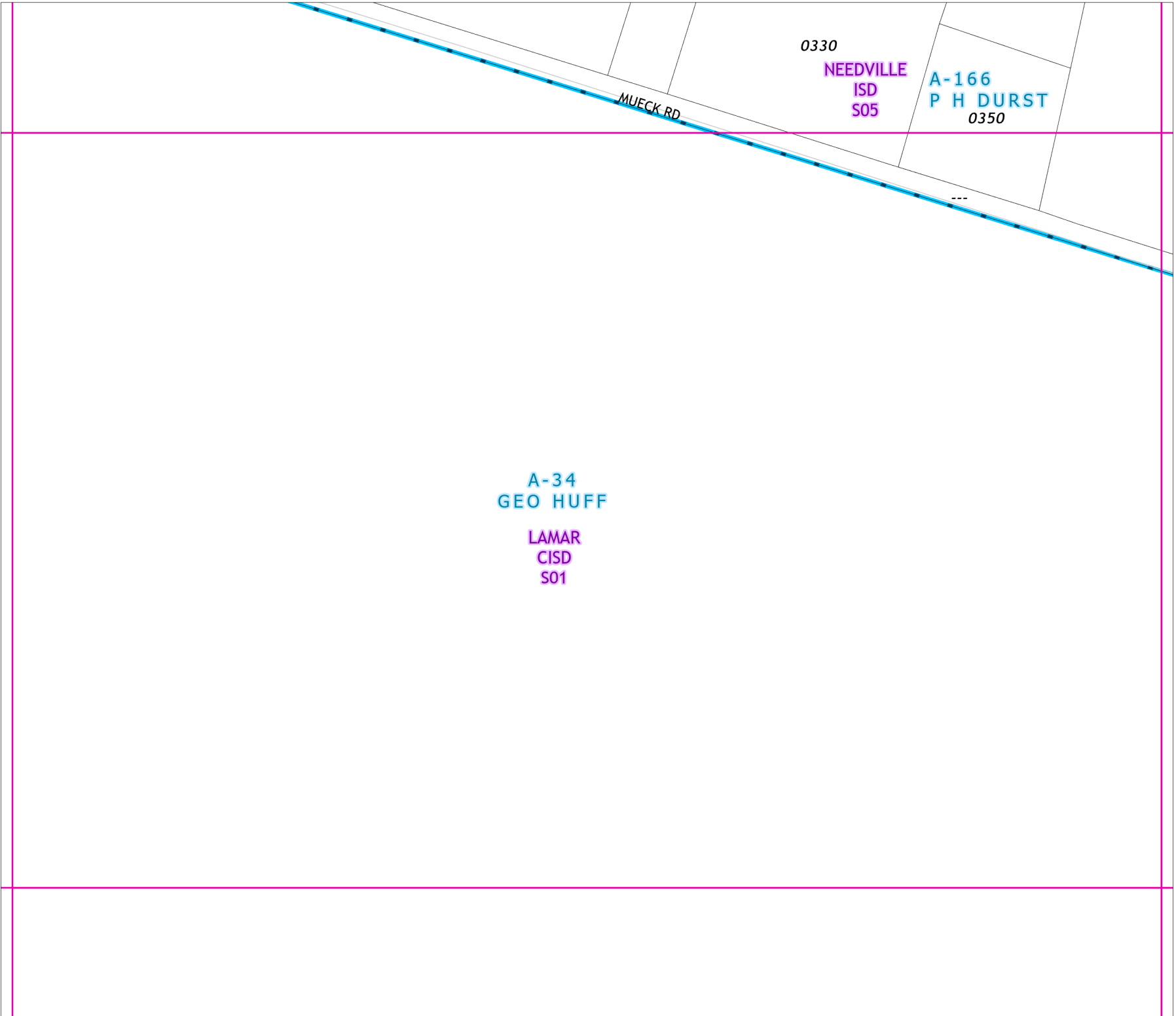

# 2021 Certified Tax Roll



Grid Page  
A-222-A4

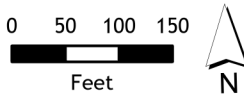

Fort Bend Central Appraisal District (FBCAD) is not authorized to determine legal title to property or establish the legal boundaries of property. FBCAD establishes appraisal records based on information from various sources, including but not limited to deeds, plats and surveys provided to but not created by the district. FBCAD is not responsible for errors or omissions in information submitted to and reviewed by the district. If any errors or omission are detected, contact the GIS Department of the FBCAD.

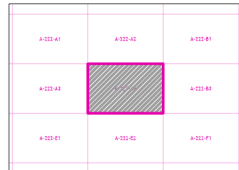

Grid Location Reference

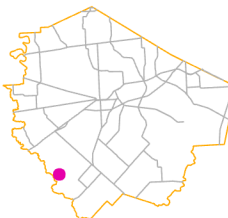

County Location Reference

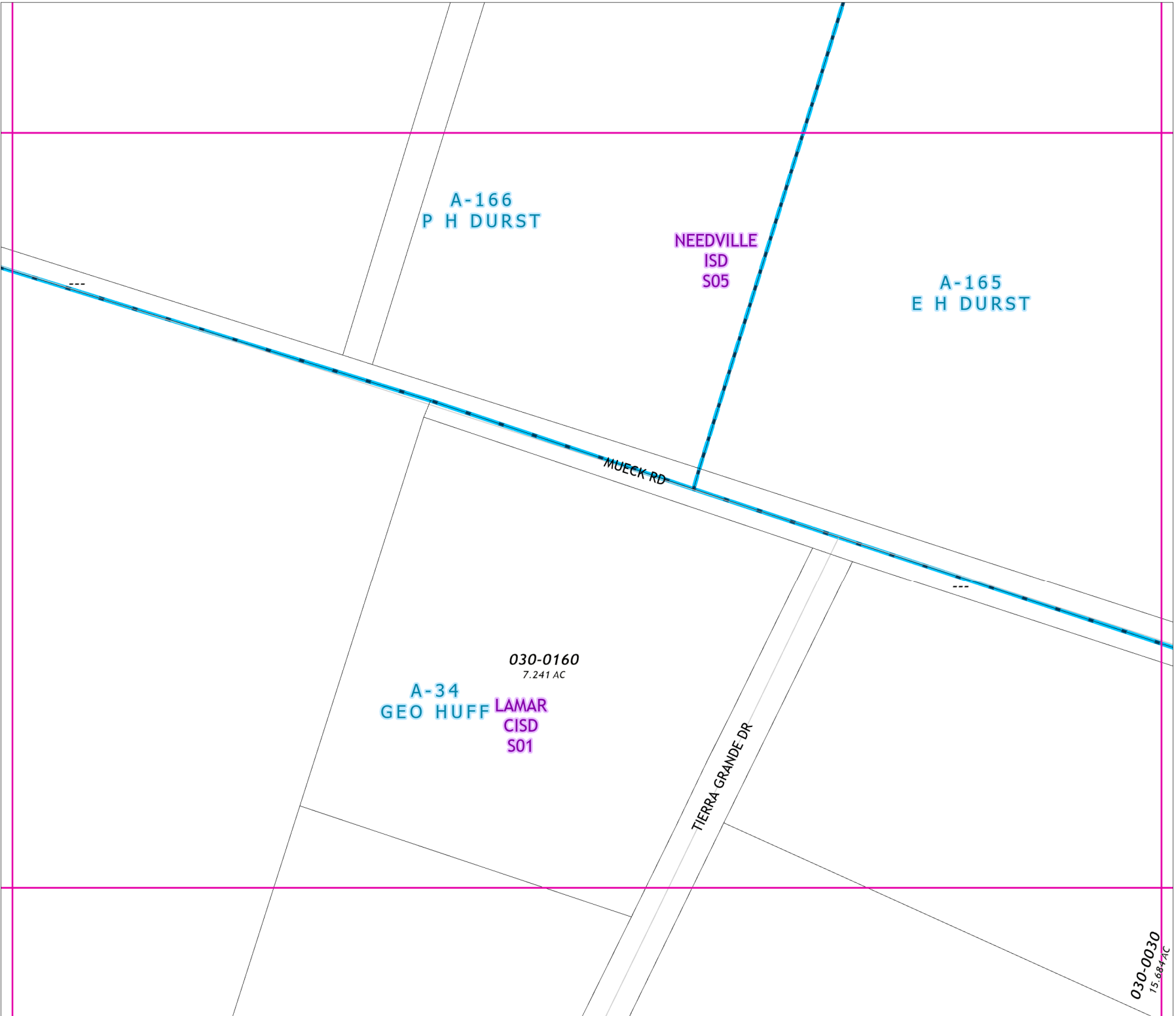



# 2021 Certified Tax Roll



Grid Page  
A-222-B1



Fort Bend Central Appraisal District (FBCAD) is not authorized to determine legal title to property or establish the legal boundaries of property. FBCAD establishes appraisal records based on information from various sources, including but not limited to deeds, plats and surveys provided to but not created by the district. FBCAD is not responsible for errors or omissions in information submitted to and reviewed by the district. If any errors or omission are detected, contact the GIS Department of the FBCAD.

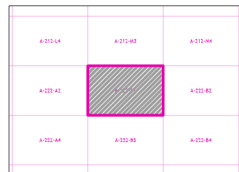

Grid Location Reference



County Location Reference

0370  
85.23 AC

A-165  
E H DURST  
NEEDVILLE  
ISD  
S05

A-21  
P CONRAD

0021

MUECK RD

# 2021 Certified Tax Roll



Grid Page  
A-222-B2



Fort Bend Central Appraisal District (FBCAD) is not authorized to determine legal title to property or establish the legal boundaries of property. FBCAD establishes appraisal records based on information from various sources, including but not limited to deeds, plats and surveys provided to but not created by the district. FBCAD is not responsible for errors or omissions in information submitted to and reviewed by the district. If any errors or omissions are detected, contact the GIS Department of the FBCAD.

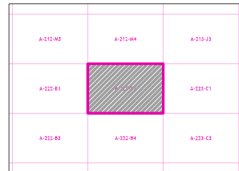

Grid Location Reference

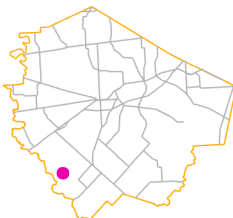

County Location Reference

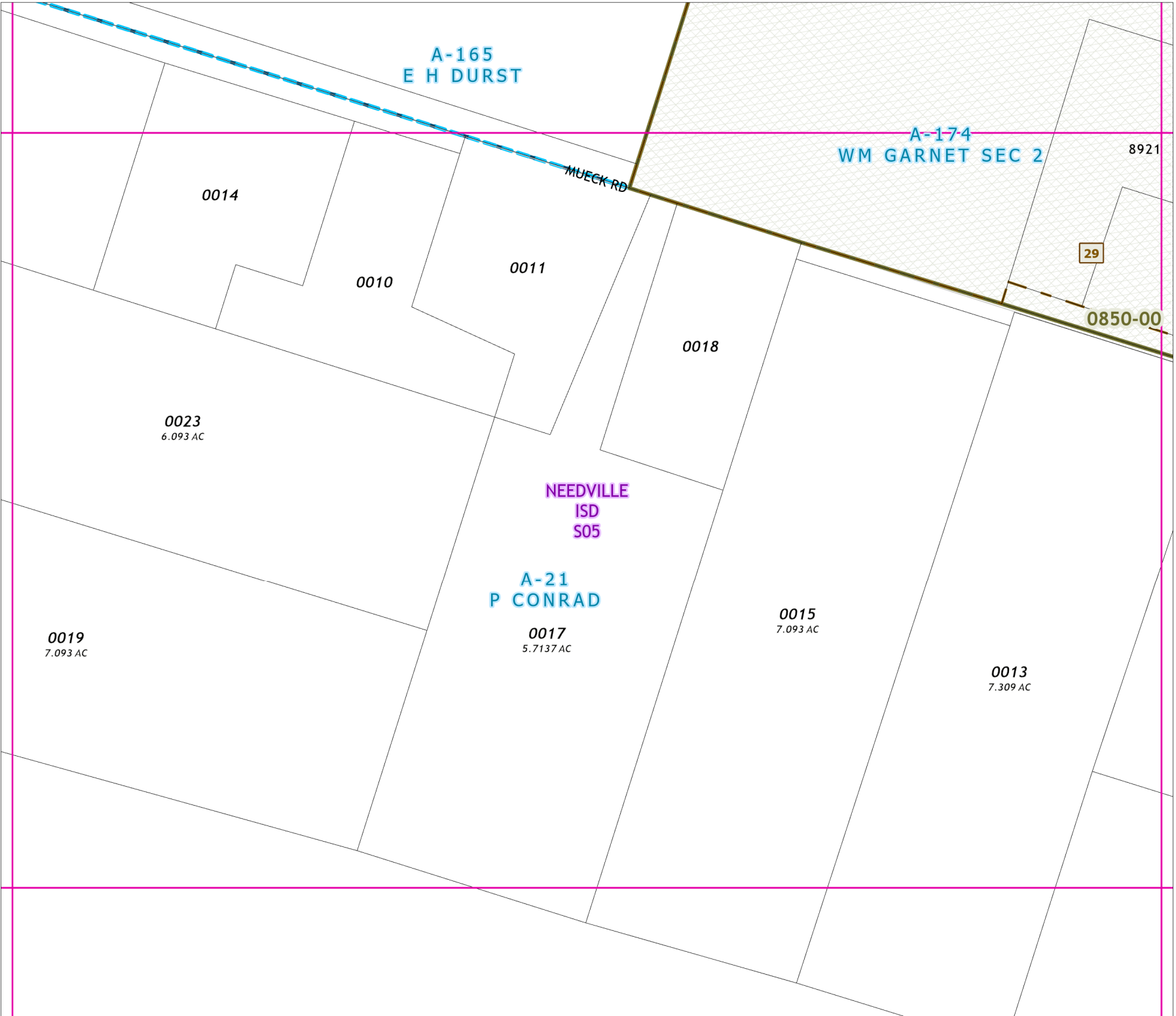

# 2021 Certified Tax Roll



Grid Page  
A-222-B3

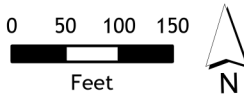

Fort Bend Central Appraisal District (FBCAD) is not authorized to determine legal title to property or establish the legal boundaries of property. FBCAD establishes appraisal records based on information from various sources, including but not limited to deeds, plats and surveys provided to but not created by the district. FBCAD is not responsible for errors or omissions in information submitted to and reviewed by the district. If any errors or omission are detected, contact the GIS Department of the FBCAD.

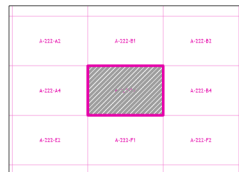

Grid Location Reference

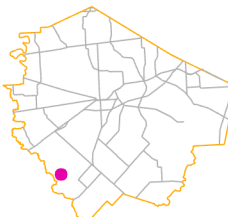

County Location Reference

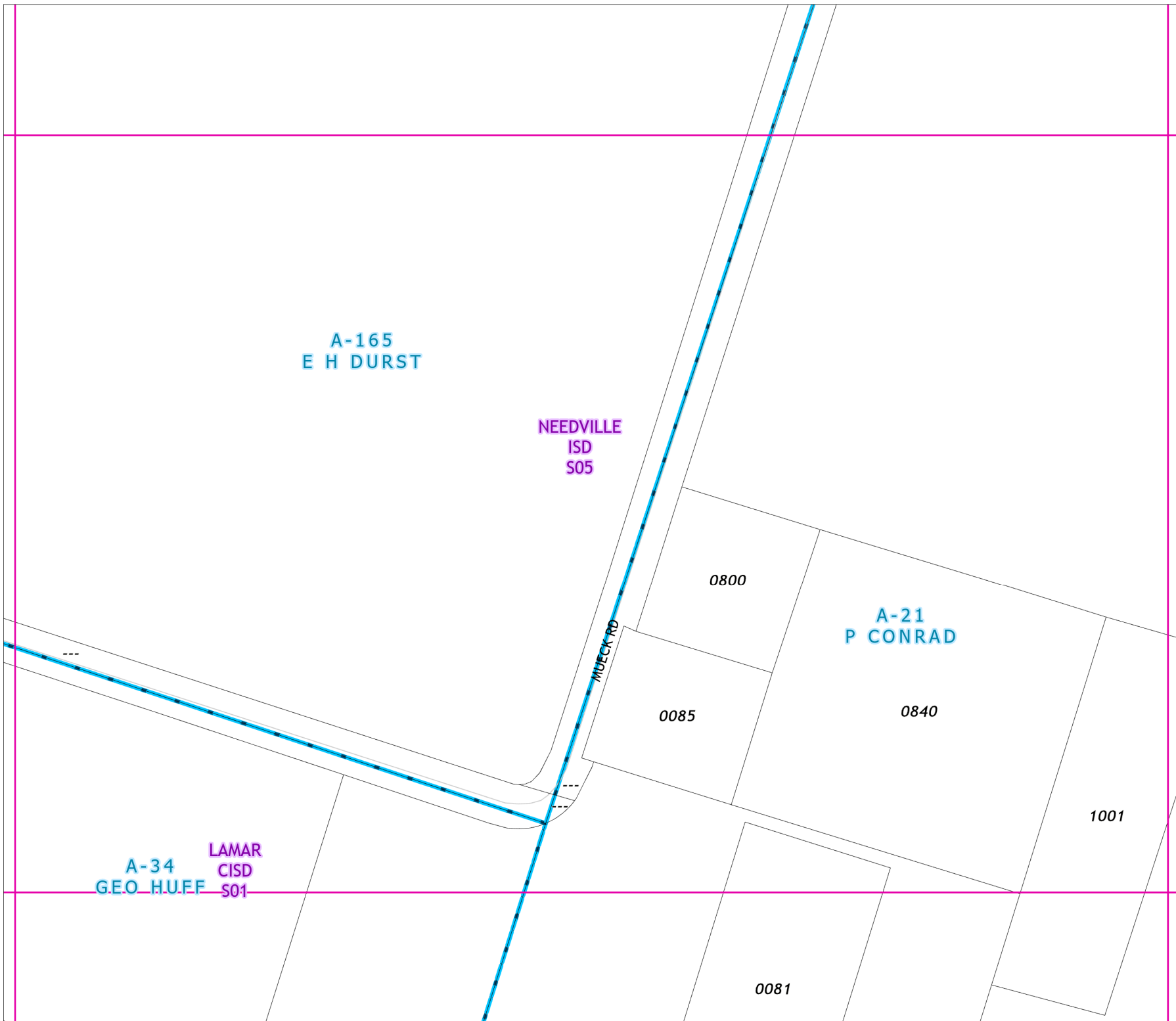

# 2021 Certified Tax Roll



**Grid Page  
A-222-B4**

**0430**  
40 AC

**NEEDVILLE**  
ISD  
S05

**A-21**  
P CONRAD

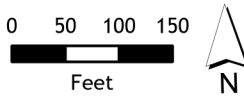

Fort Bend Central Appraisal District (FBCAD) is not authorized to determine legal title to property or establish the legal boundaries of property. FBCAD establishes appraisal records based on information from various sources, including but not limited to deeds, plats and surveys provided to but not created by the district. FBCAD is not responsible for errors or omissions in information submitted to and reviewed by the district. If any errors or omission are detected, contact the GIS Department of the FBCAD.

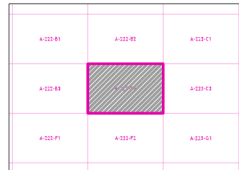

Grid Location Reference



County Location Reference

# 2021 Certified Tax Roll



**Grid Page  
A-222-C1**

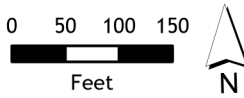

Fort Bend Central Appraisal District (FBCAD) is not authorized to determine legal title to property or establish the legal boundaries of property. FBCAD establishes appraisal records based on information from various sources, including but not limited to deeds, plats and surveys provided to but not created by the district. FBCAD is not responsible for errors or omissions in information submitted to and reviewed by the district. If any errors or omission are detected, contact the GIS Department of the FBCAD.

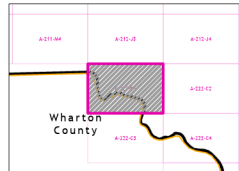

Grid Location Reference

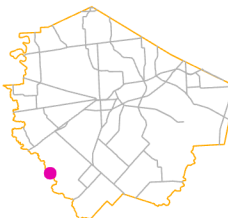

County Location Reference

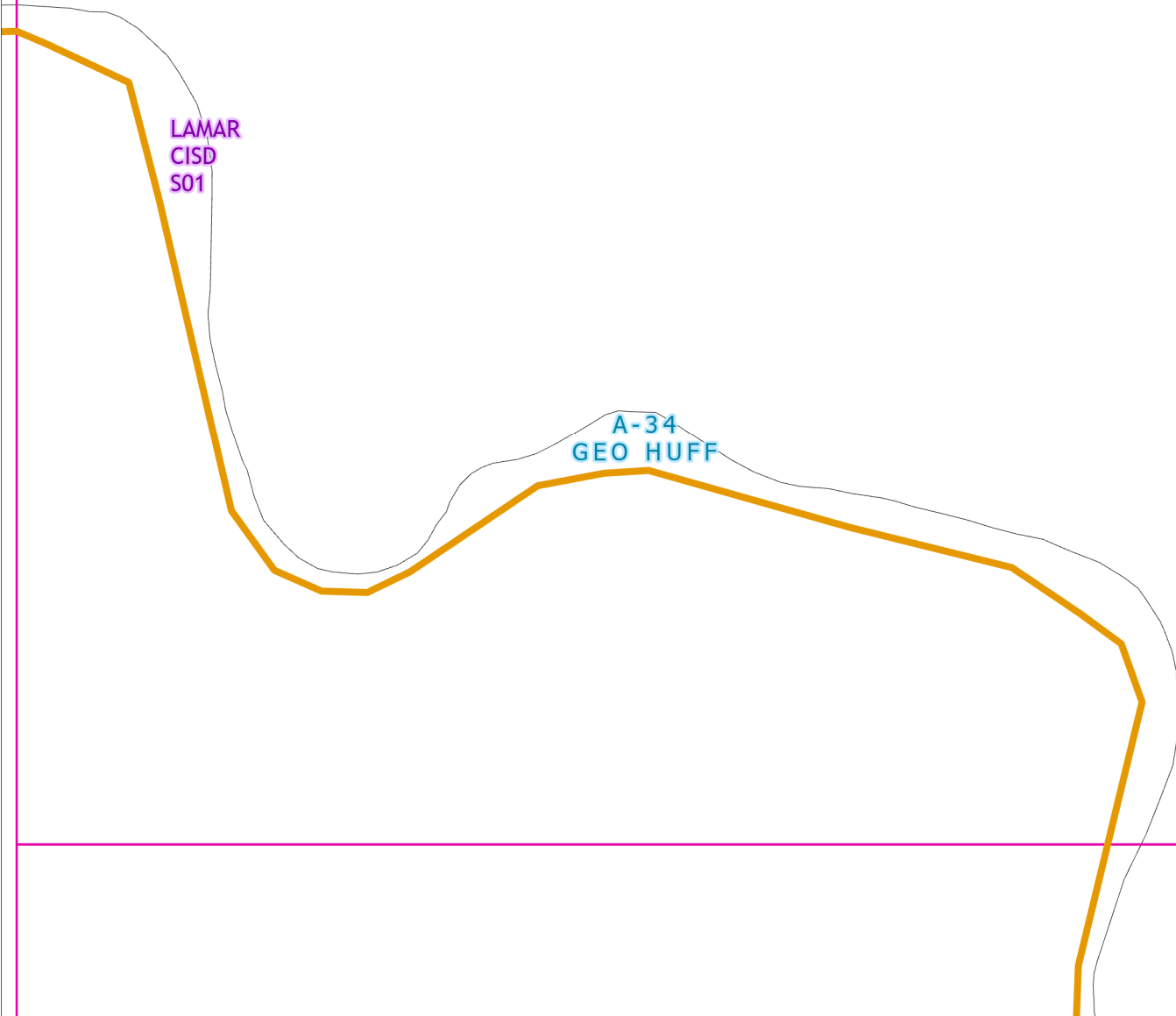

# 2021 Certified Tax Roll



**Grid Page  
A-222-C2**

LAMAR  
CISD  
S01

A-34  
GEO HUFF

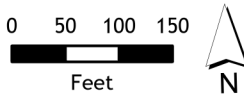

Fort Bend Central Appraisal District (FBCAD) is not authorized to determine legal title to property or establish the legal boundaries of property. FBCAD establishes appraisal records based on information from various sources, including but not limited to deeds, plats and surveys provided to but not created by the district. FBCAD is not responsible for errors or omissions in information submitted to and reviewed by the district. If any errors or omission are detected, contact the GIS Department of the FBCAD.

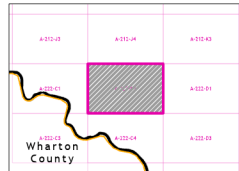

Grid Location Reference

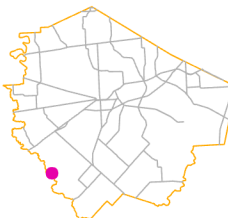

County Location Reference

# 2021 Certified Tax Roll



**Grid Page  
A-222-C3**

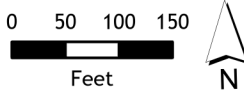

Fort Bend Central Appraisal District (FBCAD) is not authorized to determine legal title to property or establish the legal boundaries of property. FBCAD establishes appraisal records based on information from various sources, including but not limited to deeds, plats and surveys provided to but not created by the district. FBCAD is not responsible for errors or omissions in information submitted to and reviewed by the district. If any errors or omission are detected, contact the GIS Department of the FBCAD.

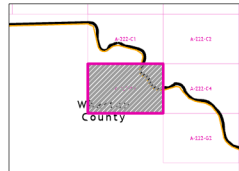

Grid Location Reference

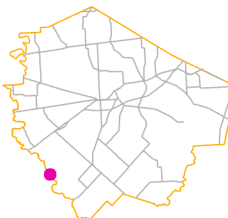

County Location Reference

A-34  
GEO HUFF

LAMAR  
CISD  
S01

# 2021 Certified Tax Roll



**Grid Page  
A-222-C4**

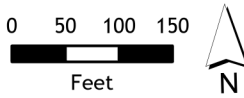

Fort Bend Central Appraisal District (FBCAD) is not authorized to determine legal title to property or establish the legal boundaries of property. FBCAD establishes appraisal records based on information from various sources, including but not limited to deeds, plats and surveys provided to but not created by the district. FBCAD is not responsible for errors or omissions in information submitted to and reviewed by the district. If any errors or omission are detected, contact the GIS Department of the FBCAD.

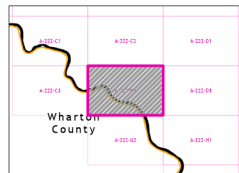

Grid Location Reference

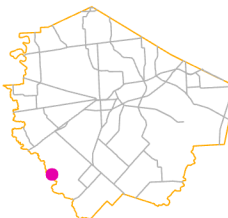

County Location Reference

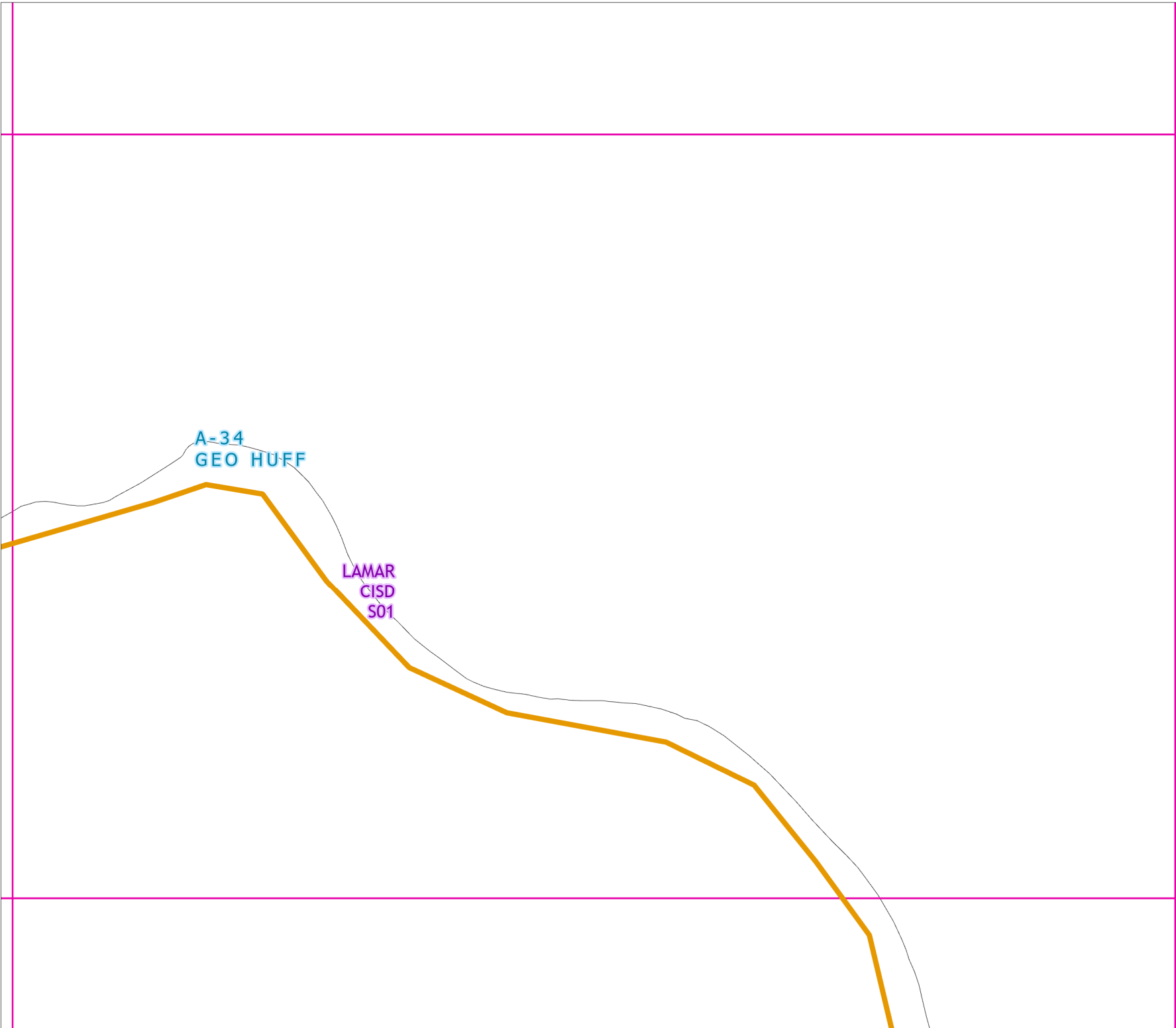



# 2021 Certified Tax Roll



**Grid Page  
A-222-D1**



Fort Bend Central Appraisal District (FBCAD) is not authorized to determine legal title to property or establish the legal boundaries of property. FBCAD establishes appraisal records based on information from various sources, including but not limited to deeds, plats and surveys provided to but not created by the district. FBCAD is not responsible for errors or omissions in information submitted to and reviewed by the district. If any errors or omission are detected, contact the GIS Department of the FBCAD.

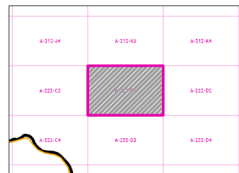

Grid Location Reference

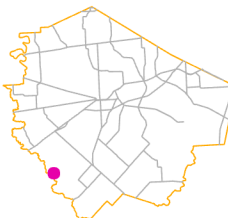

County Location Reference

A-30  
THOS GAY

LAMAR  
CISD  
S01  
A-34  
GEO HUFF

# 2021 Certified Tax Roll



**Grid Page  
A-222-D2**



Fort Bend Central Appraisal District (FBCAD) is not authorized to determine legal title to property or establish the legal boundaries of property. FBCAD establishes appraisal records based on information from various sources, including but not limited to deeds, plats and surveys provided to but not created by the district. FBCAD is not responsible for errors or omissions in information submitted to and reviewed by the district. If any errors or omission are detected, contact the GIS Department of the FBCAD.

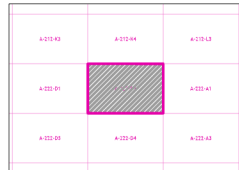

Grid Location Reference

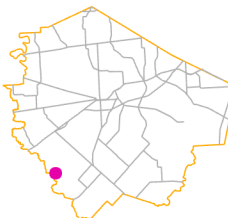

County Location Reference

A-30  
THOS GAY

LAMAR  
CISD  
S01

A-34  
GEO HUFF

# 2021 Certified Tax Roll



**Grid Page  
A-222-D3**

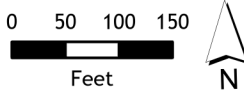

Fort Bend Central Appraisal District (FBCAD) is not authorized to determine legal title to property or establish the legal boundaries of property. FBCAD establishes appraisal records based on information from various sources, including but not limited to deeds, plats and surveys provided to but not created by the district. FBCAD is not responsible for errors or omissions in information submitted to and reviewed by the district. If any errors or omission are detected, contact the GIS Department of the FBCAD.

LAMAR  
CISD  
S01      A-34  
GEO HUFF

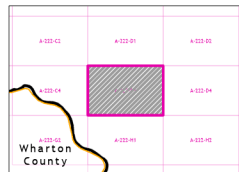

Grid Location Reference

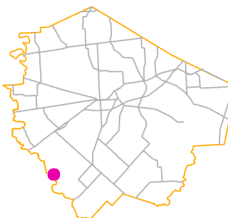

County Location Reference

020-0000  
1212 AC

# 2021 Certified Tax Roll



**Grid Page  
A-222-D4**

**LAMAR  
CISD  
S01**

**A-34  
GEO HUFF**

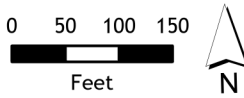

Fort Bend Central Appraisal District (FBCAD) is not authorized to determine legal title to property or establish the legal boundaries of property. FBCAD establishes appraisal records based on information from various sources, including but not limited to deeds, plats and surveys provided to but not created by the district. FBCAD is not responsible for errors or omissions in information submitted to and reviewed by the district. If any errors or omission are detected, contact the GIS Department of the FBCAD.

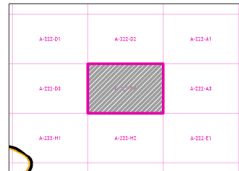

Grid Location Reference

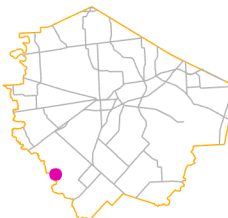

County Location Reference

# 2021 Certified Tax Roll



**Grid Page  
A-222-E1**

**LAMAR  
CISD  
S01**

**A-34  
GEO HUFF**

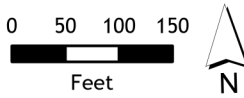

Fort Bend Central Appraisal District (FBCAD) is not authorized to determine legal title to property or establish the legal boundaries of property. FBCAD establishes appraisal records based on information from various sources, including but not limited to deeds, plats and surveys provided to but not created by the district. FBCAD is not responsible for errors or omissions in information submitted to and reviewed by the district. If any errors or omission are detected, contact the GIS Department of the FBCAD.

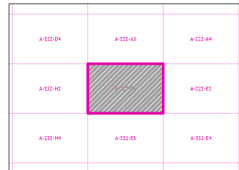

Grid Location Reference

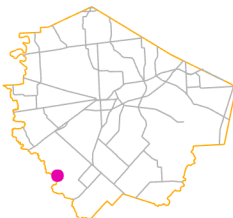

County Location Reference

# 2021 Certified Tax Roll



**Grid Page  
A-222-E2**

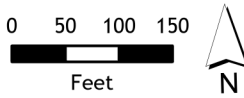

Fort Bend Central Appraisal District (FBCAD) is not authorized to determine legal title to property or establish the legal boundaries of property. FBCAD establishes appraisal records based on information from various sources, including but not limited to deeds, plats and surveys provided to but not created by the district. FBCAD is not responsible for errors or omissions in information submitted to and reviewed by the district. If any errors or omission are detected, contact the GIS Department of the FBCAD.

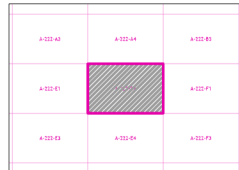

Grid Location Reference

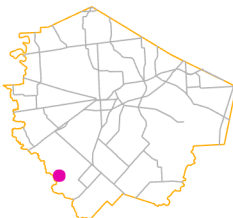

County Location Reference

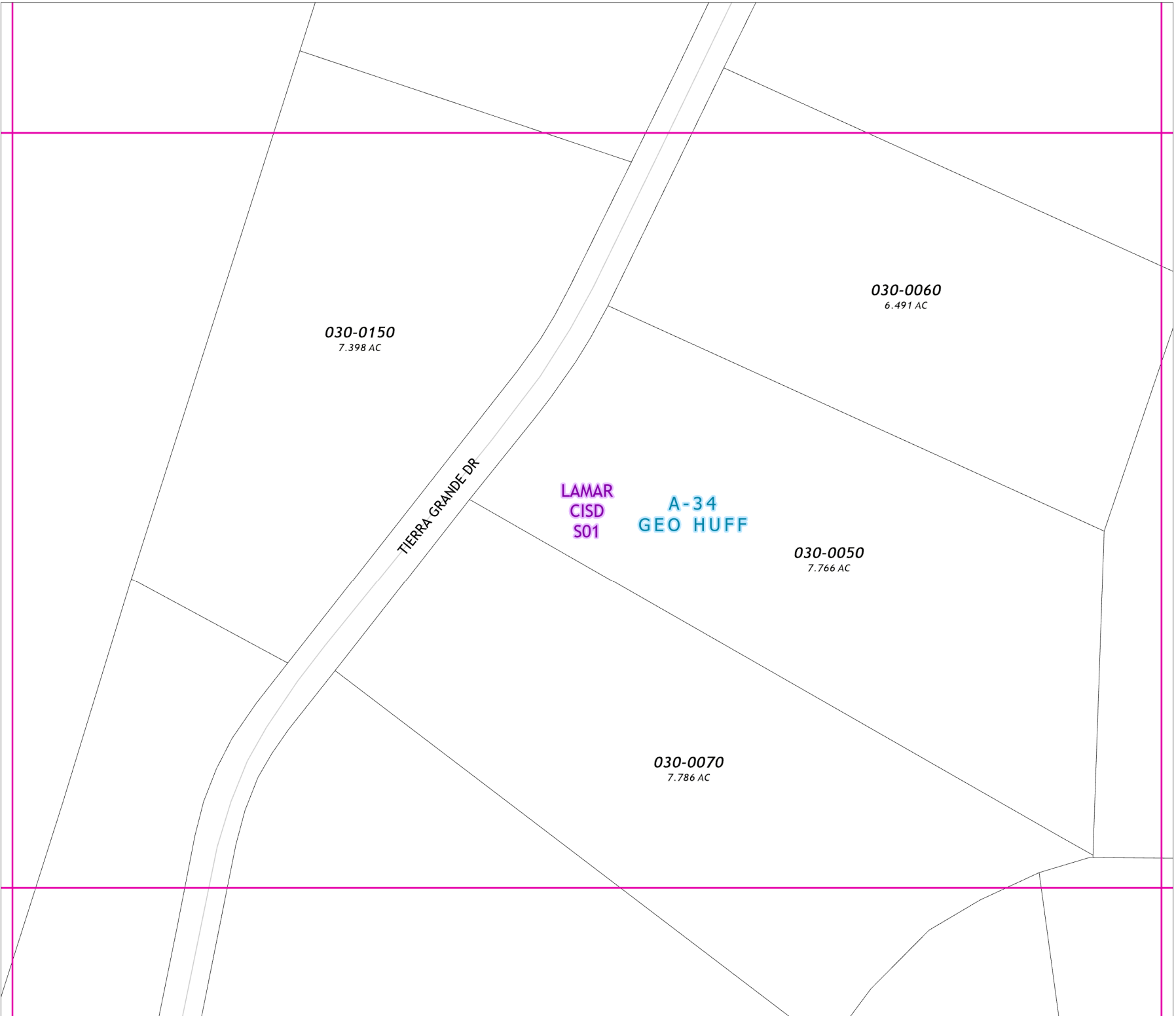

# 2021 Certified Tax Roll



**Grid Page  
A-222-E3**

LAMAR  
CISD  
S01

A-34  
GEO HUFF

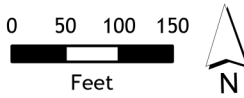

Fort Bend Central Appraisal District (FBCAD) is not authorized to determine legal title to property or establish the legal boundaries of property. FBCAD establishes appraisal records based on information from various sources, including but not limited to deeds, plats and surveys provided to but not created by the district. FBCAD is not responsible for errors or omissions in information submitted to and reviewed by the district. If any errors or omission are detected, contact the GIS Department of the FBCAD.

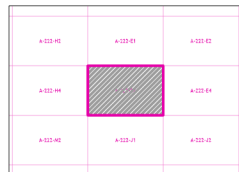

Grid Location Reference

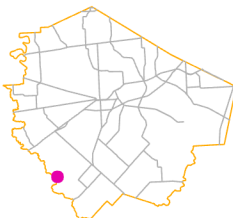

County Location Reference

030-0130

030-0121

# 2021 Certified Tax Roll



**Grid Page  
A-222-E4**

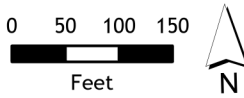

Fort Bend Central Appraisal District (FBCAD) is not authorized to determine legal title to property or establish the legal boundaries of property. FBCAD establishes appraisal records based on information from various sources, including but not limited to deeds, plats and surveys provided to but not created by the district. FBCAD is not responsible for errors or omissions in information submitted to and reviewed by the district. If any errors or omission are detected, contact the GIS Department of the FBCAD.

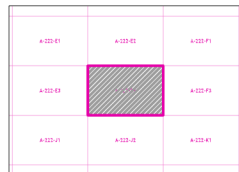

Grid Location Reference

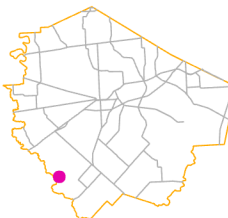

County Location Reference

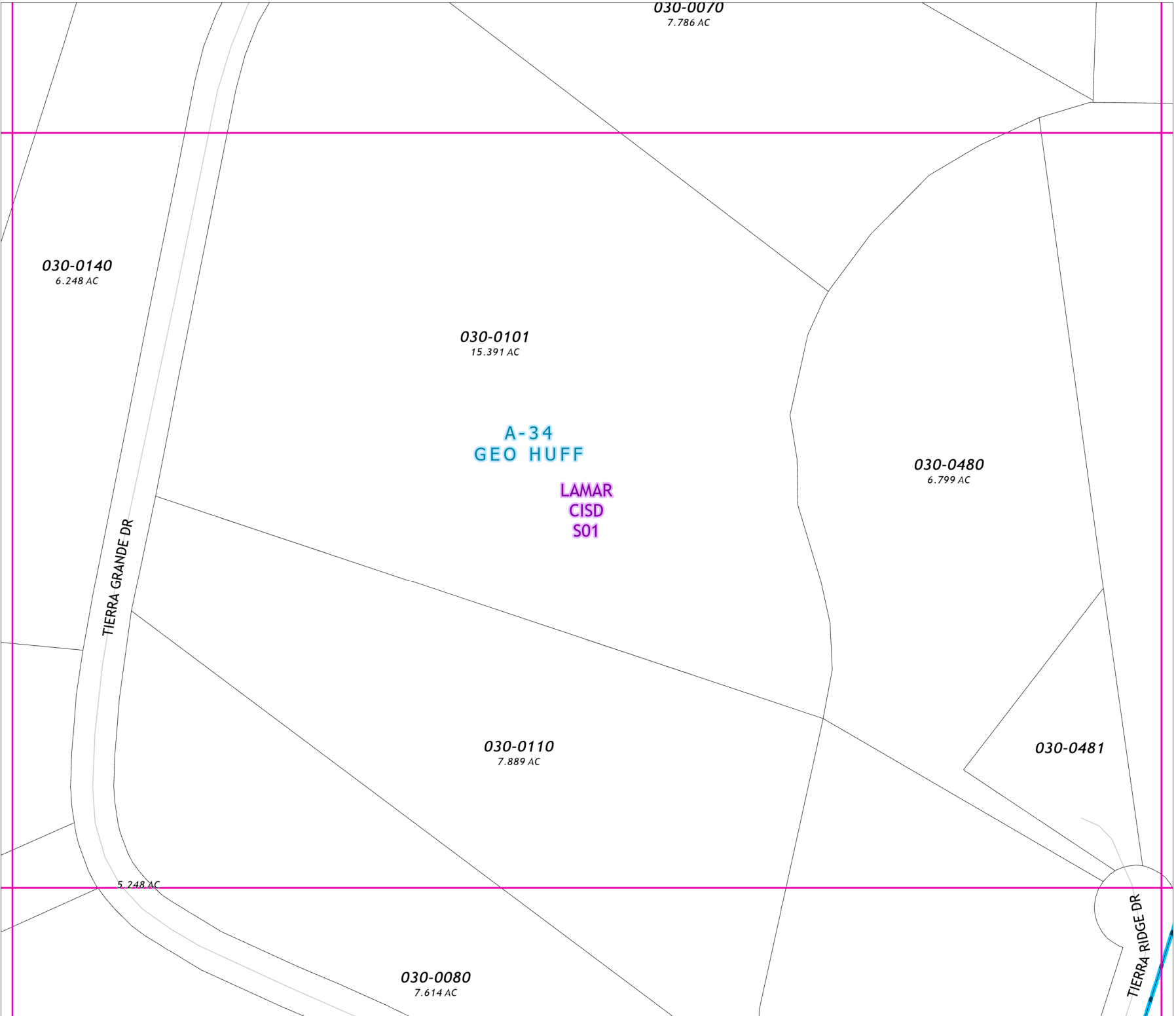



# 2021 Certified Tax Roll



**Grid Page  
A-222-F1**



Fort Bend Central Appraisal District (FBCAD) is not authorized to determine legal title to property or establish the legal boundaries of property. FBCAD establishes appraisal records based on information from various sources, including but not limited to deeds, plats and surveys provided to but not created by the district. FBCAD is not responsible for errors or omissions in information submitted to and reviewed by the district. If any errors or omission are detected, contact the GIS Department of the FBCAD.

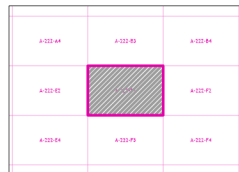

Grid Location Reference

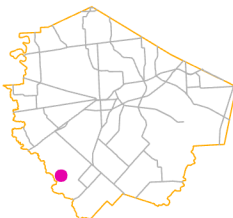

County Location Reference



# 2021 Certified Tax Roll



**Grid Page  
A-222-F2**

**A-21  
P CONRAD**  
**NEEDVILLE  
ISD  
S05**

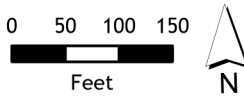

Fort Bend Central Appraisal District (FBCAD) is not authorized to determine legal title to property or establish the legal boundaries of property. FBCAD establishes appraisal records based on information from various sources, including but not limited to deeds, plats and surveys provided to but not created by the district. FBCAD is not responsible for errors or omissions in information submitted to and reviewed by the district. If any errors or omission are detected, contact the GIS Department of the FBCAD.

|          |          |          |
|----------|----------|----------|
| A-222-F0 | A-222-F4 | A-222-F8 |
| A-222-F1 | A-222-F2 | A-222-F3 |
| A-222-F5 | A-222-F6 | A-222-F7 |

Grid Location Reference



County Location Reference

# 2021 Certified Tax Roll



**Grid Page  
A-222-F3**

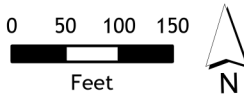

Fort Bend Central Appraisal District (FBCAD) is not authorized to determine legal title to property or establish the legal boundaries of property. FBCAD establishes appraisal records based on information from various sources, including but not limited to deeds, plats and surveys provided to but not created by the district. FBCAD is not responsible for errors or omissions in information submitted to and reviewed by the district. If any errors or omission are detected, contact the GIS Department of the FBCAD.

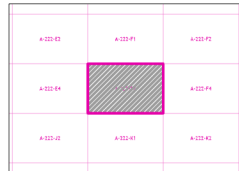

Grid Location Reference

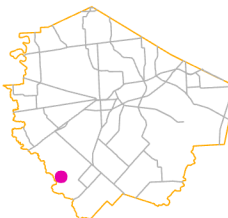

County Location Reference

**A-34  
GEO HUFF**

**LAMAR  
CISD  
S01**

**030-0491  
8.099 AC**

**0080  
42 AC**

**1000  
48 AC**

**NEEDVILLE  
ISD  
S05**

**A-21  
P CONRAD**

# 2021 Certified Tax Roll



**Grid Page  
A-222-F4**

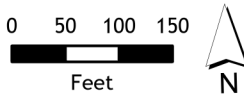

Fort Bend Central Appraisal District (FBCAD) is not authorized to determine legal title to property or establish the legal boundaries of property. FBCAD establishes appraisal records based on information from various sources, including but not limited to deeds, plats and surveys provided to but not created by the district. FBCAD is not responsible for errors or omissions in information submitted to and reviewed by the district. If any errors or omission are detected, contact the GIS Department of the FBCAD.

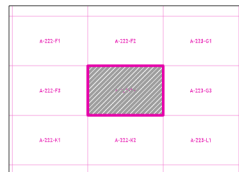

Grid Location Reference

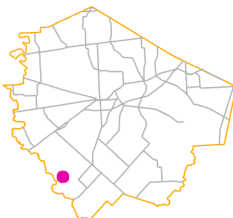

County Location Reference

**1180**  
60 AC

**NEEDVILLE**  
ISD  
S05

**A-21**  
P CONRAD

# 2021 Certified Tax Roll



**Grid Page  
A-222-G1**

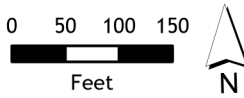

Fort Bend Central Appraisal District (FBCAD) is not authorized to determine legal title to property or establish the legal boundaries of property. FBCAD establishes appraisal records based on information from various sources, including but not limited to deeds, plats and surveys provided to but not created by the district. FBCAD is not responsible for errors or omissions in information submitted to and reviewed by the district. If any errors or omission are detected, contact the GIS Department of the FBCAD.

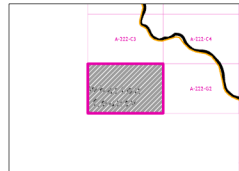

Grid Location Reference

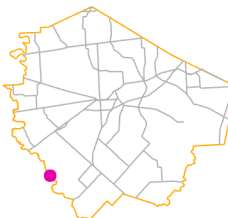

County Location Reference

# 2021 Certified Tax Roll



**Grid Page  
A-222-G2**

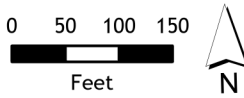

Fort Bend Central Appraisal District (FBCAD) is not authorized to determine legal title to property or establish the legal boundaries of property. FBCAD establishes appraisal records based on information from various sources, including but not limited to deeds, plats and surveys provided to but not created by the district. FBCAD is not responsible for errors or omissions in information submitted to and reviewed by the district. If any errors or omission are detected, contact the GIS Department of the FBCAD.

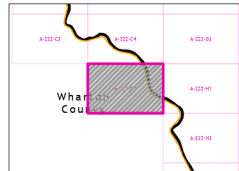

Grid Location Reference

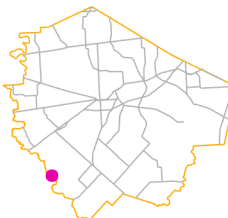

County Location Reference

**A-34  
GEO HUFF**

**LAMAR  
CISD  
S01**

# 2021 Certified Tax Roll



**Grid Page  
A-222-G3**



Fort Bend Central Appraisal District (FBCAD) is not authorized to determine legal title to property or establish the legal boundaries of property. FBCAD establishes appraisal records based on information from various sources, including but not limited to deeds, plats and surveys provided to but not created by the district. FBCAD is not responsible for errors or omissions in information submitted to and reviewed by the district. If any errors or omission are detected, contact the GIS Department of the FBCAD.

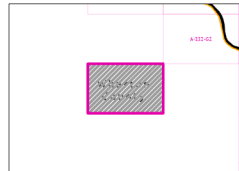

Grid Location Reference

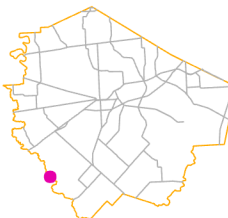

County Location Reference

# 2021 Certified Tax Roll



**Grid Page  
A-222-G4**

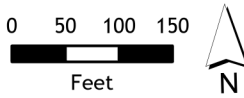

Fort Bend Central Appraisal District (FBCAD) is not authorized to determine legal title to property or establish the legal boundaries of property. FBCAD establishes appraisal records based on information from various sources, including but not limited to deeds, plats and surveys provided to but not created by the district. FBCAD is not responsible for errors or omissions in information submitted to and reviewed by the district. If any errors or omission are detected, contact the GIS Department of the FBCAD.

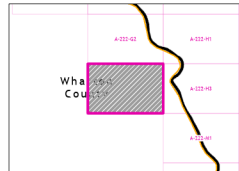

Grid Location Reference

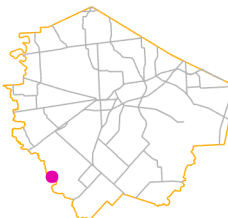

County Location Reference



# 2021 Certified Tax Roll



**Grid Page  
A-222-H1**

020-0000  
1212 AC

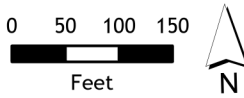

Fort Bend Central Appraisal District (FBCAD) is not authorized to determine legal title to property or establish the legal boundaries of property. FBCAD establishes appraisal records based on information from various sources, including but not limited to deeds, plats and surveys provided to but not created by the district. FBCAD is not responsible for errors or omissions in information submitted to and reviewed by the district. If any errors or omission are detected, contact the GIS Department of the FBCAD.

A-34  
GEO HUFF

LAMAR  
GISD  
S01

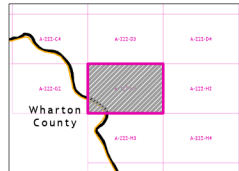

Grid Location Reference

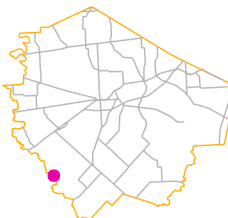

County Location Reference

# 2021 Certified Tax Roll



**Grid Page  
A-222-H2**

**A-34  
GEO HUFF**

**LAMAR  
CISD  
S01**

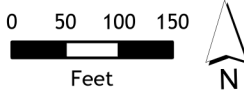

Fort Bend Central Appraisal District (FBCAD) is not authorized to determine legal title to property or establish the legal boundaries of property. FBCAD establishes appraisal records based on information from various sources, including but not limited to deeds, plats and surveys provided to but not created by the district. FBCAD is not responsible for errors or omissions in information submitted to and reviewed by the district. If any errors or omission are detected, contact the GIS Department of the FBCAD.

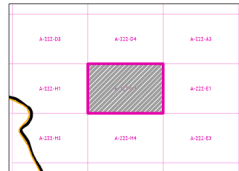

Grid Location Reference

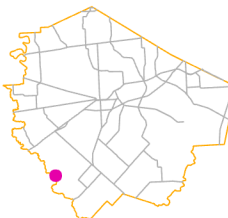

County Location Reference

# 2021 Certified Tax Roll



**Grid Page  
A-222-H3**

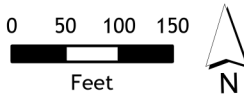

Fort Bend Central Appraisal District (FBCAD) is not authorized to determine legal title to property or establish the legal boundaries of property. FBCAD establishes appraisal records based on information from various sources, including but not limited to deeds, plats and surveys provided to but not created by the district. FBCAD is not responsible for errors or omissions in information submitted to and reviewed by the district. If any errors or omission are detected, contact the GIS Department of the FBCAD.

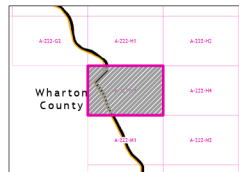

Grid Location Reference

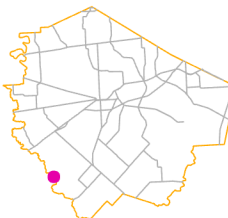

County Location Reference

LAMAR  
CISD  
S01

A-34  
GEO HUFF

# 2021 Certified Tax Roll



**Grid Page  
A-222-H4**

**A-34  
GEO HUFF**

**LAMAR  
CISD  
S01**

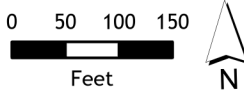

Fort Bend Central Appraisal District (FBCAD) is not authorized to determine legal title to property or establish the legal boundaries of property. FBCAD establishes appraisal records based on information from various sources, including but not limited to deeds, plats and surveys provided to but not created by the district. FBCAD is not responsible for errors or omissions in information submitted to and reviewed by the district. If any errors or omission are detected, contact the GIS Department of the FBCAD.

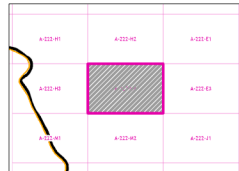

Grid Location Reference

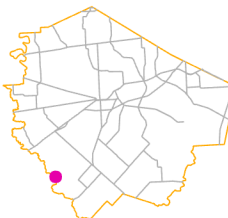

County Location Reference

# 2021 Certified Tax Roll



**Grid Page  
A-222-J1**

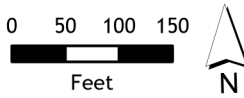

Fort Bend Central Appraisal District (FBCAD) is not authorized to determine legal title to property or establish the legal boundaries of property. FBCAD establishes appraisal records based on information from various sources, including but not limited to deeds, plats and surveys provided to but not created by the district. FBCAD is not responsible for errors or omissions in information submitted to and reviewed by the district. If any errors or omission are detected, contact the GIS Department of the FBCAD.

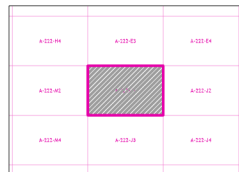

Grid Location Reference



County Location Reference

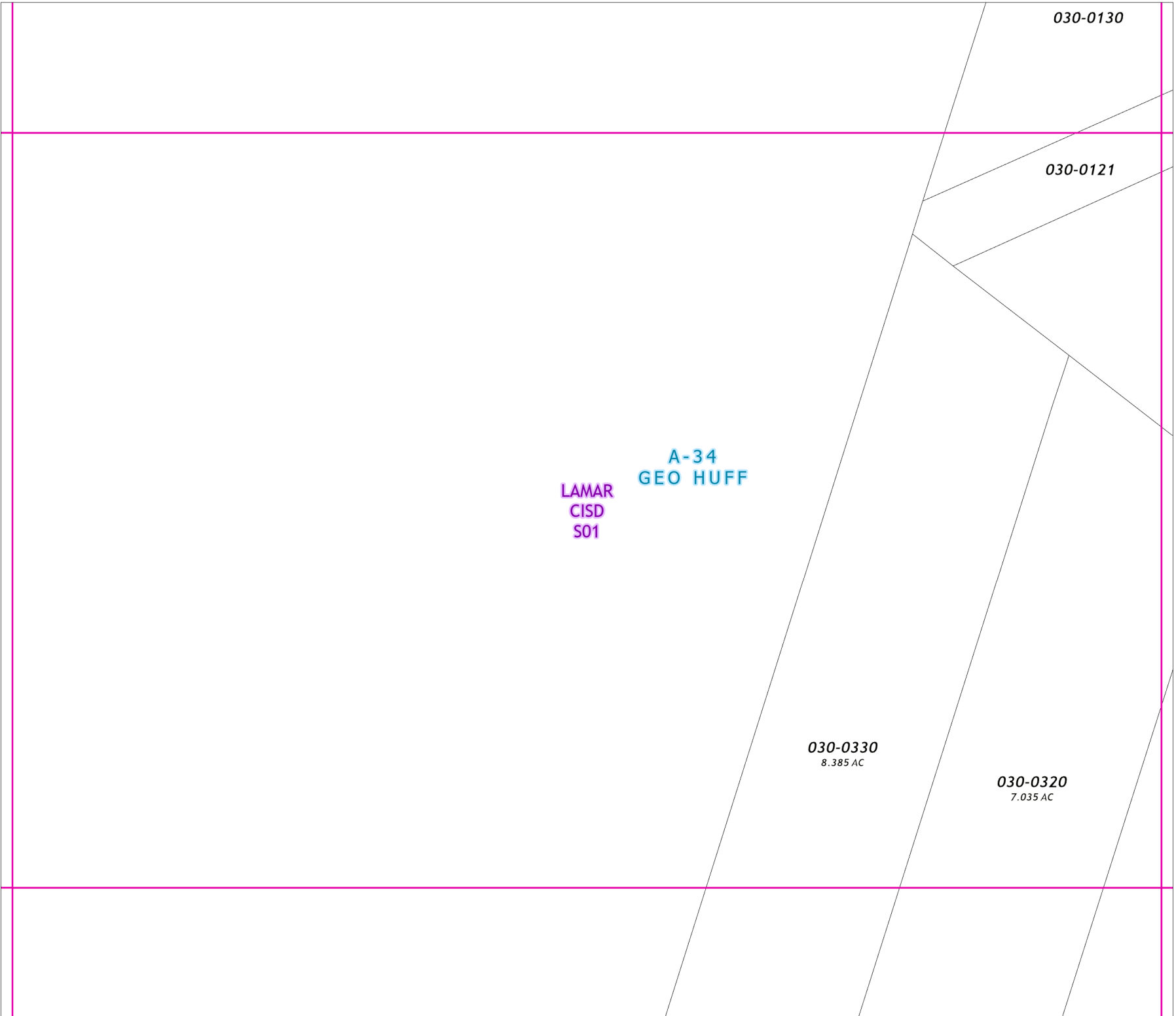

# 2021 Certified Tax Roll



Grid Page  
A-222-J2

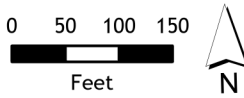

Fort Bend Central Appraisal District (FBCAD) is not authorized to determine legal title to property or establish the legal boundaries of property. FBCAD establishes appraisal records based on information from various sources, including but not limited to deeds, plats and surveys provided to but not created by the district. FBCAD is not responsible for errors or omissions in information submitted to and reviewed by the district. If any errors or omissions are detected, contact the GIS Department of the FBCAD.

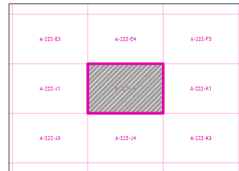

Grid Location Reference

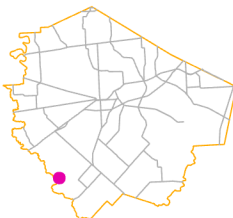

County Location Reference

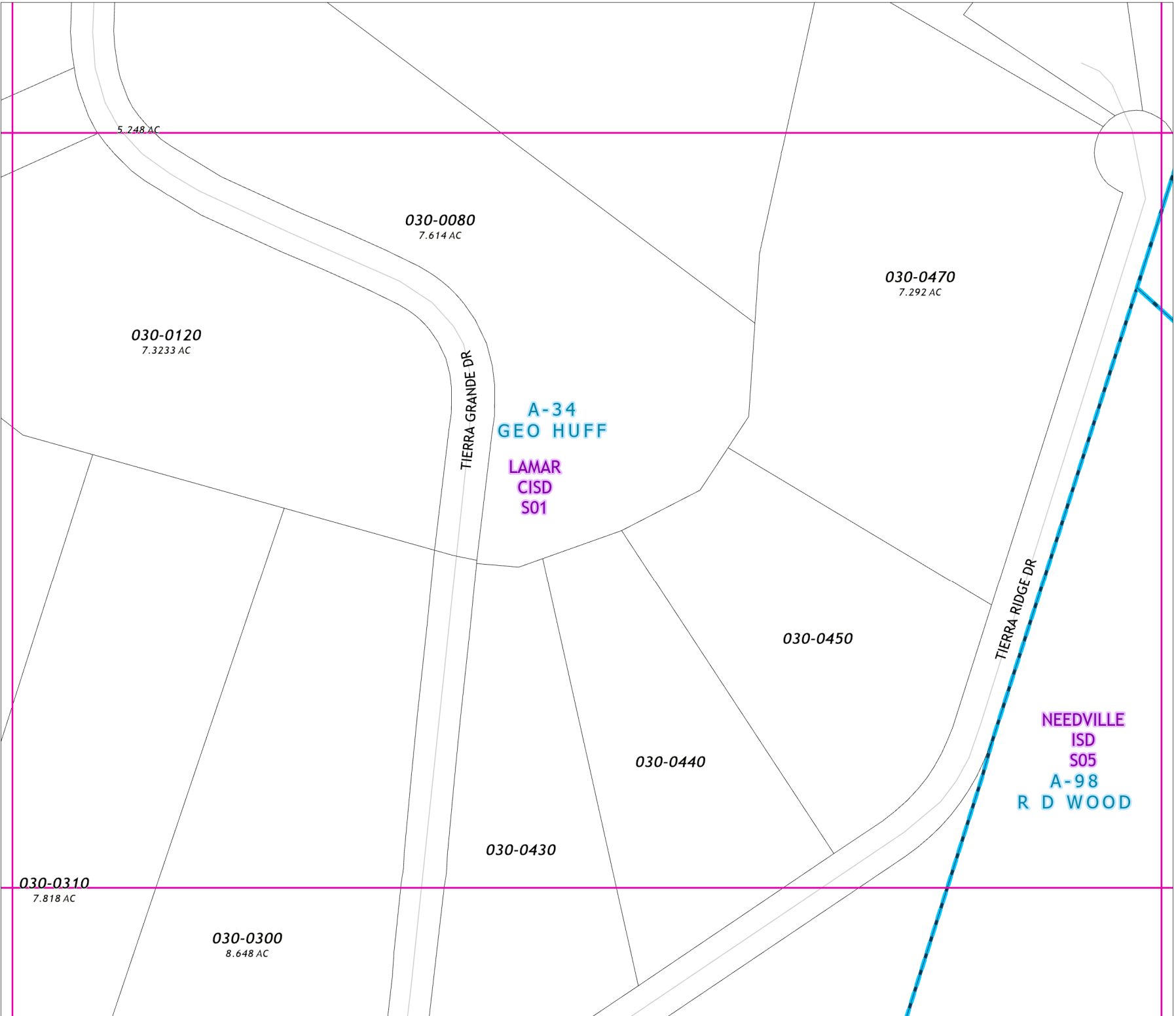

# 2021 Certified Tax Roll



Grid Page  
A-222-J3



Fort Bend Central Appraisal District (FBCAD) is not authorized to determine legal title to property or establish the legal boundaries of property. FBCAD establishes appraisal records based on information from various sources, including but not limited to deeds, plats and surveys provided to but not created by the district. FBCAD is not responsible for errors or omissions in information submitted to and reviewed by the district. If any errors or omission are detected, contact the GIS Department of the FBCAD.

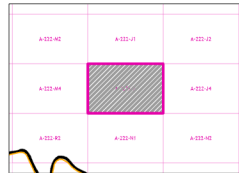

Grid Location Reference

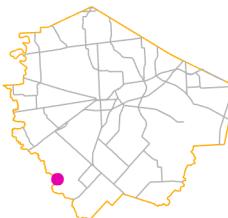

County Location Reference

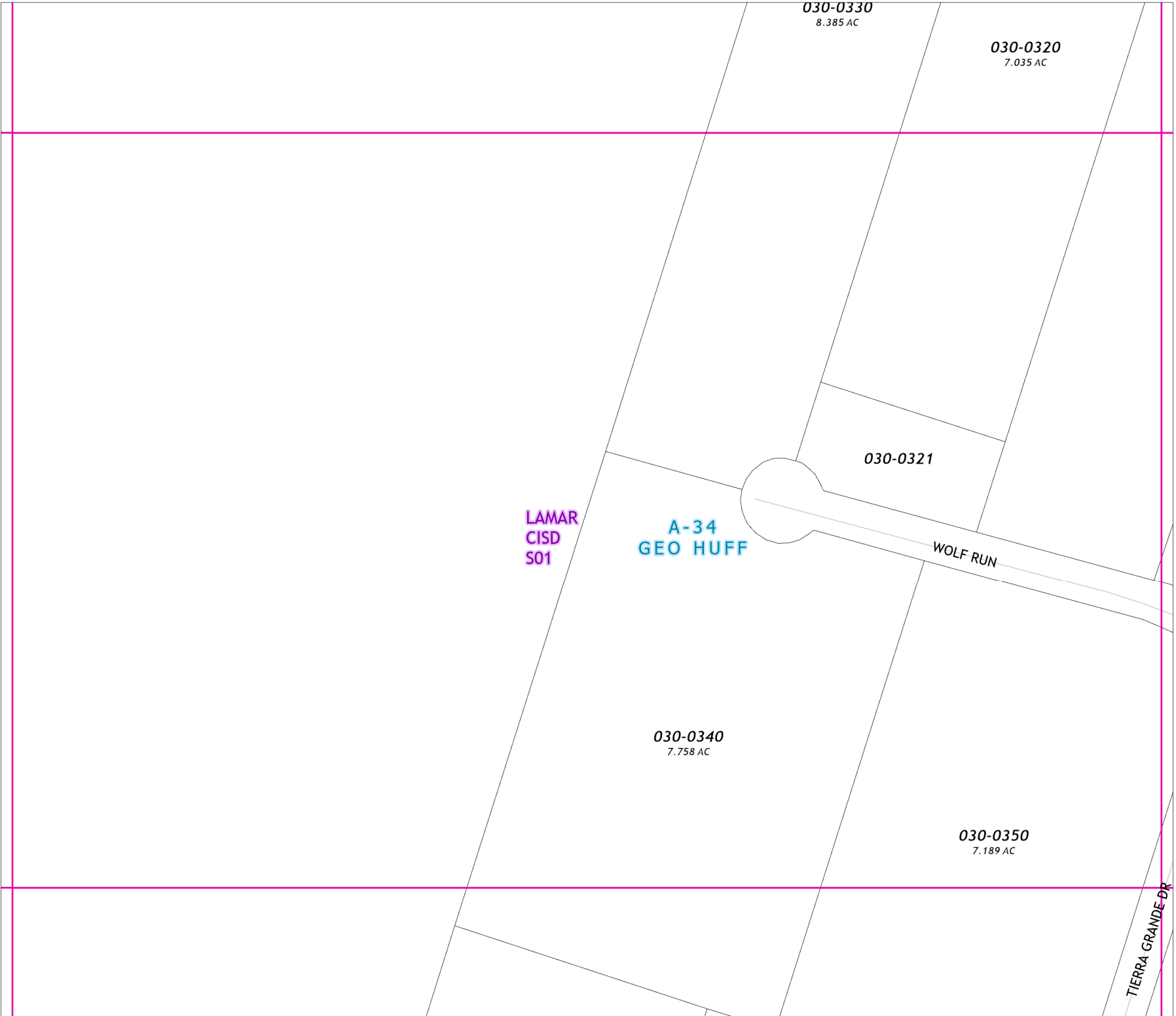

# 2021 Certified Tax Roll



Grid Page  
A-222-J4

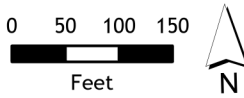

Fort Bend Central Appraisal District (FBCAD) is not authorized to determine legal title to property or establish the legal boundaries of property. FBCAD establishes appraisal records based on information from various sources, including but not limited to deeds, plats and surveys provided to but not created by the district. FBCAD is not responsible for errors or omissions in information submitted to and reviewed by the district. If any errors or omission are detected, contact the GIS Department of the FBCAD.

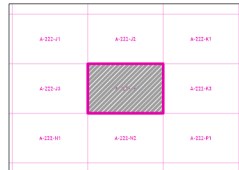

Grid Location Reference



County Location Reference

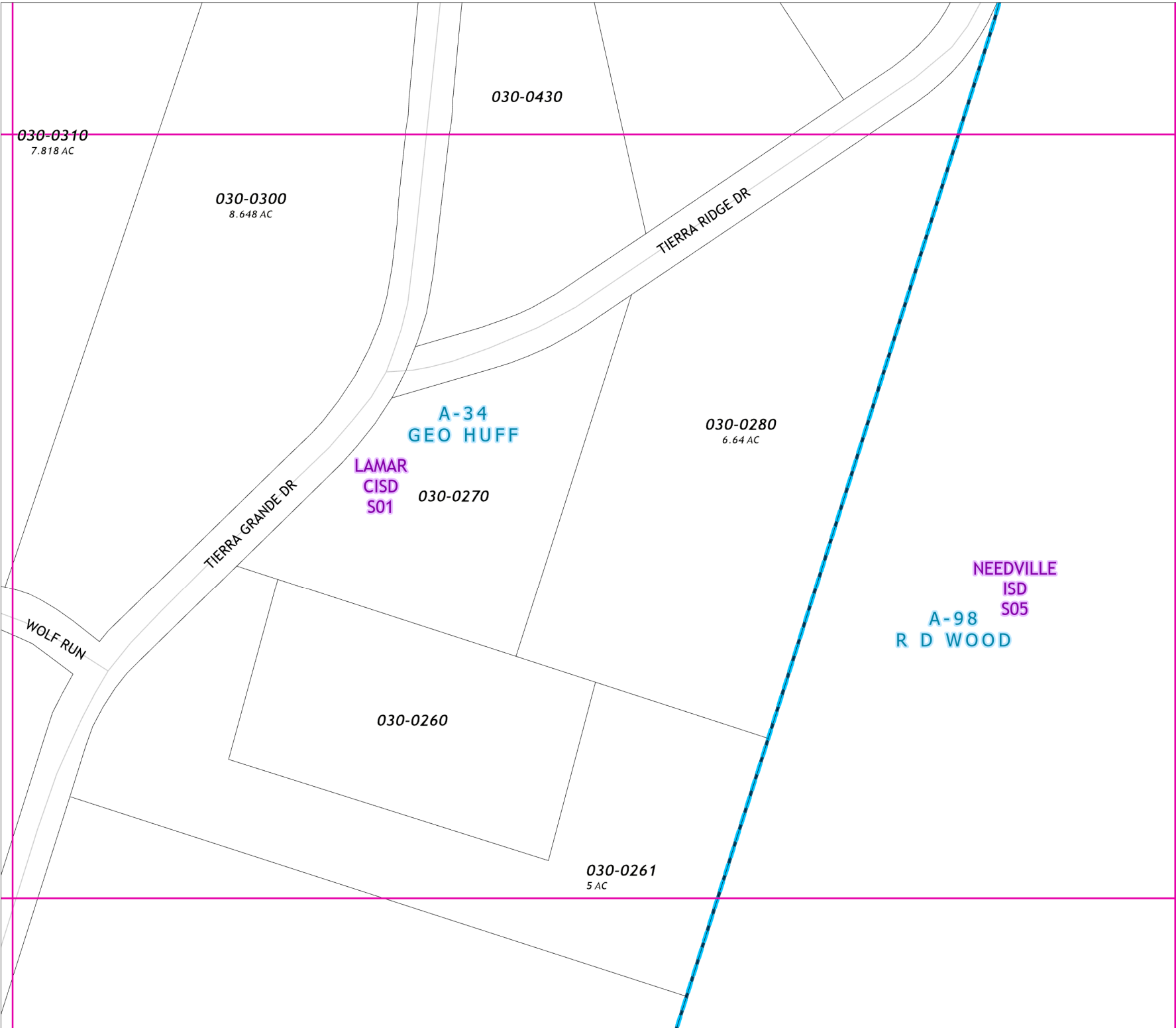



# 2021 Certified Tax Roll



**Grid Page  
A-222-K1**



Fort Bend Central Appraisal District (FBCAD) is not authorized to determine legal title to property or establish the legal boundaries of property. FBCAD establishes appraisal records based on information from various sources, including but not limited to deeds, plats and surveys provided to but not created by the district. FBCAD is not responsible for errors or omissions in information submitted to and reviewed by the district. If any errors or omission are detected, contact the GIS Department of the FBCAD.

|          |          |          |
|----------|----------|----------|
| A-222-K4 | A-222-K5 | A-222-K6 |
| A-222-K0 | A-222-K1 | A-222-K2 |
| A-222-K4 | A-222-K0 | A-222-K4 |

Grid Location Reference

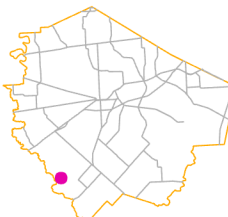

County Location Reference

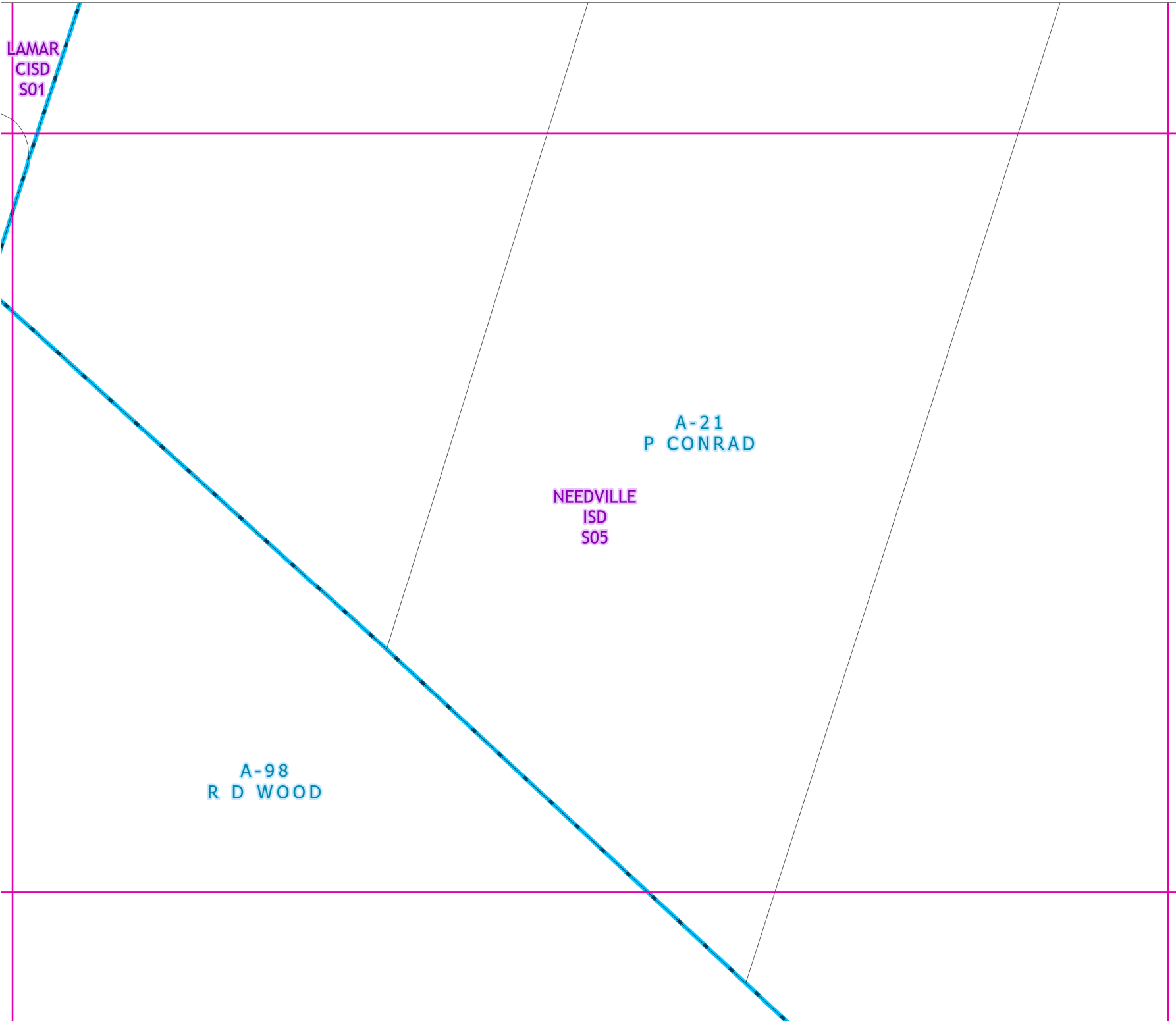

# 2021 Certified Tax Roll



**Grid Page  
A-222-K2**

**NEEDVILLE  
ISD  
S05**

**A-21  
P CONRAD**

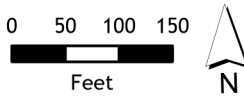

Fort Bend Central Appraisal District (FBCAD) is not authorized to determine legal title to property or establish the legal boundaries of property. FBCAD establishes appraisal records based on information from various sources, including but not limited to deeds, plats and surveys provided to but not created by the district. FBCAD is not responsible for errors or omissions in information submitted to and reviewed by the district. If any errors or omission are detected, contact the GIS Department of the FBCAD.

|          |          |          |
|----------|----------|----------|
| A-222-F3 | A-222-F4 | A-222-G8 |
| A-222-K1 |          | A-222-L1 |
| A-222-K2 | A-222-K4 | A-222-L3 |

Grid Location Reference

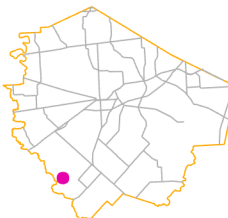

County Location Reference

# 2021 Certified Tax Roll



**Grid Page  
A-222-K3**

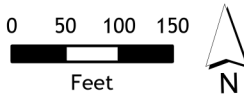

Fort Bend Central Appraisal District (FBCAD) is not authorized to determine legal title to property or establish the legal boundaries of property. FBCAD establishes appraisal records based on information from various sources, including but not limited to deeds, plats and surveys provided to but not created by the district. FBCAD is not responsible for errors or omissions in information submitted to and reviewed by the district. If any errors or omission are detected, contact the GIS Department of the FBCAD.

**A-98  
R D WOOD**

**NEEDVILLE  
ISD  
S05**

**A-21  
P CONRAD**

|          |          |          |
|----------|----------|----------|
| A-222-K2 | A-222-K1 | A-222-K3 |
| A-222-K4 |          | A-222-K4 |
| A-222-K5 | A-222-K1 | A-222-K5 |

Grid Location Reference

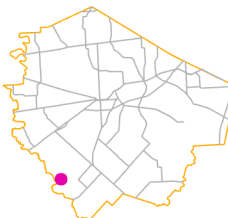

County Location Reference

# 2021 Certified Tax Roll



**Grid Page  
A-222-K4**

**A-21  
P CONRAD**

**NEEDVILLE  
ISD  
S05**

**A-98  
R D WOOD**

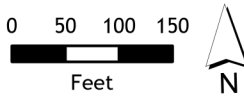

Fort Bend Central Appraisal District (FBCAD) is not authorized to determine legal title to property or establish the legal boundaries of property. FBCAD establishes appraisal records based on information from various sources, including but not limited to deeds, plats and surveys provided to but not created by the district. FBCAD is not responsible for errors or omissions in information submitted to and reviewed by the district. If any errors or omissions are detected, contact the GIS Department of the FBCAD.

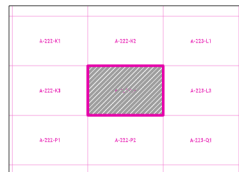

Grid Location Reference

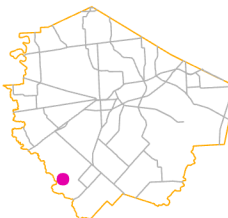

County Location Reference

# 2021 Certified Tax Roll



**Grid Page  
A-222-L1**

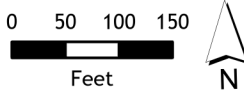

Fort Bend Central Appraisal District (FBCAD) is not authorized to determine legal title to property or establish the legal boundaries of property. FBCAD establishes appraisal records based on information from various sources, including but not limited to deeds, plats and surveys provided to but not created by the district. FBCAD is not responsible for errors or omissions in information submitted to and reviewed by the district. If any errors or omission are detected, contact the GIS Department of the FBCAD.

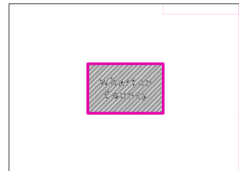

Grid Location Reference

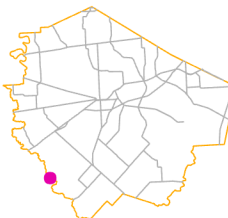

County Location Reference

# 2021 Certified Tax Roll



**Grid Page  
A-222-L2**

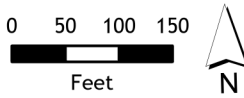

Fort Bend Central Appraisal District (FBCAD) is not authorized to determine legal title to property or establish the legal boundaries of property. FBCAD establishes appraisal records based on information from various sources, including but not limited to deeds, plats and surveys provided to but not created by the district. FBCAD is not responsible for errors or omissions in information submitted to and reviewed by the district. If any errors or omission are detected, contact the GIS Department of the FBCAD.

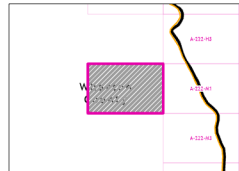

Grid Location Reference

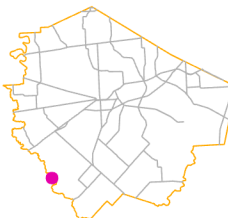

County Location Reference

# 2021 Certified Tax Roll



**Grid Page  
A-222-L3**

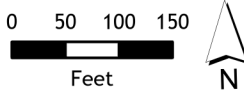

Fort Bend Central Appraisal District (FBCAD) is not authorized to determine legal title to property or establish the legal boundaries of property. FBCAD establishes appraisal records based on information from various sources, including but not limited to deeds, plats and surveys provided to but not created by the district. FBCAD is not responsible for errors or omissions in information submitted to and reviewed by the district. If any errors or omission are detected, contact the GIS Department of the FBCAD.

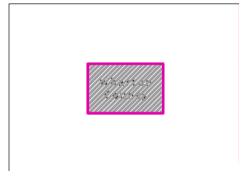

Grid Location Reference

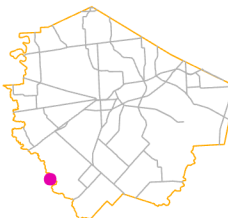

County Location Reference

# 2021 Certified Tax Roll



**Grid Page  
A-222-L4**

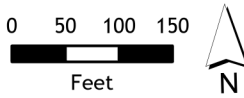

Fort Bend Central Appraisal District (FBCAD) is not authorized to determine legal title to property or establish the legal boundaries of property. FBCAD establishes appraisal records based on information from various sources, including but not limited to deeds, plats and surveys provided to but not created by the district. FBCAD is not responsible for errors or omissions in information submitted to and reviewed by the district. If any errors or omission are detected, contact the GIS Department of the FBCAD.

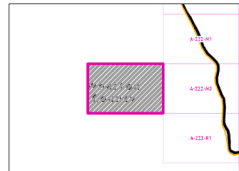

Grid Location Reference

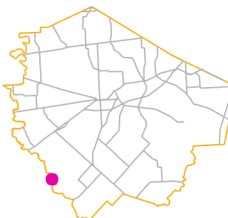

County Location Reference



# 2021 Certified Tax Roll



**Grid Page  
A-222-M1**



Fort Bend Central Appraisal District (FBCAD) is not authorized to determine legal title to property or establish the legal boundaries of property. FBCAD establishes appraisal records based on information from various sources, including but not limited to deeds, plats and surveys provided to but not created by the district. FBCAD is not responsible for errors or omissions in information submitted to and reviewed by the district. If any errors or omission are detected, contact the GIS Department of the FBCAD.

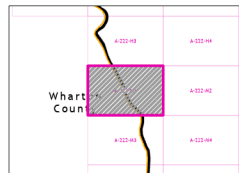

Grid Location Reference

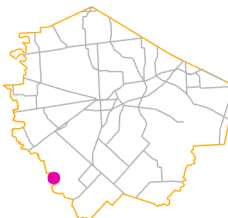

County Location Reference

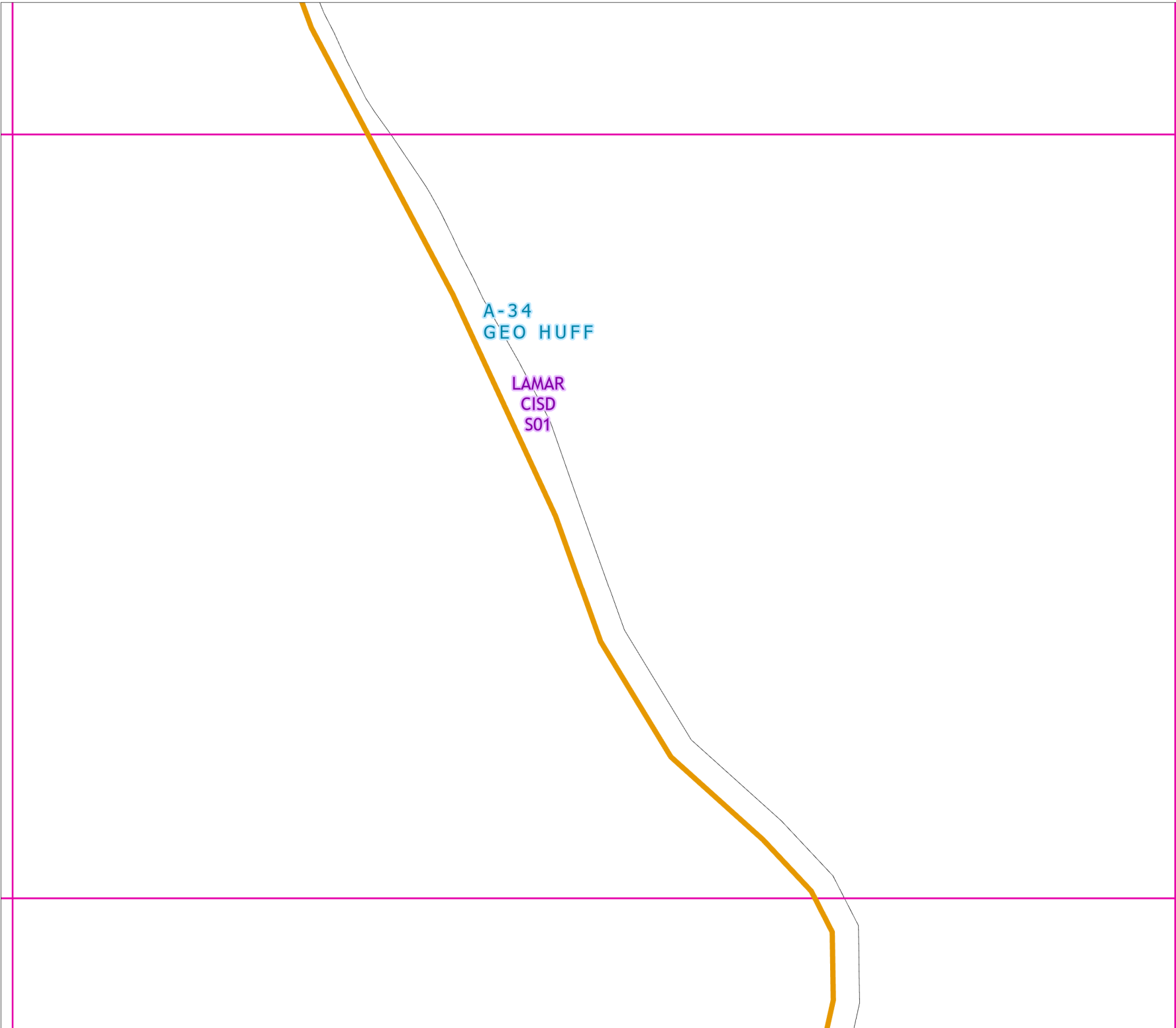

# 2021 Certified Tax Roll



**Grid Page  
A-222-M2**

**A-34  
GEO HUFF**

**LAMAR  
CISD  
S01**

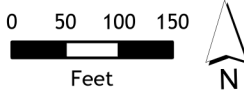

Fort Bend Central Appraisal District (FBCAD) is not authorized to determine legal title to property or establish the legal boundaries of property. FBCAD establishes appraisal records based on information from various sources, including but not limited to deeds, plats and surveys provided to but not created by the district. FBCAD is not responsible for errors or omissions in information submitted to and reviewed by the district. If any errors or omission are detected, contact the GIS Department of the FBCAD.

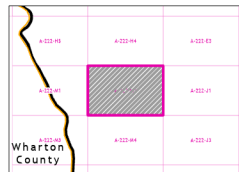

Grid Location Reference

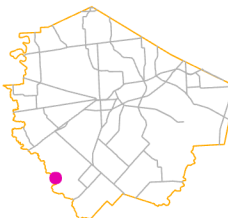

County Location Reference

# 2021 Certified Tax Roll



**Grid Page  
A-222-M3**

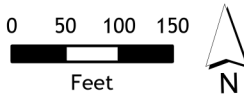

Fort Bend Central Appraisal District (FBCAD) is not authorized to determine legal title to property or establish the legal boundaries of property. FBCAD establishes appraisal records based on information from various sources, including but not limited to deeds, plats and surveys provided to but not created by the district. FBCAD is not responsible for errors or omissions in information submitted to and reviewed by the district. If any errors or omission are detected, contact the GIS Department of the FBCAD.

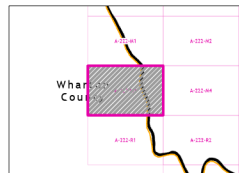

Grid Location Reference

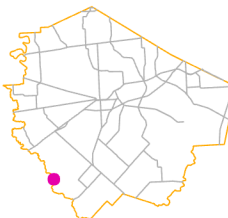

County Location Reference

LAMAR  
CISD  
S01

A-34  
GEO HUFF

# 2021 Certified Tax Roll



**Grid Page  
A-222-M4**

LAMAR  
CISD  
S01      A-34  
            GEO HUFF

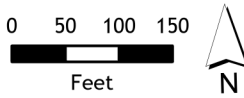

Fort Bend Central Appraisal District (FBCAD) is not authorized to determine legal title to property or establish the legal boundaries of property. FBCAD establishes appraisal records based on information from various sources, including but not limited to deeds, plats and surveys provided to but not created by the district. FBCAD is not responsible for errors or omissions in information submitted to and reviewed by the district. If any errors or omission are detected, contact the GIS Department of the FBCAD.

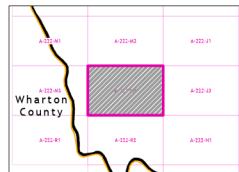

Grid Location Reference

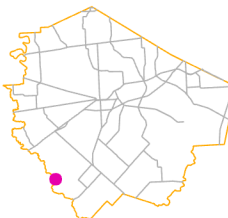

County Location Reference

# 2021 Certified Tax Roll



Grid Page  
A-222-N1

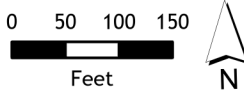

Fort Bend Central Appraisal District (FBCAD) is not authorized to determine legal title to property or establish the legal boundaries of property. FBCAD establishes appraisal records based on information from various sources, including but not limited to deeds, plats and surveys provided to but not created by the district. FBCAD is not responsible for errors or omissions in information submitted to and reviewed by the district. If any errors or omission are detected, contact the GIS Department of the FBCAD.

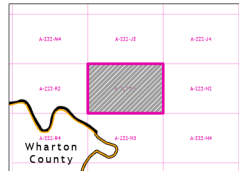

Grid Location Reference

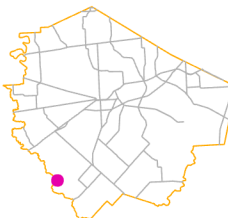

County Location Reference



# 2021 Certified Tax Roll



**Grid Page  
A-222-N2**

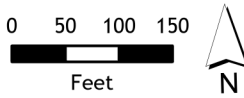

Fort Bend Central Appraisal District (FBCAD) is not authorized to determine legal title to property or establish the legal boundaries of property. FBCAD establishes appraisal records based on information from various sources, including but not limited to deeds, plats and surveys provided to but not created by the district. FBCAD is not responsible for errors or omissions in information submitted to and reviewed by the district. If any errors or omissions are detected, contact the GIS Department of the FBCAD.

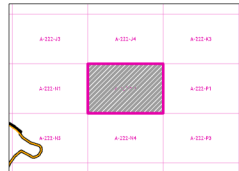

Grid Location Reference

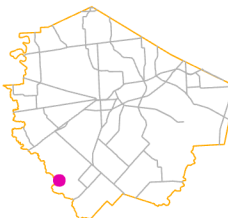

County Location Reference

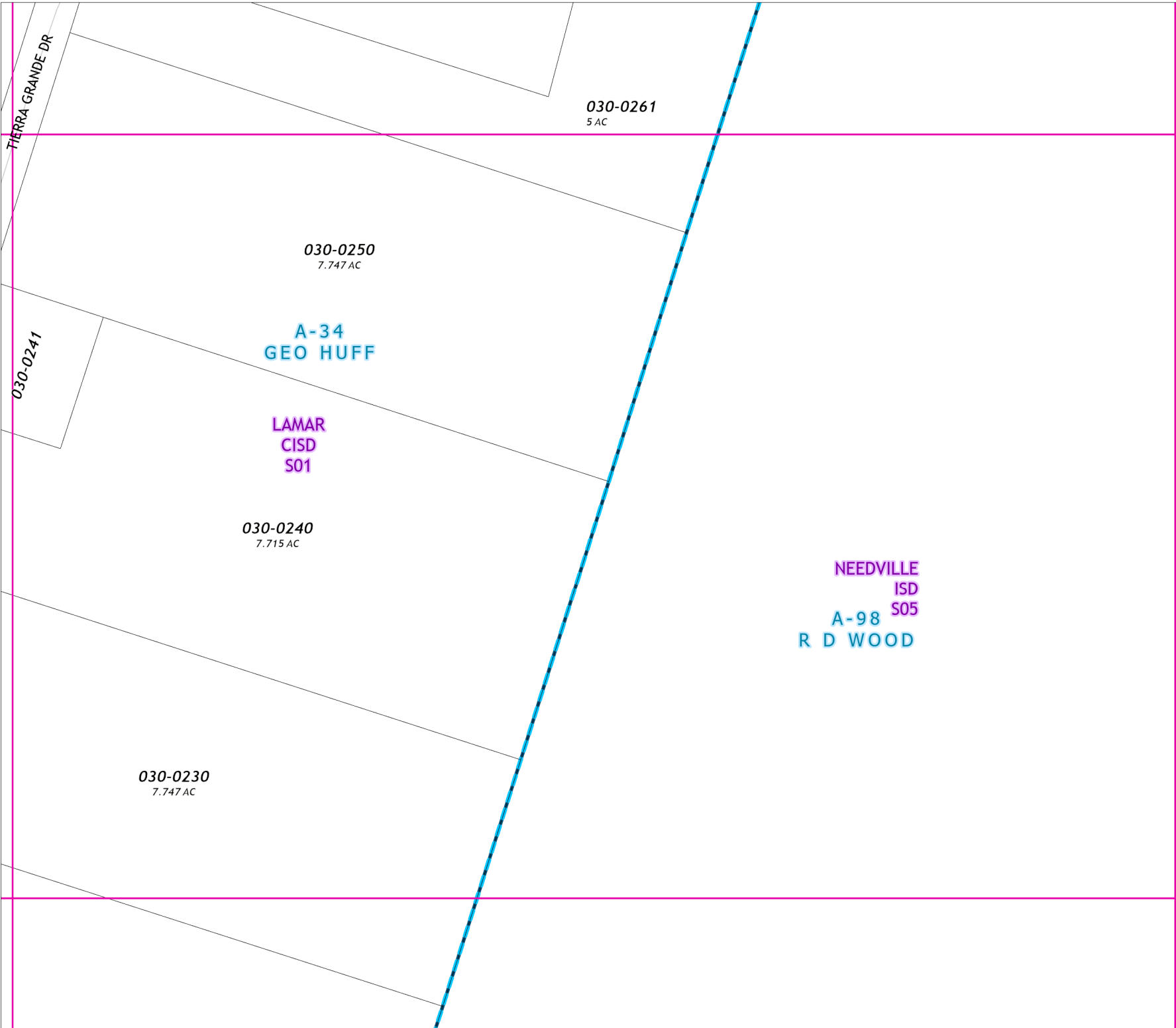

# 2021 Certified Tax Roll



**Grid Page  
A-222-N3**



Fort Bend Central Appraisal District (FBCAD) is not authorized to determine legal title to property or establish the legal boundaries of property. FBCAD establishes appraisal records based on information from various sources, including but not limited to deeds, plats and surveys provided to but not created by the district. FBCAD is not responsible for errors or omissions in information submitted to and reviewed by the district. If any errors or omission are detected, contact the GIS Department of the FBCAD.

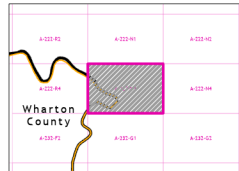

Grid Location Reference

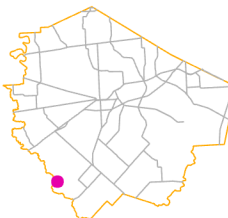

County Location Reference

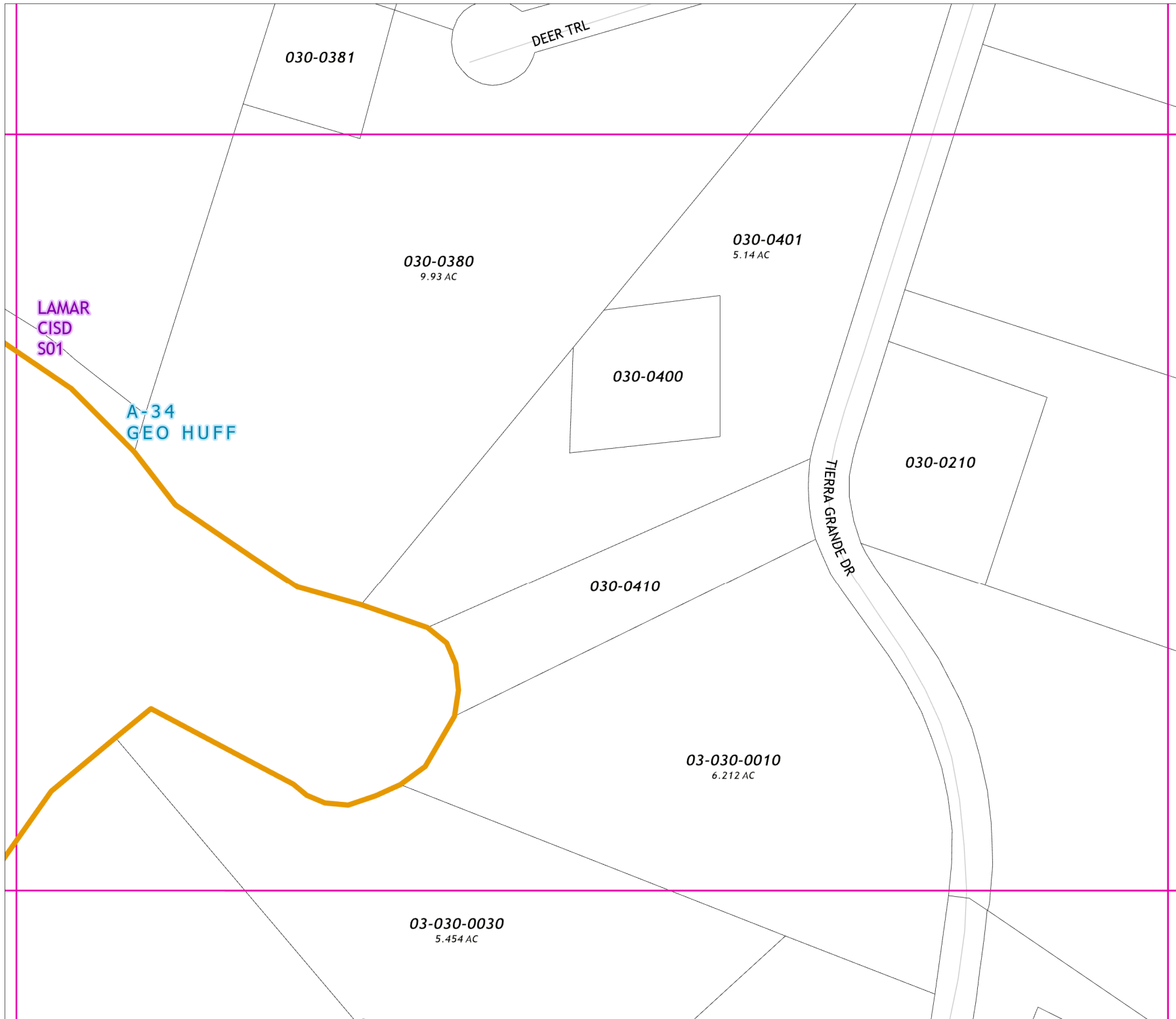

# 2021 Certified Tax Roll



**Grid Page  
A-222-N4**

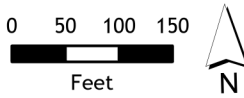

Fort Bend Central Appraisal District (FBCAD) is not authorized to determine legal title to property or establish the legal boundaries of property. FBCAD establishes appraisal records based on information from various sources, including but not limited to deeds, plats and surveys provided to but not created by the district. FBCAD is not responsible for errors or omissions in information submitted to and reviewed by the district. If any errors or omission are detected, contact the GIS Department of the FBCAD.

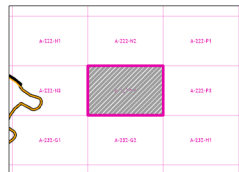

Grid Location Reference



County Location Reference

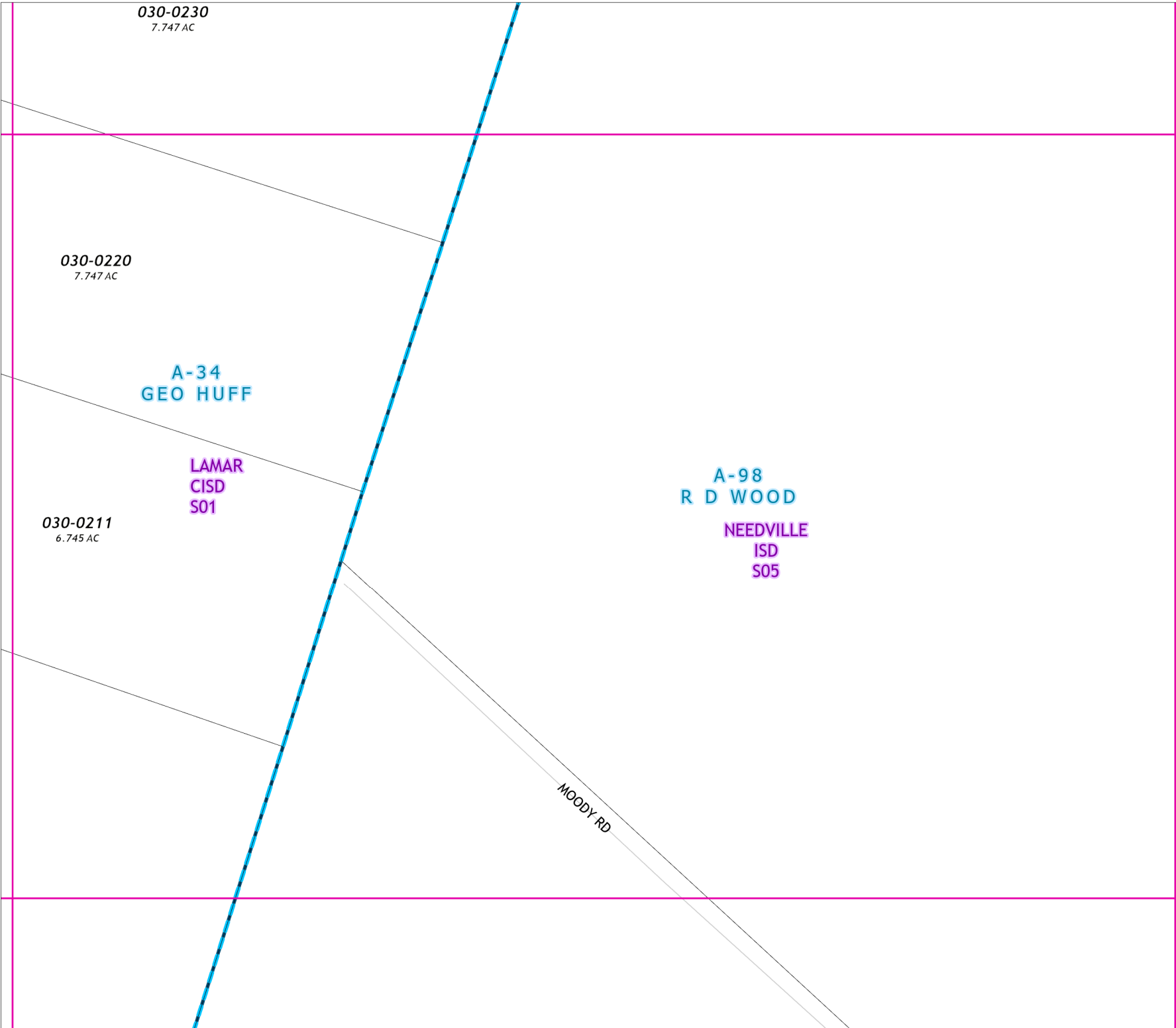



# 2021 Certified Tax Roll



**Grid Page  
A-222-P1**



Fort Bend Central Appraisal District (FBCAD) is not authorized to determine legal title to property or establish the legal boundaries of property. FBCAD establishes appraisal records based on information from various sources, including but not limited to deeds, plats and surveys provided to but not created by the district. FBCAD is not responsible for errors or omissions in information submitted to and reviewed by the district. If any errors or omission are detected, contact the GIS Department of the FBCAD.

NEEDVILLE  
ISD  
S05

A-98  
R D WOOD

0010  
237.5 AC

|          |          |          |
|----------|----------|----------|
| A-222-P4 | A-222-P3 | A-222-P2 |
| A-222-P5 | A-222-P1 | A-222-P6 |
| A-222-P8 | A-222-P9 | A-222-P7 |

Grid Location Reference

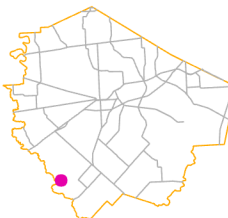

County Location Reference

# 2021 Certified Tax Roll



**Grid Page  
A-222-P2**

2800  
100 AC

NEEDVILLE  
ISD  
S05

A-98  
R D WOOD

A-21  
P CONRAD

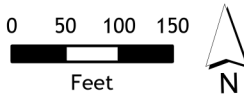

Fort Bend Central Appraisal District (FBCAD) is not authorized to determine legal title to property or establish the legal boundaries of property. FBCAD establishes appraisal records based on information from various sources, including but not limited to deeds, plats and surveys provided to but not created by the district. FBCAD is not responsible for errors or omissions in information submitted to and reviewed by the district. If any errors or omission are detected, contact the GIS Department of the FBCAD.

|          |          |          |
|----------|----------|----------|
| A-222-03 | A-222-04 | A-222-13 |
| A-222-01 |          | A-222-02 |
| A-222-05 | A-222-04 | A-222-02 |

Grid Location Reference

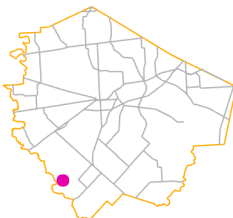

County Location Reference

# 2021 Certified Tax Roll



**Grid Page  
A-222-P3**

**A-98  
R D WOOD**

**NEEDVILLE  
ISD  
S05**

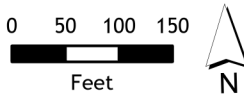

Fort Bend Central Appraisal District (FBCAD) is not authorized to determine legal title to property or establish the legal boundaries of property. FBCAD establishes appraisal records based on information from various sources, including but not limited to deeds, plats and surveys provided to but not created by the district. FBCAD is not responsible for errors or omissions in information submitted to and reviewed by the district. If any errors or omission are detected, contact the GIS Department of the FBCAD.

|          |          |          |
|----------|----------|----------|
| A-222-H0 | A-222-P1 | A-222-P2 |
| A-222-H4 | A-222-P3 | A-222-P4 |
| A-222-H8 | A-222-H1 | A-222-H5 |

Grid Location Reference

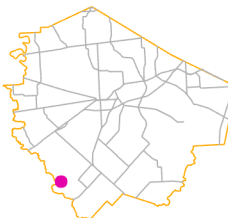

County Location Reference

A-21  
P CONRAD

# 2021 Certified Tax Roll



**Grid Page**  
**A-222-P4**

NEEDVILLE  
ISD  
S05  
A-98  
R D WOOD

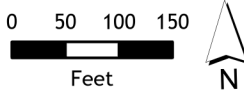

Fort Bend Central Appraisal District (FBCAD) is not authorized to determine legal title to property or establish the legal boundaries of property. FBCAD establishes appraisal records based on information from various sources, including but not limited to deeds, plats and surveys provided to but not created by the district. FBCAD is not responsible for errors or omissions in information submitted to and reviewed by the district. If any errors or omission are detected, contact the GIS Department of the FBCAD.

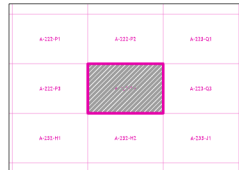

Grid Location Reference

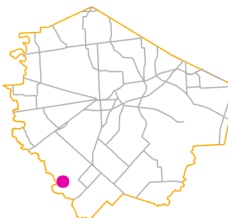

County Location Reference

# 2021 Certified Tax Roll



**Grid Page  
A-222-Q1**

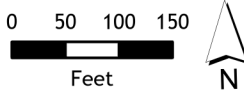

Fort Bend Central Appraisal District (FBCAD) is not authorized to determine legal title to property or establish the legal boundaries of property. FBCAD establishes appraisal records based on information from various sources, including but not limited to deeds, plats and surveys provided to but not created by the district. FBCAD is not responsible for errors or omissions in information submitted to and reviewed by the district. If any errors or omission are detected, contact the GIS Department of the FBCAD.

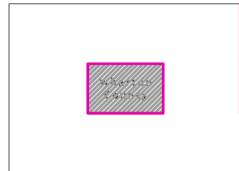

Grid Location Reference

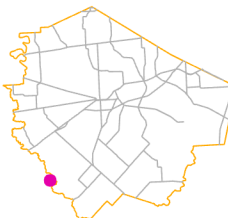

County Location Reference

# 2021 Certified Tax Roll



**Grid Page  
A-222-Q2**

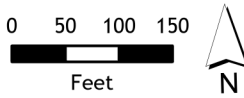

Fort Bend Central Appraisal District (FBCAD) is not authorized to determine legal title to property or establish the legal boundaries of property. FBCAD establishes appraisal records based on information from various sources, including but not limited to deeds, plats and surveys provided to but not created by the district. FBCAD is not responsible for errors or omissions in information submitted to and reviewed by the district. If any errors or omission are detected, contact the GIS Department of the FBCAD.

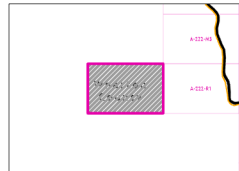

Grid Location Reference

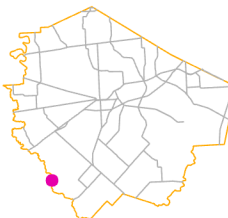

County Location Reference

# 2021 Certified Tax Roll



**Grid Page  
A-222-Q3**

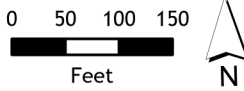

Fort Bend Central Appraisal District (FBCAD) is not authorized to determine legal title to property or establish the legal boundaries of property. FBCAD establishes appraisal records based on information from various sources, including but not limited to deeds, plats and surveys provided to but not created by the district. FBCAD is not responsible for errors or omissions in information submitted to and reviewed by the district. If any errors or omission are detected, contact the GIS Department of the FBCAD.

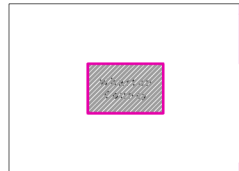

Grid Location Reference

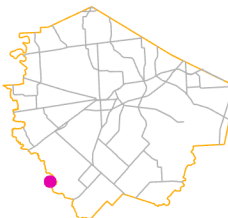

County Location Reference

# 2021 Certified Tax Roll



**Grid Page  
A-222-Q4**

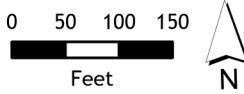

Fort Bend Central Appraisal District (FBCAD) is not authorized to determine legal title to property or establish the legal boundaries of property. FBCAD establishes appraisal records based on information from various sources, including but not limited to deeds, plats and surveys provided to but not created by the district. FBCAD is not responsible for errors or omissions in information submitted to and reviewed by the district. If any errors or omission are detected, contact the GIS Department of the FBCAD.

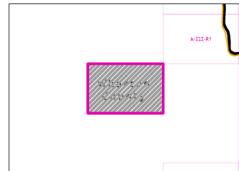

Grid Location Reference

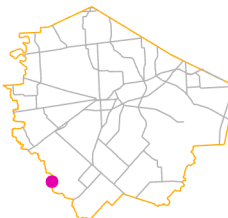

County Location Reference



# 2021 Certified Tax Roll



**Grid Page  
A-222-R1**

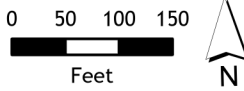

Fort Bend Central Appraisal District (FBCAD) is not authorized to determine legal title to property or establish the legal boundaries of property. FBCAD establishes appraisal records based on information from various sources, including but not limited to deeds, plats and surveys provided to but not created by the district. FBCAD is not responsible for errors or omissions in information submitted to and reviewed by the district. If any errors or omission are detected, contact the GIS Department of the FBCAD.

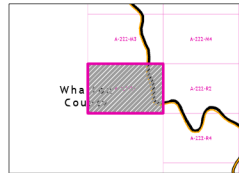

Grid Location Reference

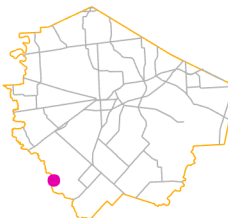

County Location Reference

**LAMAR  
CISD  
S01**

**A-34  
GEO HUFF**

# 2021 Certified Tax Roll



**Grid Page  
A-222-R2**



Fort Bend Central Appraisal District (FBCAD) is not authorized to determine legal title to property or establish the legal boundaries of property. FBCAD establishes appraisal records based on information from various sources, including but not limited to deeds, plats and surveys provided to but not created by the district. FBCAD is not responsible for errors or omissions in information submitted to and reviewed by the district. If any errors or omission are detected, contact the GIS Department of the FBCAD.

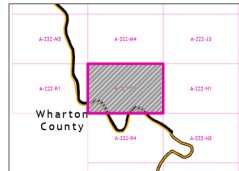

Grid Location Reference

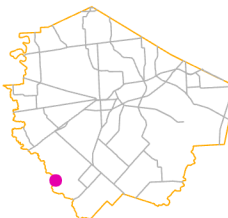

County Location Reference

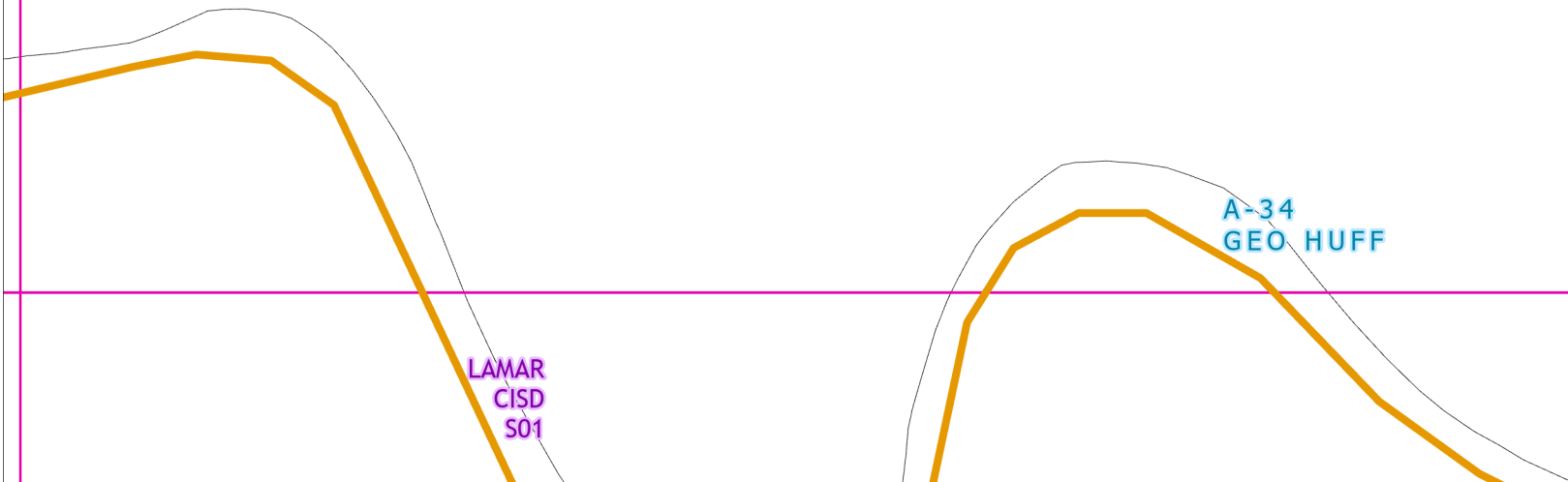

# 2021 Certified Tax Roll



**Grid Page  
A-222-R3**



Fort Bend Central Appraisal District (FBCAD) is not authorized to determine legal title to property or establish the legal boundaries of property. FBCAD establishes appraisal records based on information from various sources, including but not limited to deeds, plats and surveys provided to but not created by the district. FBCAD is not responsible for errors or omissions in information submitted to and reviewed by the district. If any errors or omission are detected, contact the GIS Department of the FBCAD.

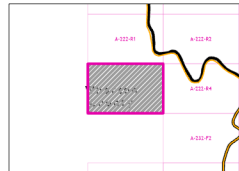

Grid Location Reference

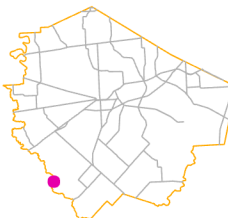

County Location Reference

# 2021 Certified Tax Roll



**Grid Page  
A-222-R4**

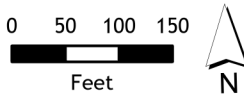

Fort Bend Central Appraisal District (FBCAD) is not authorized to determine legal title to property or establish the legal boundaries of property. FBCAD establishes appraisal records based on information from various sources, including but not limited to deeds, plats and surveys provided to but not created by the district. FBCAD is not responsible for errors or omissions in information submitted to and reviewed by the district. If any errors or omission are detected, contact the GIS Department of the FBCAD.

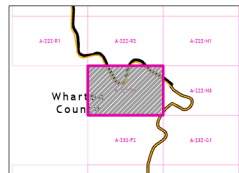

Grid Location Reference

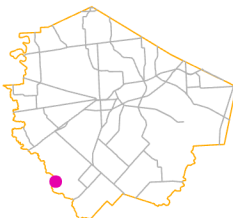

County Location Reference

LAMAR  
CISD  
S01

A-34  
GEO HUFF