

# 2021 Certified Tax Roll



**Grid Page  
A-217-A1**



Fort Bend Central Appraisal District (FBCAD) is not authorized to determine legal title to property or establish the legal boundaries of property. FBCAD establishes appraisal records based on information from various sources, including but not limited to deeds, plats and surveys provided to but not created by the district. FBCAD is not responsible for errors or omissions in information submitted to and reviewed by the district. If any errors or omission are detected, contact the GIS Department of the FBCAD.

A-217-A1	A-217-A2	A-217-A3
A-217-A4	A-217-A5	A-217-A6
A-217-A7	A-217-A8	A-217-A9

Grid Location Reference



County Location Reference

A-730  
O'NEIL CHANNEL

NEEDVILLE  
ISD  
S05 A-251  
H & TC RR SEC 102

# 2021 Certified Tax Roll



**Grid Page  
A-217-A2**

**A-251  
H & TC RR SEC 102**

**NEEDVILLE  
ISD  
S05**

**A-256  
H & TC RR SEC 111**

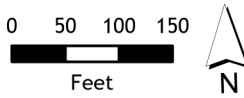

Fort Bend Central Appraisal District (FBCAD) is not authorized to determine legal title to property or establish the legal boundaries of property. FBCAD establishes appraisal records based on information from various sources, including but not limited to deeds, plats and surveys provided to but not created by the district. FBCAD is not responsible for errors or omissions in information submitted to and reviewed by the district. If any errors or omission are detected, contact the GIS Department of the FBCAD.

A-217-01	A-217-04	A-218-02
A-217-01		A-218-01
A-217-02	A-217-04	A-218-01

Grid Location Reference



County Location Reference

# 2021 Certified Tax Roll



**Grid Page  
A-217-A3**

**A-251  
H & TC RR SEC 102  
NEEDVILLE  
ISD  
S05**

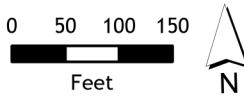

Fort Bend Central Appraisal District (FBCAD) is not authorized to determine legal title to property or establish the legal boundaries of property. FBCAD establishes appraisal records based on information from various sources, including but not limited to deeds, plats and surveys provided to but not created by the district. FBCAD is not responsible for errors or omissions in information submitted to and reviewed by the district. If any errors or omission are detected, contact the GIS Department of the FBCAD.

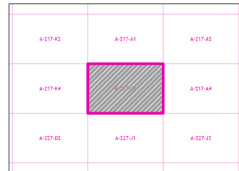

Grid Location Reference



County Location Reference

**A-581  
D J JONES**

**A-256  
H & TC RR SEC 111**

# 2021 Certified Tax Roll



**Grid Page  
A-217-A4**



Fort Bend Central Appraisal District (FBCAD) is not authorized to determine legal title to property or establish the legal boundaries of property. FBCAD establishes appraisal records based on information from various sources, including but not limited to deeds, plats and surveys provided to but not created by the district. FBCAD is not responsible for errors or omissions in information submitted to and reviewed by the district. If any errors or omission are detected, contact the GIS Department of the FBCAD.

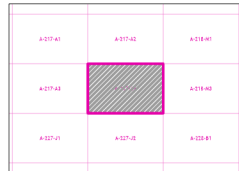

Grid Location Reference



County Location Reference

**A-251  
H & TC RR SEC 102**

**NEEDVILLE  
ISD  
S05**

**A-256  
H & TC RR SEC 111**

# 2021 Certified Tax Roll



**Grid Page  
A-217-B1**



Fort Bend Central Appraisal District (FBCAD) is not authorized to determine legal title to property or establish the legal boundaries of property. FBCAD establishes appraisal records based on information from various sources, including but not limited to deeds, plats and surveys provided to but not created by the district. FBCAD is not responsible for errors or omissions in information submitted to and reviewed by the district. If any errors or omission are detected, contact the GIS Department of the FBCAD.

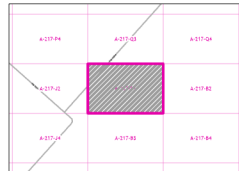

Grid Location Reference



County Location Reference

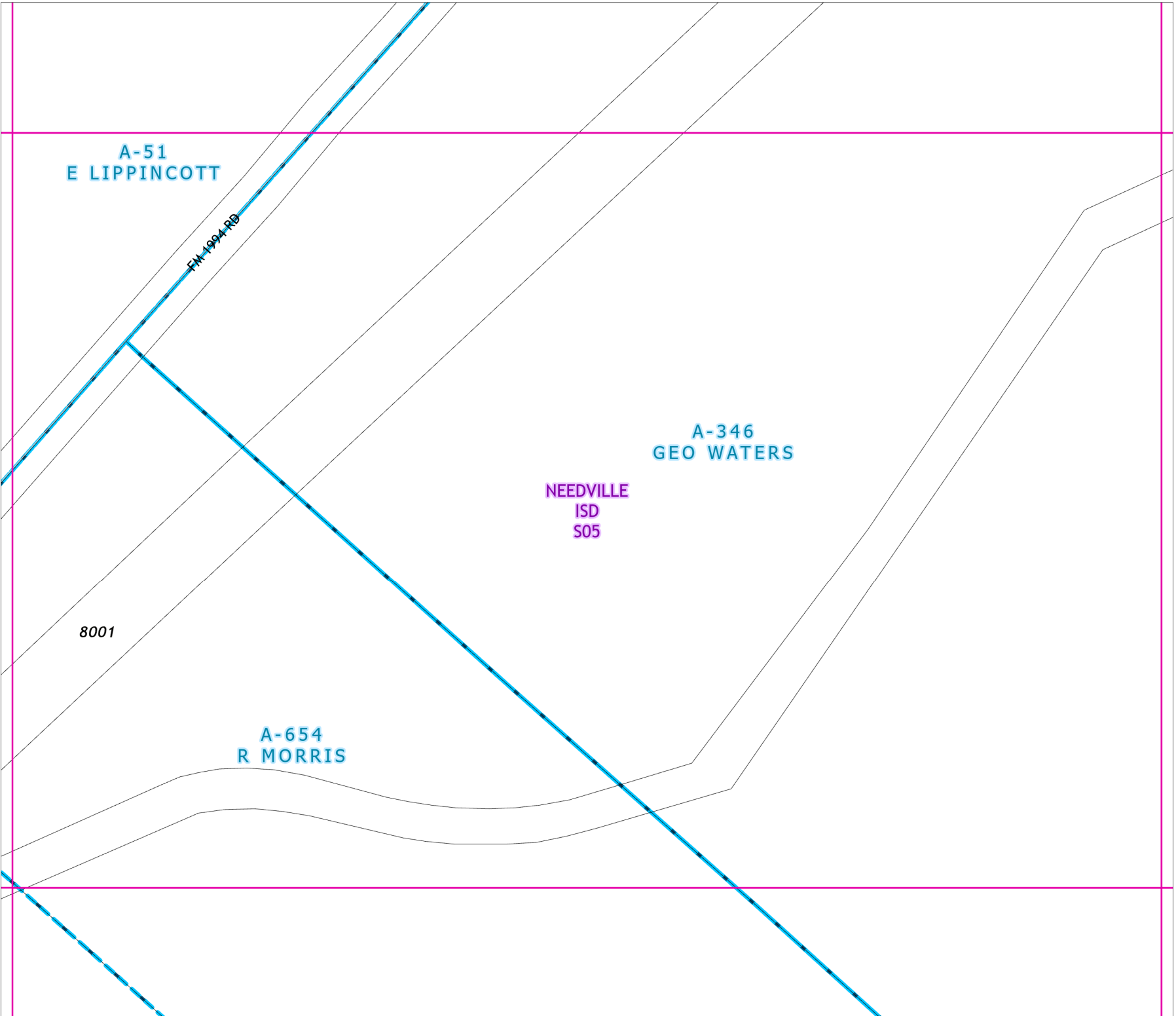

# 2021 Certified Tax Roll



**Grid Page  
A-217-B2**



Fort Bend Central Appraisal District (FBCAD) is not authorized to determine legal title to property or establish the legal boundaries of property. FBCAD establishes appraisal records based on information from various sources, including but not limited to deeds, plats and surveys provided to but not created by the district. FBCAD is not responsible for errors or omissions in information submitted to and reviewed by the district. If any errors or omission are detected, contact the GIS Department of the FBCAD.

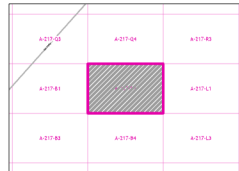

Grid Location Reference



County Location Reference

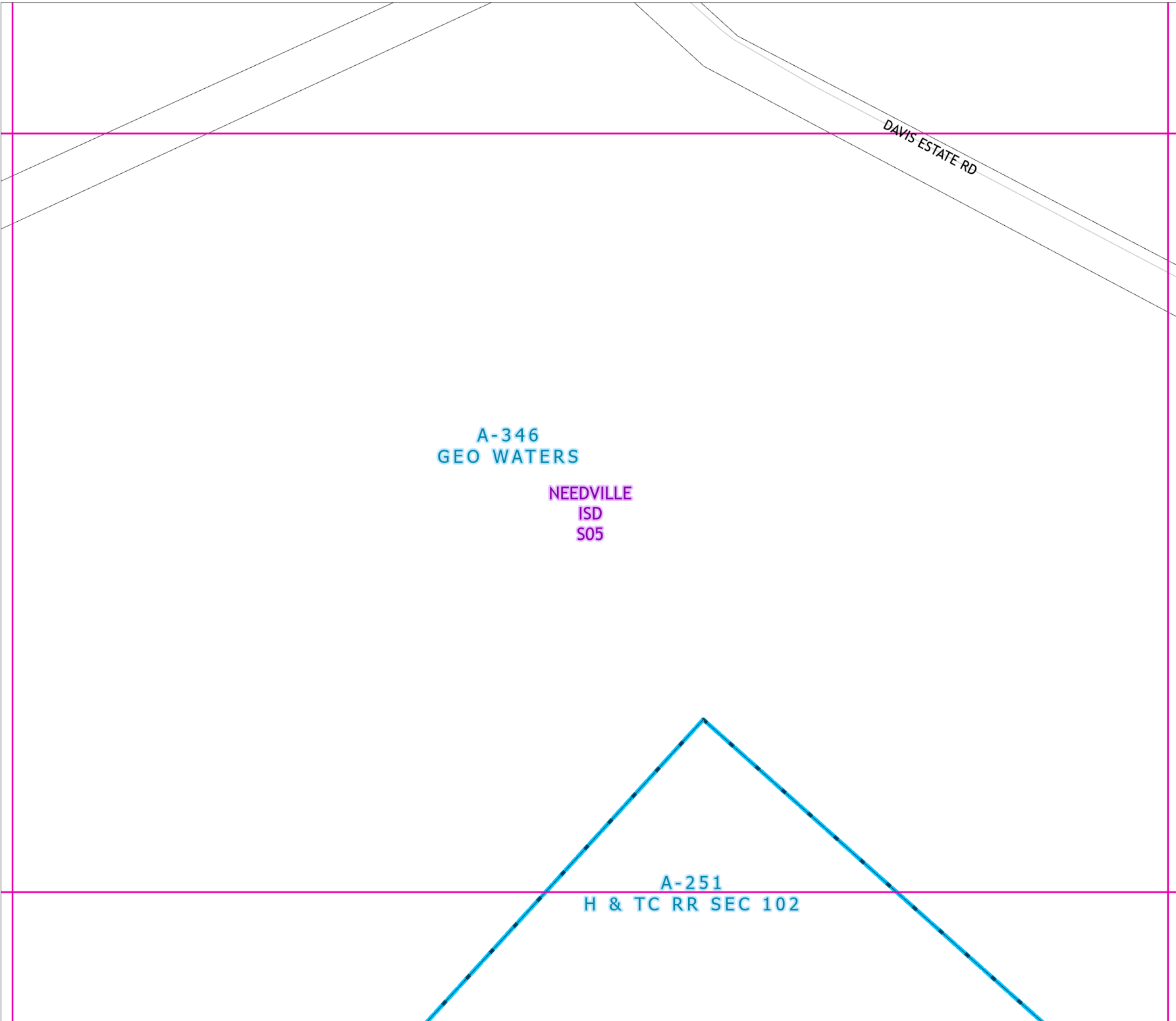

# 2021 Certified Tax Roll



**Grid Page  
A-217-B3**



Fort Bend Central Appraisal District (FBCAD) is not authorized to determine legal title to property or establish the legal boundaries of property. FBCAD establishes appraisal records based on information from various sources, including but not limited to deeds, plats and surveys provided to but not created by the district. FBCAD is not responsible for errors or omissions in information submitted to and reviewed by the district. If any errors or omission are detected, contact the GIS Department of the FBCAD.

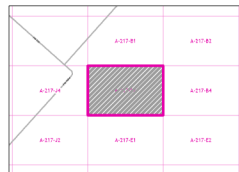

Grid Location Reference



County Location Reference

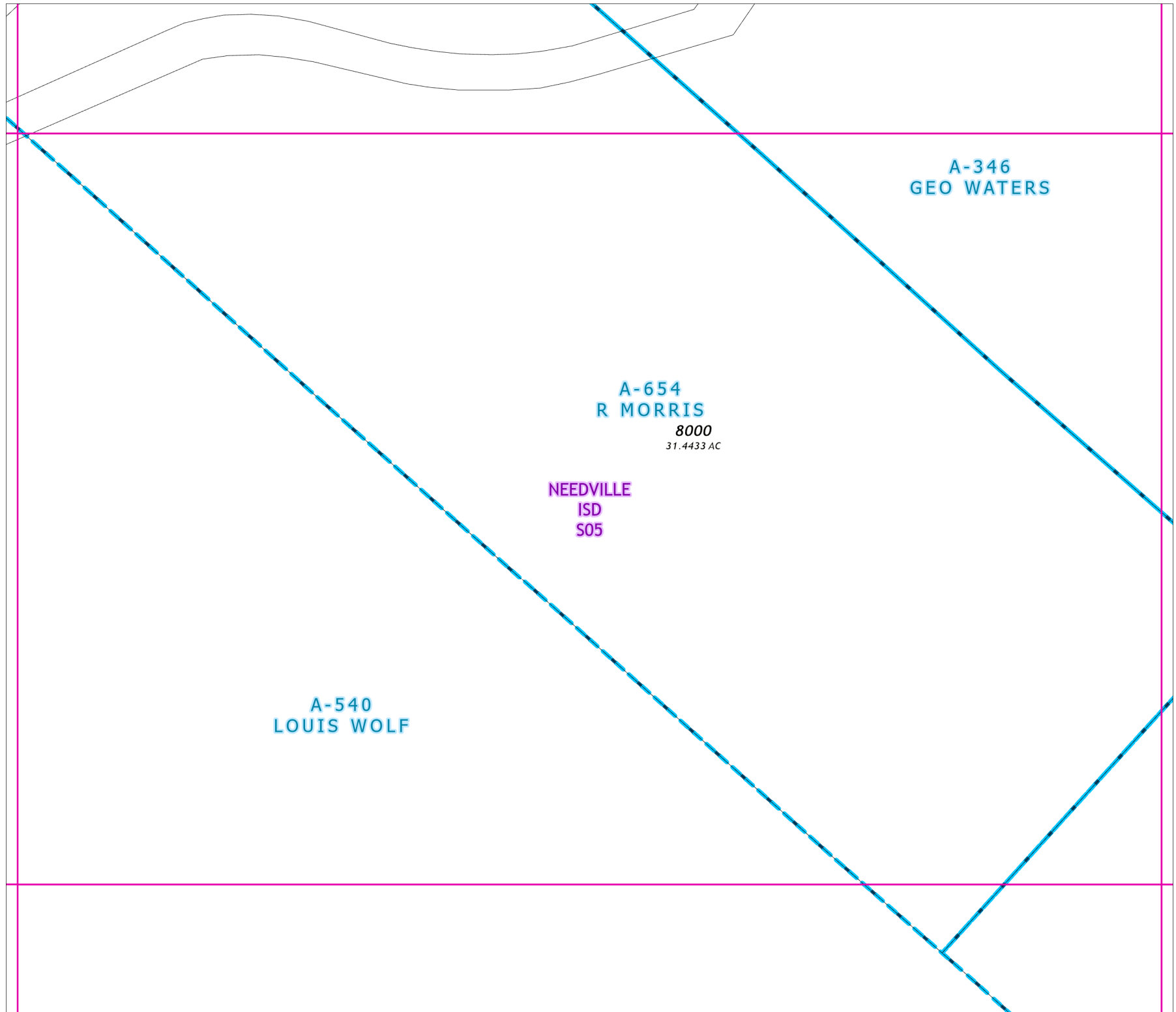

# 2021 Certified Tax Roll



**Grid Page  
A-217-B4**



Fort Bend Central Appraisal District (FBCAD) is not authorized to determine legal title to property or establish the legal boundaries of property. FBCAD establishes appraisal records based on information from various sources, including but not limited to deeds, plats and surveys provided to but not created by the district. FBCAD is not responsible for errors or omissions in information submitted to and reviewed by the district. If any errors or omission are detected, contact the GIS Department of the FBCAD.

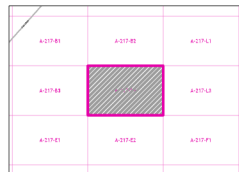

Grid Location Reference



County Location Reference

**A-346  
GEO WATERS**

**NEEDVILLE  
ISD  
S05**

**A-251  
H & TC RR SEC 102**



# 2021 Certified Tax Roll



Grid Page  
A-217-D1



Fort Bend Central Appraisal District (FBCAD) is not authorized to determine legal title to property or establish the legal boundaries of property. FBCAD establishes appraisal records based on information from various sources, including but not limited to deeds, plats and surveys provided to but not created by the district. FBCAD is not responsible for errors or omissions in information submitted to and reviewed by the district. If any errors or omission are detected, contact the GIS Department of the FBCAD.

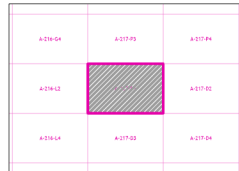

Grid Location Reference



County Location Reference

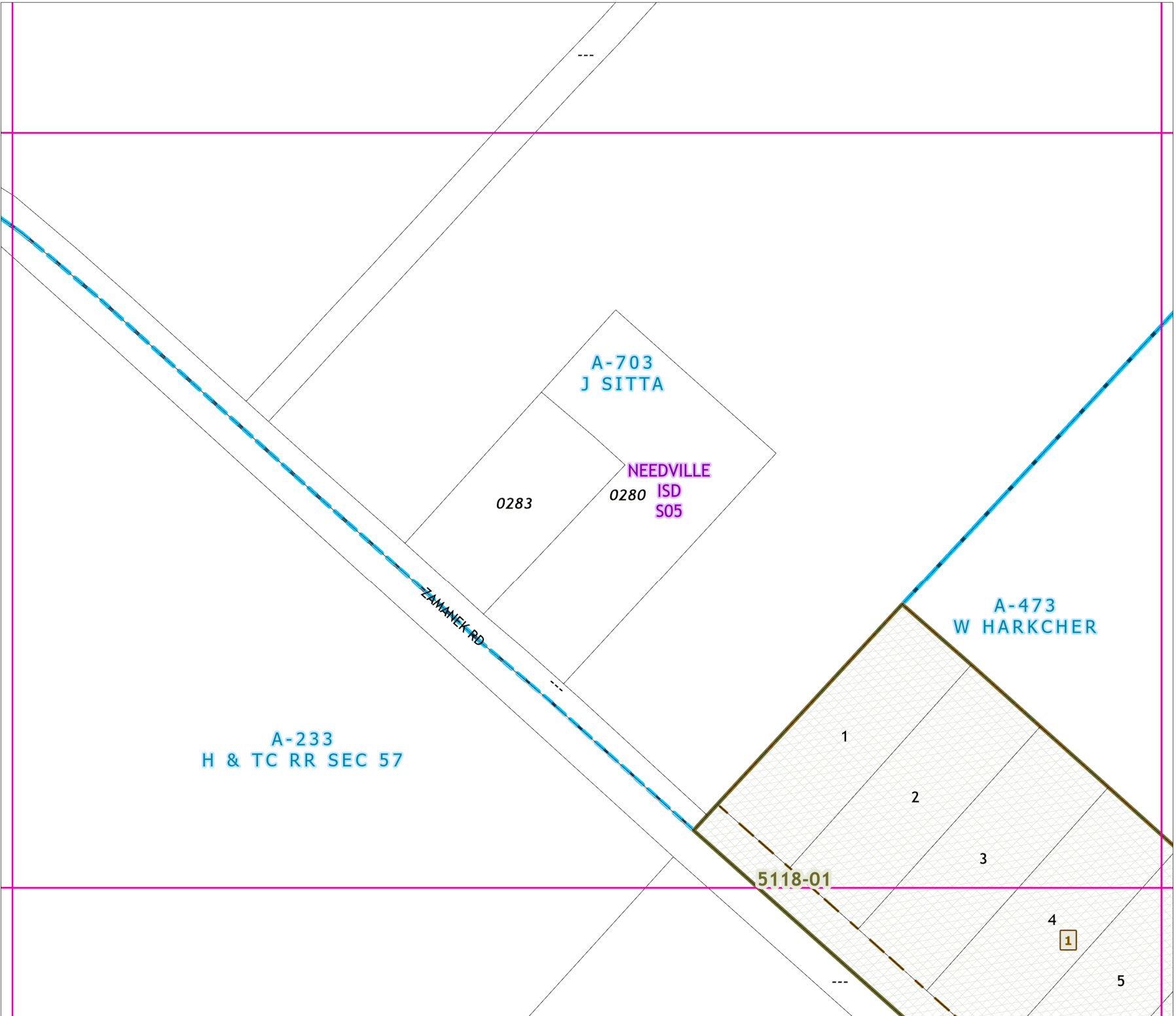

# 2021 Certified Tax Roll



**Grid Page  
A-217-D2**



Fort Bend Central Appraisal District (FBCAD) is not authorized to determine legal title to property or establish the legal boundaries of property. FBCAD establishes appraisal records based on information from various sources, including but not limited to deeds, plats and surveys provided to but not created by the district. FBCAD is not responsible for errors or omissions in information submitted to and reviewed by the district. If any errors or omission are detected, contact the GIS Department of the FBCAD.

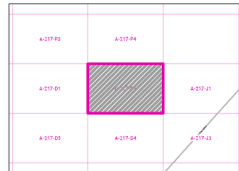

Grid Location Reference

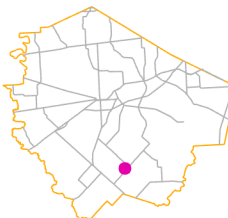

County Location Reference

A-703  
J SITTA

A-473  
W HARKCHER

NEEDVILLE  
ISD  
S05

0010  
110.081 AC

5118-01

1

# 2021 Certified Tax Roll



**Grid Page  
A-217-D3**



Fort Bend Central Appraisal District (FBCAD) is not authorized to determine legal title to property or establish the legal boundaries of property. FBCAD establishes appraisal records based on information from various sources, including but not limited to deeds, plats and surveys provided to but not created by the district. FBCAD is not responsible for errors or omissions in information submitted to and reviewed by the district. If any errors or omission are detected, contact the GIS Department of the FBCAD.

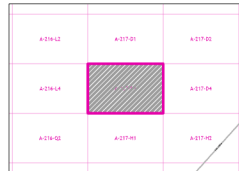

Grid Location Reference



County Location Reference

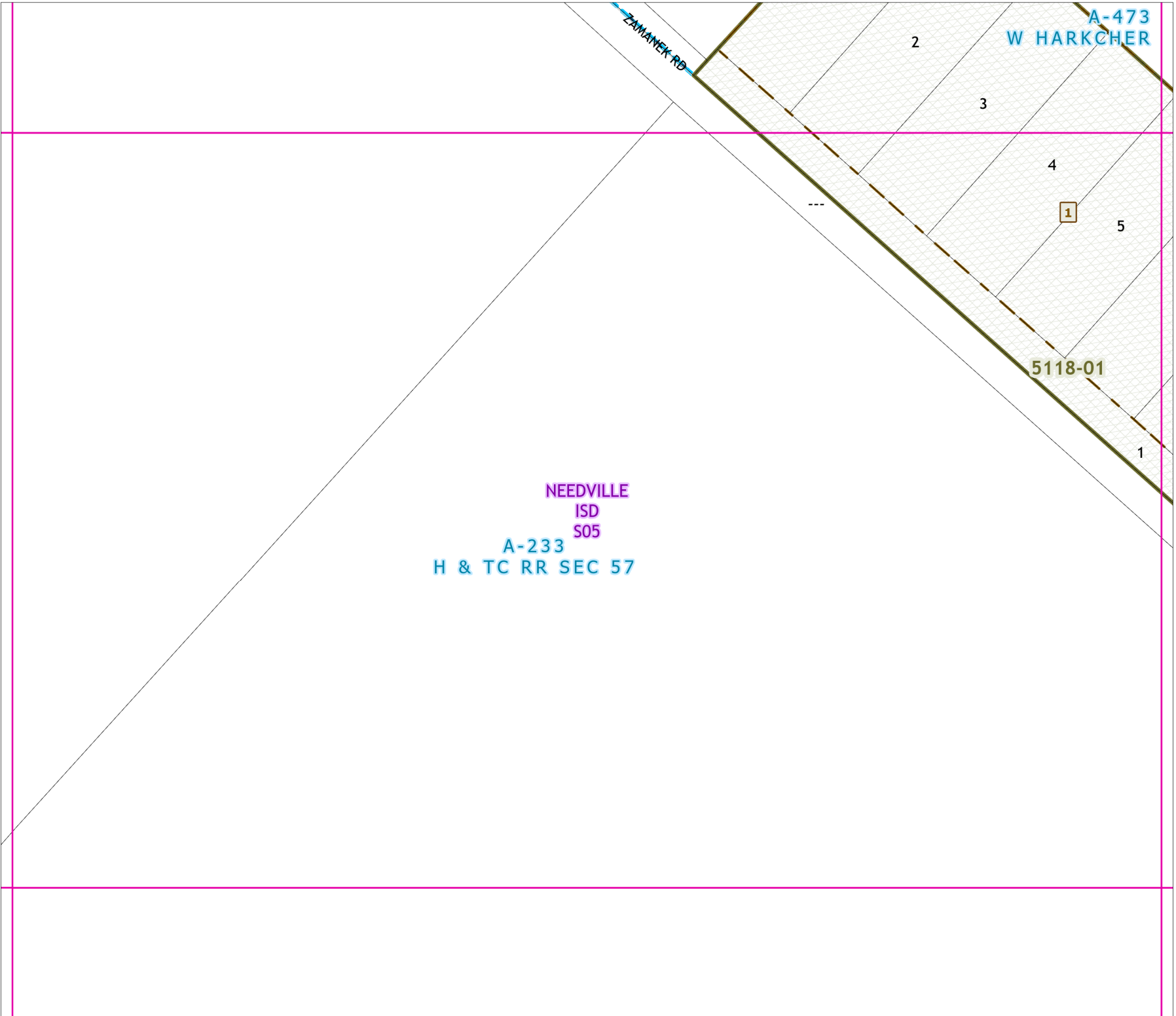

# 2021 Certified Tax Roll



Grid Page  
A-217-D4



Fort Bend Central Appraisal District (FBCAD) is not authorized to determine legal title to property or establish the legal boundaries of property. FBCAD establishes appraisal records based on information from various sources, including but not limited to deeds, plats and surveys provided to but not created by the district. FBCAD is not responsible for errors or omissions in information submitted to and reviewed by the district. If any errors or omission are detected, contact the GIS Department of the FBCAD.

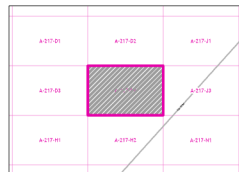

Grid Location Reference



County Location Reference

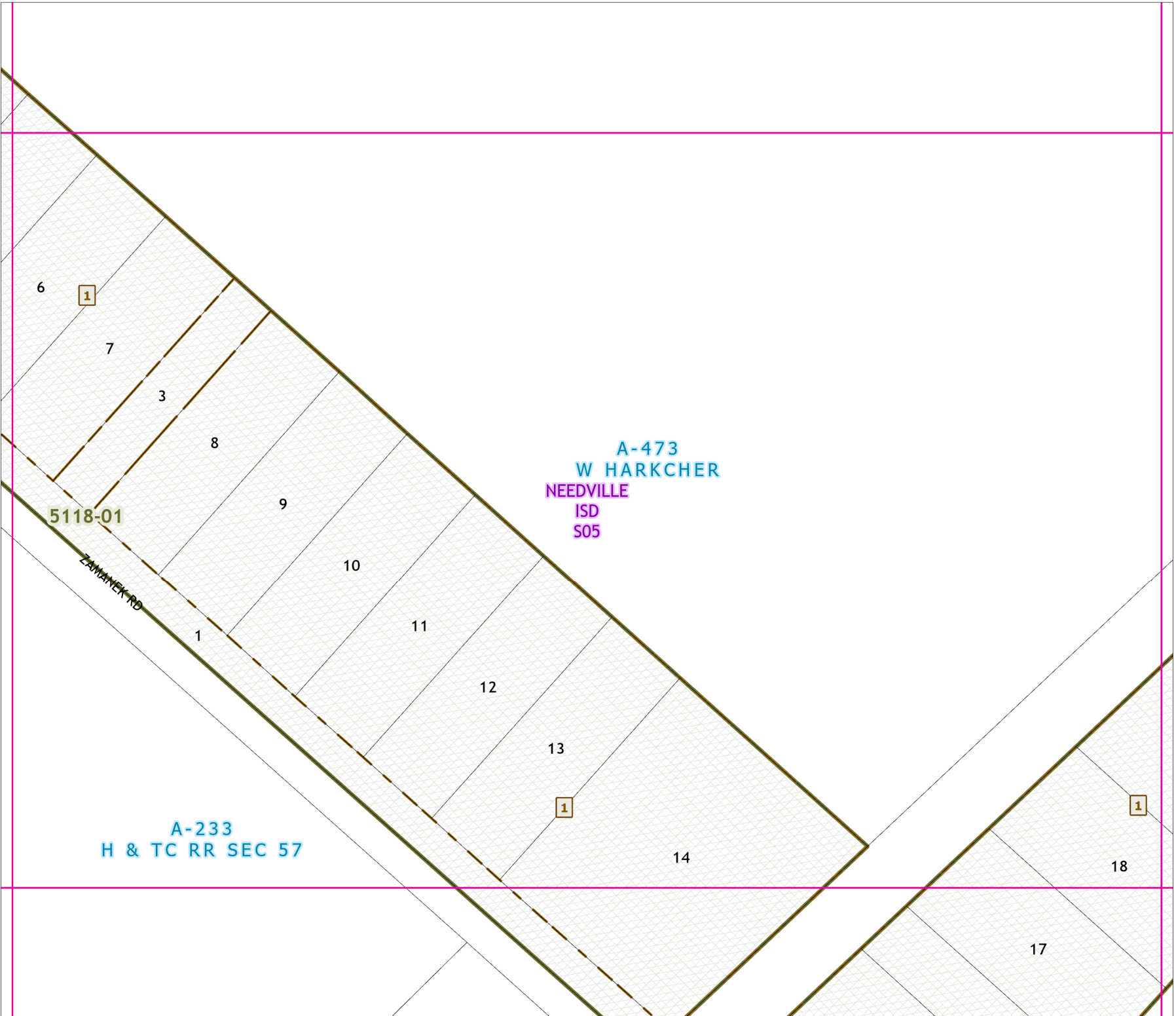

# 2021 Certified Tax Roll



**Grid Page  
A-217-E1**



Fort Bend Central Appraisal District (FBCAD) is not authorized to determine legal title to property or establish the legal boundaries of property. FBCAD establishes appraisal records based on information from various sources, including but not limited to deeds, plats and surveys provided to but not created by the district. FBCAD is not responsible for errors or omissions in information submitted to and reviewed by the district. If any errors or omission are detected, contact the GIS Department of the FBCAD.

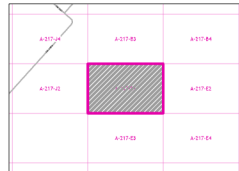

Grid Location Reference

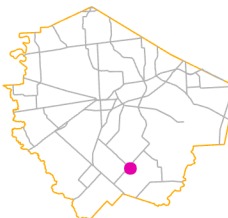

County Location Reference

A-654  
R MORRIS

NEEDVILLE  
ISD  
A-540 S05  
LOUIS WOLF

**8000**  
237.5444 AC

# 2021 Certified Tax Roll



**Grid Page  
A-217-E2**



Fort Bend Central Appraisal District (FBCAD) is not authorized to determine legal title to property or establish the legal boundaries of property. FBCAD establishes appraisal records based on information from various sources, including but not limited to deeds, plats and surveys provided to but not created by the district. FBCAD is not responsible for errors or omissions in information submitted to and reviewed by the district. If any errors or omission are detected, contact the GIS Department of the FBCAD.

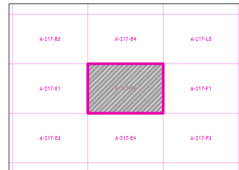

Grid Location Reference



County Location Reference

**A-251  
H & TC RR SEC 102**

**NEEDVILLE  
ISD  
S05**

**A-540  
LOUIS WOLF**

# 2021 Certified Tax Roll



**Grid Page  
A-217-E3**



Fort Bend Central Appraisal District (FBCAD) is not authorized to determine legal title to property or establish the legal boundaries of property. FBCAD establishes appraisal records based on information from various sources, including but not limited to deeds, plats and surveys provided to but not created by the district. FBCAD is not responsible for errors or omissions in information submitted to and reviewed by the district. If any errors or omission are detected, contact the GIS Department of the FBCAD.

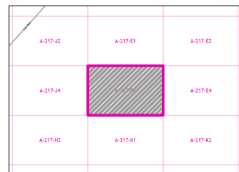

Grid Location Reference

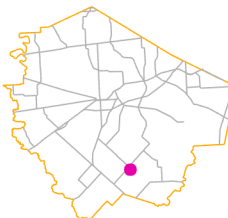

County Location Reference

8000  
237.5444 AC

A-540  
LOUIS WOLF

NEEDVILLE  
ISD  
S05

# 2021 Certified Tax Roll



**Grid Page  
A-217-E4**



Fort Bend Central Appraisal District (FBCAD) is not authorized to determine legal title to property or establish the legal boundaries of property. FBCAD establishes appraisal records based on information from various sources, including but not limited to deeds, plats and surveys provided to but not created by the district. FBCAD is not responsible for errors or omissions in information submitted to and reviewed by the district. If any errors or omissions are detected, contact the GIS Department of the FBCAD.

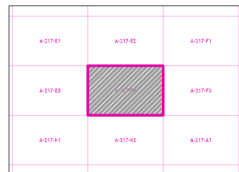

Grid Location Reference



County Location Reference

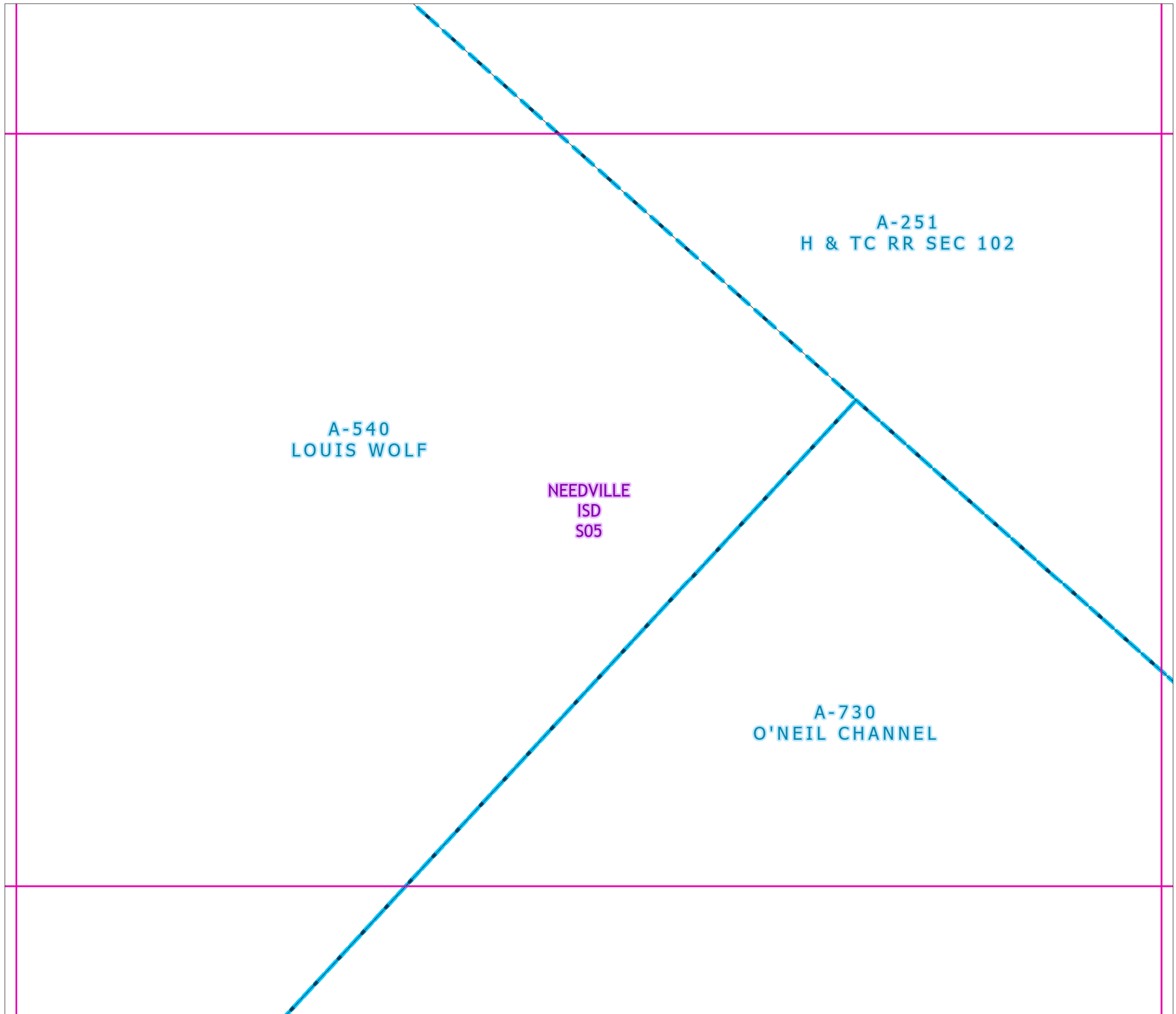



# 2021 Certified Tax Roll



**Grid Page  
A-217-F1**



Fort Bend Central Appraisal District (FBCAD) is not authorized to determine legal title to property or establish the legal boundaries of property. FBCAD establishes appraisal records based on information from various sources, including but not limited to deeds, plats and surveys provided to but not created by the district. FBCAD is not responsible for errors or omissions in information submitted to and reviewed by the district. If any errors or omission are detected, contact the GIS Department of the FBCAD.

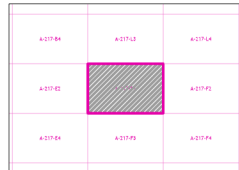

Grid Location Reference



County Location Reference

A-346  
GEO WATERS

NEEDVILLE  
ISD  
S05

A-251  
H & TC RR SEC 102

# 2021 Certified Tax Roll



**Grid Page  
A-217-F2**



Fort Bend Central Appraisal District (FBCAD) is not authorized to determine legal title to property or establish the legal boundaries of property. FBCAD establishes appraisal records based on information from various sources, including but not limited to deeds, plats and surveys provided to but not created by the district. FBCAD is not responsible for errors or omissions in information submitted to and reviewed by the district. If any errors or omission are detected, contact the GIS Department of the FBCAD.

A-217-03	A-217-04	A-218-00
A-217-01	A-217-02	A-218-01
A-217-05	A-217-06	A-218-02

Grid Location Reference



County Location Reference

A-346  
GEO WATERS

NEEDVILLE  
ISD  
S05

A-655  
T F PINCKNEY

A-251  
H & TC RR SEC 102

# 2021 Certified Tax Roll



**Grid Page  
A-217-F3**



Fort Bend Central Appraisal District (FBCAD) is not authorized to determine legal title to property or establish the legal boundaries of property. FBCAD establishes appraisal records based on information from various sources, including but not limited to deeds, plats and surveys provided to but not created by the district. FBCAD is not responsible for errors or omissions in information submitted to and reviewed by the district. If any errors or omission are detected, contact the GIS Department of the FBCAD.

A-217-F1	A-217-F1	A-217-F2
A-217-F4		A-217-F4
A-217-F3	A-217-F1	A-217-F2

Grid Location Reference



County Location Reference

**A-251  
H & TC RR SEC 102**

**NEEDVILLE  
ISD  
S05**

**8000  
311.2562 AC**

**A-730  
O'NEIL CHANNEL**

# 2021 Certified Tax Roll



**Grid Page**  
**A-217-F4**



Fort Bend Central Appraisal District (FBCAD) is not authorized to determine legal title to property or establish the legal boundaries of property. FBCAD establishes appraisal records based on information from various sources, including but not limited to deeds, plats and surveys provided to but not created by the district. FBCAD is not responsible for errors or omissions in information submitted to and reviewed by the district. If any errors or omission are detected, contact the GIS Department of the FBCAD.

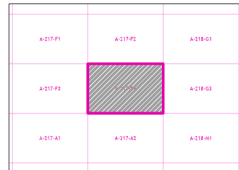

Grid Location Reference



County Location Reference

A-346  
GEO WATERS

A-655  
T F PINCKNEY

NEEDVILLE  
ISD  
S05

A-251  
H & TC RR SEC 102

# 2021 Certified Tax Roll



**Grid Page  
A-217-H1**

**A-233  
H & TC RR SEC 57**

**NEEDVILLE  
ISD  
S05**

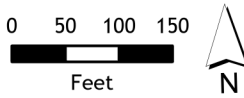

Fort Bend Central Appraisal District (FBCAD) is not authorized to determine legal title to property or establish the legal boundaries of property. FBCAD establishes appraisal records based on information from various sources, including but not limited to deeds, plats and surveys provided to but not created by the district. FBCAD is not responsible for errors or omissions in information submitted to and reviewed by the district. If any errors or omission are detected, contact the GIS Department of the FBCAD.

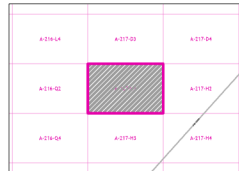

Grid Location Reference



County Location Reference

# 2021 Certified Tax Roll



Grid Page  
A-217-H2



Fort Bend Central Appraisal District (FBCAD) is not authorized to determine legal title to property or establish the legal boundaries of property. FBCAD establishes appraisal records based on information from various sources, including but not limited to deeds, plats and surveys provided to but not created by the district. FBCAD is not responsible for errors or omissions in information submitted to and reviewed by the district. If any errors or omission are detected, contact the GIS Department of the FBCAD.

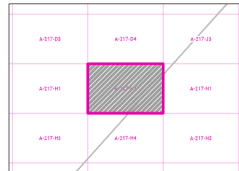

Grid Location Reference

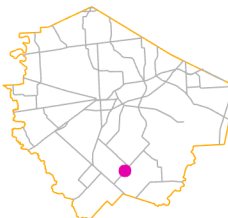

County Location Reference

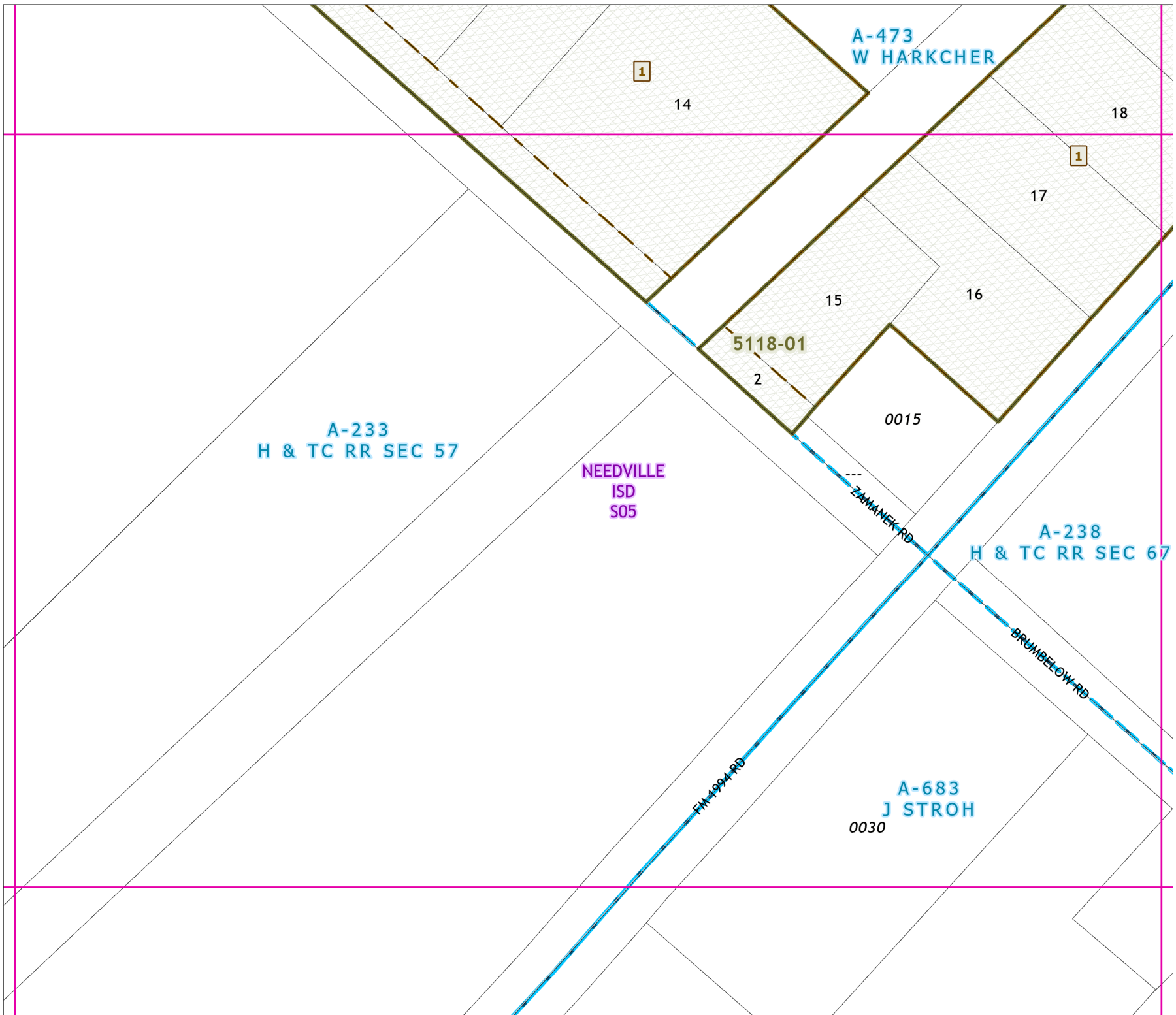

# 2021 Certified Tax Roll



**Grid Page  
A-217-H3**



Fort Bend Central Appraisal District (FBCAD) is not authorized to determine legal title to property or establish the legal boundaries of property. FBCAD establishes appraisal records based on information from various sources, including but not limited to deeds, plats and surveys provided to but not created by the district. FBCAD is not responsible for errors or omissions in information submitted to and reviewed by the district. If any errors or omission are detected, contact the GIS Department of the FBCAD.

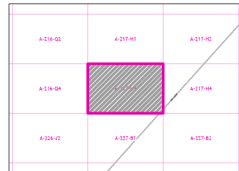

Grid Location Reference



County Location Reference

**A-233  
H & TC RR SEC 57**

**1020  
24.6 AC**

**NEEDVILLE  
ISD  
S05**

**0010  
14.001 AC**

**FM 1994 RD**

**A-683  
J STROH**

# 2021 Certified Tax Roll



**Grid Page  
A-217-H4**



Fort Bend Central Appraisal District (FBCAD) is not authorized to determine legal title to property or establish the legal boundaries of property. FBCAD establishes appraisal records based on information from various sources, including but not limited to deeds, plats and surveys provided to but not created by the district. FBCAD is not responsible for errors or omissions in information submitted to and reviewed by the district. If any errors or omission are detected, contact the GIS Department of the FBCAD.

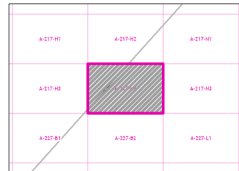

Grid Location Reference

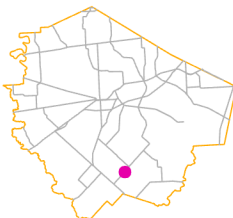

County Location Reference

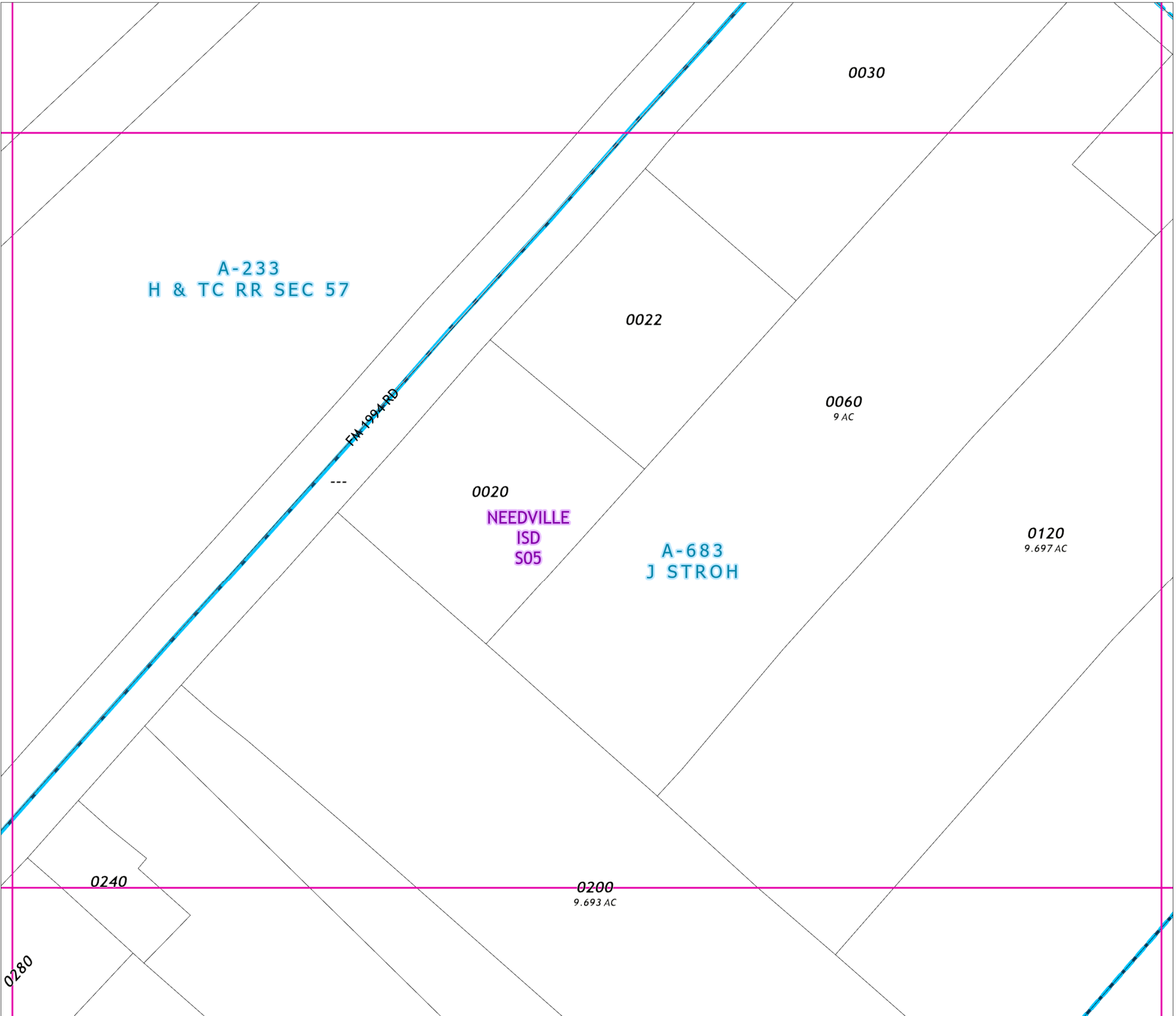



# 2021 Certified Tax Roll



**Grid Page  
A-217-J1**

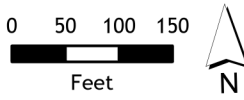
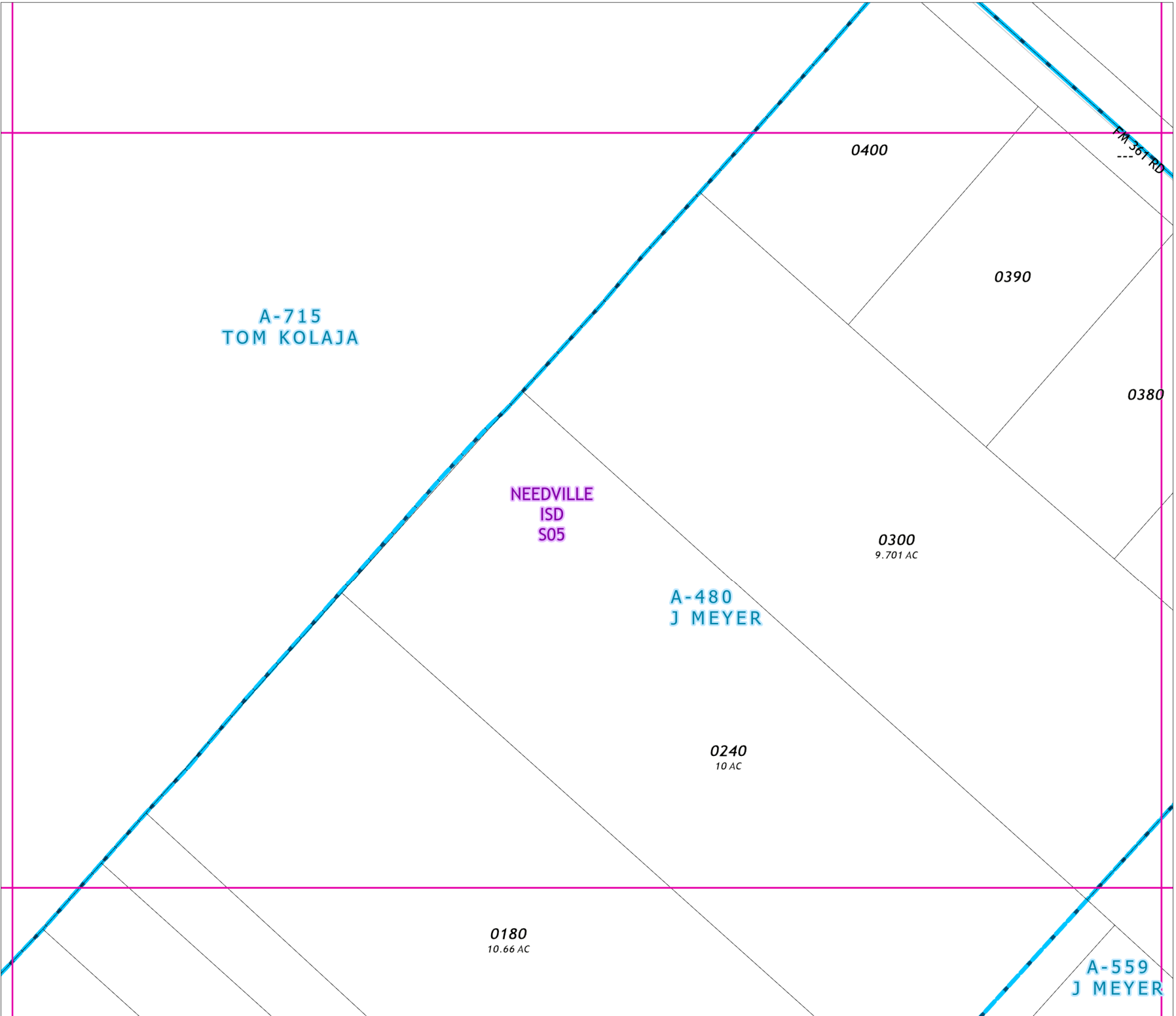

Fort Bend Central Appraisal District (FBCAD) is not authorized to determine legal title to property or establish the legal boundaries of property. FBCAD establishes appraisal records based on information from various sources, including but not limited to deeds, plats and surveys provided to but not created by the district. FBCAD is not responsible for errors or omissions in information submitted to and reviewed by the district. If any errors or omission are detected, contact the GIS Department of the FBCAD.

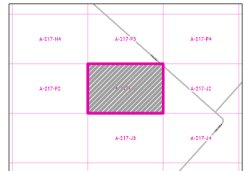

Grid Location Reference

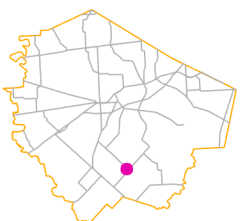

County Location Reference

# 2021 Certified Tax Roll



**Grid Page  
A-217-J1**

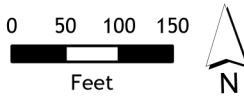
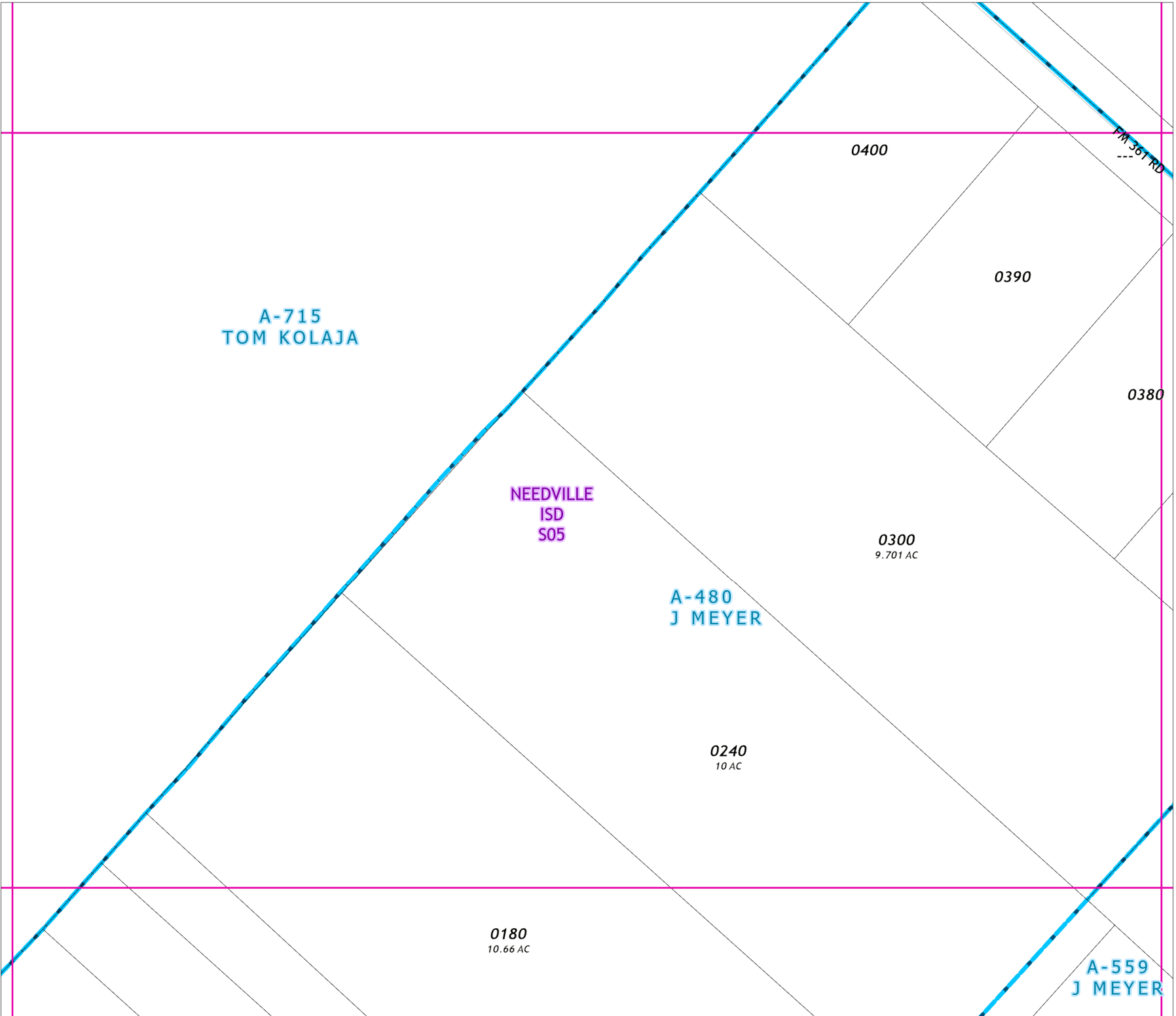

Fort Bend Central Appraisal District (FBCAD) is not authorized to determine legal title to property or establish the legal boundaries of property. FBCAD establishes appraisal records based on information from various sources, including but not limited to deeds, plats and surveys provided to but not created by the district. FBCAD is not responsible for errors or omissions in information submitted to and reviewed by the district. If any errors or omission are detected, contact the GIS Department of the FBCAD.

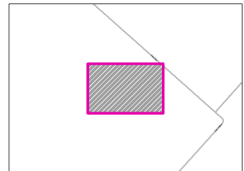

Grid Location Reference



County Location Reference

# 2021 Certified Tax Roll



Grid Page  
A-217-J2



Fort Bend Central Appraisal District (FBCAD) is not authorized to determine legal title to property or establish the legal boundaries of property. FBCAD establishes appraisal records based on information from various sources, including but not limited to deeds, plats and surveys provided to but not created by the district. FBCAD is not responsible for errors or omissions in information submitted to and reviewed by the district. If any errors or omission are detected, contact the GIS Department of the FBCAD.

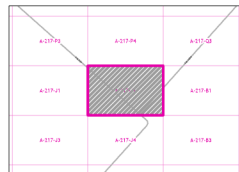

Grid Location Reference



County Location Reference

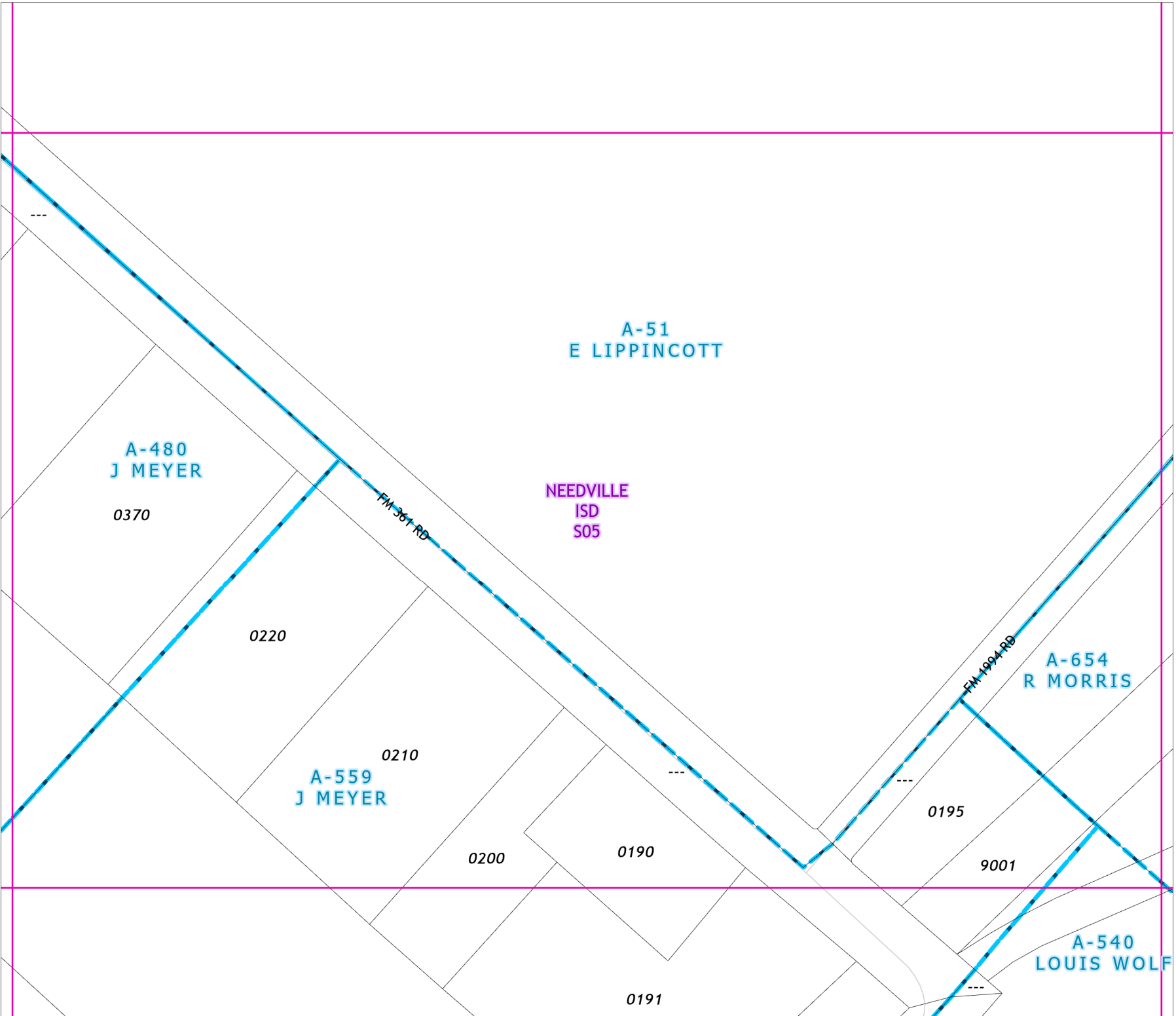

# 2021 Certified Tax Roll



Grid Page  
A-217-J2

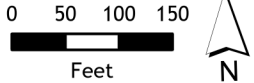
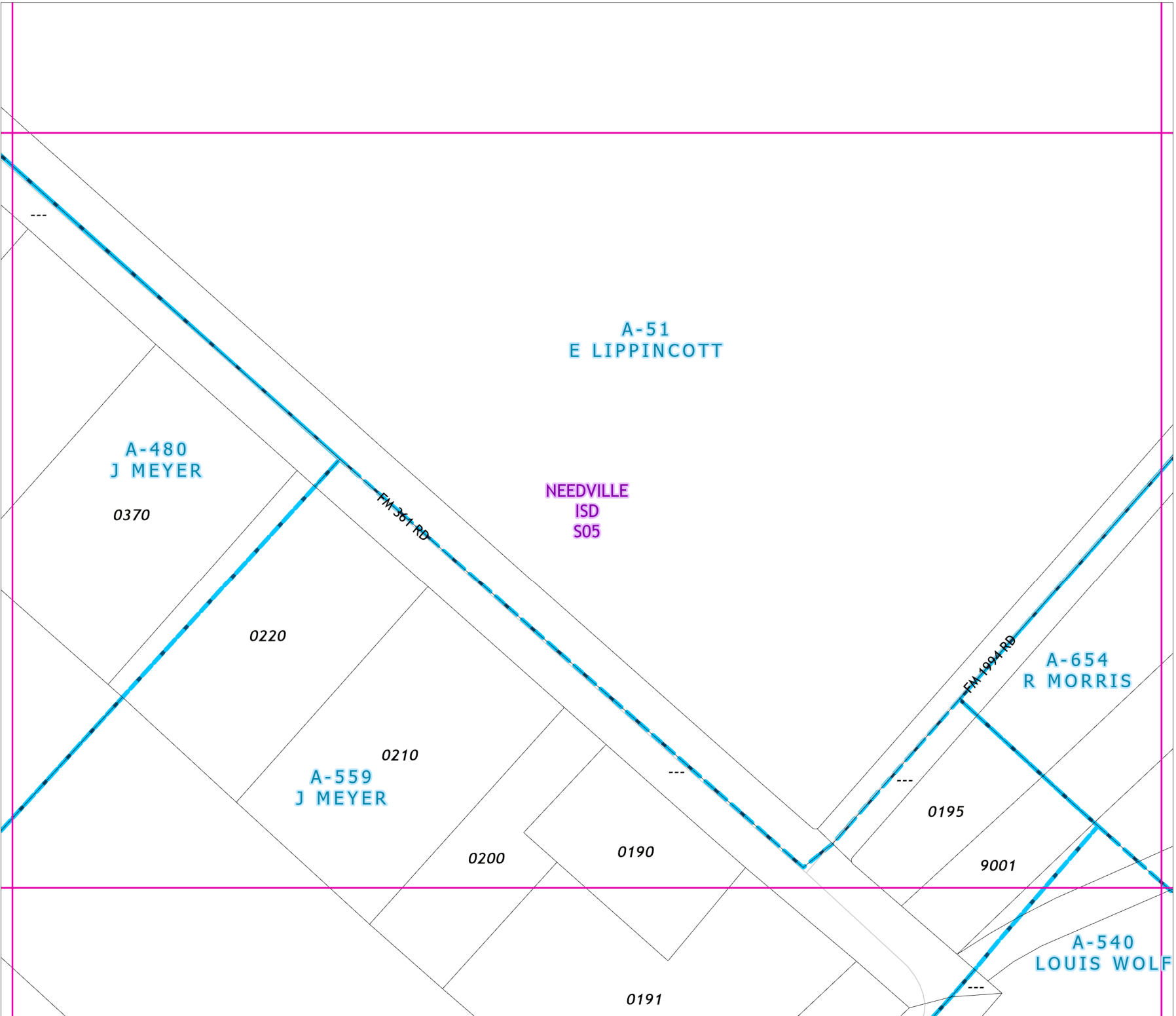

Fort Bend Central Appraisal District (FBCAD) is not authorized to determine legal title to property or establish the legal boundaries of property. FBCAD establishes appraisal records based on information from various sources, including but not limited to deeds, plats and surveys provided to but not created by the district. FBCAD is not responsible for errors or omissions in information submitted to and reviewed by the district. If any errors or omission are detected, contact the GIS Department of the FBCAD.

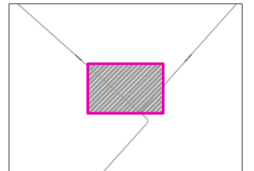

Grid Location Reference



County Location Reference

A-715  
TOM KOLAJA

0180  
10.66 AC

0120

0100

A-480  
J MEYER

0040  
10.7 AC

NEEDVILLE  
ISD  
S05

0112

0110  
8.3 AC

A-559  
J MEYER

0070

A-473  
W HARKCHER

0030  
8.683 AC

# 2021 Certified Tax Roll



Grid Page  
A-217-J3

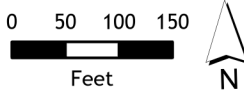

Fort Bend Central Appraisal District (FBCAD) is not authorized to determine legal title to property or establish the legal boundaries of property. FBCAD establishes appraisal records based on information from various sources, including but not limited to deeds, plats and surveys provided to but not created by the district. FBCAD is not responsible for errors or omissions in information submitted to and reviewed by the district. If any errors or omission are detected, contact the GIS Department of the FBCAD.

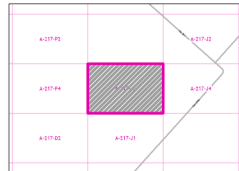

Grid Location Reference



County Location Reference

A-715  
TOM KOLAJA

0180  
10.66 AC

0120

0100  
A-480  
J MEYER

0040  
10.7 AC

NEEDVILLE  
ISD  
S05

0112

0110  
8.3 AC

A-559  
J MEYER

0070

A-473  
W HARKCHER

0030  
8.683 AC

# 2021 Certified Tax Roll



Grid Page  
A-217-J3

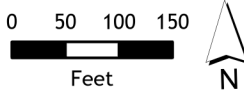

Fort Bend Central Appraisal District (FBCAD) is not authorized to determine legal title to property or establish the legal boundaries of property. FBCAD establishes appraisal records based on information from various sources, including but not limited to deeds, plats and surveys provided to but not created by the district. FBCAD is not responsible for errors or omissions in information submitted to and reviewed by the district. If any errors or omission are detected, contact the GIS Department of the FBCAD.

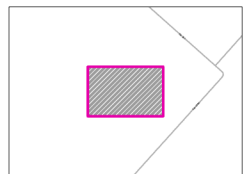

Grid Location Reference



County Location Reference

# 2021 Certified Tax Roll



**Grid Page  
A-217-J4**



Fort Bend Central Appraisal District (FBCAD) is not authorized to determine legal title to property or establish the legal boundaries of property. FBCAD establishes appraisal records based on information from various sources, including but not limited to deeds, plats and surveys provided to but not created by the district. FBCAD is not responsible for errors or omissions in information submitted to and reviewed by the district. If any errors or omission are detected, contact the GIS Department of the FBCAD.

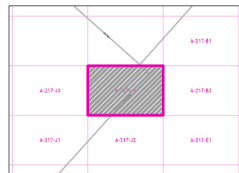

Grid Location Reference



County Location Reference

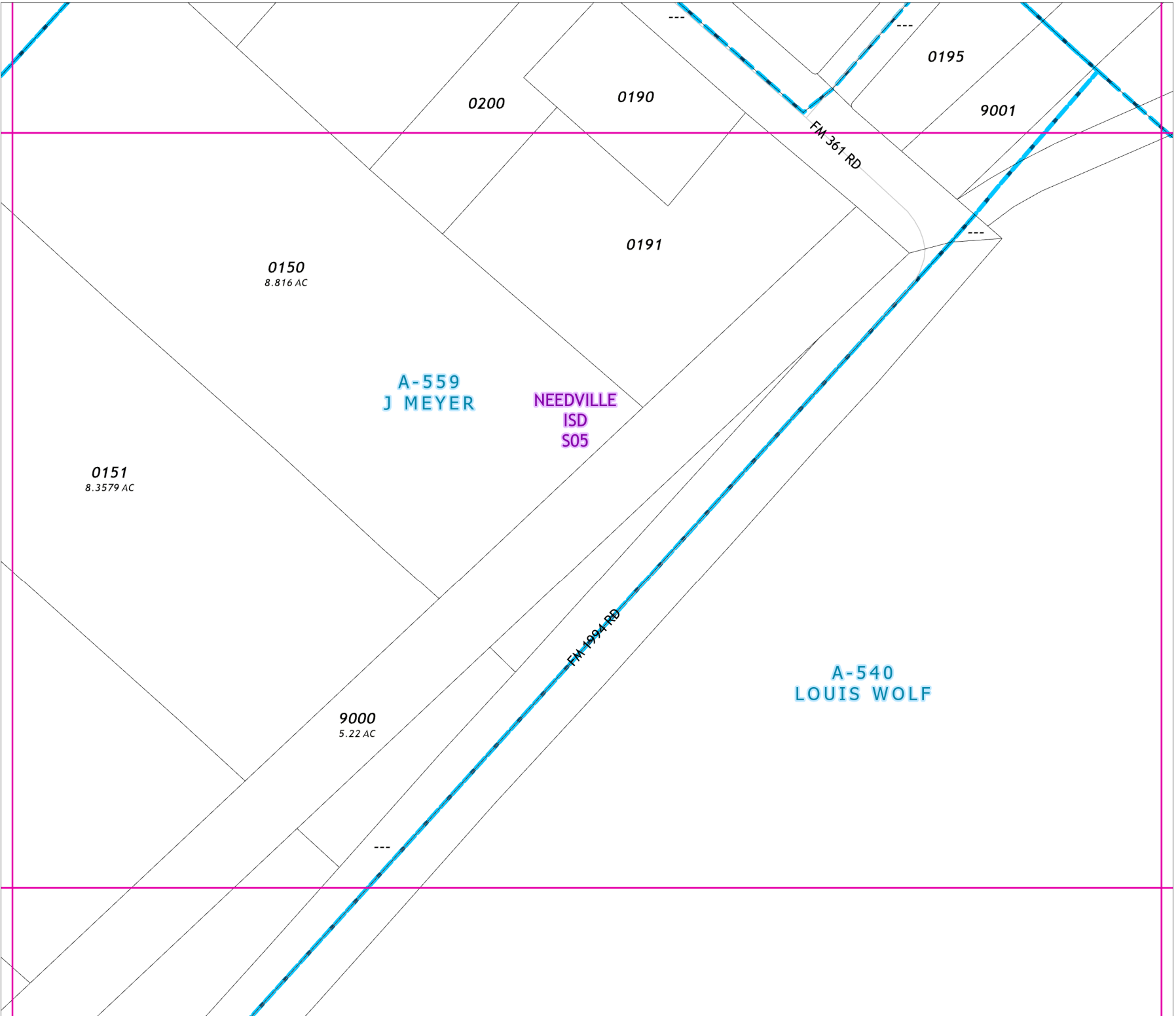

# 2021 Certified Tax Roll



**Grid Page  
A-217-J4**



Fort Bend Central Appraisal District (FBCAD) is not authorized to determine legal title to property or establish the legal boundaries of property. FBCAD establishes appraisal records based on information from various sources, including but not limited to deeds, plats and surveys provided to but not created by the district. FBCAD is not responsible for errors or omissions in information submitted to and reviewed by the district. If any errors or omission are detected, contact the GIS Department of the FBCAD.

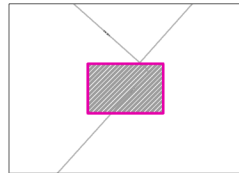

Grid Location Reference



County Location Reference

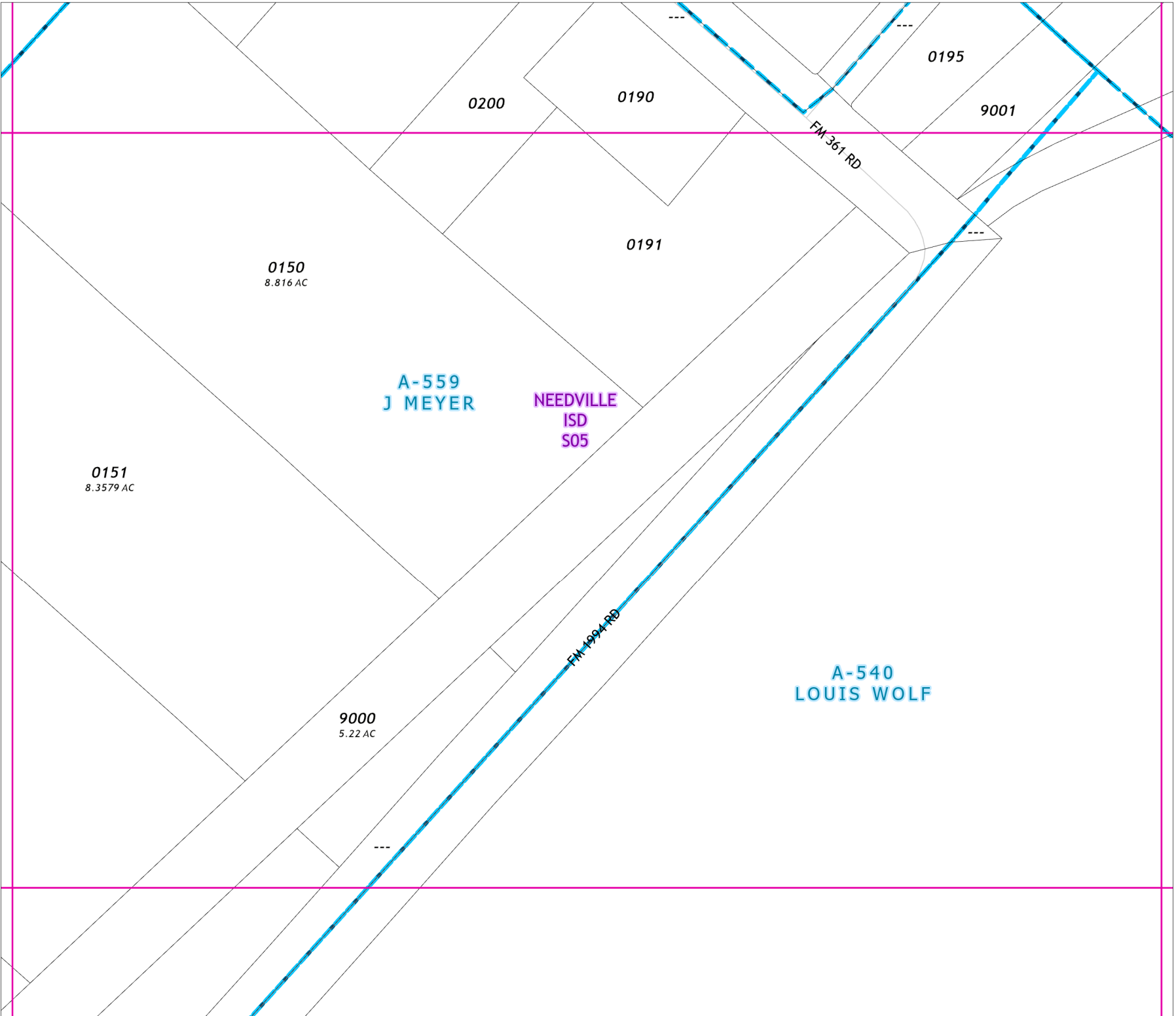



# 2021 Certified Tax Roll



**Grid Page  
A-217-K1**



Fort Bend Central Appraisal District (FBCAD) is not authorized to determine legal title to property or establish the legal boundaries of property. FBCAD establishes appraisal records based on information from various sources, including but not limited to deeds, plats and surveys provided to but not created by the district. FBCAD is not responsible for errors or omissions in information submitted to and reviewed by the district. If any errors or omission are detected, contact the GIS Department of the FBCAD.

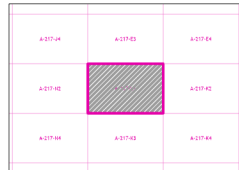

Grid Location Reference



County Location Reference

**A-540  
LOUIS WOLF**

**NEEDVILLE  
ISD  
S05**

**A-238  
H & TC RR SEC 67**

**A-730  
O'NEIL CHANNEL**

# 2021 Certified Tax Roll



**Grid Page  
A-217-K2**

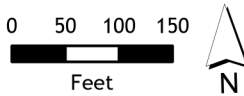

Fort Bend Central Appraisal District (FBCAD) is not authorized to determine legal title to property or establish the legal boundaries of property. FBCAD establishes appraisal records based on information from various sources, including but not limited to deeds, plats and surveys provided to but not created by the district. FBCAD is not responsible for errors or omissions in information submitted to and reviewed by the district. If any errors or omission are detected, contact the GIS Department of the FBCAD.

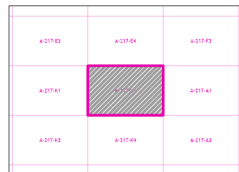

Grid Location Reference



County Location Reference

A-540  
LOUIS WOLF

NEEDVILLE  
ISD  
S05 A-730  
O'NEIL CHANNEL

8000  
79.6635 AC

A-251  
H & TC RR SEC 102

# 2021 Certified Tax Roll



**Grid Page  
A-217-K3**



Fort Bend Central Appraisal District (FBCAD) is not authorized to determine legal title to property or establish the legal boundaries of property. FBCAD establishes appraisal records based on information from various sources, including but not limited to deeds, plats and surveys provided to but not created by the district. FBCAD is not responsible for errors or omissions in information submitted to and reviewed by the district. If any errors or omission are detected, contact the GIS Department of the FBCAD.

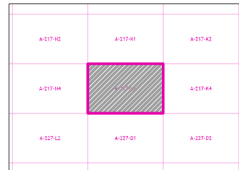

Grid Location Reference



County Location Reference

A-540  
LOUIS WOLF

A-730  
O'NEIL CHANNEL

NEEDVILLE  
ISD  
S05

A-238  
H & TC RR SEC 67

# 2021 Certified Tax Roll



Grid Page  
A-217-K4

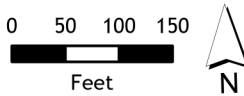

Fort Bend Central Appraisal District (FBCAD) is not authorized to determine legal title to property or establish the legal boundaries of property. FBCAD establishes appraisal records based on information from various sources, including but not limited to deeds, plats and surveys provided to but not created by the district. FBCAD is not responsible for errors or omissions in information submitted to and reviewed by the district. If any errors or omission are detected, contact the GIS Department of the FBCAD.

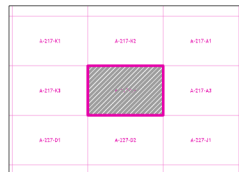

Grid Location Reference



County Location Reference

A-730  
O'NEIL CHANNEL

A-251  
H & TC RR SEC 102

NEEDVILLE  
ISD  
S05

A-581  
D J JONES

A-238  
H & TC RR SEC 67

# 2021 Certified Tax Roll



**Grid Page  
A-217-L1**



Fort Bend Central Appraisal District (FBCAD) is not authorized to determine legal title to property or establish the legal boundaries of property. FBCAD establishes appraisal records based on information from various sources, including but not limited to deeds, plats and surveys provided to but not created by the district. FBCAD is not responsible for errors or omissions in information submitted to and reviewed by the district. If any errors or omissions are detected, contact the GIS Department of the FBCAD.

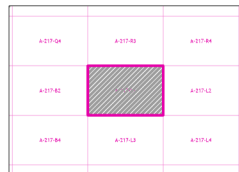

Grid Location Reference



County Location Reference

**A-346  
GEO WATERS**

**NEEDVILLE  
ISD  
S05**

**DAVIS ESTATE RD 8.1748 AC**

# 2021 Certified Tax Roll



**Grid Page  
A-217-L2**

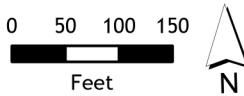

Fort Bend Central Appraisal District (FBCAD) is not authorized to determine legal title to property or establish the legal boundaries of property. FBCAD establishes appraisal records based on information from various sources, including but not limited to deeds, plats and surveys provided to but not created by the district. FBCAD is not responsible for errors or omissions in information submitted to and reviewed by the district. If any errors or omission are detected, contact the GIS Department of the FBCAD.

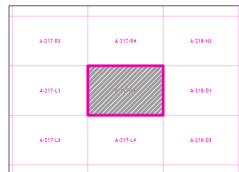

Grid Location Reference



County Location Reference

A-24  
P FAIRCHILD

A-346  
GEO WATERS

NEEDVILLE  
ISD  
S05

DAVIS ESTATE RD

# 2021 Certified Tax Roll



**Grid Page  
A-217-L3**



Fort Bend Central Appraisal District (FBCAD) is not authorized to determine legal title to property or establish the legal boundaries of property. FBCAD establishes appraisal records based on information from various sources, including but not limited to deeds, plats and surveys provided to but not created by the district. FBCAD is not responsible for errors or omissions in information submitted to and reviewed by the district. If any errors or omission are detected, contact the GIS Department of the FBCAD.

A-217-82	A-217-81	A-217-82
A-217-84		A-217-84
A-217-82	A-217-81	A-217-82

Grid Location Reference



County Location Reference

DAVIS ESTATE RD

A-346  
GEO WATERS

NEEDVILLE  
ISD  
S05

A-251  
H & TC RR SEC 102

# 2021 Certified Tax Roll



**Grid Page  
A-217-L4**



Fort Bend Central Appraisal District (FBCAD) is not authorized to determine legal title to property or establish the legal boundaries of property. FBCAD establishes appraisal records based on information from various sources, including but not limited to deeds, plats and surveys provided to but not created by the district. FBCAD is not responsible for errors or omissions in information submitted to and reviewed by the district. If any errors or omission are detected, contact the GIS Department of the FBCAD.

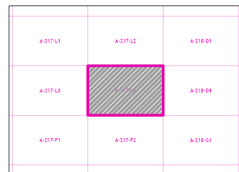

Grid Location Reference



County Location Reference

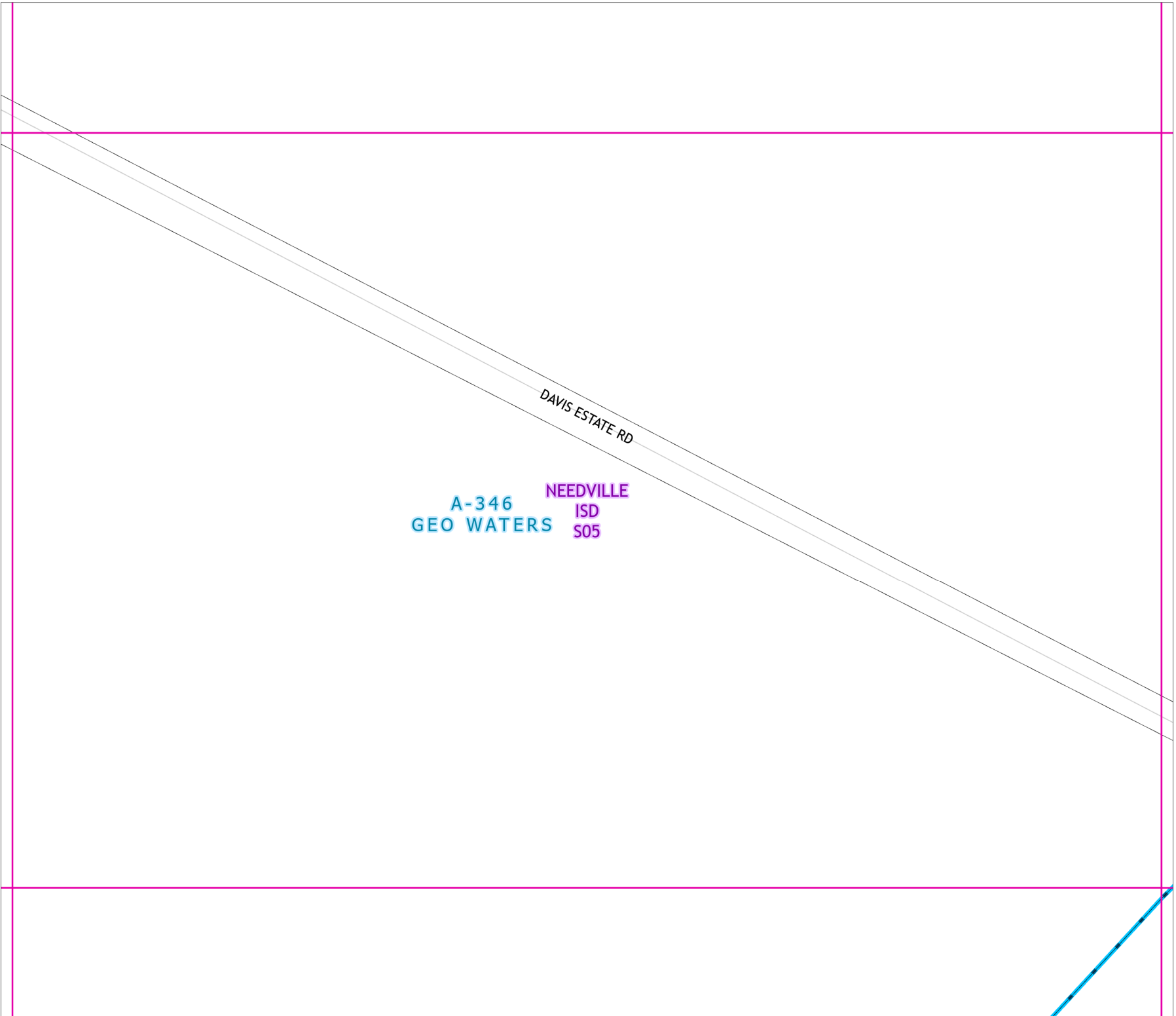



# 2021 Certified Tax Roll



**Grid Page  
A-217-N1**



Fort Bend Central Appraisal District (FBCAD) is not authorized to determine legal title to property or establish the legal boundaries of property. FBCAD establishes appraisal records based on information from various sources, including but not limited to deeds, plats and surveys provided to but not created by the district. FBCAD is not responsible for errors or omissions in information submitted to and reviewed by the district. If any errors or omission are detected, contact the GIS Department of the FBCAD.

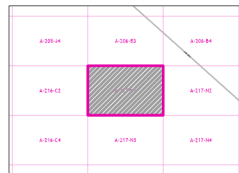

Grid Location Reference

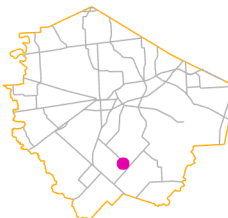

County Location Reference

**1830**  
23.13 AC

**1810**  
45.201 AC

**A-232**  
**H & TC RR SEC 55**

**NEEDVILLE**  
**ISD**  
**S05**

**1820**  
25.235 AC

**A-600**  
**A F WARD**

# 2021 Certified Tax Roll



**Grid Page  
A-217-N1**



Fort Bend Central Appraisal District (FBCAD) is not authorized to determine legal title to property or establish the legal boundaries of property. FBCAD establishes appraisal records based on information from various sources, including but not limited to deeds, plats and surveys provided to but not created by the district. FBCAD is not responsible for errors or omissions in information submitted to and reviewed by the district. If any errors or omissions are detected, contact the GIS Department of the FBCAD.

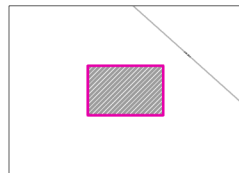

Grid Location Reference



County Location Reference

**1830**  
23.13 AC

**1810**  
45.201 AC

**A-232**  
**H & TC RR SEC 55**

**NEEDVILLE**  
**ISD**  
**S05**

**1820**  
25.235 AC

**A-600**  
**A F WARD**

# 2021 Certified Tax Roll



**Grid Page  
A-217-N2**

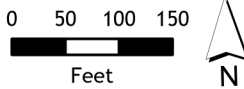

Fort Bend Central Appraisal District (FBCAD) is not authorized to determine legal title to property or establish the legal boundaries of property. FBCAD establishes appraisal records based on information from various sources, including but not limited to deeds, plats and surveys provided to but not created by the district. FBCAD is not responsible for errors or omissions in information submitted to and reviewed by the district. If any errors or omission are detected, contact the GIS Department of the FBCAD.

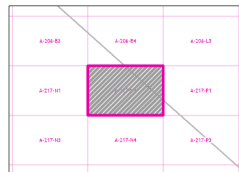

Grid Location Reference



County Location Reference

A-232  
H & TC RR SEC 55

A-51  
E LIPPINCOTT

FM 367 RD

NEEDVILLE  
ISD  
S05

A-600  
A F WARD

0021  
29.564 AC

# 2021 Certified Tax Roll



**Grid Page  
A-217-N2**

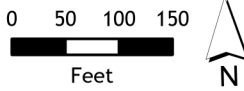

Fort Bend Central Appraisal District (FBCAD) is not authorized to determine legal title to property or establish the legal boundaries of property. FBCAD establishes appraisal records based on information from various sources, including but not limited to deeds, plats and surveys provided to but not created by the district. FBCAD is not responsible for errors or omissions in information submitted to and reviewed by the district. If any errors or omission are detected, contact the GIS Department of the FBCAD.

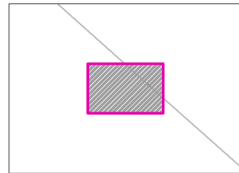

Grid Location Reference



County Location Reference

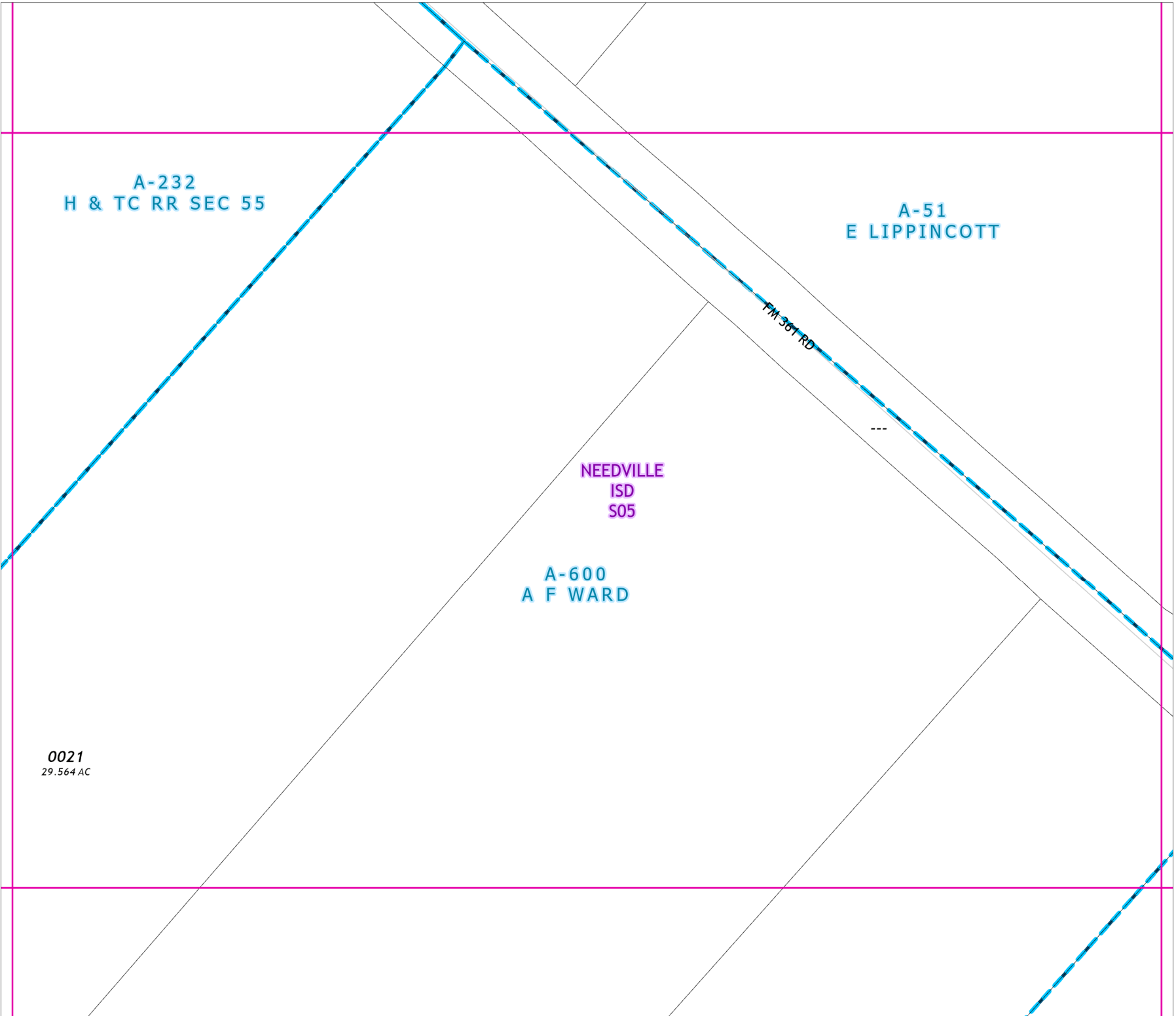

# 2021 Certified Tax Roll



**Grid Page  
A-217-N3**



Fort Bend Central Appraisal District (FBCAD) is not authorized to determine legal title to property or establish the legal boundaries of property. FBCAD establishes appraisal records based on information from various sources, including but not limited to deeds, plats and surveys provided to but not created by the district. FBCAD is not responsible for errors or omissions in information submitted to and reviewed by the district. If any errors or omission are detected, contact the GIS Department of the FBCAD.

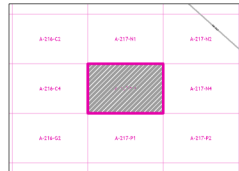

Grid Location Reference



County Location Reference

A-232  
H & TC RR SEC 55

A-600  
A F WARD

NEEDVILLE  
ISD  
S05

A-703  
J SITTA

# 2021 Certified Tax Roll



**Grid Page  
A-217-N3**



Fort Bend Central Appraisal District (FBCAD) is not authorized to determine legal title to property or establish the legal boundaries of property. FBCAD establishes appraisal records based on information from various sources, including but not limited to deeds, plats and surveys provided to but not created by the district. FBCAD is not responsible for errors or omissions in information submitted to and reviewed by the district. If any errors or omission are detected, contact the GIS Department of the FBCAD.

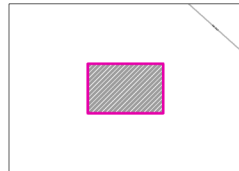

Grid Location Reference



County Location Reference

A-232  
H & TC RR SEC 55

A-600  
A F WARD

NEEDVILLE  
ISD  
S05

A-703  
J SITTA

# 2021 Certified Tax Roll



**Grid Page  
A-217-N4**



Fort Bend Central Appraisal District (FBCAD) is not authorized to determine legal title to property or establish the legal boundaries of property. FBCAD establishes appraisal records based on information from various sources, including but not limited to deeds, plats and surveys provided to but not created by the district. FBCAD is not responsible for errors or omissions in information submitted to and reviewed by the district. If any errors or omission are detected, contact the GIS Department of the FBCAD.

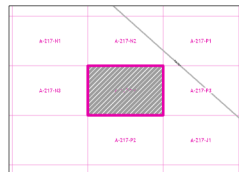

Grid Location Reference



County Location Reference

**0020**  
29.564 AC

**A-600**  
**A F WARD**

**NEEDVILLE**  
**ISD 0080**  
**S05** 20 AC

**A-715**  
**TOM KOLAJA**

**0041**  
79.911 AC

# 2021 Certified Tax Roll



**Grid Page  
A-217-N4**



Fort Bend Central Appraisal District (FBCAD) is not authorized to determine legal title to property or establish the legal boundaries of property. FBCAD establishes appraisal records based on information from various sources, including but not limited to deeds, plats and surveys provided to but not created by the district. FBCAD is not responsible for errors or omissions in information submitted to and reviewed by the district. If any errors or omission are detected, contact the GIS Department of the FBCAD.

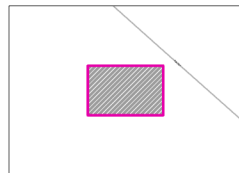

Grid Location Reference



County Location Reference

**0020**  
29.564 AC

**A-600**  
**A F WARD**

**NEEDVILLE**  
**ISD 0080**  
**S05**  
20 AC

**A-715**  
**TOM KOLAJA**

**0041**  
79.911 AC



# 2021 Certified Tax Roll



**Grid Page  
A-217-P1**

**A-51  
E LIPPINCOTT**  
**NEEDVILLE  
ISD  
S05**

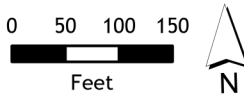

Fort Bend Central Appraisal District (FBCAD) is not authorized to determine legal title to property or establish the legal boundaries of property. FBCAD establishes appraisal records based on information from various sources, including but not limited to deeds, plats and surveys provided to but not created by the district. FBCAD is not responsible for errors or omissions in information submitted to and reviewed by the district. If any errors or omission are detected, contact the GIS Department of the FBCAD.

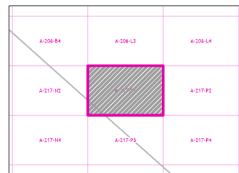

Grid Location Reference



County Location Reference

**A-715  
TOM KOLAJA**

**FM 361 RD**

# 2021 Certified Tax Roll



Grid Page  
A-217-P1

A-51  
E LIPPINCOTT  
NEEDVILLE  
ISD  
S05

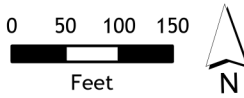

Fort Bend Central Appraisal District (FBCAD) is not authorized to determine legal title to property or establish the legal boundaries of property. FBCAD establishes appraisal records based on information from various sources, including but not limited to deeds, plats and surveys provided to but not created by the district. FBCAD is not responsible for errors or omissions in information submitted to and reviewed by the district. If any errors or omission are detected, contact the GIS Department of the FBCAD.

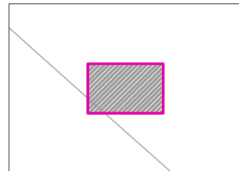

Grid Location Reference



County Location Reference

A-715  
TOM KOLAJA

FM 361 RD

# 2021 Certified Tax Roll



**Grid Page  
A-217-P2**



Fort Bend Central Appraisal District (FBCAD) is not authorized to determine legal title to property or establish the legal boundaries of property. FBCAD establishes appraisal records based on information from various sources, including but not limited to deeds, plats and surveys provided to but not created by the district. FBCAD is not responsible for errors or omissions in information submitted to and reviewed by the district. If any errors or omission are detected, contact the GIS Department of the FBCAD.

NEEDVILLE  
ISD  
S05  
A-51  
E LIPPINCOTT

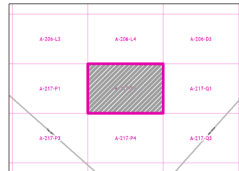

Grid Location Reference



County Location Reference

# 2021 Certified Tax Roll



**Grid Page  
A-217-P2**

**NEEDVILLE**  
**ISD**  
**S05**  
**A-51**  
**E LIPPINCOTT**

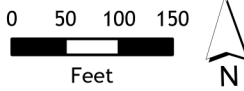

Fort Bend Central Appraisal District (FBCAD) is not authorized to determine legal title to property or establish the legal boundaries of property. FBCAD establishes appraisal records based on information from various sources, including but not limited to deeds, plats and surveys provided to but not created by the district. FBCAD is not responsible for errors or omissions in information submitted to and reviewed by the district. If any errors or omission are detected, contact the GIS Department of the FBCAD.

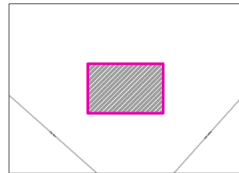

Grid Location Reference



County Location Reference

# 2021 Certified Tax Roll



Grid Page  
A-217-P3



Fort Bend Central Appraisal District (FBCAD) is not authorized to determine legal title to property or establish the legal boundaries of property. FBCAD establishes appraisal records based on information from various sources, including but not limited to deeds, plats and surveys provided to but not created by the district. FBCAD is not responsible for errors or omissions in information submitted to and reviewed by the district. If any errors or omission are detected, contact the GIS Department of the FBCAD.

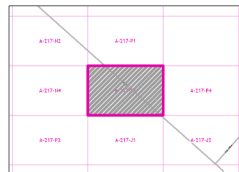

Grid Location Reference



County Location Reference

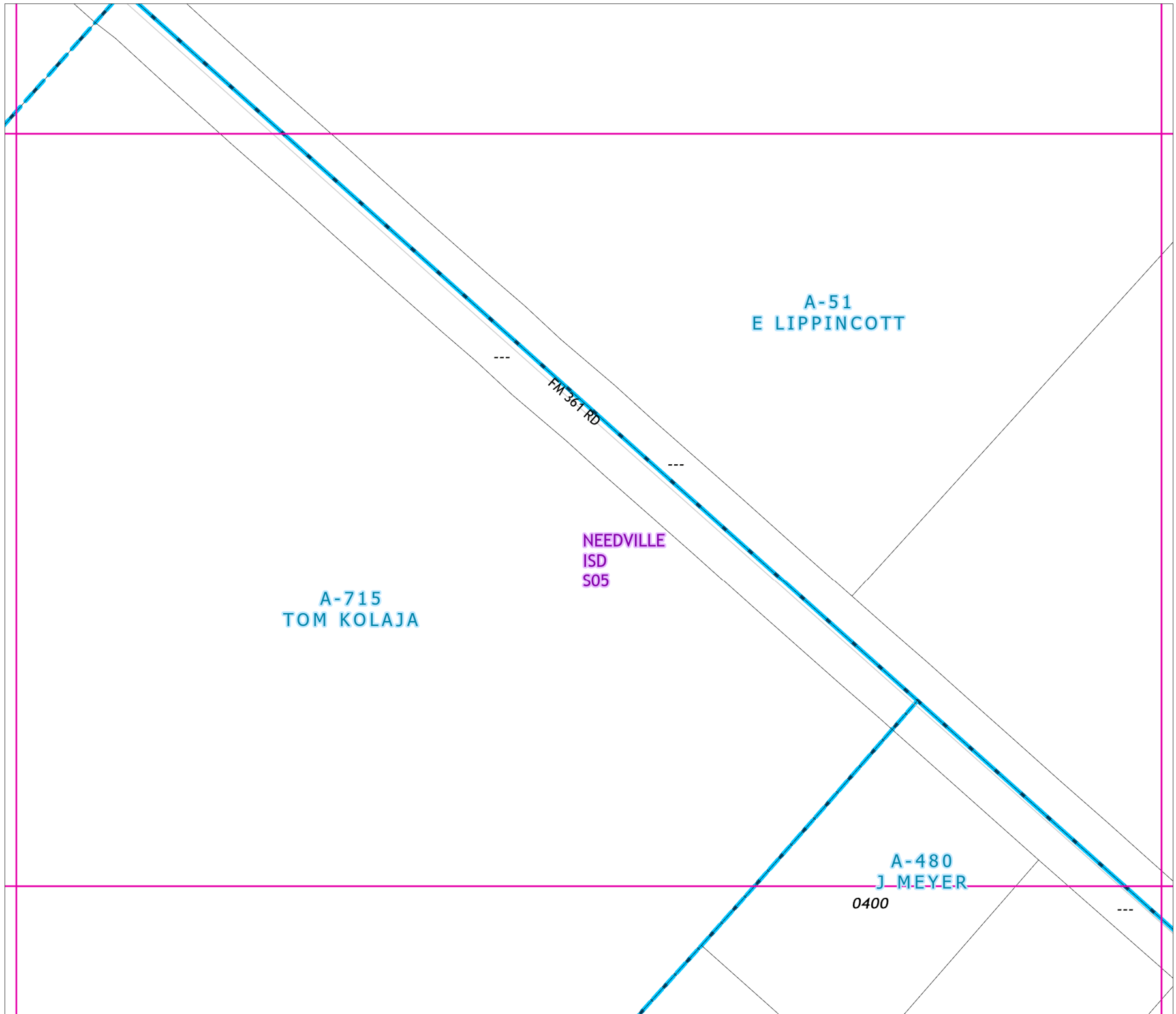

# 2021 Certified Tax Roll



Grid Page  
A-217-P3



Fort Bend Central Appraisal District (FBCAD) is not authorized to determine legal title to property or establish the legal boundaries of property. FBCAD establishes appraisal records based on information from various sources, including but not limited to deeds, plats and surveys provided to but not created by the district. FBCAD is not responsible for errors or omissions in information submitted to and reviewed by the district. If any errors or omissions are detected, contact the GIS Department of the FBCAD.

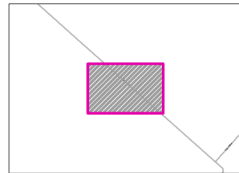

Grid Location Reference



County Location Reference

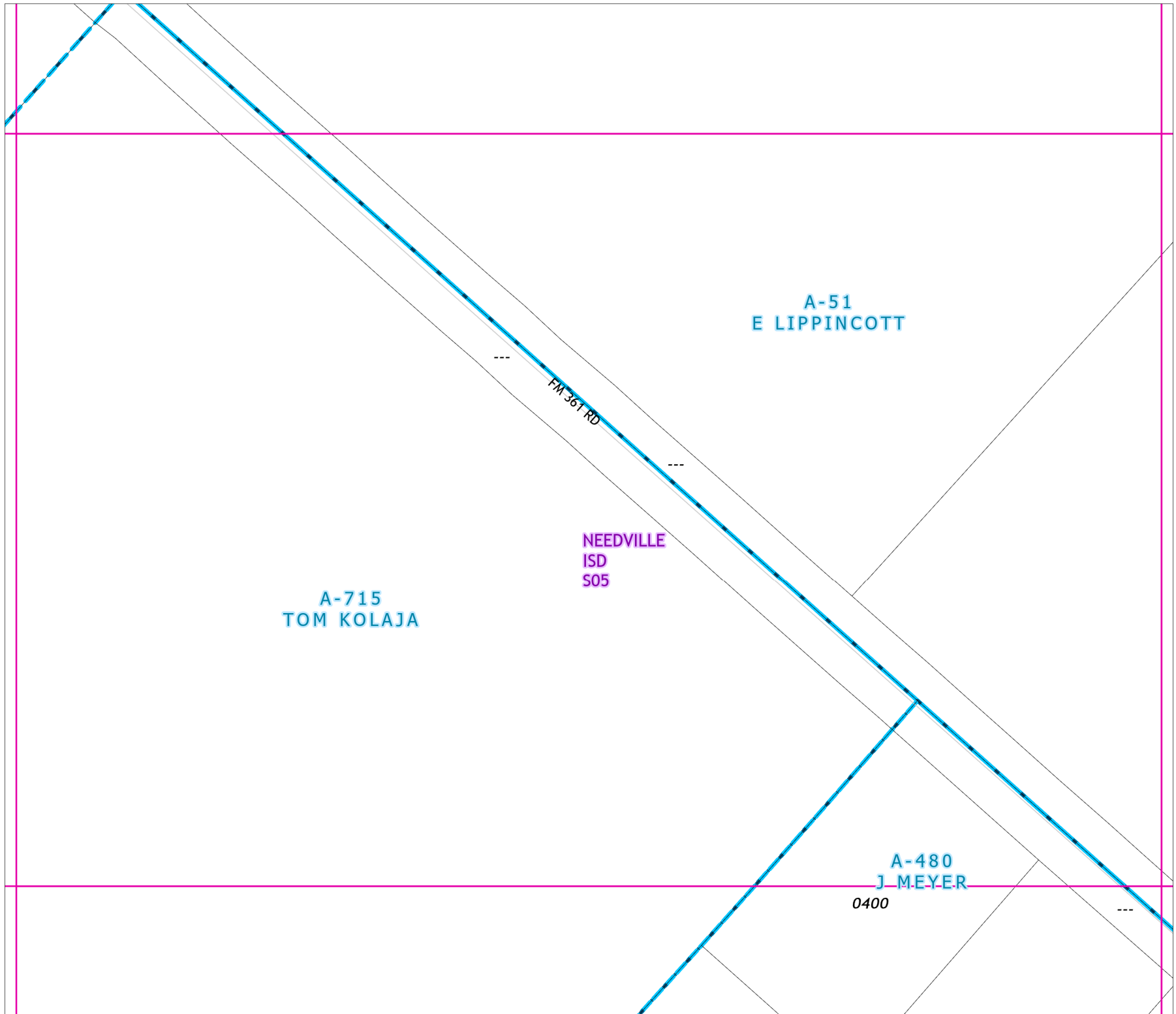

# 2021 Certified Tax Roll



**Grid Page  
A-217-P4**

**A-51  
E LIPPINCOTT  
NEEDVILLE  
ISD  
S05**

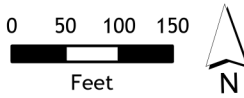

Fort Bend Central Appraisal District (FBCAD) is not authorized to determine legal title to property or establish the legal boundaries of property. FBCAD establishes appraisal records based on information from various sources, including but not limited to deeds, plats and surveys provided to but not created by the district. FBCAD is not responsible for errors or omissions in information submitted to and reviewed by the district. If any errors or omission are detected, contact the GIS Department of the FBCAD.

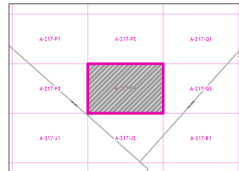

Grid Location Reference



County Location Reference

FM 361 RD

# 2021 Certified Tax Roll



**Grid Page  
A-217-P4**

**A-51  
E LIPPINCOTT  
NEEDVILLE  
ISD  
S05**

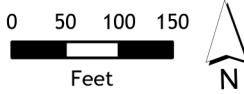

Fort Bend Central Appraisal District (FBCAD) is not authorized to determine legal title to property or establish the legal boundaries of property. FBCAD establishes appraisal records based on information from various sources, including but not limited to deeds, plats and surveys provided to but not created by the district. FBCAD is not responsible for errors or omissions in information submitted to and reviewed by the district. If any errors or omission are detected, contact the GIS Department of the FBCAD.

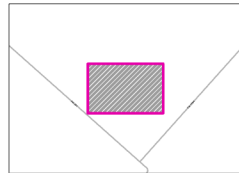

Grid Location Reference



County Location Reference

FM 361 RD



# 2021 Certified Tax Roll



Grid Page  
A-217-Q1



Fort Bend Central Appraisal District (FBCAD) is not authorized to determine legal title to property or establish the legal boundaries of property. FBCAD establishes appraisal records based on information from various sources, including but not limited to deeds, plats and surveys provided to but not created by the district. FBCAD is not responsible for errors or omissions in information submitted to and reviewed by the district. If any errors or omission are detected, contact the GIS Department of the FBCAD.

A-51  
E LIPPINCOTT

NEEDVILLE  
ISD  
S05

8010  
18.667 AC

FM 1994 RD

A-346  
GEO WATERS

DAVIS ESTATE RD

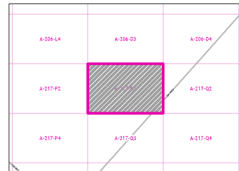

Grid Location Reference



County Location Reference

# 2021 Certified Tax Roll



**Grid Page  
A-217-Q2**

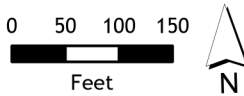

Fort Bend Central Appraisal District (FBCAD) is not authorized to determine legal title to property or establish the legal boundaries of property. FBCAD establishes appraisal records based on information from various sources, including but not limited to deeds, plats and surveys provided to but not created by the district. FBCAD is not responsible for errors or omissions in information submitted to and reviewed by the district. If any errors or omission are detected, contact the GIS Department of the FBCAD.

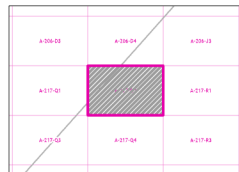

Grid Location Reference



County Location Reference

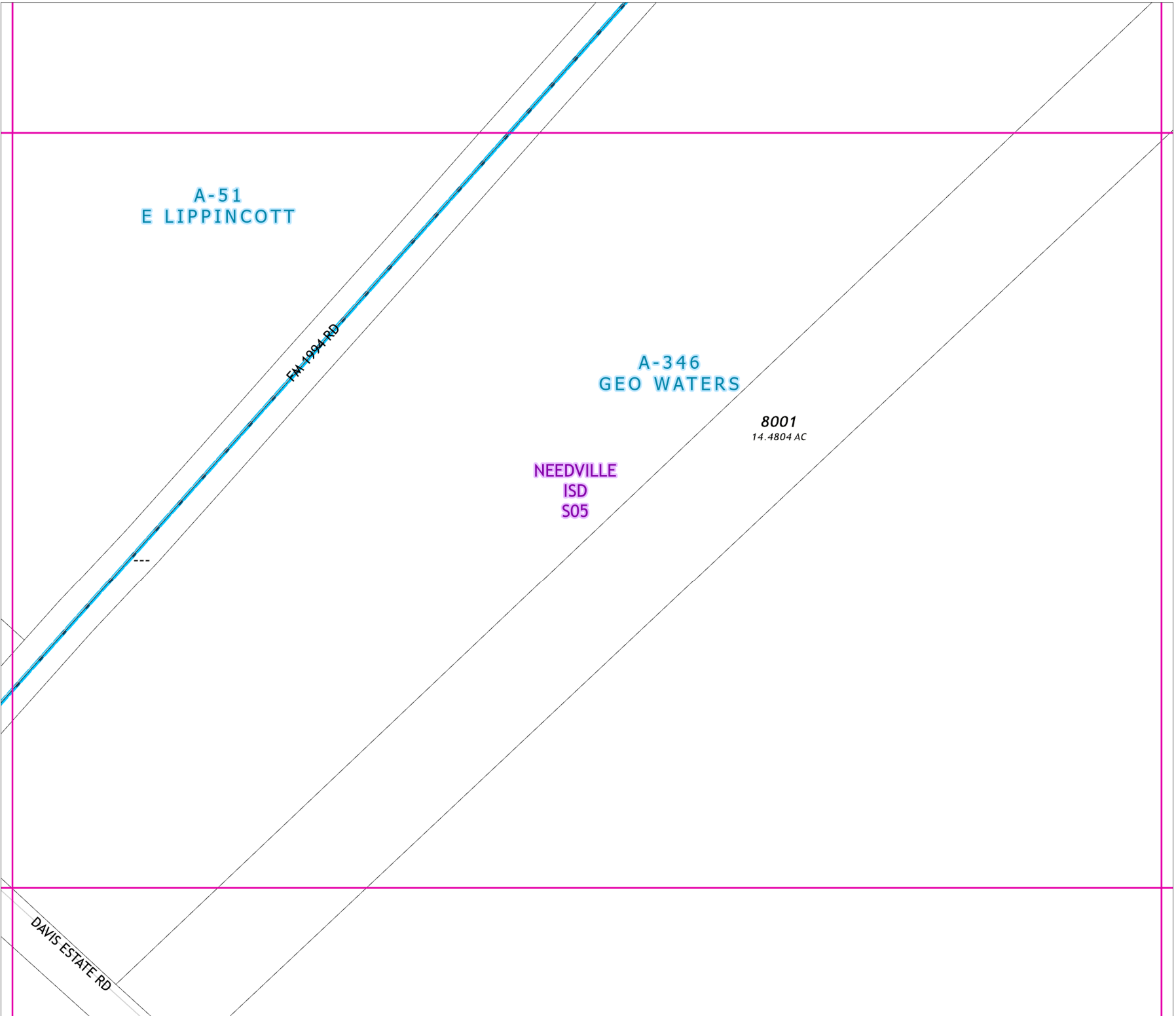

8010  
18.667 AC

# 2021 Certified Tax Roll



Grid Page  
A-217-Q3

A-51  
E LIPPINCOTT

NEEDVILLE  
ISD  
S05

FM 1994 RD

DAVIS ESTATE RD

A-346  
GEO WATERS

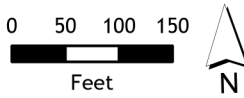

Fort Bend Central Appraisal District (FBCAD) is not authorized to determine legal title to property or establish the legal boundaries of property. FBCAD establishes appraisal records based on information from various sources, including but not limited to deeds, plats and surveys provided to but not created by the district. FBCAD is not responsible for errors or omissions in information submitted to and reviewed by the district. If any errors or omission are detected, contact the GIS Department of the FBCAD.

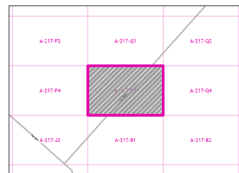

Grid Location Reference

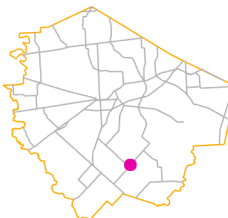

County Location Reference

# 2021 Certified Tax Roll



**Grid Page  
A-217-Q4**



Fort Bend Central Appraisal District (FBCAD) is not authorized to determine legal title to property or establish the legal boundaries of property. FBCAD establishes appraisal records based on information from various sources, including but not limited to deeds, plats and surveys provided to but not created by the district. FBCAD is not responsible for errors or omissions in information submitted to and reviewed by the district. If any errors or omission are detected, contact the GIS Department of the FBCAD.

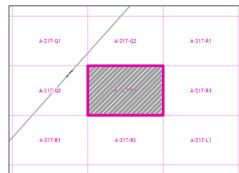

Grid Location Reference

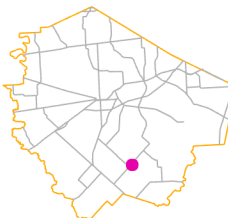

County Location Reference

**A-346  
GEO WATERS**

**NEEDVILLE  
ISD  
S05**

DAVIS ESTATE RD

# 2021 Certified Tax Roll



**Grid Page  
A-217-R1**



Fort Bend Central Appraisal District (FBCAD) is not authorized to determine legal title to property or establish the legal boundaries of property. FBCAD establishes appraisal records based on information from various sources, including but not limited to deeds, plats and surveys provided to but not created by the district. FBCAD is not responsible for errors or omissions in information submitted to and reviewed by the district. If any errors or omission are detected, contact the GIS Department of the FBCAD.

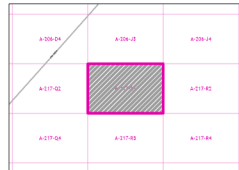

Grid Location Reference



County Location Reference

**A-24  
P FAIRCHILD**

**NEEDVILLE  
ISD  
S05**

**A-346  
GEO WATERS**

# 2021 Certified Tax Roll



**Grid Page  
A-217-R2**

**A-24  
P FAIRCHILD  
NEEDVILLE  
ISD  
S05**

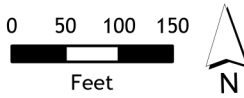

Fort Bend Central Appraisal District (FBCAD) is not authorized to determine legal title to property or establish the legal boundaries of property. FBCAD establishes appraisal records based on information from various sources, including but not limited to deeds, plats and surveys provided to but not created by the district. FBCAD is not responsible for errors or omissions in information submitted to and reviewed by the district. If any errors or omission are detected, contact the GIS Department of the FBCAD.

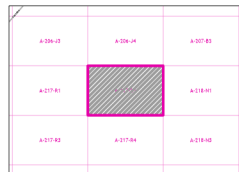

Grid Location Reference



County Location Reference

**A-346  
GEO WATERS**

# 2021 Certified Tax Roll



**Grid Page  
A-217-R3**

**A-346  
GEO WATERS**

**NEEDVILLE  
ISD  
S05**

**8000  
465.8767 AC**

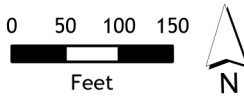

Fort Bend Central Appraisal District (FBCAD) is not authorized to determine legal title to property or establish the legal boundaries of property. FBCAD establishes appraisal records based on information from various sources, including but not limited to deeds, plats and surveys provided to but not created by the district. FBCAD is not responsible for errors or omissions in information submitted to and reviewed by the district. If any errors or omission are detected, contact the GIS Department of the FBCAD.

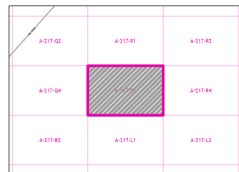

Grid Location Reference



County Location Reference

# 2021 Certified Tax Roll



Grid Page  
A-217-R4



Fort Bend Central Appraisal District (FBCAD) is not authorized to determine legal title to property or establish the legal boundaries of property. FBCAD establishes appraisal records based on information from various sources, including but not limited to deeds, plats and surveys provided to but not created by the district. FBCAD is not responsible for errors or omissions in information submitted to and reviewed by the district. If any errors or omission are detected, contact the GIS Department of the FBCAD.

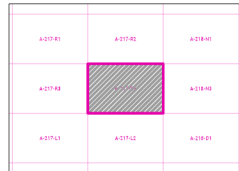

Grid Location Reference



County Location Reference

A-24  
P FAIRCHILD

NEEDVILLE  
ISD  
S05

A-346  
GEO WATERS