

2021 Certified Tax Roll



Grid Page
A-199-A1



Fort Bend Central Appraisal District (FBCAD) is not authorized to determine legal title to property or establish the legal boundaries of property. FBCAD establishes appraisal records based on information from various sources, including but not limited to deeds, plats and surveys provided to but not created by the district. FBCAD is not responsible for errors or omissions in information submitted to and reviewed by the district. If any errors or omission are detected, contact the GIS Department of the FBCAD.

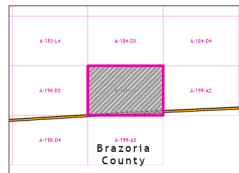

Grid Location Reference

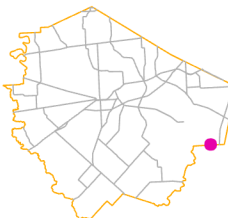

County Location Reference

A-184-D3

A-68
WM PETTUS

FT
BEND
ISD
S07

A-198-D2

A-199-A2

A-199-A3

2021 Certified Tax Roll



**Grid Page
A-199-A2**

**A-68
WM PETTUS** **FT
BEND
ISD
S07**

A-199-A1

A-199-B1

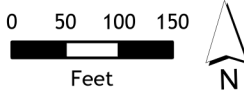

Fort Bend Central Appraisal District (FBCAD) is not authorized to determine legal title to property or establish the legal boundaries of property. FBCAD establishes appraisal records based on information from various sources, including but not limited to deeds, plats and surveys provided to but not created by the district. FBCAD is not responsible for errors or omissions in information submitted to and reviewed by the district. If any errors or omission are detected, contact the GIS Department of the FBCAD.

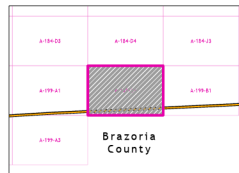

Grid Location Reference

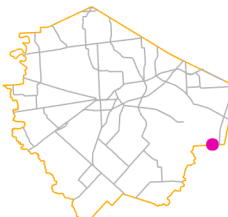

County Location Reference

A-199-A1

A-68
WM PETTUS

FT
BEND
ISD
S07

2021 Certified Tax Roll



Grid Page
A-199-A3

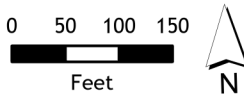

Fort Bend Central Appraisal District (FBCAD) is not authorized to determine legal title to property or establish the legal boundaries of property. FBCAD establishes appraisal records based on information from various sources, including but not limited to deeds, plats and surveys provided to but not created by the district. FBCAD is not responsible for errors or omissions in information submitted to and reviewed by the district. If any errors or omission are detected, contact the GIS Department of the FBCAD.

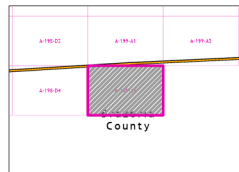

Grid Location Reference

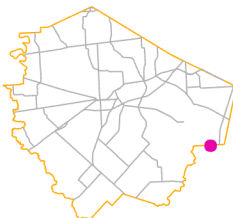

County Location Reference

A-198-D4

2021 Certified Tax Roll



Grid Page
A-199-B1

A-68
WM PETTUS FT
BEND
ISD
S07

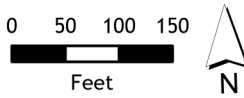

Fort Bend Central Appraisal District (FBCAD) is not authorized to determine legal title to property or establish the legal boundaries of property. FBCAD establishes appraisal records based on information from various sources, including but not limited to deeds, plats and surveys provided to but not created by the district. FBCAD is not responsible for errors or omissions in information submitted to and reviewed by the district. If any errors or omission are detected, contact the GIS Department of the FBCAD.

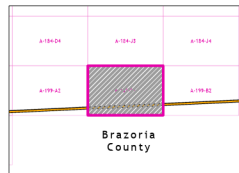

Grid Location Reference

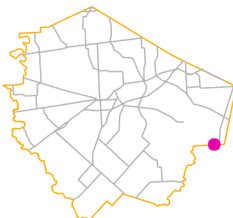

County Location Reference

4205
10 AC

A-199-A2

A-199-B2

2021 Certified Tax Roll



Grid Page
A-199-B2

A-68
WM PETTUS

FT
BEND
ISD
S07

A-199-B1

A-199-C1

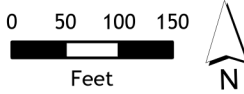

Fort Bend Central Appraisal District (FBCAD) is not authorized to determine legal title to property or establish the legal boundaries of property. FBCAD establishes appraisal records based on information from various sources, including but not limited to deeds, plats and surveys provided to but not created by the district. FBCAD is not responsible for errors or omissions in information submitted to and reviewed by the district. If any errors or omission are detected, contact the GIS Department of the FBCAD.

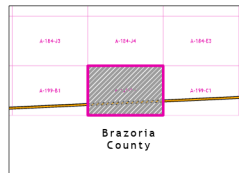

Grid Location Reference

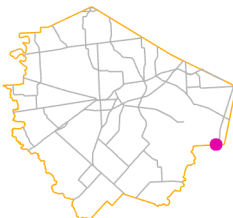

County Location Reference

2021 Certified Tax Roll



**Grid Page
A-199-C1**

**A-68
WM PETTUS** **FT
BEND
ISD
S07**

A-199-B2

A-199-C2

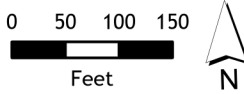

Fort Bend Central Appraisal District (FBCAD) is not authorized to determine legal title to property or establish the legal boundaries of property. FBCAD establishes appraisal records based on information from various sources, including but not limited to deeds, plats and surveys provided to but not created by the district. FBCAD is not responsible for errors or omissions in information submitted to and reviewed by the district. If any errors or omission are detected, contact the GIS Department of the FBCAD.

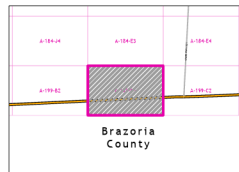

Grid Location Reference

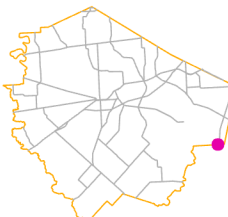

County Location Reference

2021 Certified Tax Roll



Grid Page
A-199-C2

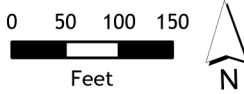

Fort Bend Central Appraisal District (FBCAD) is not authorized to determine legal title to property or establish the legal boundaries of property. FBCAD establishes appraisal records based on information from various sources, including but not limited to deeds, plats and surveys provided to but not created by the district. FBCAD is not responsible for errors or omissions in information submitted to and reviewed by the district. If any errors or omission are detected, contact the GIS Department of the FBCAD.

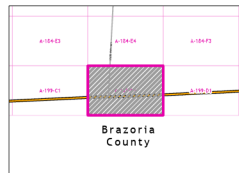

Grid Location Reference

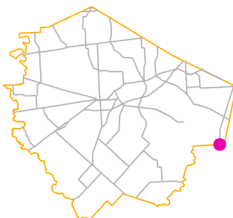

County Location Reference



2021 Certified Tax Roll



Grid Page
A-199-D1

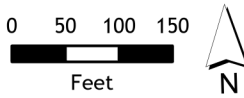

Fort Bend Central Appraisal District (FBCAD) is not authorized to determine legal title to property or establish the legal boundaries of property. FBCAD establishes appraisal records based on information from various sources, including but not limited to deeds, plats and surveys provided to but not created by the district. FBCAD is not responsible for errors or omissions in information submitted to and reviewed by the district. If any errors or omission are detected, contact the GIS Department of the FBCAD.

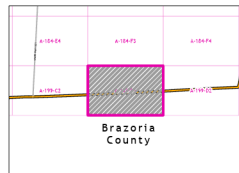

Grid Location Reference

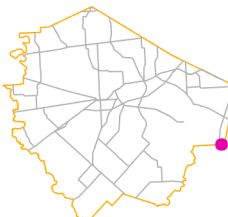

County Location Reference

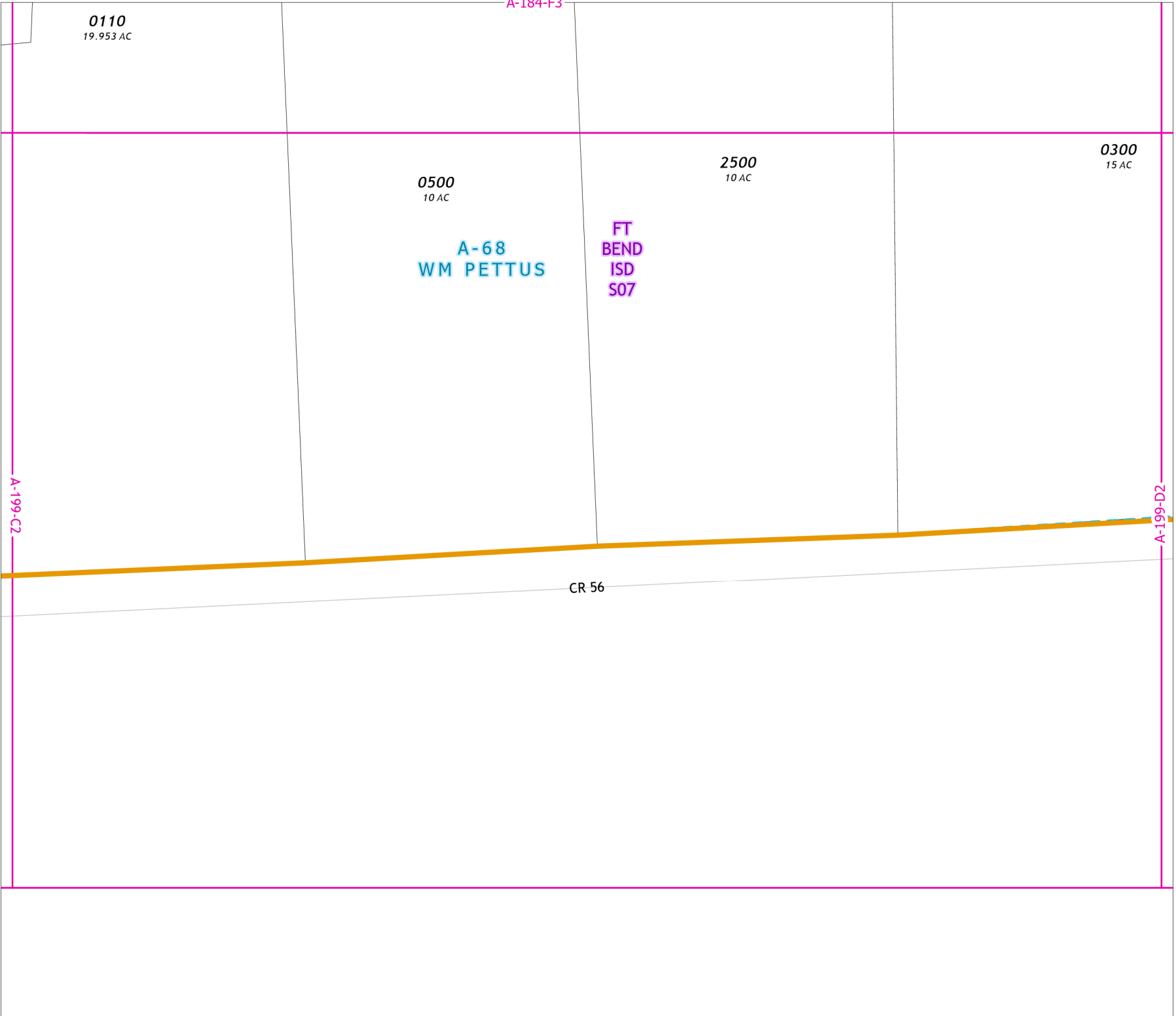

A-184-F4

4446

FT
BEND
ISD
S07

0100
13.392 AC

A-68
WM PETTUS

0203

0204

CR 56

A-199-D1

A-199A-P1

2021 Certified Tax Roll



Grid Page
A-199-D2

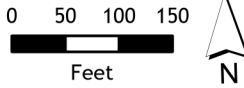

Fort Bend Central Appraisal District (FBCAD) is not authorized to determine legal title to property or establish the legal boundaries of property. FBCAD establishes appraisal records based on information from various sources, including but not limited to deeds, plats and surveys provided to but not created by the district. FBCAD is not responsible for errors or omissions in information submitted to and reviewed by the district. If any errors or omission are detected, contact the GIS Department of the FBCAD.

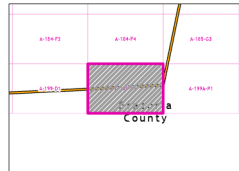

Grid Location Reference

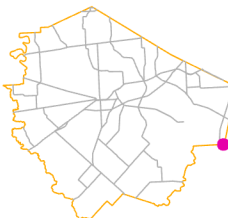

County Location Reference