

# 2021 Certified Tax Roll



## Grid Page A-179-A1

A-5  
W T AUSTIN

LAMAR  
CISD  
S01

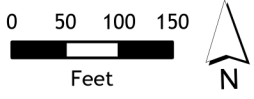

Fort Bend Central Appraisal District (FBCAD) is not authorized to determine legal title to property or establish the legal boundaries of property. FBCAD establishes appraisal records based on information from various sources, including but not limited to deeds, plats and surveys provided to but not created by the district. FBCAD is not responsible for errors or omissions in information submitted to and reviewed by the district. If any errors or omission are detected, contact the GIS Department of the FBCAD.

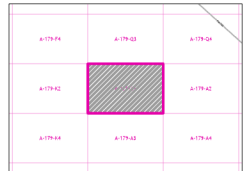

Grid Location Reference



County Location Reference

# 2021 Certified Tax Roll



## Grid Page A-179-A2

A-5  
W T AUSTIN  
LAMAR  
CISD  
S01

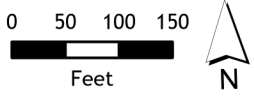

Fort Bend Central Appraisal District (FBCAD) is not authorized to determine legal title to property or establish the legal boundaries of property. FBCAD establishes appraisal records based on information from various sources, including but not limited to deeds, plats and surveys provided to but not created by the district. FBCAD is not responsible for errors or omissions in information submitted to and reviewed by the district. If any errors or omission are detected, contact the GIS Department of the FBCAD.

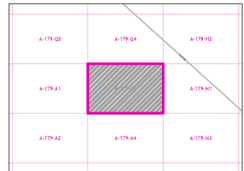

Grid Location Reference



County Location Reference

# 2021 Certified Tax Roll



**Grid Page  
A-179-A3**

**A-5  
W T AUSTIN**

**LAMAR  
CISD  
S01**

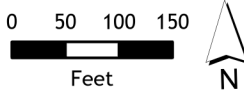

Fort Bend Central Appraisal District (FBCAD) is not authorized to determine legal title to property or establish the legal boundaries of property. FBCAD establishes appraisal records based on information from various sources, including but not limited to deeds, plats and surveys provided to but not created by the district. FBCAD is not responsible for errors or omissions in information submitted to and reviewed by the district. If any errors or omission are detected, contact the GIS Department of the FBCAD.

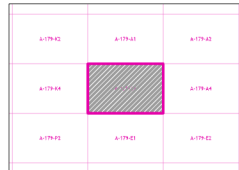

Grid Location Reference



County Location Reference

# 2021 Certified Tax Roll



**Grid Page  
A-179-A4**

**A-5  
W T AUSTIN  
LAMAR  
CISD  
S01**

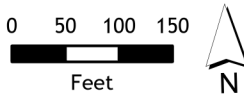

Fort Bend Central Appraisal District (FBCAD) is not authorized to determine legal title to property or establish the legal boundaries of property. FBCAD establishes appraisal records based on information from various sources, including but not limited to deeds, plats and surveys provided to but not created by the district. FBCAD is not responsible for errors or omissions in information submitted to and reviewed by the district. If any errors or omission are detected, contact the GIS Department of the FBCAD.

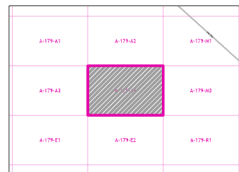

Grid Location Reference



County Location Reference

A-99  
M YOUNG

A-163-J3

BOOTHLINE RD

A-178-J2

LAMAR  
CISD  
S01

A-5  
W T AUSTIN

A-179-B3

# 2021 Certified Tax Roll



Grid Page  
A-179-B1

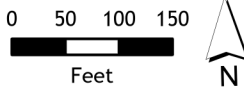

Fort Bend Central Appraisal District (FBCAD) is not authorized to determine legal title to property or establish the legal boundaries of property. FBCAD establishes appraisal records based on information from various sources, including but not limited to deeds, plats and surveys provided to but not created by the district. FBCAD is not responsible for errors or omissions in information submitted to and reviewed by the district. If any errors or omission are detected, contact the GIS Department of the FBCAD.

A-162-N4	A-162-B	A-162-S4
A-179-B2	A-179-B1	A-179-B2
A-179-S4	A-179-B3	A-179-S4

Grid Location Reference



County Location Reference

# 2021 Certified Tax Roll



Grid Page  
A-179-B2



Fort Bend Central Appraisal District (FBCAD) is not authorized to determine legal title to property or establish the legal boundaries of property. FBCAD establishes appraisal records based on information from various sources, including but not limited to deeds, plats and surveys provided to but not created by the district. FBCAD is not responsible for errors or omissions in information submitted to and reviewed by the district. If any errors or omission are detected, contact the GIS Department of the FBCAD.

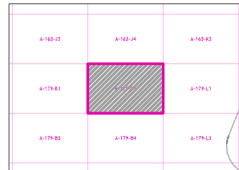

Grid Location Reference



County Location Reference

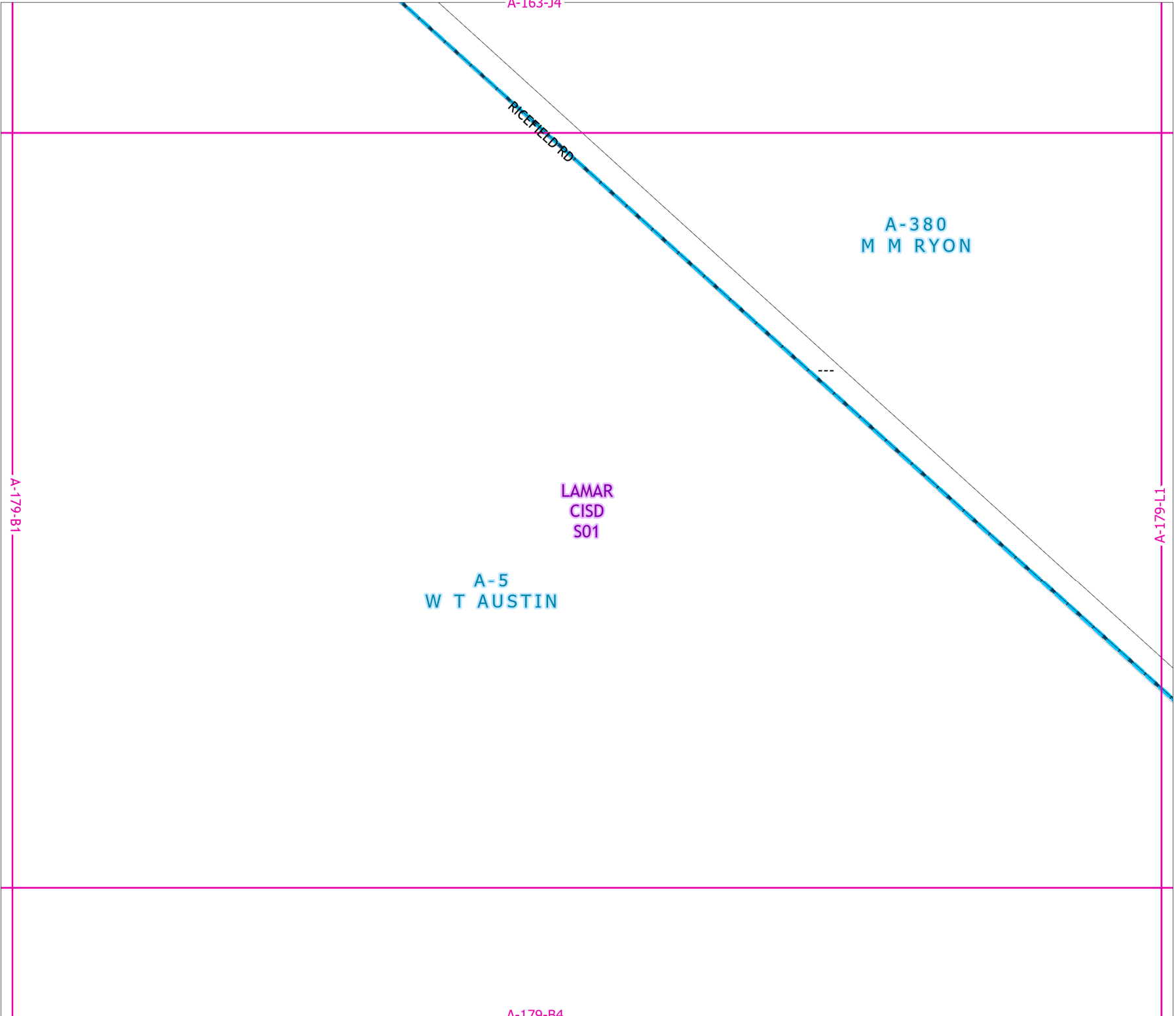

# 2021 Certified Tax Roll



**Grid Page  
A-179-B3**

**A-5  
W T AUSTIN**

**LAMAR  
CISD  
S01**

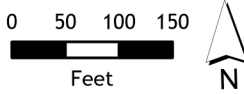

Fort Bend Central Appraisal District (FBCAD) is not authorized to determine legal title to property or establish the legal boundaries of property. FBCAD establishes appraisal records based on information from various sources, including but not limited to deeds, plats and surveys provided to but not created by the district. FBCAD is not responsible for errors or omissions in information submitted to and reviewed by the district. If any errors or omission are detected, contact the GIS Department of the FBCAD.

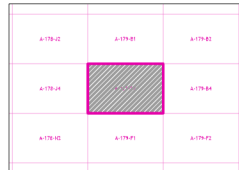

Grid Location Reference



County Location Reference

**0023**  
467 AC

# 2021 Certified Tax Roll



**Grid Page  
A-179-B4**

**A-5  
W T AUSTIN  
LAMAR  
CISD  
S01**

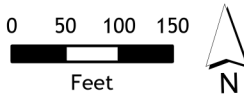

Fort Bend Central Appraisal District (FBCAD) is not authorized to determine legal title to property or establish the legal boundaries of property. FBCAD establishes appraisal records based on information from various sources, including but not limited to deeds, plats and surveys provided to but not created by the district. FBCAD is not responsible for errors or omissions in information submitted to and reviewed by the district. If any errors or omission are detected, contact the GIS Department of the FBCAD.

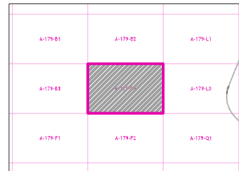

Grid Location Reference



County Location Reference



# 2021 Certified Tax Roll



**Grid Page  
A-179-C1**

**A-147  
BEATY-SEALES-FORWOOD**

**LAMAR  
CISD  
S01**

A-179-M2

A-179-C2

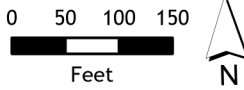

Fort Bend Central Appraisal District (FBCAD) is not authorized to determine legal title to property or establish the legal boundaries of property. FBCAD establishes appraisal records based on information from various sources, including but not limited to deeds, plats and surveys provided to but not created by the district. FBCAD is not responsible for errors or omissions in information submitted to and reviewed by the district. If any errors or omission are detected, contact the GIS Department of the FBCAD.

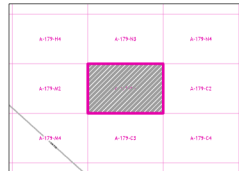

Grid Location Reference



County Location Reference



**A-147  
BEATY-SEALES-FORWOOD**  
LAMAR  
CISD  
S01

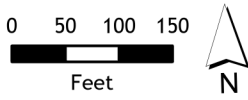

Fort Bend Central Appraisal District (FBCAD) is not authorized to determine legal title to property or establish the legal boundaries of property. FBCAD establishes appraisal records based on information from various sources, including but not limited to deeds, plats and surveys provided to but not created by the district. FBCAD is not responsible for errors or omissions in information submitted to and reviewed by the district. If any errors or omission are detected, contact the GIS Department of the FBCAD.

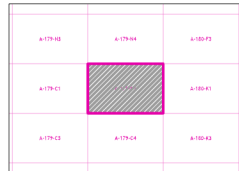

Grid Location Reference



County Location Reference

A-179-C1

A-180-K1

A-179-C4

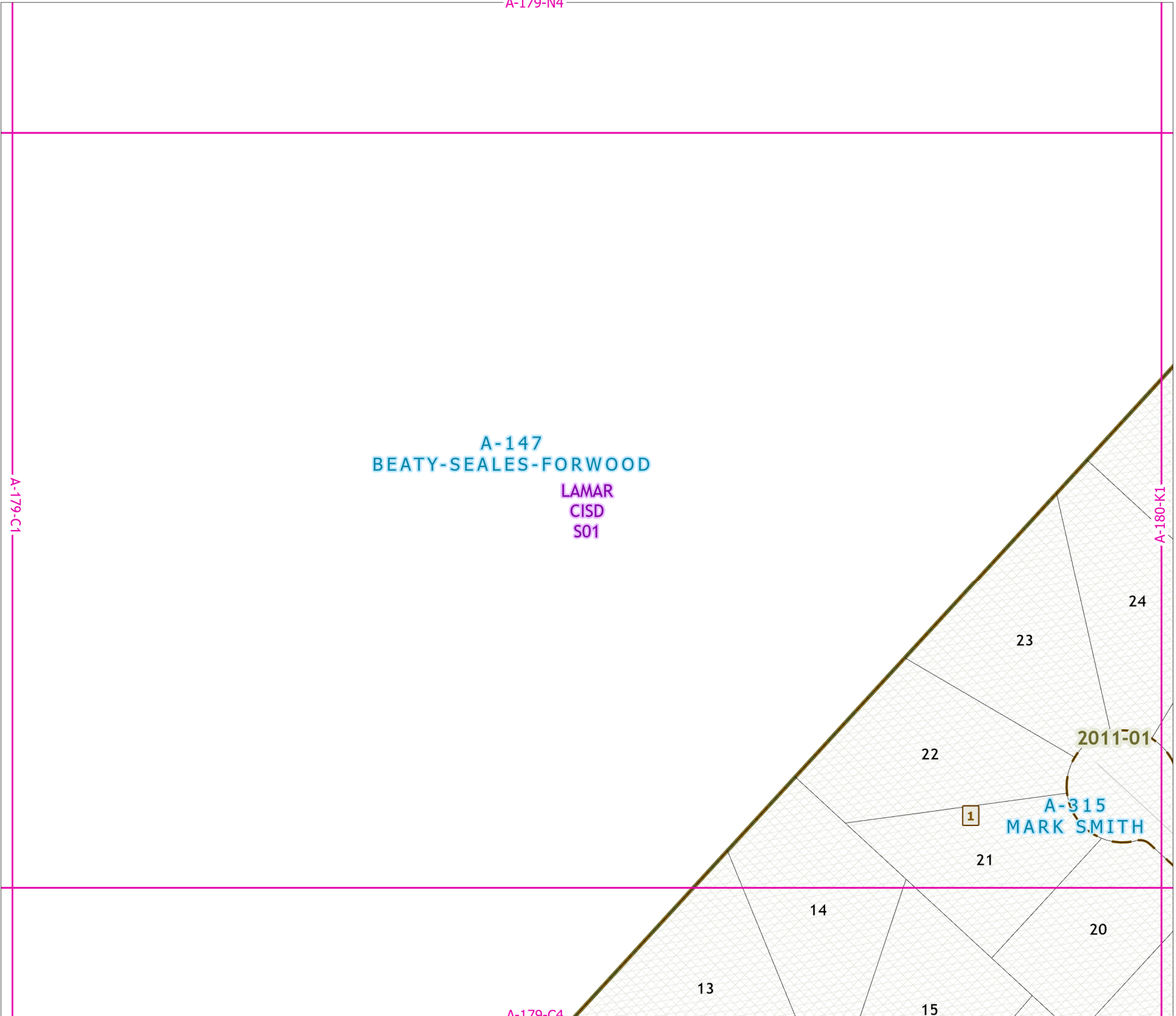

# 2021 Certified Tax Roll



**Grid Page  
A-179-C3**

LAMAR  
CISD  
S01  
A-147  
BEATY-SEALES-FORWOOD

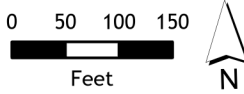

Fort Bend Central Appraisal District (FBCAD) is not authorized to determine legal title to property or establish the legal boundaries of property. FBCAD establishes appraisal records based on information from various sources, including but not limited to deeds, plats and surveys provided to but not created by the district. FBCAD is not responsible for errors or omissions in information submitted to and reviewed by the district. If any errors or omission are detected, contact the GIS Department of the FBCAD.

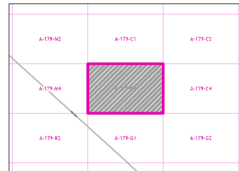

Grid Location Reference



County Location Reference

1

2011-01

A-179-C2

# 2021 Certified Tax Roll



Grid Page  
A-179-C4

A-147  
BEATY-SEALES-FORWOOD

LAMAR  
CISD  
S01

A-179-C3

A-180-K3

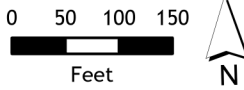

Fort Bend Central Appraisal District (FBCAD) is not authorized to determine legal title to property or establish the legal boundaries of property. FBCAD establishes appraisal records based on information from various sources, including but not limited to deeds, plats and surveys provided to but not created by the district. FBCAD is not responsible for errors or omissions in information submitted to and reviewed by the district. If any errors or omission are detected, contact the GIS Department of the FBCAD.

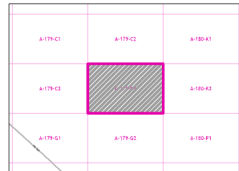

Grid Location Reference



County Location Reference

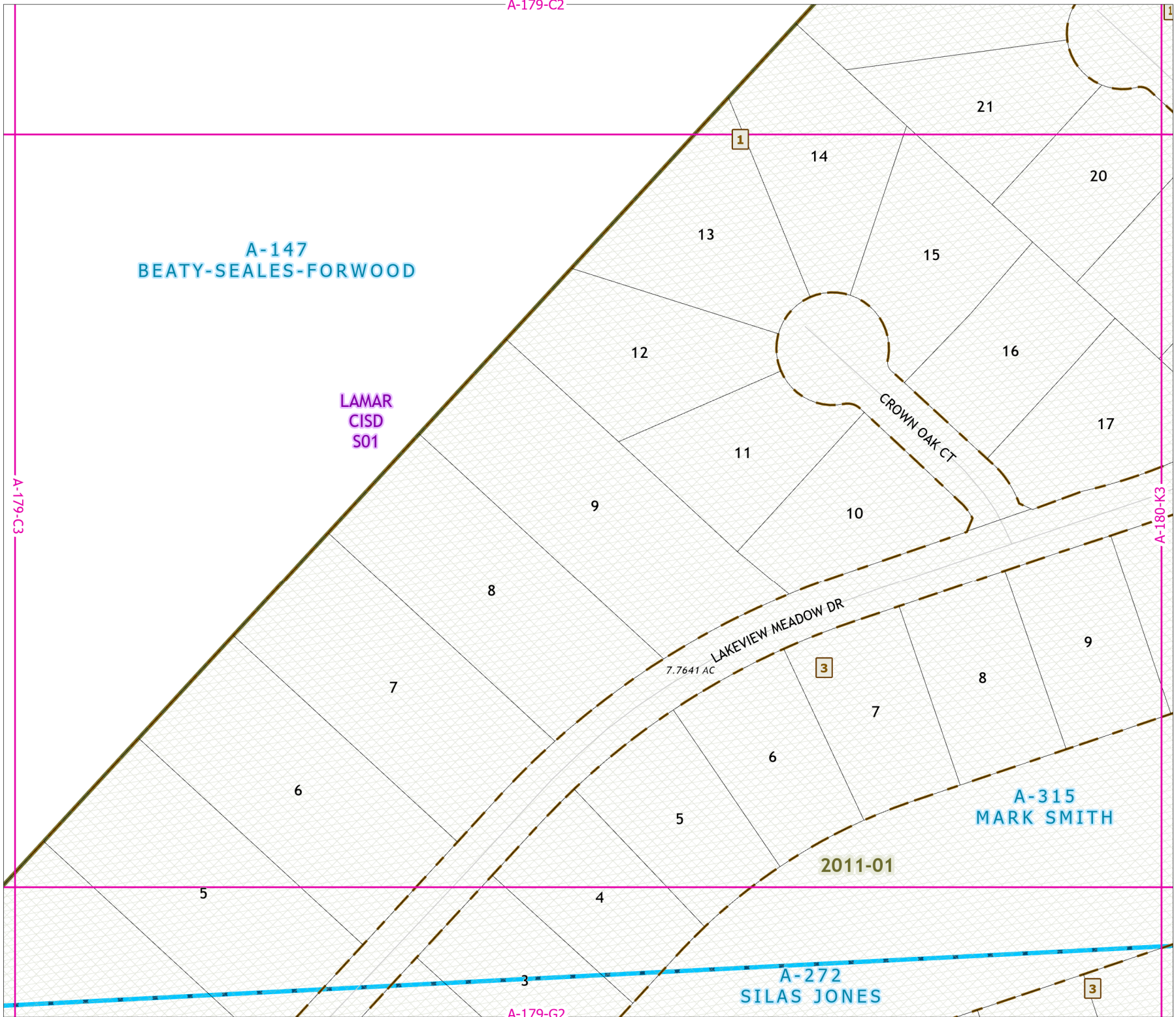

7.7641 AC

2011-01

A-272  
SILAS JONES

A-315  
MARK SMITH

# 2021 Certified Tax Roll



Grid Page  
A-179-D1



Fort Bend Central Appraisal District (FBCAD) is not authorized to determine legal title to property or establish the legal boundaries of property. FBCAD establishes appraisal records based on information from various sources, including but not limited to deeds, plats and surveys provided to but not created by the district. FBCAD is not responsible for errors or omissions in information submitted to and reviewed by the district. If any errors or omission are detected, contact the GIS Department of the FBCAD.

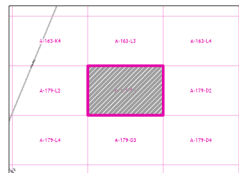

Grid Location Reference



County Location Reference

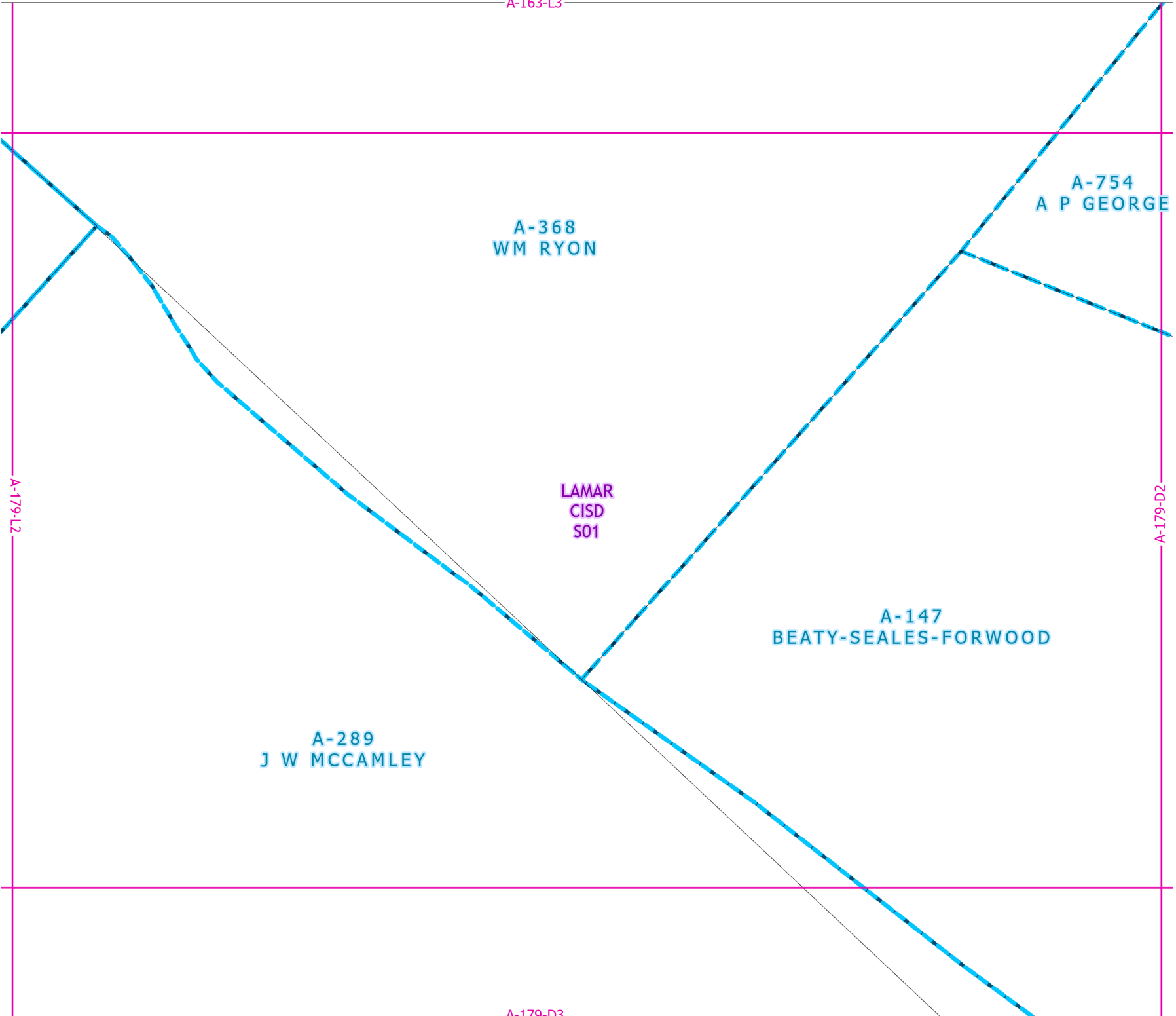

# 2021 Certified Tax Roll



Grid Page  
A-179-D2



Fort Bend Central Appraisal District (FBCAD) is not authorized to determine legal title to property or establish the legal boundaries of property. FBCAD establishes appraisal records based on information from various sources, including but not limited to deeds, plats and surveys provided to but not created by the district. FBCAD is not responsible for errors or omissions in information submitted to and reviewed by the district. If any errors or omission are detected, contact the GIS Department of the FBCAD.

A-179-L3	A-180-L4	A-180-R5
A-179-D1		A-179-D2
A-179-D3	A-179-D4	A-179-D5

Grid Location Reference



County Location Reference

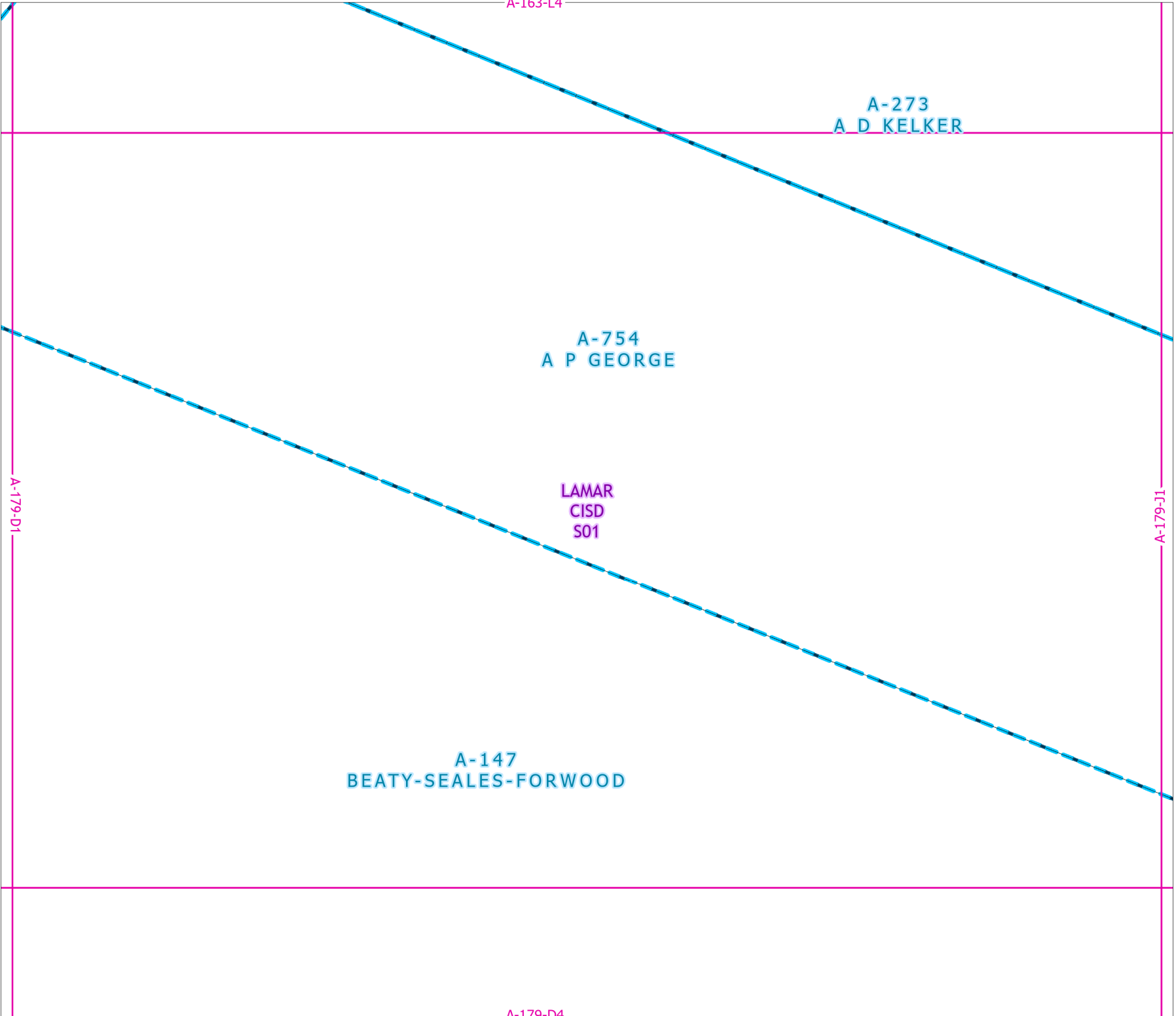

# 2021 Certified Tax Roll



Grid Page  
A-179-D3



Fort Bend Central Appraisal District (FBCAD) is not authorized to determine legal title to property or establish the legal boundaries of property. FBCAD establishes appraisal records based on information from various sources, including but not limited to deeds, plats and surveys provided to but not created by the district. FBCAD is not responsible for errors or omissions in information submitted to and reviewed by the district. If any errors or omission are detected, contact the GIS Department of the FBCAD.

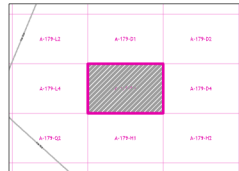

Grid Location Reference



County Location Reference

A-179-D1

A-147  
BEATY-SEALES-FORWOOD

LAMAR  
CISD  
S01  
A-289  
J W MCCAMLEY

A-179-L4

A-179-D4

A-179-H1

A-179-D2

# 2021 Certified Tax Roll



Grid Page  
A-179-D4

A-147  
BEATY-SEALES-FORWOOD

LAMAR  
CISD  
S01

0010  
145.2 AC

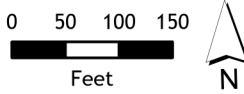

Fort Bend Central Appraisal District (FBCAD) is not authorized to determine legal title to property or establish the legal boundaries of property. FBCAD establishes appraisal records based on information from various sources, including but not limited to deeds, plats and surveys provided to but not created by the district. FBCAD is not responsible for errors or omissions in information submitted to and reviewed by the district. If any errors or omission are detected, contact the GIS Department of the FBCAD.

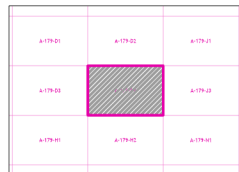

Grid Location Reference



County Location Reference

A-179-D3

A-179-J3

A-179-H2

A-289  
J W MCCAMLEY



# 2021 Certified Tax Roll



**Grid Page  
A-179-E1**

**A-5  
W T AUSTIN**

**LAMAR  
CISD  
S01**

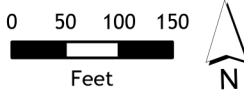

Fort Bend Central Appraisal District (FBCAD) is not authorized to determine legal title to property or establish the legal boundaries of property. FBCAD establishes appraisal records based on information from various sources, including but not limited to deeds, plats and surveys provided to but not created by the district. FBCAD is not responsible for errors or omissions in information submitted to and reviewed by the district. If any errors or omission are detected, contact the GIS Department of the FBCAD.

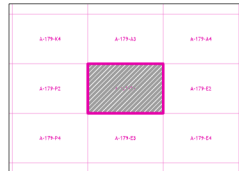

Grid Location Reference



County Location Reference

# 2021 Certified Tax Roll



**Grid Page  
A-179-E2**

**A-5  
W T AUSTIN**

**LAMAR  
CISD  
S01**

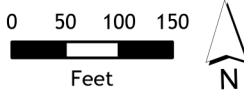

Fort Bend Central Appraisal District (FBCAD) is not authorized to determine legal title to property or establish the legal boundaries of property. FBCAD establishes appraisal records based on information from various sources, including but not limited to deeds, plats and surveys provided to but not created by the district. FBCAD is not responsible for errors or omissions in information submitted to and reviewed by the district. If any errors or omission are detected, contact the GIS Department of the FBCAD.

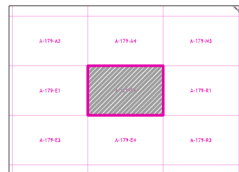

Grid Location Reference



County Location Reference

# 2021 Certified Tax Roll



**Grid Page  
A-179-E3**

**A-5  
W T AUSTIN  
LAMAR  
CISD  
S01**

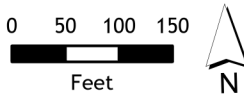

Fort Bend Central Appraisal District (FBCAD) is not authorized to determine legal title to property or establish the legal boundaries of property. FBCAD establishes appraisal records based on information from various sources, including but not limited to deeds, plats and surveys provided to but not created by the district. FBCAD is not responsible for errors or omissions in information submitted to and reviewed by the district. If any errors or omission are detected, contact the GIS Department of the FBCAD.

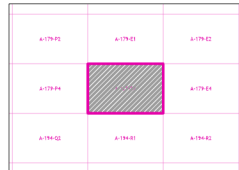

Grid Location Reference



County Location Reference

A-179-E2

# 2021 Certified Tax Roll



**Grid Page  
A-179-E4**

**A-5  
W T AUSTIN**

**LAMAR  
CISD  
S01**

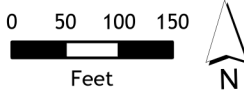

Fort Bend Central Appraisal District (FBCAD) is not authorized to determine legal title to property or establish the legal boundaries of property. FBCAD establishes appraisal records based on information from various sources, including but not limited to deeds, plats and surveys provided to but not created by the district. FBCAD is not responsible for errors or omissions in information submitted to and reviewed by the district. If any errors or omission are detected, contact the GIS Department of the FBCAD.

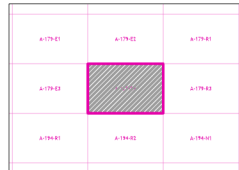

Grid Location Reference



County Location Reference

A-179-E3

A-179-R3

A-194-R2

0023  
467 AC

A-5  
W T AUSTIN

LAMAR  
CISD  
S01

# 2021 Certified Tax Roll



Grid Page  
A-179-F1

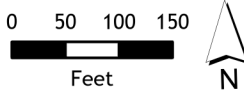

Fort Bend Central Appraisal District (FBCAD) is not authorized to determine legal title to property or establish the legal boundaries of property. FBCAD establishes appraisal records based on information from various sources, including but not limited to deeds, plats and surveys provided to but not created by the district. FBCAD is not responsible for errors or omissions in information submitted to and reviewed by the district. If any errors or omission are detected, contact the GIS Department of the FBCAD.

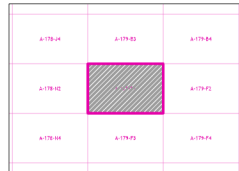

Grid Location Reference



County Location Reference



## Grid Page A-179-F2

A-5  
W T AUSTIN

LAMAR  
CISD  
S01

A-179-F1

A-179-Q1

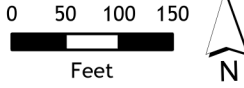

Fort Bend Central Appraisal District (FBCAD) is not authorized to determine legal title to property or establish the legal boundaries of property. FBCAD establishes appraisal records based on information from various sources, including but not limited to deeds, plats and surveys provided to but not created by the district. FBCAD is not responsible for errors or omissions in information submitted to and reviewed by the district. If any errors or omission are detected, contact the GIS Department of the FBCAD.

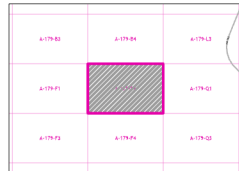

Grid Location Reference

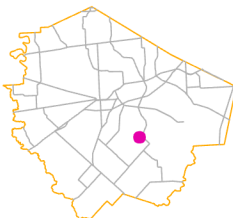

County Location Reference

A-179-F1

# 2021 Certified Tax Roll



Grid Page  
A-179-F3

A-5  
W T AUSTIN  
LAMAR  
CISD  
S01

A-178-N4

A-179-F4

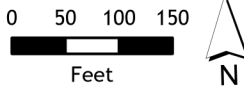

Fort Bend Central Appraisal District (FBCAD) is not authorized to determine legal title to property or establish the legal boundaries of property. FBCAD establishes appraisal records based on information from various sources, including but not limited to deeds, plats and surveys provided to but not created by the district. FBCAD is not responsible for errors or omissions in information submitted to and reviewed by the district. If any errors or omission are detected, contact the GIS Department of the FBCAD.

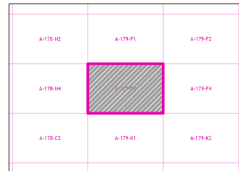

Grid Location Reference

0020  
16.4 AC



County Location Reference

A-179-K1

# 2021 Certified Tax Roll



Grid Page  
A-179-F4



Fort Bend Central Appraisal District (FBCAD) is not authorized to determine legal title to property or establish the legal boundaries of property. FBCAD establishes appraisal records based on information from various sources, including but not limited to deeds, plats and surveys provided to but not created by the district. FBCAD is not responsible for errors or omissions in information submitted to and reviewed by the district. If any errors or omission are detected, contact the GIS Department of the FBCAD.

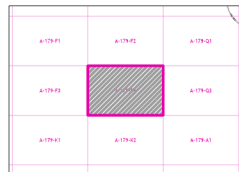

Grid Location Reference



County Location Reference

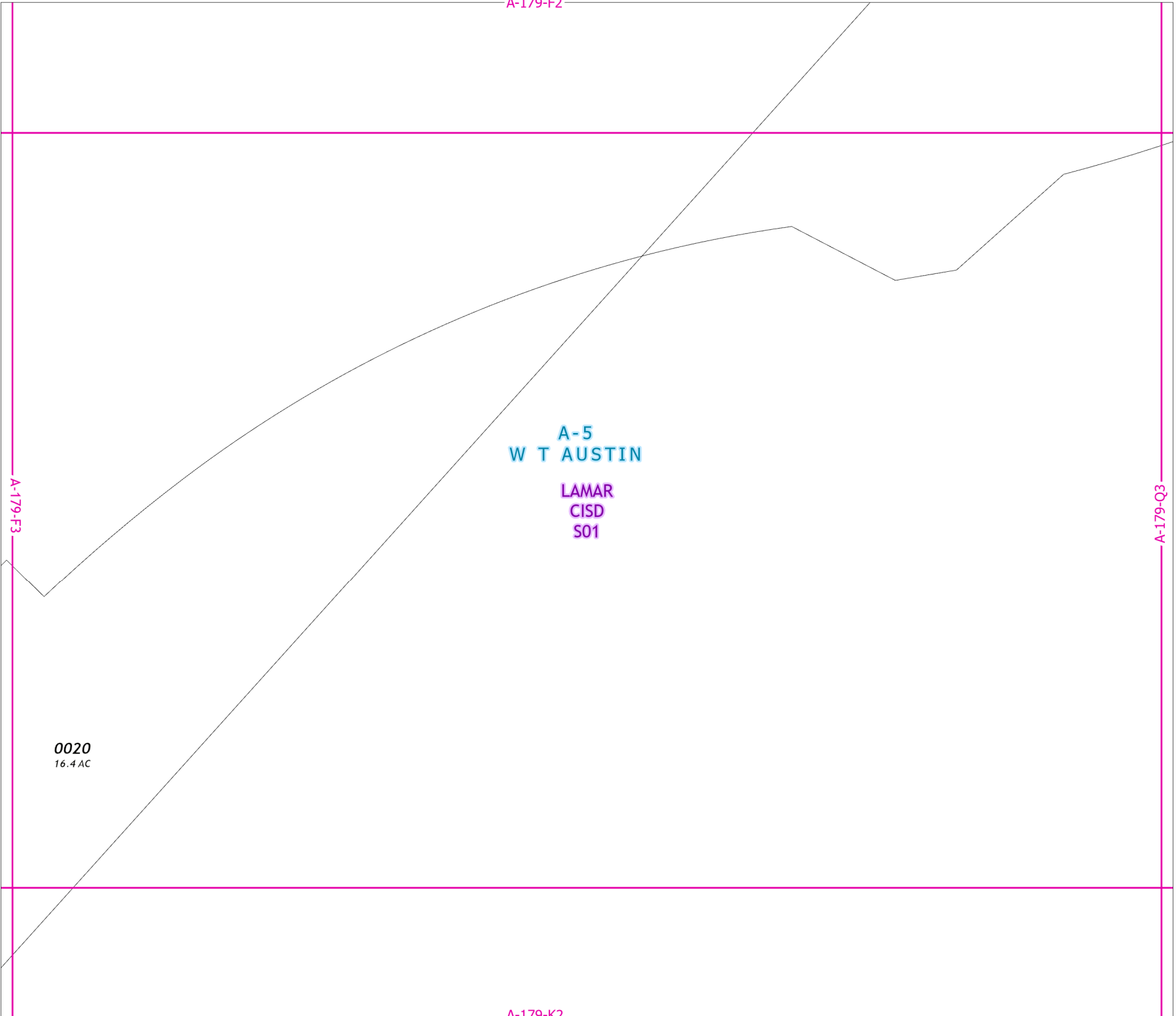



# 2021 Certified Tax Roll



Grid Page  
A-179-G1



Fort Bend Central Appraisal District (FBCAD) is not authorized to determine legal title to property or establish the legal boundaries of property. FBCAD establishes appraisal records based on information from various sources, including but not limited to deeds, plats and surveys provided to but not created by the district. FBCAD is not responsible for errors or omissions in information submitted to and reviewed by the district. If any errors or omission are detected, contact the GIS Department of the FBCAD.

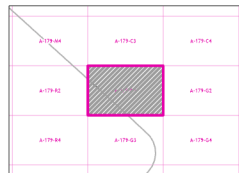

Grid Location Reference



County Location Reference

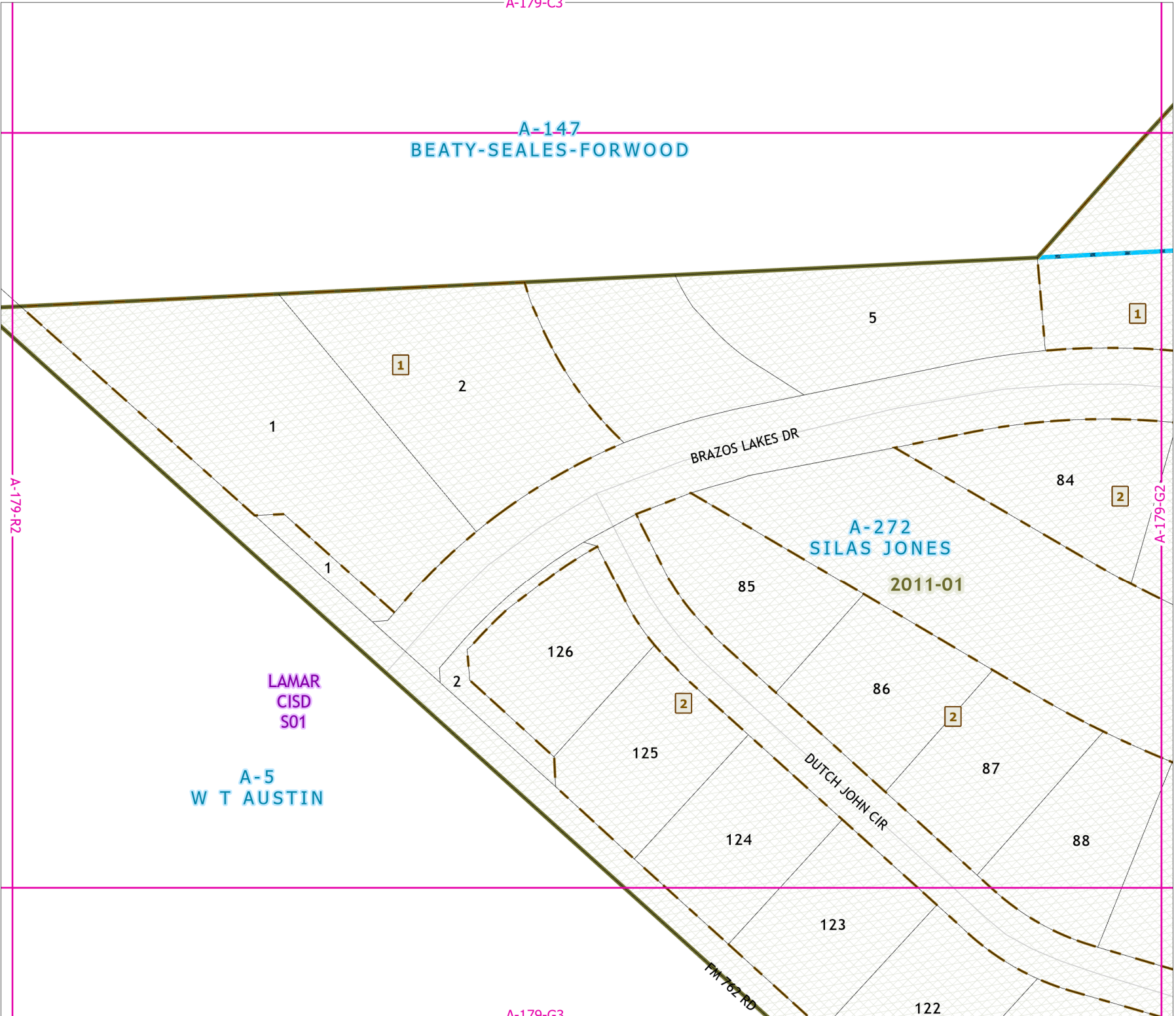

# 2021 Certified Tax Roll



Grid Page  
A-179-G2

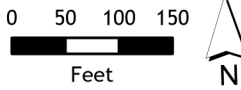

Fort Bend Central Appraisal District (FBCAD) is not authorized to determine legal title to property or establish the legal boundaries of property. FBCAD establishes appraisal records based on information from various sources, including but not limited to deeds, plats and surveys provided to but not created by the district. FBCAD is not responsible for errors or omissions in information submitted to and reviewed by the district. If any errors or omission are detected, contact the GIS Department of the FBCAD.

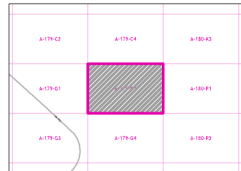

Grid Location Reference



County Location Reference

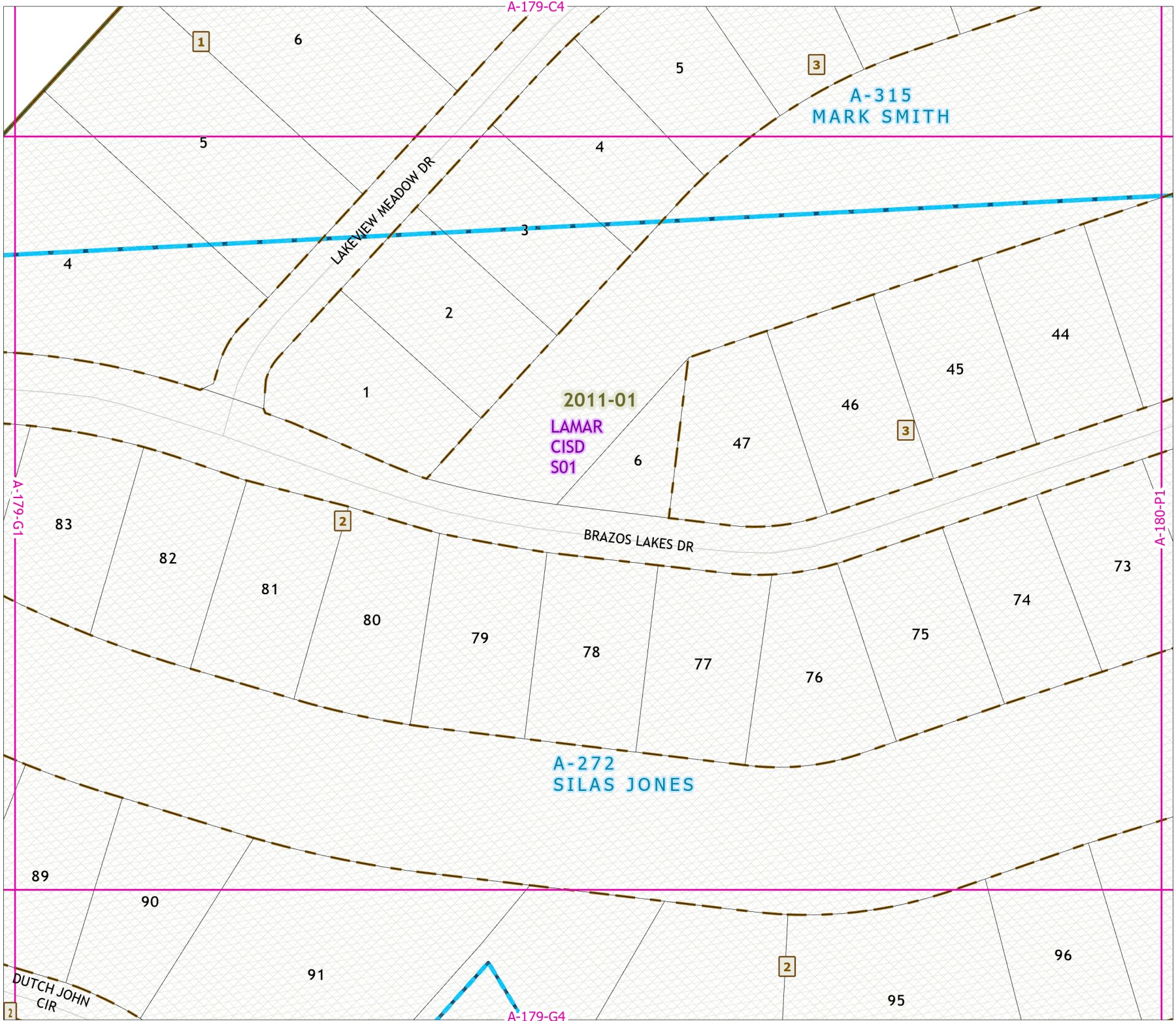

# 2021 Certified Tax Roll



**Grid Page  
A-179-G3**



Fort Bend Central Appraisal District (FBCAD) is not authorized to determine legal title to property or establish the legal boundaries of property. FBCAD establishes appraisal records based on information from various sources, including but not limited to deeds, plats and surveys provided to but not created by the district. FBCAD is not responsible for errors or omissions in information submitted to and reviewed by the district. If any errors or omission are detected, contact the GIS Department of the FBCAD.

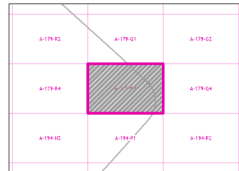

Grid Location Reference



County Location Reference

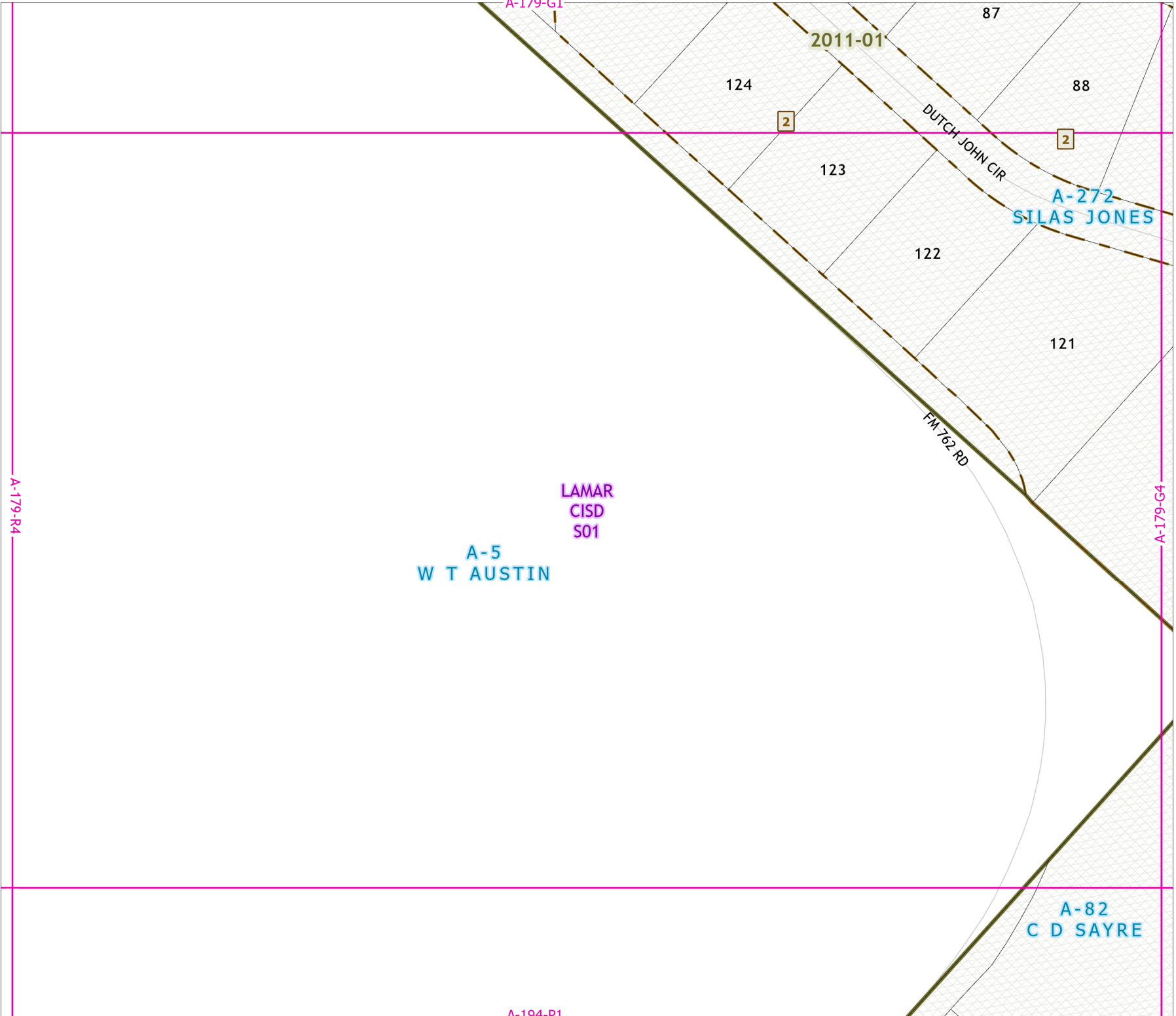

# 2021 Certified Tax Roll



Grid Page  
A-179-G4

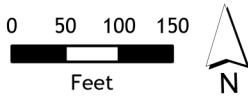

Fort Bend Central Appraisal District (FBCAD) is not authorized to determine legal title to property or establish the legal boundaries of property. FBCAD establishes appraisal records based on information from various sources, including but not limited to deeds, plats and surveys provided to but not created by the district. FBCAD is not responsible for errors or omissions in information submitted to and reviewed by the district. If any errors or omission are detected, contact the GIS Department of the FBCAD.

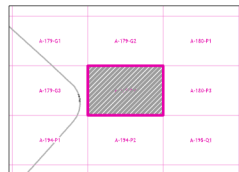

Grid Location Reference



County Location Reference

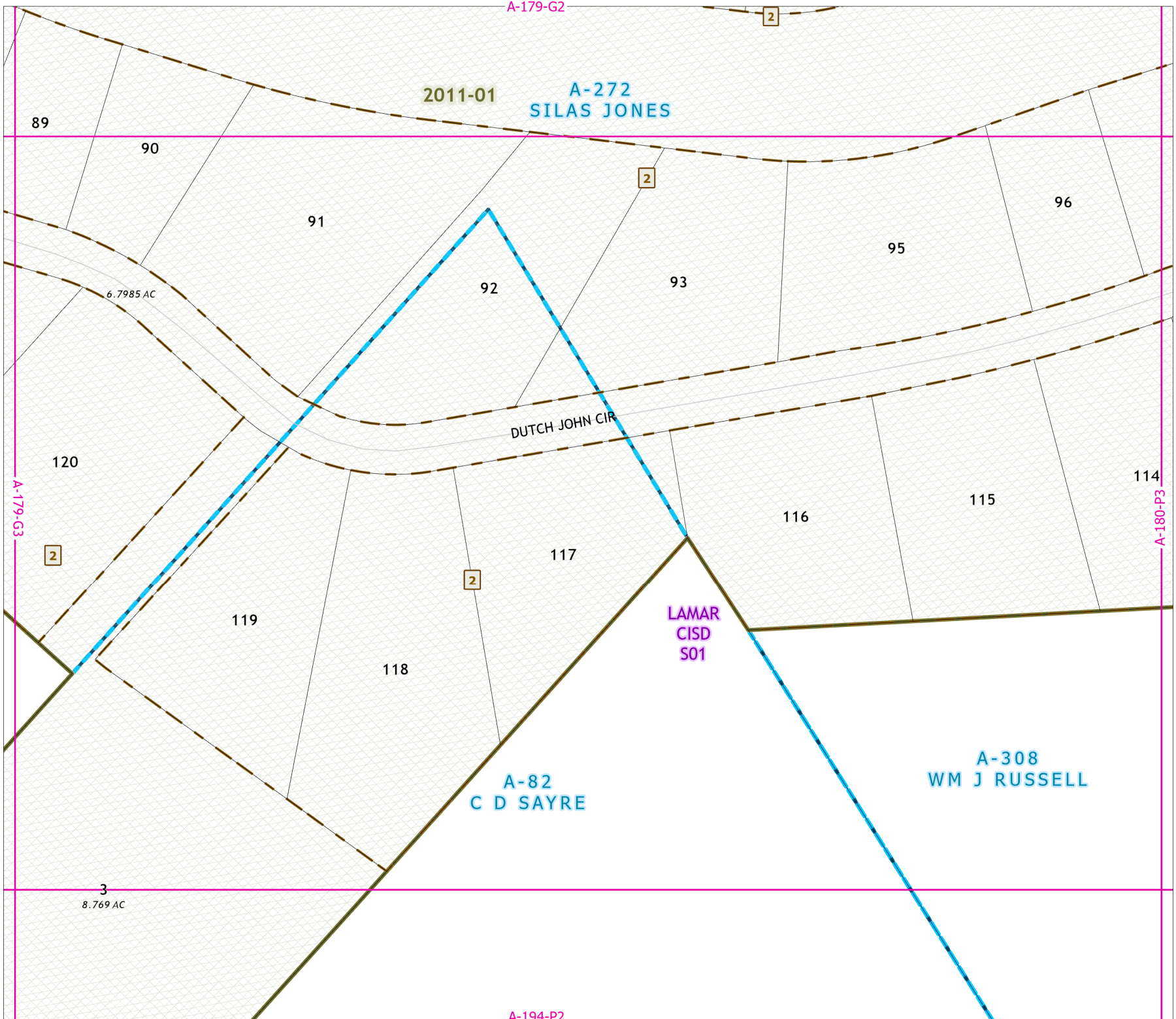

# 2021 Certified Tax Roll



**Grid Page  
A-179-H1**

**0010**  
242.97 AC

**A-289**  
**J W MCCAMLEY**

**LAMAR**  
**CISD**  
**S01**

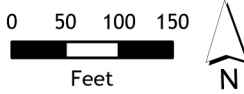

Fort Bend Central Appraisal District (FBCAD) is not authorized to determine legal title to property or establish the legal boundaries of property. FBCAD establishes appraisal records based on information from various sources, including but not limited to deeds, plats and surveys provided to but not created by the district. FBCAD is not responsible for errors or omissions in information submitted to and reviewed by the district. If any errors or omission are detected, contact the GIS Department of the FBCAD.

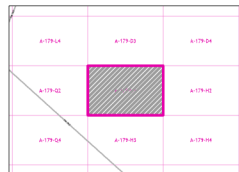

Grid Location Reference



County Location Reference

# 2021 Certified Tax Roll



**Grid Page  
A-179-H2**

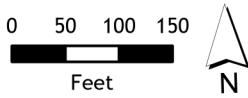

Fort Bend Central Appraisal District (FBCAD) is not authorized to determine legal title to property or establish the legal boundaries of property. FBCAD establishes appraisal records based on information from various sources, including but not limited to deeds, plats and surveys provided to but not created by the district. FBCAD is not responsible for errors or omissions in information submitted to and reviewed by the district. If any errors or omission are detected, contact the GIS Department of the FBCAD.

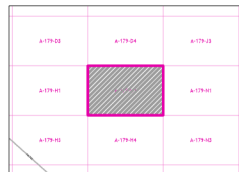

Grid Location Reference



County Location Reference

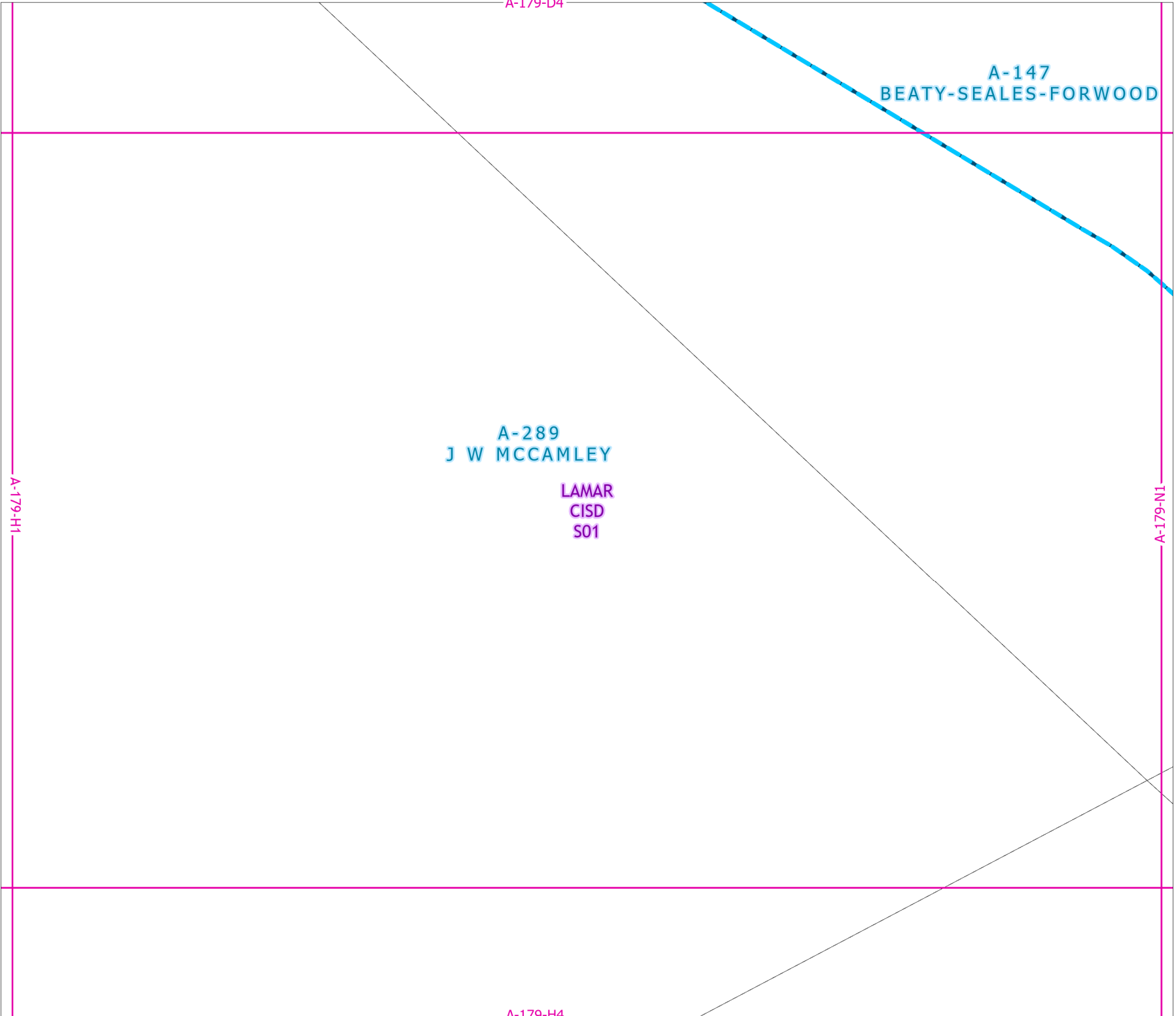

A-179-H1

# 2021 Certified Tax Roll



**Grid Page  
A-179-H3**

**A-289  
J W MCCAMLEY**

**LAMAR  
CISD  
S01**

**A-5  
W T AUSTIN**

**FM 762 RD**

A-179-M1

A-179-Q4

A-179-H4

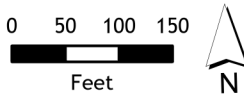

Fort Bend Central Appraisal District (FBCAD) is not authorized to determine legal title to property or establish the legal boundaries of property. FBCAD establishes appraisal records based on information from various sources, including but not limited to deeds, plats and surveys provided to but not created by the district. FBCAD is not responsible for errors or omissions in information submitted to and reviewed by the district. If any errors or omission are detected, contact the GIS Department of the FBCAD.

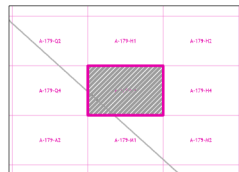

Grid Location Reference



County Location Reference

A-179-H2

# 2021 Certified Tax Roll



**Grid Page  
A-179-H4**

**A-289  
J W MCCAMLEY**

**LAMAR  
CISD  
S01**

**0020  
72.344 AC**

A-179-M2

A-179-H3

A-179-N3

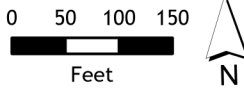

Fort Bend Central Appraisal District (FBCAD) is not authorized to determine legal title to property or establish the legal boundaries of property. FBCAD establishes appraisal records based on information from various sources, including but not limited to deeds, plats and surveys provided to but not created by the district. FBCAD is not responsible for errors or omissions in information submitted to and reviewed by the district. If any errors or omission are detected, contact the GIS Department of the FBCAD.

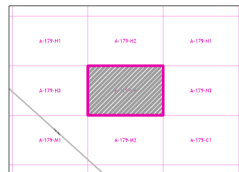

Grid Location Reference



County Location Reference



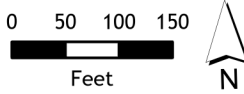

Fort Bend Central Appraisal District (FBCAD) is not authorized to determine legal title to property or establish the legal boundaries of property. FBCAD establishes appraisal records based on information from various sources, including but not limited to deeds, plats and surveys provided to but not created by the district. FBCAD is not responsible for errors or omissions in information submitted to and reviewed by the district. If any errors or omission are detected, contact the GIS Department of the FBCAD.

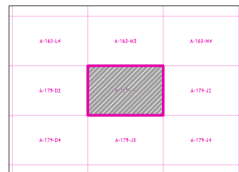

Grid Location Reference



County Location Reference

A-273  
A D KELKER

LAMAR  
CISD  
S01

0020  
51.036 AC

A-754  
A P GEORGE

A-147  
BEATY-SEALES-FORWOOD

A-179-D2

A-179-J2

A-179-J3

# 2021 Certified Tax Roll



**Grid Page  
A-179-J2**

**A-273  
A D KELKER**  
**LAMAR  
CISD  
S01**

**A-754  
A P GEORGE**

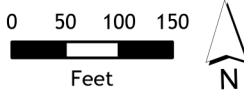

Fort Bend Central Appraisal District (FBCAD) is not authorized to determine legal title to property or establish the legal boundaries of property. FBCAD establishes appraisal records based on information from various sources, including but not limited to deeds, plats and surveys provided to but not created by the district. FBCAD is not responsible for errors or omissions in information submitted to and reviewed by the district. If any errors or omission are detected, contact the GIS Department of the FBCAD.

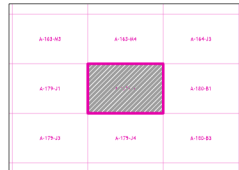

Grid Location Reference



County Location Reference

A-179-J1

A-180-B1

A-179-J4

# 2021 Certified Tax Roll



Grid Page  
A-179-J3



Fort Bend Central Appraisal District (FBCAD) is not authorized to determine legal title to property or establish the legal boundaries of property. FBCAD establishes appraisal records based on information from various sources, including but not limited to deeds, plats and surveys provided to but not created by the district. FBCAD is not responsible for errors or omissions in information submitted to and reviewed by the district. If any errors or omission are detected, contact the GIS Department of the FBCAD.

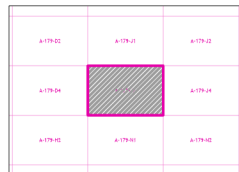

Grid Location Reference



County Location Reference

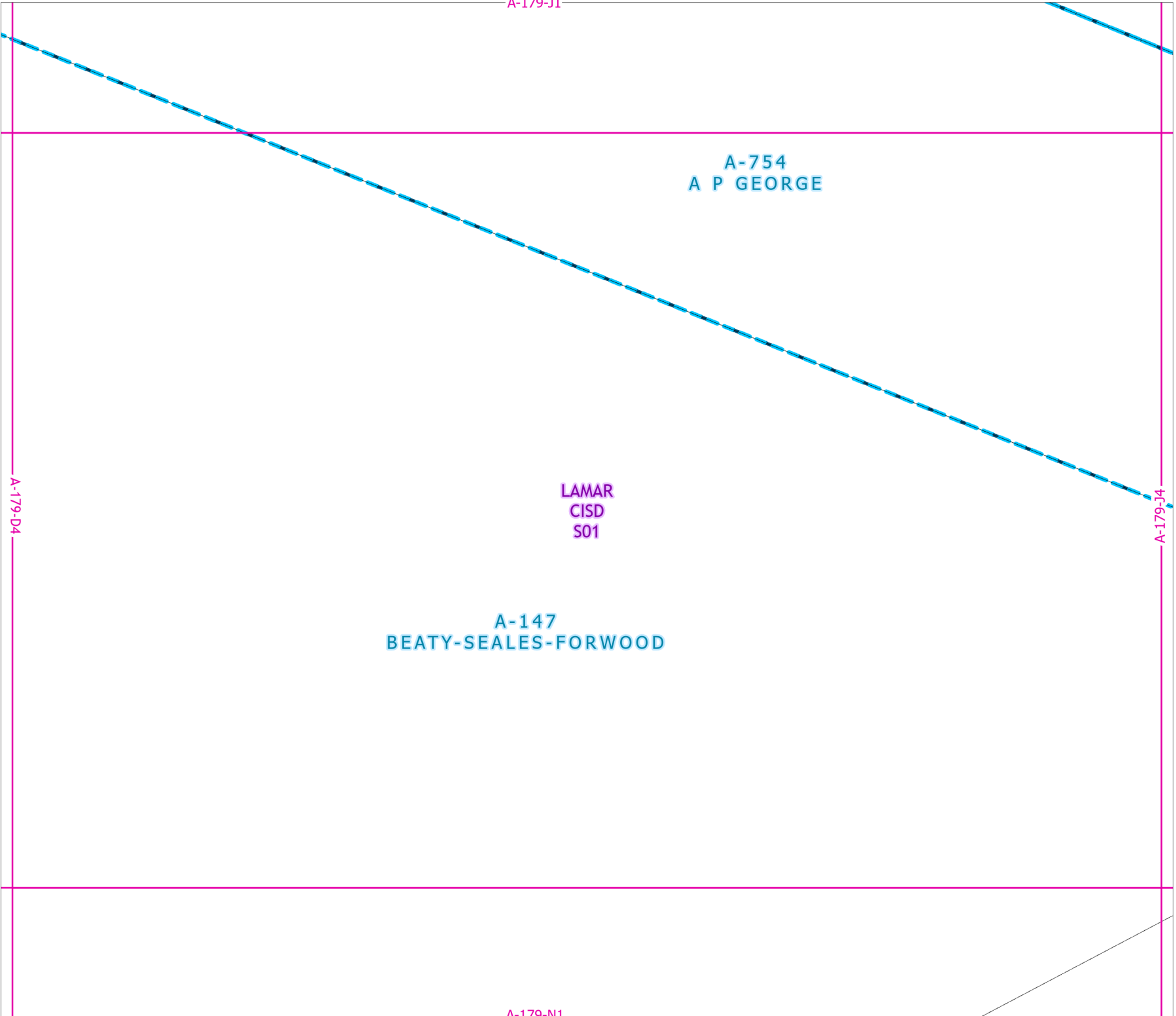

A-179-J2

# 2021 Certified Tax Roll



Grid Page  
A-179-J4

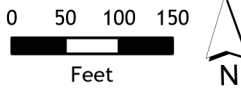

Fort Bend Central Appraisal District (FBCAD) is not authorized to determine legal title to property or establish the legal boundaries of property. FBCAD establishes appraisal records based on information from various sources, including but not limited to deeds, plats and surveys provided to but not created by the district. FBCAD is not responsible for errors or omissions in information submitted to and reviewed by the district. If any errors or omission are detected, contact the GIS Department of the FBCAD.

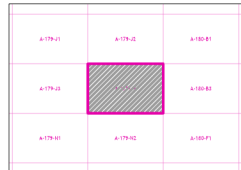

Grid Location Reference



County Location Reference

A-273  
A D KELKER

A-754  
A P GEORGE  
LAMAR  
CISD  
S01

A-147  
BEATY-SEALES-FORWOOD

A-179-N2

A-179-J3

A-180-B3

A-179-F3

0020  
16.4 AC

A-5  
W T AUSTIN

LAMAR  
CISD  
S01

A-178-C2

A-179-K2

A-179-K3

# 2021 Certified Tax Roll



Grid Page  
A-179-K1

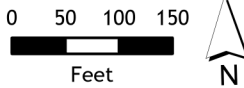

Fort Bend Central Appraisal District (FBCAD) is not authorized to determine legal title to property or establish the legal boundaries of property. FBCAD establishes appraisal records based on information from various sources, including but not limited to deeds, plats and surveys provided to but not created by the district. FBCAD is not responsible for errors or omissions in information submitted to and reviewed by the district. If any errors or omission are detected, contact the GIS Department of the FBCAD.

A-179-K4	A-179-F3	A-179-K4
A-179-K2	A-179-K1	A-179-K2
A-179-K4	A-179-K2	A-179-K4

Grid Location Reference



County Location Reference

0020  
16.4 AC

# 2021 Certified Tax Roll



Grid Page  
A-179-K2

A-5  
W T AUSTIN  
LAMAR  
CISD  
S01

A-179-K1

A-179-A1

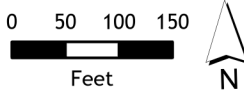

Fort Bend Central Appraisal District (FBCAD) is not authorized to determine legal title to property or establish the legal boundaries of property. FBCAD establishes appraisal records based on information from various sources, including but not limited to deeds, plats and surveys provided to but not created by the district. FBCAD is not responsible for errors or omissions in information submitted to and reviewed by the district. If any errors or omission are detected, contact the GIS Department of the FBCAD.

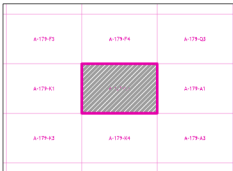

Grid Location Reference



County Location Reference

# 2021 Certified Tax Roll



Grid Page  
A-179-K3



Fort Bend Central Appraisal District (FBCAD) is not authorized to determine legal title to property or establish the legal boundaries of property. FBCAD establishes appraisal records based on information from various sources, including but not limited to deeds, plats and surveys provided to but not created by the district. FBCAD is not responsible for errors or omissions in information submitted to and reviewed by the district. If any errors or omission are detected, contact the GIS Department of the FBCAD.

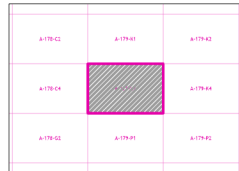

Grid Location Reference

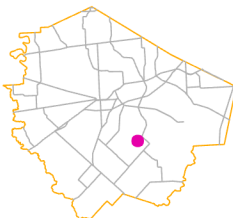

County Location Reference

A-179-K1

A-5  
W T AUSTIN

LAMAR  
CISD  
S01

A-178-C4

A-179-K4

A-179-P1

# 2021 Certified Tax Roll



**Grid Page  
A-179-K4**

**A-5  
W T AUSTIN  
LAMAR  
CISD  
S01**

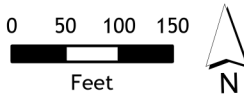

Fort Bend Central Appraisal District (FBCAD) is not authorized to determine legal title to property or establish the legal boundaries of property. FBCAD establishes appraisal records based on information from various sources, including but not limited to deeds, plats and surveys provided to but not created by the district. FBCAD is not responsible for errors or omissions in information submitted to and reviewed by the district. If any errors or omission are detected, contact the GIS Department of the FBCAD.

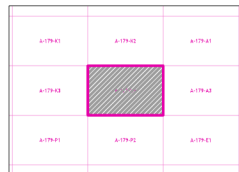

Grid Location Reference



County Location Reference



# 2021 Certified Tax Roll



Grid Page  
A-179-L1

A-380  
M M RYON

LAMAR  
CISD  
S01

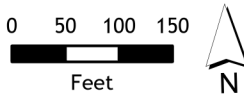

Fort Bend Central Appraisal District (FBCAD) is not authorized to determine legal title to property or establish the legal boundaries of property. FBCAD establishes appraisal records based on information from various sources, including but not limited to deeds, plats and surveys provided to but not created by the district. FBCAD is not responsible for errors or omissions in information submitted to and reviewed by the district. If any errors or omission are detected, contact the GIS Department of the FBCAD.

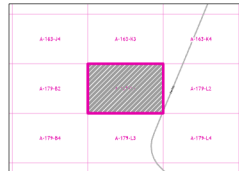

Grid Location Reference



County Location Reference

A-179-B2

A-179-L2

RICEFIELD RD

A-5  
W T AUSTIN

FM 762 RD

A-163-K4

A-368  
WM RYON

# 2021 Certified Tax Roll



Grid Page  
A-179-L2

A-380  
M M RYON

LAMAR  
CISD  
S01

0015  
53.213 AC

FM 762 RD

A-289  
J W MCCAMLEY

A-179-L1

A-179-D1

A-179-L4

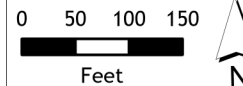

Fort Bend Central Appraisal District (FBCAD) is not authorized to determine legal title to property or establish the legal boundaries of property. FBCAD establishes appraisal records based on information from various sources, including but not limited to deeds, plats and surveys provided to but not created by the district. FBCAD is not responsible for errors or omissions in information submitted to and reviewed by the district. If any errors or omission are detected, contact the GIS Department of the FBCAD.

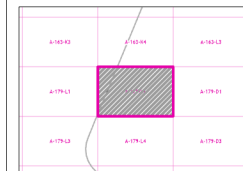

Grid Location Reference

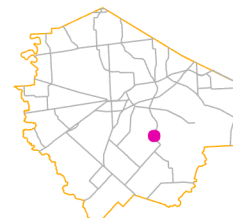

County Location Reference

# 2021 Certified Tax Roll



Grid Page  
A-179-L3

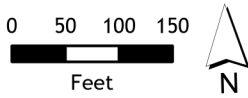

Fort Bend Central Appraisal District (FBCAD) is not authorized to determine legal title to property or establish the legal boundaries of property. FBCAD establishes appraisal records based on information from various sources, including but not limited to deeds, plats and surveys provided to but not created by the district. FBCAD is not responsible for errors or omissions in information submitted to and reviewed by the district. If any errors or omission are detected, contact the GIS Department of the FBCAD.

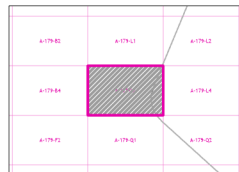

Grid Location Reference



County Location Reference

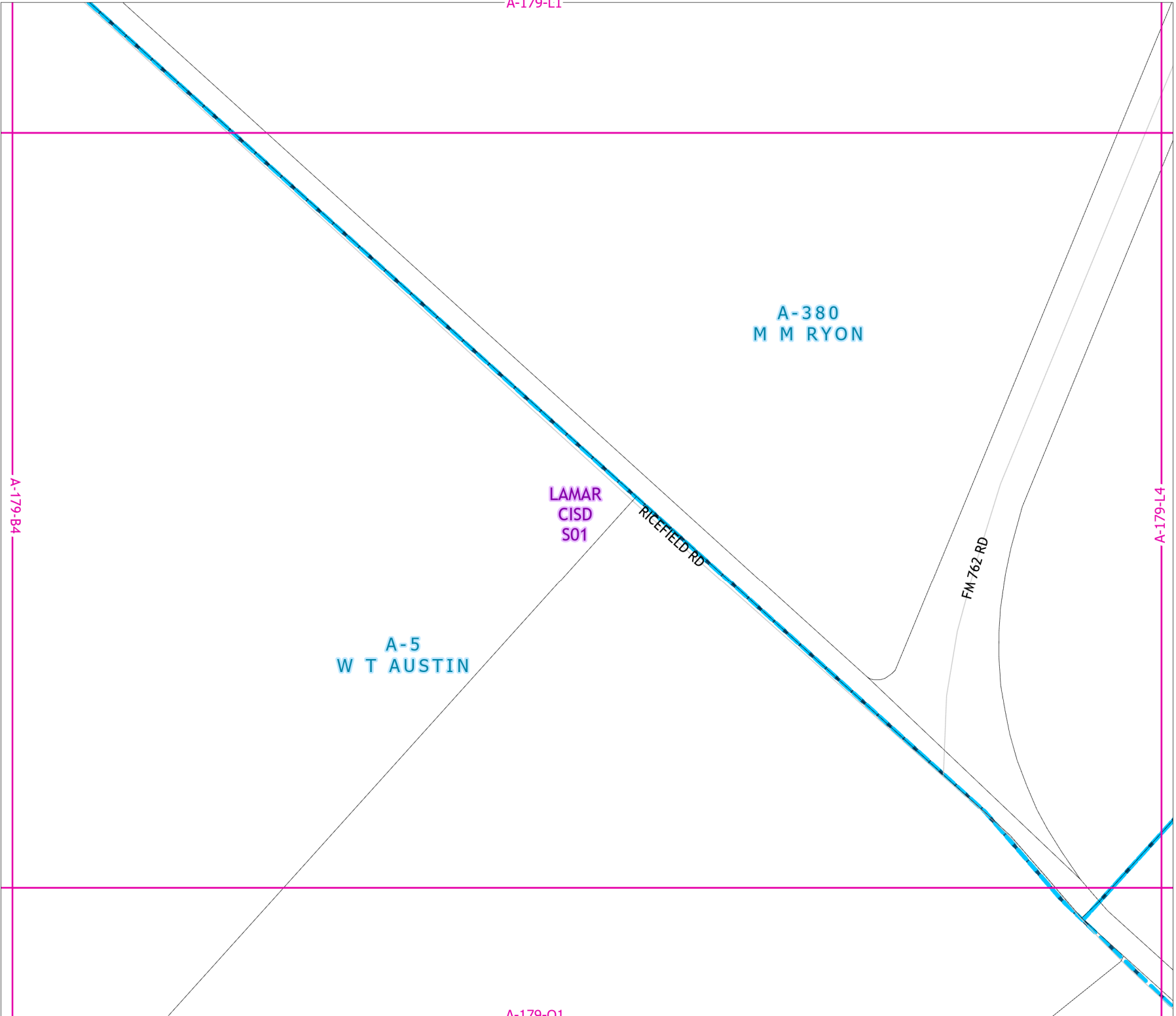

# 2021 Certified Tax Roll



**Grid Page**  
**A-179-L4**



Fort Bend Central Appraisal District (FBCAD) is not authorized to determine legal title to property or establish the legal boundaries of property. FBCAD establishes appraisal records based on information from various sources, including but not limited to deeds, plats and surveys provided to but not created by the district. FBCAD is not responsible for errors or omissions in information submitted to and reviewed by the district. If any errors or omission are detected, contact the GIS Department of the FBCAD.

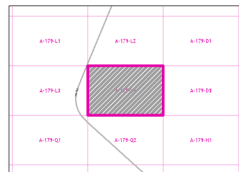

Grid Location Reference



County Location Reference

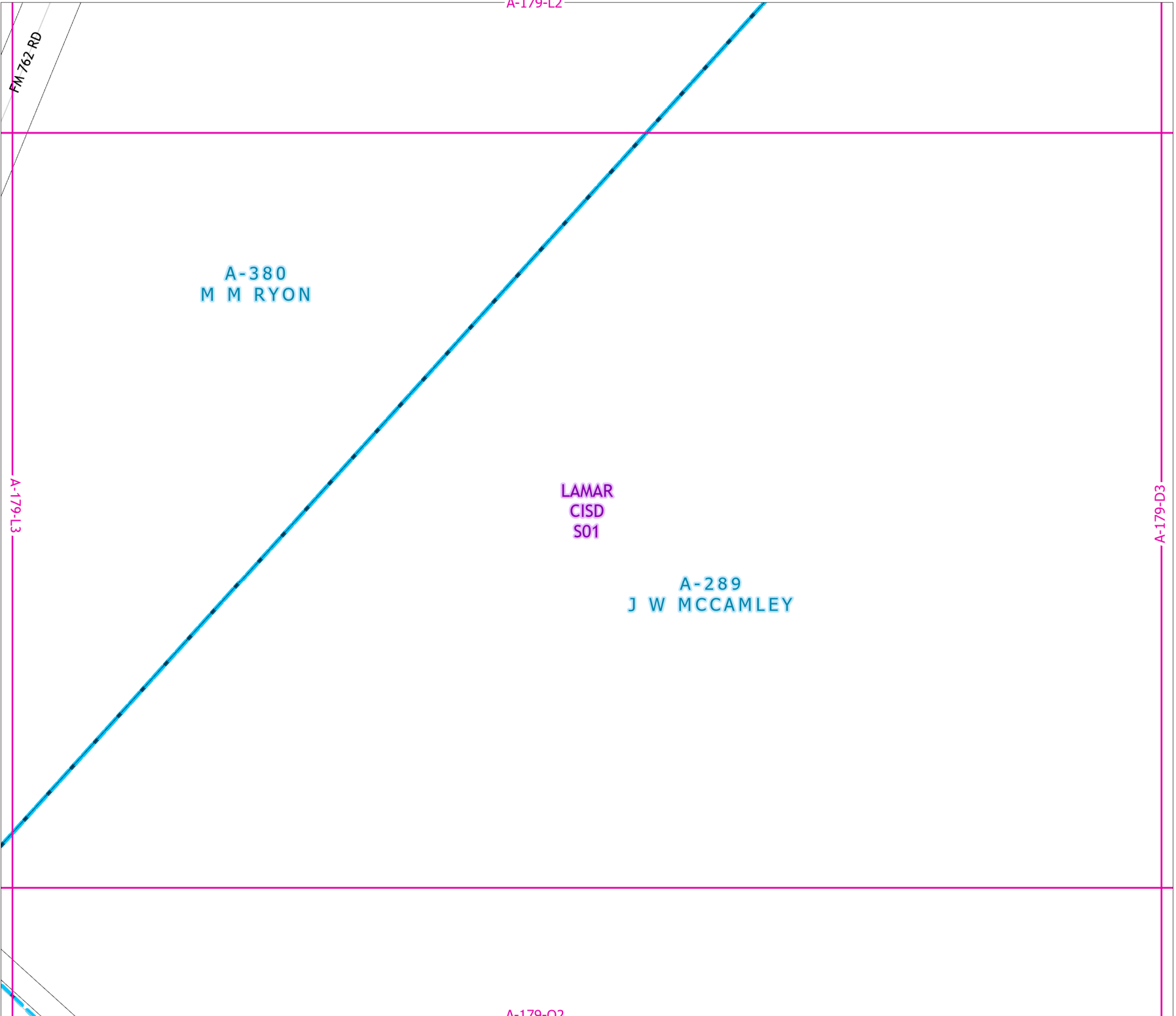

# 2021 Certified Tax Roll



Grid Page  
A-179-M1



Fort Bend Central Appraisal District (FBCAD) is not authorized to determine legal title to property or establish the legal boundaries of property. FBCAD establishes appraisal records based on information from various sources, including but not limited to deeds, plats and surveys provided to but not created by the district. FBCAD is not responsible for errors or omissions in information submitted to and reviewed by the district. If any errors or omission are detected, contact the GIS Department of the FBCAD.

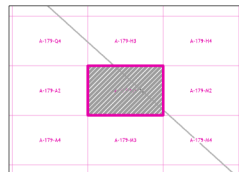

Grid Location Reference



County Location Reference

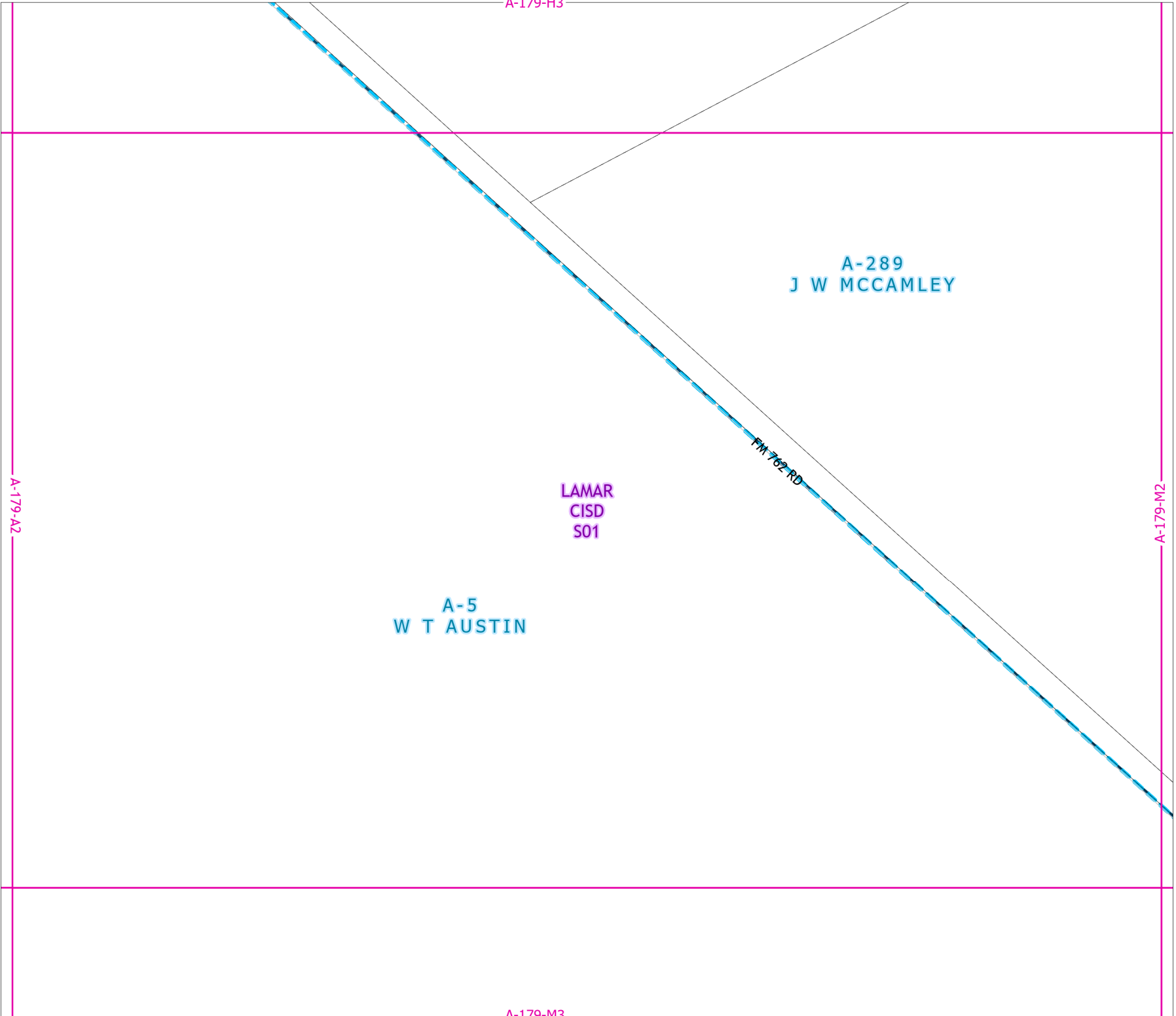

A-179-H4

0020  
72.344 AC

A-289  
J W MCCAMLEY

LAMAR  
CISD  
S01

A-147  
BEATY-SEALES-FORWOOD

A-179-M1

A-179-C1

A-5  
W T AUSTIN

FM 762 RD

A-179-M4

# 2021 Certified Tax Roll



Grid Page  
A-179-M2

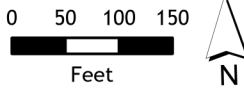

Fort Bend Central Appraisal District (FBCAD) is not authorized to determine legal title to property or establish the legal boundaries of property. FBCAD establishes appraisal records based on information from various sources, including but not limited to deeds, plats and surveys provided to but not created by the district. FBCAD is not responsible for errors or omissions in information submitted to and reviewed by the district. If any errors or omission are detected, contact the GIS Department of the FBCAD.

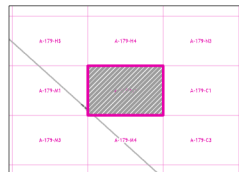

Grid Location Reference



County Location Reference

A-179-M1

FM 702 RD

# 2021 Certified Tax Roll



**Grid Page  
A-179-M3**

**A-5  
W T AUSTIN  
LAMAR  
CISD  
S01**

A-179-A4

A-179-M4

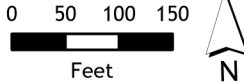

Fort Bend Central Appraisal District (FBCAD) is not authorized to determine legal title to property or establish the legal boundaries of property. FBCAD establishes appraisal records based on information from various sources, including but not limited to deeds, plats and surveys provided to but not created by the district. FBCAD is not responsible for errors or omissions in information submitted to and reviewed by the district. If any errors or omission are detected, contact the GIS Department of the FBCAD.

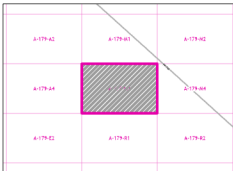

Grid Location Reference



County Location Reference

A-179-R1

# 2021 Certified Tax Roll



**Grid Page**  
**A-179-M4**



Fort Bend Central Appraisal District (FBCAD) is not authorized to determine legal title to property or establish the legal boundaries of property. FBCAD establishes appraisal records based on information from various sources, including but not limited to deeds, plats and surveys provided to but not created by the district. FBCAD is not responsible for errors or omissions in information submitted to and reviewed by the district. If any errors or omission are detected, contact the GIS Department of the FBCAD.

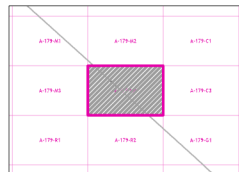

Grid Location Reference



County Location Reference

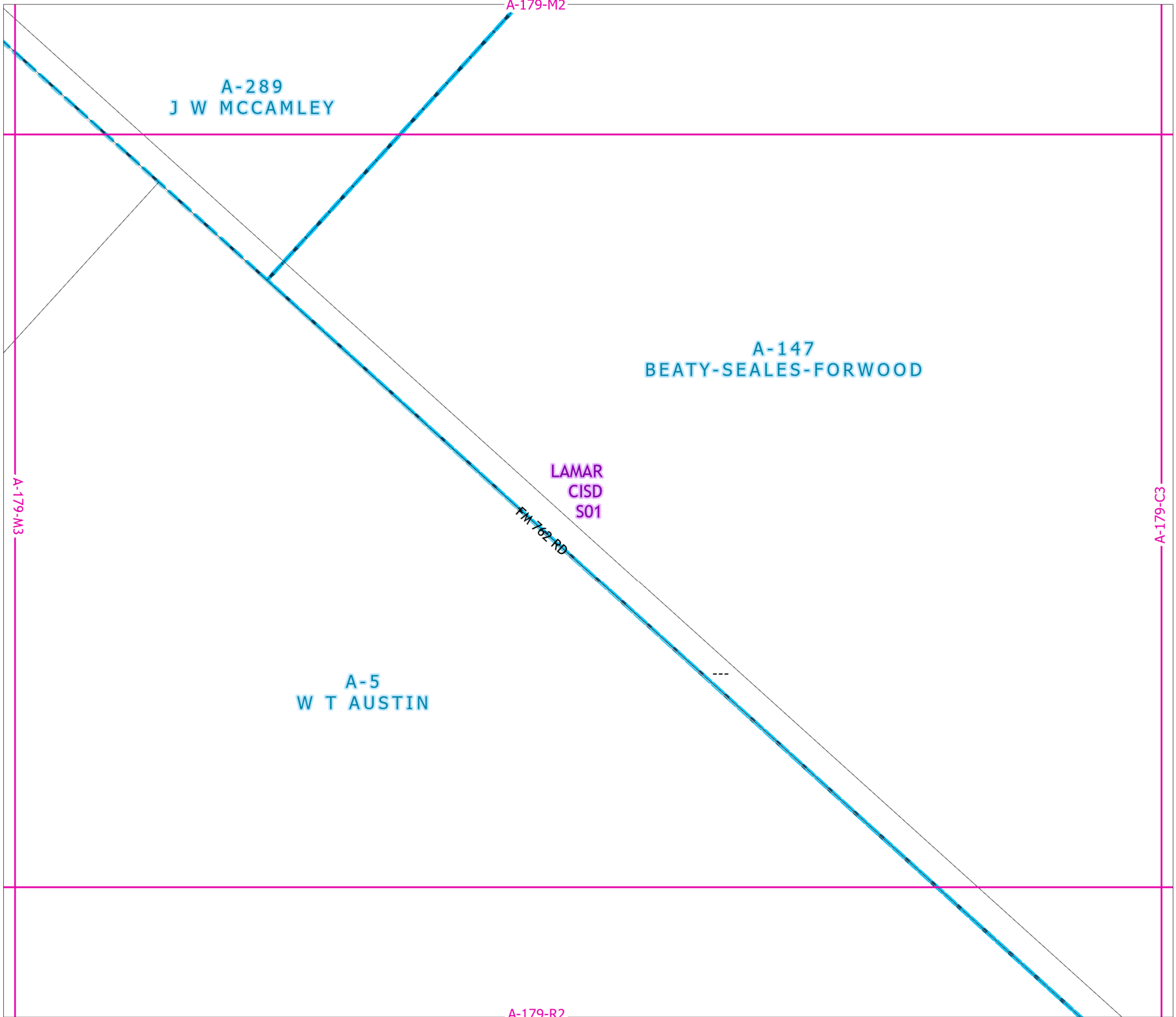



A-179-J3

# 2021 Certified Tax Roll



Grid Page  
A-179-N1

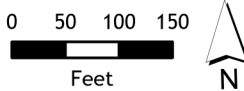

Fort Bend Central Appraisal District (FBCAD) is not authorized to determine legal title to property or establish the legal boundaries of property. FBCAD establishes appraisal records based on information from various sources, including but not limited to deeds, plats and surveys provided to but not created by the district. FBCAD is not responsible for errors or omissions in information submitted to and reviewed by the district. If any errors or omission are detected, contact the GIS Department of the FBCAD.

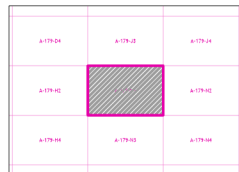

Grid Location Reference



County Location Reference

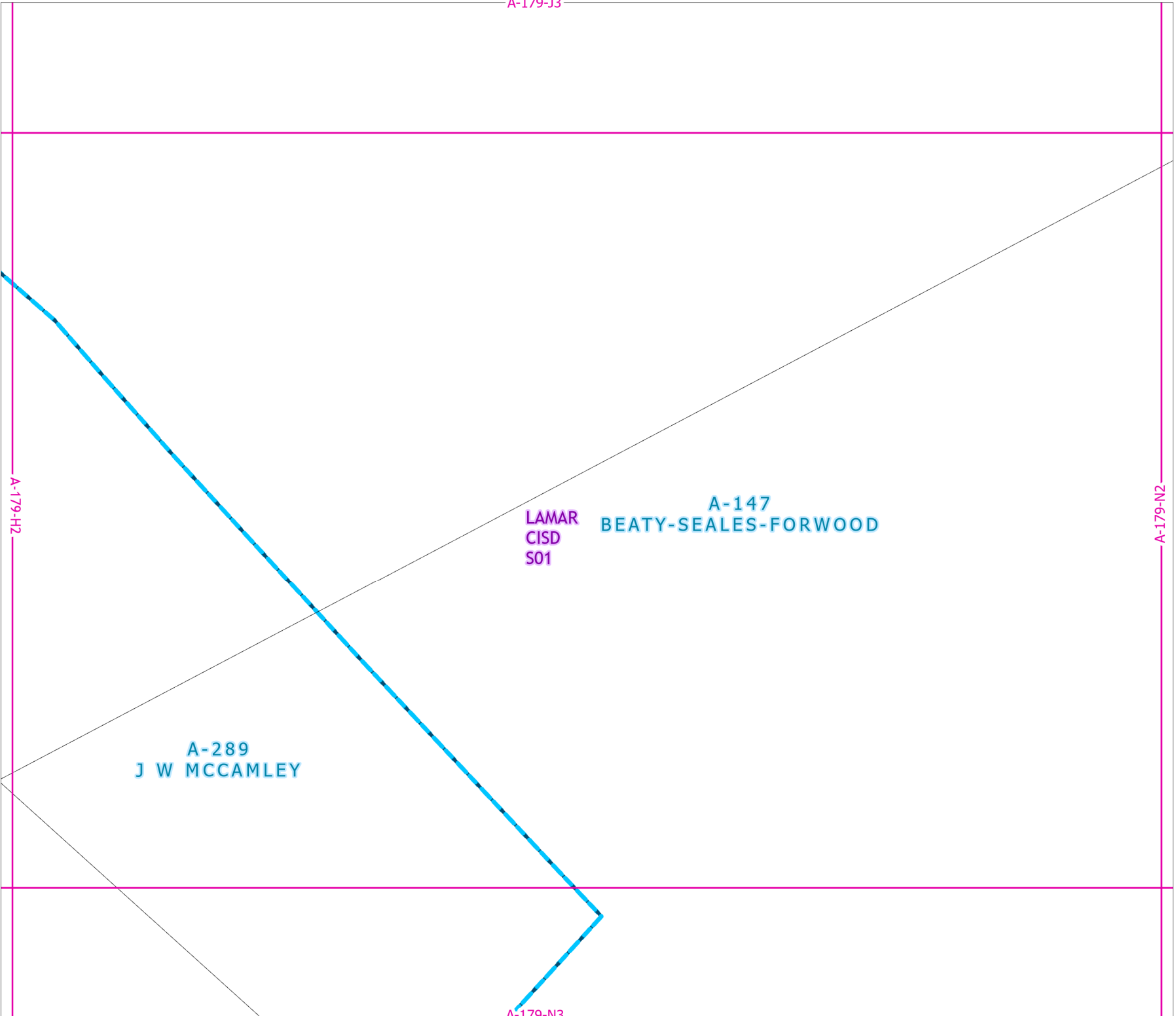

A-179-N3

# 2021 Certified Tax Roll



**Grid Page  
A-179-N2**



Fort Bend Central Appraisal District (FBCAD) is not authorized to determine legal title to property or establish the legal boundaries of property. FBCAD establishes appraisal records based on information from various sources, including but not limited to deeds, plats and surveys provided to but not created by the district. FBCAD is not responsible for errors or omissions in information submitted to and reviewed by the district. If any errors or omission are detected, contact the GIS Department of the FBCAD.

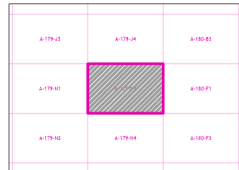

Grid Location Reference



County Location Reference

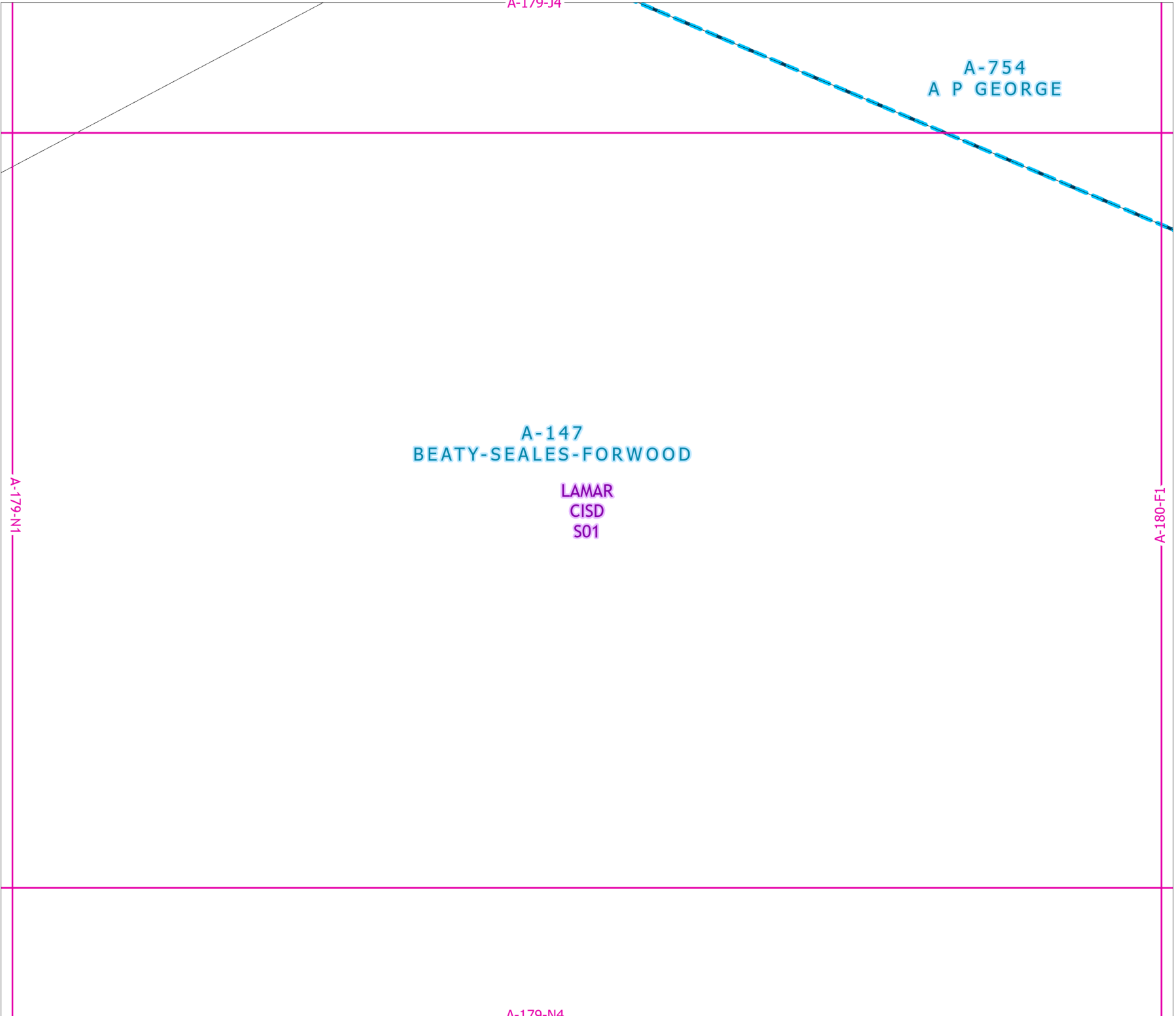

# 2021 Certified Tax Roll



Grid Page  
A-179-N3



Fort Bend Central Appraisal District (FBCAD) is not authorized to determine legal title to property or establish the legal boundaries of property. FBCAD establishes appraisal records based on information from various sources, including but not limited to deeds, plats and surveys provided to but not created by the district. FBCAD is not responsible for errors or omissions in information submitted to and reviewed by the district. If any errors or omission are detected, contact the GIS Department of the FBCAD.

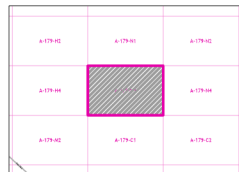

Grid Location Reference



County Location Reference

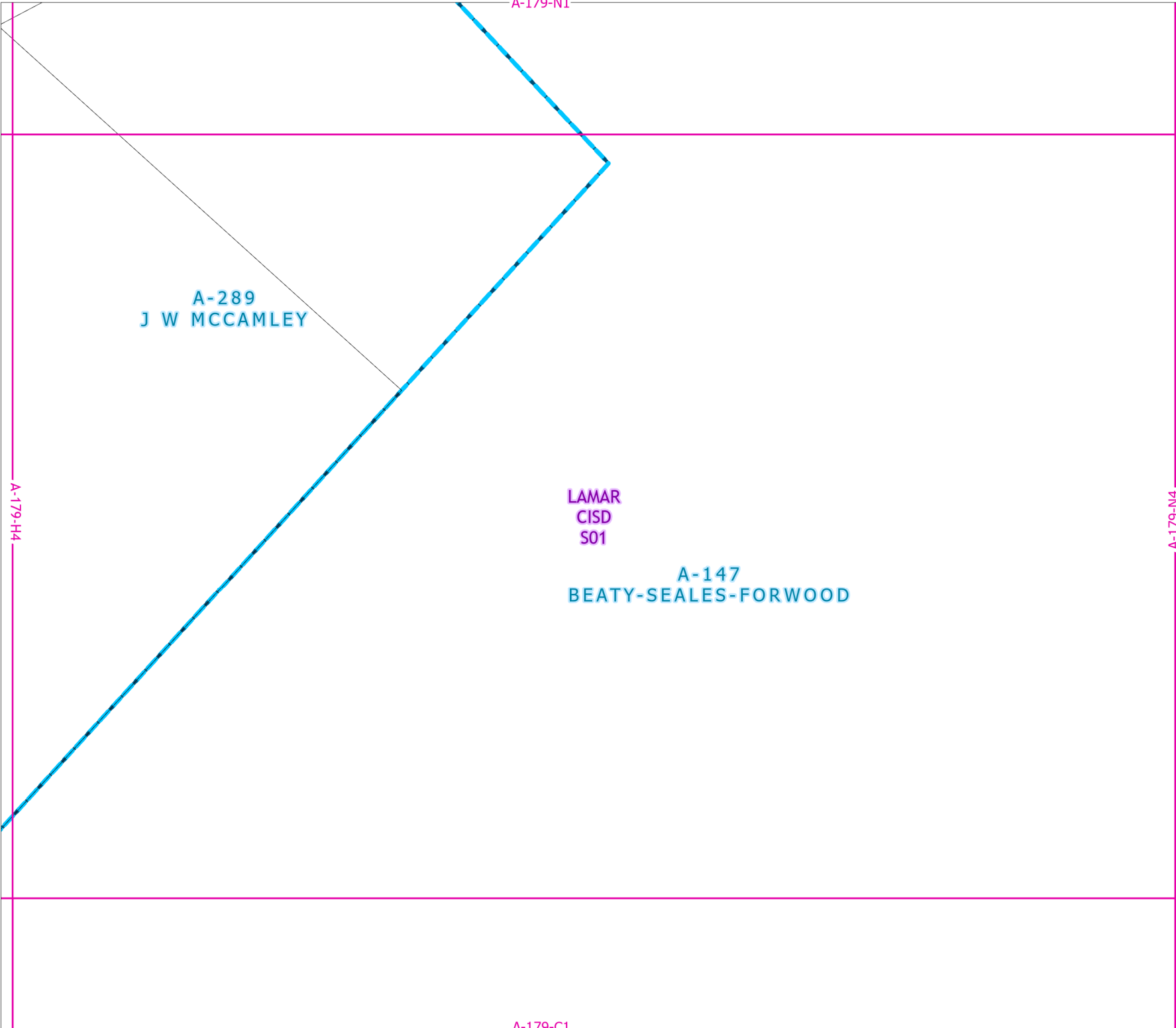



**Grid Page  
A-179-N4**

**A-147  
BEATY-SEALES-FORWOOD**

**LAMAR  
CISD  
S01**

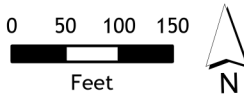

Fort Bend Central Appraisal District (FBCAD) is not authorized to determine legal title to property or establish the legal boundaries of property. FBCAD establishes appraisal records based on information from various sources, including but not limited to deeds, plats and surveys provided to but not created by the district. FBCAD is not responsible for errors or omissions in information submitted to and reviewed by the district. If any errors or omission are detected, contact the GIS Department of the FBCAD.

A-179-N1	A-179-N2	A-180-F1
A-179-N3	A-179-N4	A-180-F2
A-179-N5	A-179-N6	A-180-F3

Grid Location Reference



County Location Reference

# 2021 Certified Tax Roll



**Grid Page  
A-179-P1**

**A-5  
W T AUSTIN**

**LAMAR  
CISD  
S01**

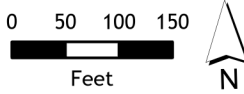

Fort Bend Central Appraisal District (FBCAD) is not authorized to determine legal title to property or establish the legal boundaries of property. FBCAD establishes appraisal records based on information from various sources, including but not limited to deeds, plats and surveys provided to but not created by the district. FBCAD is not responsible for errors or omissions in information submitted to and reviewed by the district. If any errors or omission are detected, contact the GIS Department of the FBCAD.

A-179-G1	A-179-G2	A-179-G4
A-179-G3	A-179-P1	A-179-G2
A-179-G4	A-179-G3	A-179-G4

Grid Location Reference



County Location Reference

# 2021 Certified Tax Roll



**Grid Page  
A-179-P2**

**A-5  
W T AUSTIN  
LAMAR  
CISD  
S01**

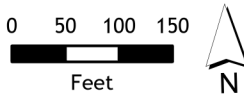

Fort Bend Central Appraisal District (FBCAD) is not authorized to determine legal title to property or establish the legal boundaries of property. FBCAD establishes appraisal records based on information from various sources, including but not limited to deeds, plats and surveys provided to but not created by the district. FBCAD is not responsible for errors or omissions in information submitted to and reviewed by the district. If any errors or omission are detected, contact the GIS Department of the FBCAD.

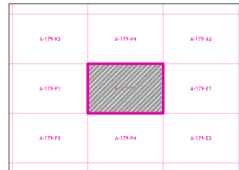

Grid Location Reference



County Location Reference



**Grid Page  
A-179-P3**

**A-5  
W T AUSTIN**

**LAMAR  
CISD  
S01**

A-178-G4

A-179-P4

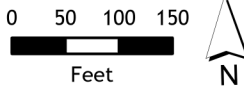

Fort Bend Central Appraisal District (FBCAD) is not authorized to determine legal title to property or establish the legal boundaries of property. FBCAD establishes appraisal records based on information from various sources, including but not limited to deeds, plats and surveys provided to but not created by the district. FBCAD is not responsible for errors or omissions in information submitted to and reviewed by the district. If any errors or omission are detected, contact the GIS Department of the FBCAD.

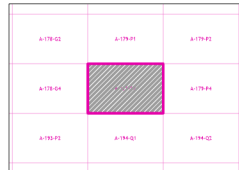

Grid Location Reference



County Location Reference

# 2021 Certified Tax Roll



**Grid Page  
A-179-P4**

**A-5  
W T AUSTIN**

**LAMAR  
CISD  
S01**

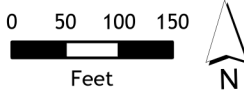

Fort Bend Central Appraisal District (FBCAD) is not authorized to determine legal title to property or establish the legal boundaries of property. FBCAD establishes appraisal records based on information from various sources, including but not limited to deeds, plats and surveys provided to but not created by the district. FBCAD is not responsible for errors or omissions in information submitted to and reviewed by the district. If any errors or omission are detected, contact the GIS Department of the FBCAD.

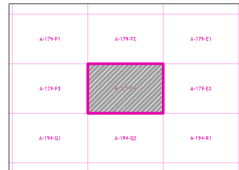

Grid Location Reference



County Location Reference



# 2021 Certified Tax Roll



**Grid Page  
A-179-Q1**



Fort Bend Central Appraisal District (FBCAD) is not authorized to determine legal title to property or establish the legal boundaries of property. FBCAD establishes appraisal records based on information from various sources, including but not limited to deeds, plats and surveys provided to but not created by the district. FBCAD is not responsible for errors or omissions in information submitted to and reviewed by the district. If any errors or omission are detected, contact the GIS Department of the FBCAD.

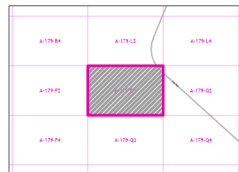

Grid Location Reference



County Location Reference

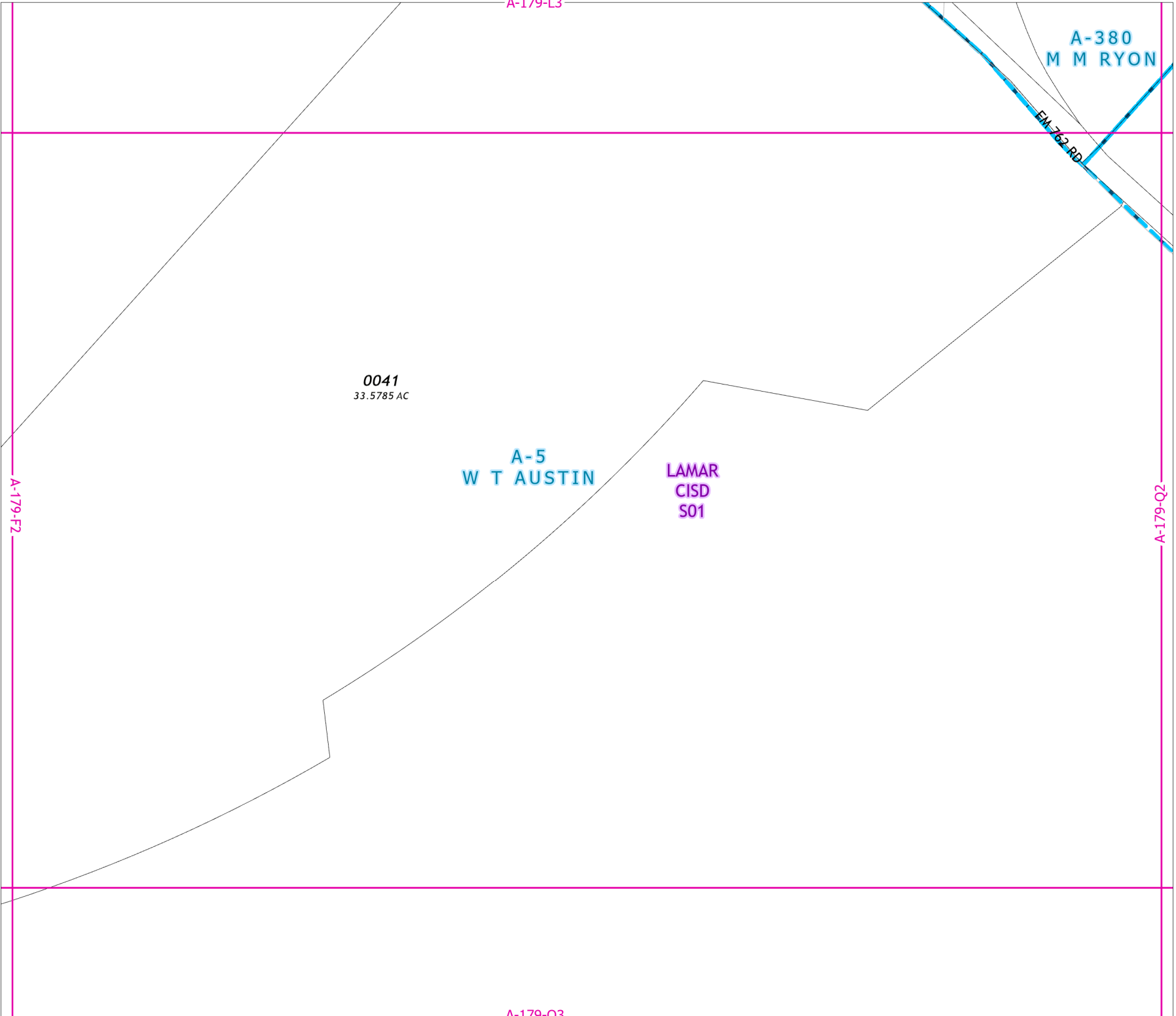

A-179-L4

# 2021 Certified Tax Roll



Grid Page  
A-179-Q2

A-289  
J W MCCAMLEY

LAMAR  
CISD  
S01

A-5  
W T AUSTIN

FH 762 RD

A-179-Q1

A-179-H1

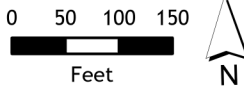

Fort Bend Central Appraisal District (FBCAD) is not authorized to determine legal title to property or establish the legal boundaries of property. FBCAD establishes appraisal records based on information from various sources, including but not limited to deeds, plats and surveys provided to but not created by the district. FBCAD is not responsible for errors or omissions in information submitted to and reviewed by the district. If any errors or omission are detected, contact the GIS Department of the FBCAD.

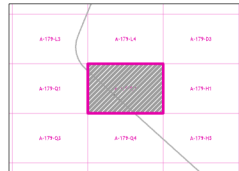

Grid Location Reference



County Location Reference

A-179-Q4

# 2021 Certified Tax Roll



**Grid Page  
A-179-Q3**

**A-5  
W T AUSTIN**

**LAMAR  
CISD  
S01**

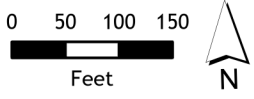

Fort Bend Central Appraisal District (FBCAD) is not authorized to determine legal title to property or establish the legal boundaries of property. FBCAD establishes appraisal records based on information from various sources, including but not limited to deeds, plats and surveys provided to but not created by the district. FBCAD is not responsible for errors or omissions in information submitted to and reviewed by the district. If any errors or omission are detected, contact the GIS Department of the FBCAD.

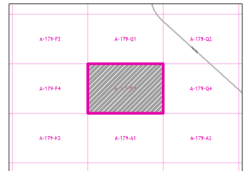

Grid Location Reference

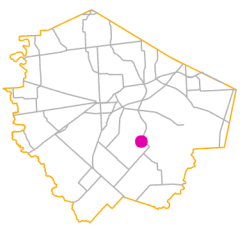

County Location Reference

# 2021 Certified Tax Roll



Grid Page  
A-179-Q4



Fort Bend Central Appraisal District (FBCAD) is not authorized to determine legal title to property or establish the legal boundaries of property. FBCAD establishes appraisal records based on information from various sources, including but not limited to deeds, plats and surveys provided to but not created by the district. FBCAD is not responsible for errors or omissions in information submitted to and reviewed by the district. If any errors or omission are detected, contact the GIS Department of the FBCAD.

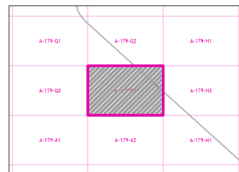

Grid Location Reference



County Location Reference

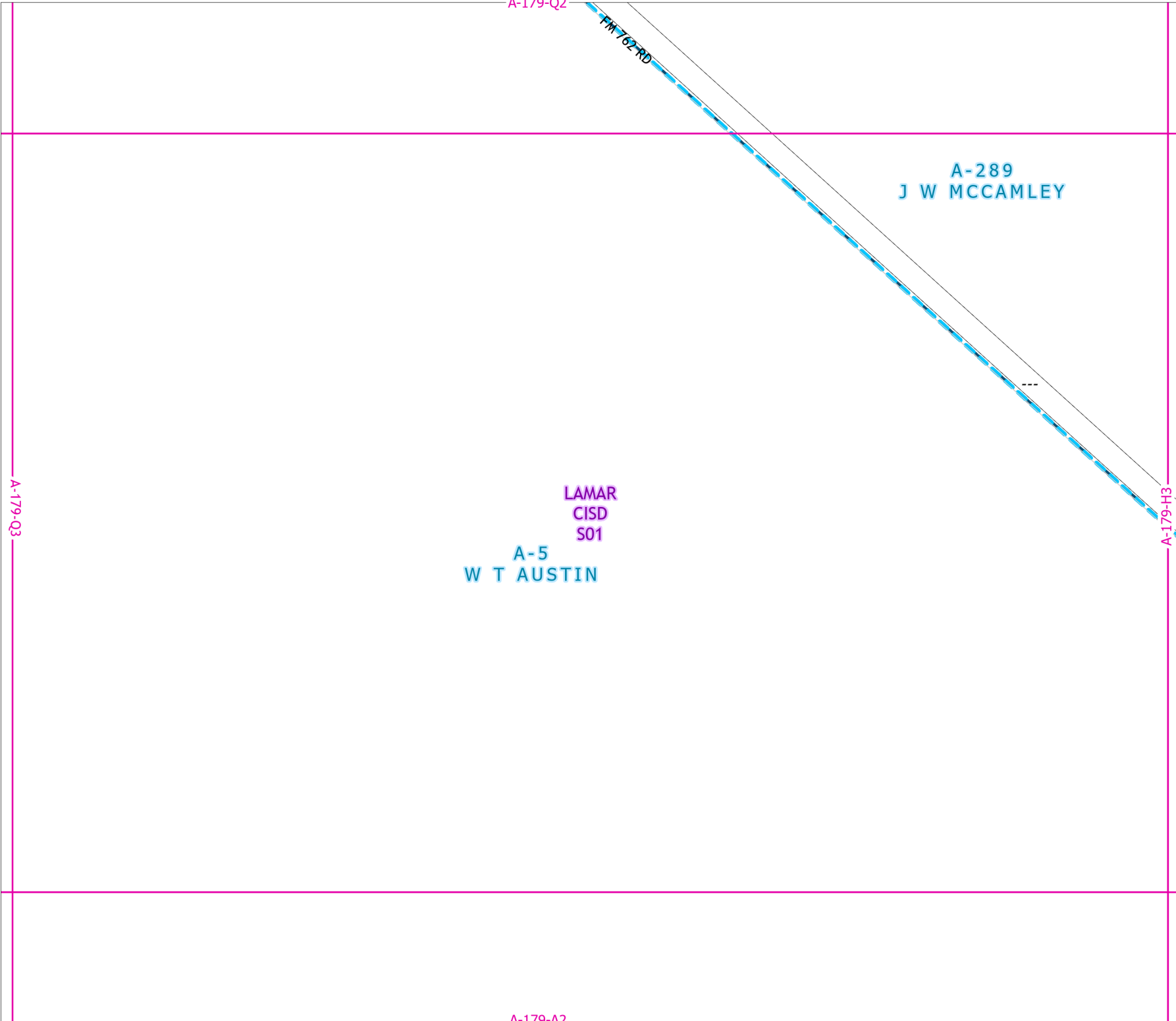

# 2021 Certified Tax Roll



**Grid Page  
A-179-R1**

A-179-M3

**A-5  
W T AUSTIN**

**LAMAR  
CISD  
S01**

A-179-E2

A-179-R2

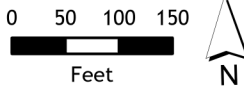

Fort Bend Central Appraisal District (FBCAD) is not authorized to determine legal title to property or establish the legal boundaries of property. FBCAD establishes appraisal records based on information from various sources, including but not limited to deeds, plats and surveys provided to but not created by the district. FBCAD is not responsible for errors or omissions in information submitted to and reviewed by the district. If any errors or omission are detected, contact the GIS Department of the FBCAD.

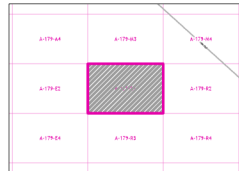

Grid Location Reference



County Location Reference

A-179-R3

A-179-M4

A-147  
BEATY-SEALES-FORWOOD

FM 762 RD

# 2021 Certified Tax Roll



Grid Page  
A-179-R2

A-5  
W T AUSTIN

LAMAR  
CISD  
S01

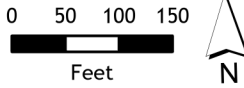

Fort Bend Central Appraisal District (FBCAD) is not authorized to determine legal title to property or establish the legal boundaries of property. FBCAD establishes appraisal records based on information from various sources, including but not limited to deeds, plats and surveys provided to but not created by the district. FBCAD is not responsible for errors or omissions in information submitted to and reviewed by the district. If any errors or omission are detected, contact the GIS Department of the FBCAD.

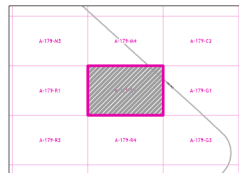

Grid Location Reference



County Location Reference

A-179-R1

A-179-G1

A-179-R4

# 2021 Certified Tax Roll



**Grid Page  
A-179-R3**

**A-5  
W T AUSTIN**

**LAMAR  
CISD  
S01**

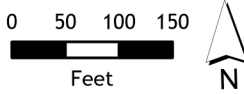

Fort Bend Central Appraisal District (FBCAD) is not authorized to determine legal title to property or establish the legal boundaries of property. FBCAD establishes appraisal records based on information from various sources, including but not limited to deeds, plats and surveys provided to but not created by the district. FBCAD is not responsible for errors or omissions in information submitted to and reviewed by the district. If any errors or omission are detected, contact the GIS Department of the FBCAD.

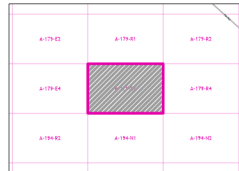

Grid Location Reference



County Location Reference



## Grid Page A-179-R4

A-5  
W T AUSTIN  
LAMAR  
CISD  
S01

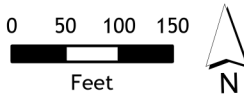

Fort Bend Central Appraisal District (FBCAD) is not authorized to determine legal title to property or establish the legal boundaries of property. FBCAD establishes appraisal records based on information from various sources, including but not limited to deeds, plats and surveys provided to but not created by the district. FBCAD is not responsible for errors or omissions in information submitted to and reviewed by the district. If any errors or omission are detected, contact the GIS Department of the FBCAD.

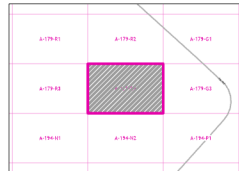

Grid Location Reference



County Location Reference